

PLAZA DECK ASSEMBLY

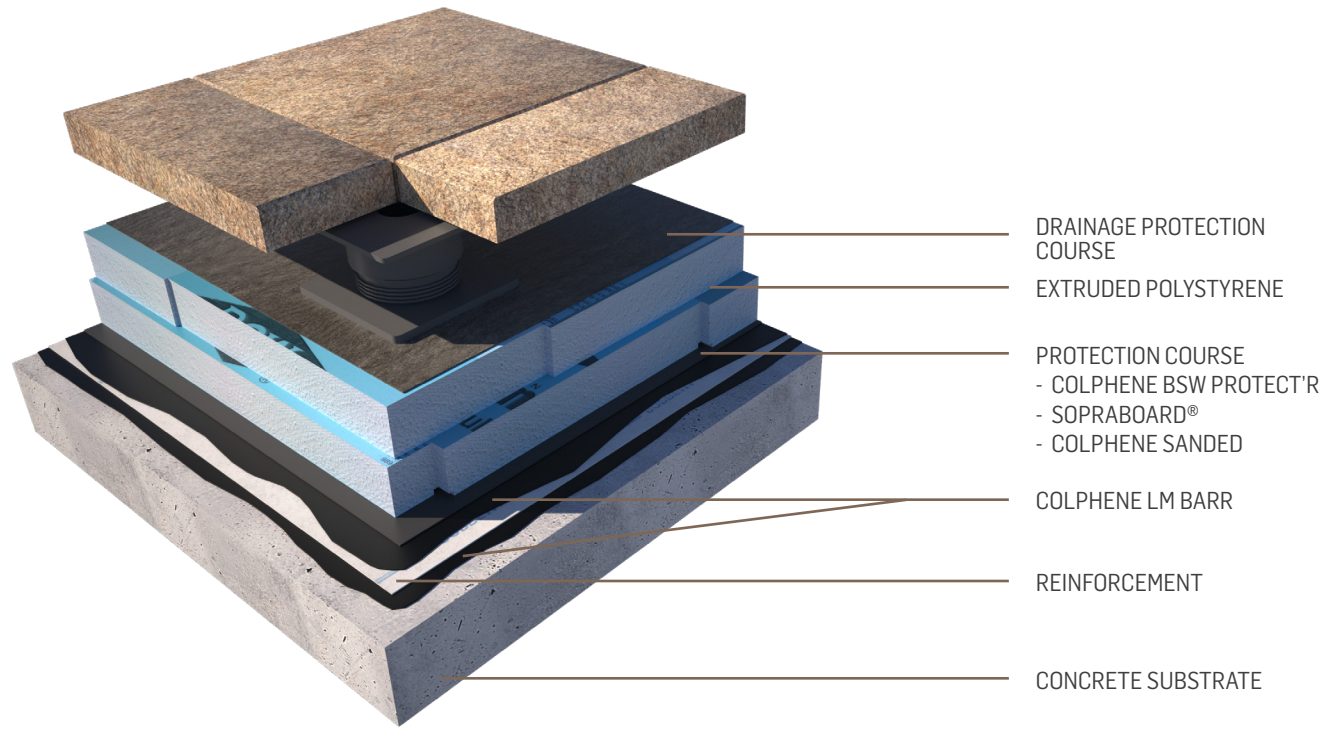

TESTING & APPROVALS

Meets the testing and performance requirements of:

ASTM D 5385: Standard Test Method for Hydrostatic Pressure Resistance of Waterproofing Membranes

ASTM C 836: Standard Specification for High Solids Content, Cold Liquid-Applied Elastomeric Waterproofing Membrane for Use with Separate Wearing Course



INNOVATION SINCE 1908

SOPREMA has developed around the idea that the quality, durability and reliability of materials must match builders' ambitions and expectations. For more than 100 years, SOPREMA has been using its expertise to develop a variety of high-end products that meet or exceed all the requirements of the construction field.

ROOFING WATERPROOFING WALLS CIVIL ENGINEERING



SOPREMA is an international manufacturer specializing in the production of waterproofing and insulation products, as well as vegetative and soundproofing solutions, for the building and civil engineering sectors.

SOPREMA.US • 1.800.356.3521

SOPREMA.CA • 1.877.MAMMOUTH



WATERPROOFING

COLPHENE® LM BARR

UNIVERSAL WATERPROOFING BARRIER

ADDITIONAL EXPERTISE



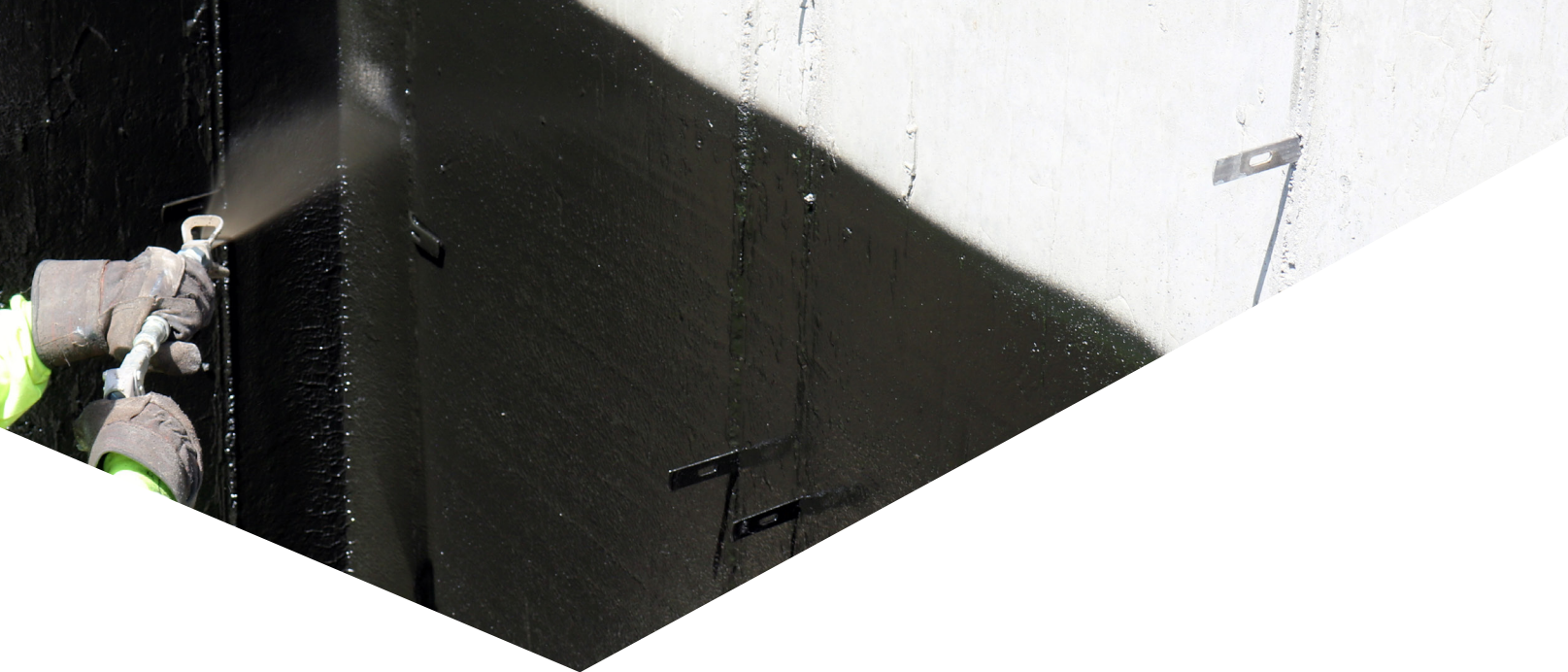

COLPHENE® LM BARR

WHEN CONSTRUCTION CALLS FOR A MONOLITHIC WATERPROOFING BARRIER

COLPHENE LM BARR is a single component, liquid applied, moisture curing elastomeric waterproofing membrane. COLPHENE LM BARR is ideal as a positive-side waterproofing for sealing foundations. It can also be used in between slab waterproofing, equipment wells, and other underground construction. In above grade applications, use COLPHENE LM BARR to waterproof planter boxes, sealing parapets, plaza decks and green roof systems. COLPHENE LM BARR is available in both spray and squeegee grades.

SYSTEM ADVANTAGES

- The first and only spray grade STPE waterproofing membrane on the market making installation fast and easy with very minimal preparation work – truly a time saving solution!
- Polyether/STPE technology combines the best of both worlds – provides persistent adhesion to concrete while allowing movement of the building with extremely high elongation properties
- One pass application up to 120 mils (3.0 mm)
- Moisture cure allows COLPHENE LM BARR to bond to 'green' concrete which allows you to coat the concrete sooner as opposed to emulsion-type or cutback products which can blister with moisture
- High solids content – meaning this product won't shrink or pull away from the concrete - i.e. 120 mils is 120 mils
- Fast cure reduces construction sequencing time by reducing backfill wait times
- Rain safe in minutes

INNOVATION

ABOUT STPE TECHNOLOGY

What do MS polymers, STPE and polyethers have in common? These typically all refer to the same technology. STPE (silyl terminated polyether) refers to what is known as a hybrid material. It is called a hybrid because this technology combines the most desired features of several chemistries to develop products that excel in the construction industry. COLPHENE LM BARR is a hybrid technology which combines the long term grab and adhesion of a silicone and the elongation properties of a urethane providing an extremely broad range of performance properties.

SUCCESS STORY

ANB Bank
Denver, Colorado

ANB Bank offers customers personal and business banking, as well as financial services with a company that is dedicated to keeping their financials safe. By providing creative and flexible one-on-one solutions, ANB Bank puts their customers first, and with thirty locations across Colorado, Wyoming and the Kansas City metro area a branch is always near.

When the Denver ANB Bank was to go through a remodel, SOPREMA's COLPHENE LM BARR product was selected to waterproof the building. With a tight deadline and existing concrete preparation to take into consideration, COLPHENE LM BARR was the perfect solution due to its excellent performance qualities. With COLPHENE LM BARR's STPE moisture cure technology, the new and improved ANB Bank will have a continuous waterproofing layer that can withstand extreme cold and high temperatures without cracking or softening for many years to come.



BELOW GRADE ASSEMBLY

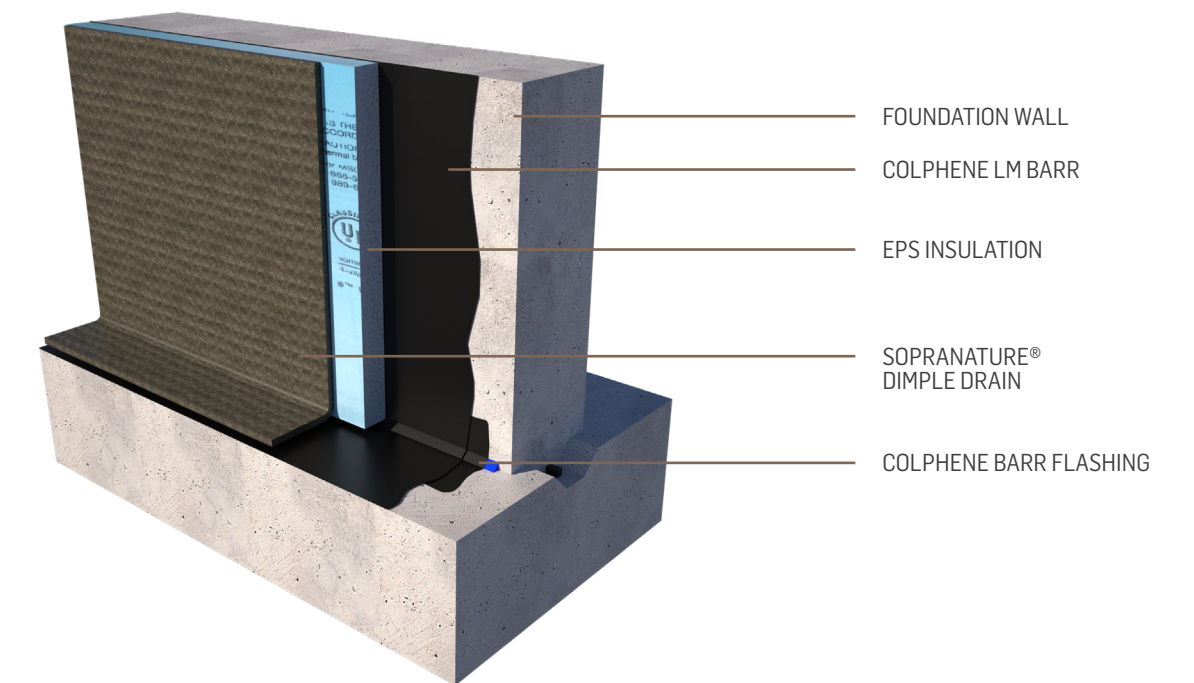

PRODUCTS AND SIZES AVAILABLE

COLPHENE LM BARR

COLPHENE LM BARR is a single component, 98% solids content, liquid applied, moisture curing elastomeric waterproofing membrane. COLPHENE LM BARR's STPE moisture cure technology forms a continuous, tough elastic seal to the substrate that withstands extreme cold and high temperatures without cracking or softening.



* Available in 5 GAL (19 L)

COLPHENE BARR FLASHING

COLPHENE LM BARR Flashing is a single component, 100% solids content, liquid applied, moisture curing elastomeric waterproofing membrane. COLPHENE LM BARR Flashing's STPE moisture cure technology forms a continuous, tough elastic seal to the substrate that withstands extreme cold and high temperatures without cracking or softening.



* Available in 3.5 GAL (13 L) or 20 OZ (591 ML)

COLPHENE LM BARR SPRAY

COLPHENE LM BARR Spray is a single component, 95% solids content, liquid applied, moisture curing elastomeric waterproofing membrane. COLPHENE LM BARR Spray's STPE moisture cure technology forms a continuous, tough elastic seal to the substrate that withstands extreme cold and high temperatures without cracking or softening.



* Available in 5 GAL (19 L), 50 GAL (189 L), or 330 GAL (1249 L)

POLYFLEECE FLASHING

Polyfleece Flashing is a proprietary woven polyester reinforcement used in conjunction with liquid applied resins.

