

## ALSAN RS ROOF SYSTEMS

### ROOF SYSTEM

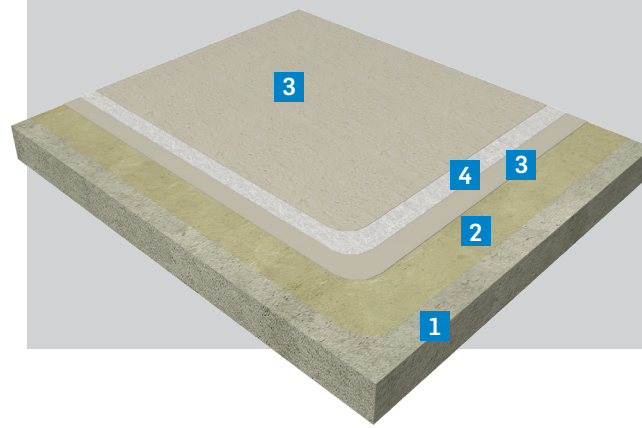

- 1 Prepared substrate
- 2 ALSAN RS 276 Primer
- 3 ALSAN RS 230 Field or ALSAN RS 260 LO Field
- 4 ALSAN RS Fleece

### ADDITIONAL MATERIALS FOR TRAFFICABLE SURFACES

- 5 ALSAN RS 230 Field or ALSAN RS 260 LO Field (additional layer)
- 6 ALSAN RS 289 Textured Base and ALSAN RS Color Additive

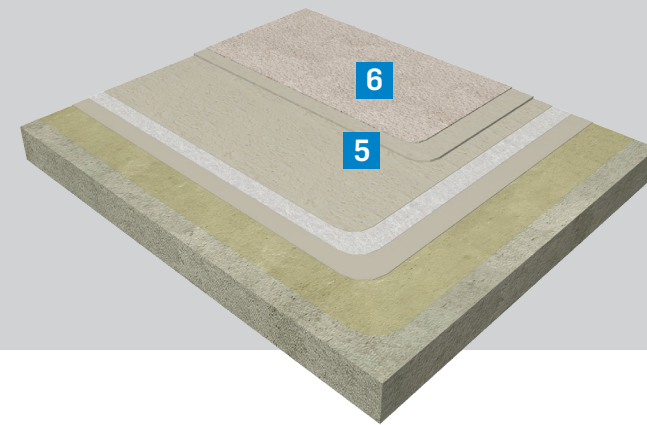

### ALSAN RS FOR FLASHING

ALSAN RS PMMA/PMA liquid applied resins can be used in combination with ALSAN RS Fleece to create a seamless, watertight, puncture resistant, fully reinforced flashing system over SBS-modified bitumen or SENTINEL PVC membranes. Using ALSAN RS for difficult details is a cost-effective, easy-to-apply method that conforms to irregular shapes such as flashings, walls, penetrations, and curbs without the need of torching or adhesives.



## INNOVATION SINCE 1908

SOPREMA has developed around the idea that the quality, durability and reliability of materials must match builders' ambitions and expectations. For more than 100 years, SOPREMA has been using its expertise to develop a variety of high-end products that meet or exceed all the requirements of the construction field.

### ROOFING WATERPROOFING WALLS CIVIL ENGINEERING



SOPREMA is an international manufacturer specializing in the production of waterproofing and insulation products, as well as vegetative and soundproofing solutions, for the building and civil engineering sectors.

SOPREMA.US • 1.800.356.3521

SOPREMA.CA • 1.877.MAMMOUTH



ROOFING &  
WATERPROOFING

# ALSAN® RS ROOFING





# ALSAN® RS

LIQUID APPLIED PMMA/PMA POLYMERIC ROOF MEMBRANES

ALSAN RS offers a complete range of high performance, flexible, seamless, polyester reinforced liquid applied polymeric roofing solutions. ALSAN RS is composed of polymethyl methacrylate (PMMA) and polymethacrylate (PMA) based resins that offer rapid set times and results in a resilient roof requiring minimal maintenance.

Liquid applied systems offer alternatives to conventional roofing methods, eliminating the safety risks associated with adhesives, torches, and hot-applied systems. The single coat application technique also makes ALSAN RS a time and cost effective solution.

## ADVANTAGES

- Rapid-setting and easy application
- VOC compliant
- Tough polyester reinforcement
- Cool roof solution
- Low maintenance

# SUSTAINABILITY

## EXTEND ROOF LIFE

ALSAN RS fully reinforced systems can be used over existing roofs as a recovery system to extend the life of the existing roof installation, limiting the need for tear off. ALSAN RS systems provide a seamless, monolithic seal for a watertight finish. This method provides long-term, cost effective protection against moisture infiltration and other damage.

## SUCCESS STORY

Flatiron Building  
New York City, New York

The world famous Flatiron Building in New York City is protected by SOPREMA. In the dead of winter, with temperatures below freezing, ALSAN RS created an impenetrable liquid applied waterproofing membrane guaranteed for 20 years. SOPREMA's state of the art polymethyl methacrylate liquid applied waterproofing technology was used to completely waterproof the 8,500 square foot main roof and 21st floor set back of the building. The work was completed in difficult circumstances, with below freezing (25° F) temperatures and windy conditions. The main roof was a recovery application, which saved Newmark Knight Frank, the building's owner, the costly process of tearing off the aged granulated surfaced SBS membrane. ALSAN RS was applied directly over the existing membrane, creating a watertight surface. Of special interest was the time saved on numerous skylights and other difficult flashing challenges, including time-consuming penetrations, bulkheads and chimneys, many with peculiar angles due to the building's unique architecture.



## ALSAN RS ROOF SYSTEMS COMPONENTS\*

### PRIMERS

ALSAN RS 276 Primer – A rapid-setting primer designed for porous substrates

ALSAN RS 222 Primer – A rapid-setting primer designed for asphaltic surfaces and coverboards

### RESINS

ALSAN RS 230 Field – Waterproofing resin for horizontal surfaces

ALSAN RS 230 Flash – Waterproofing resin for slopes and details

ALSAN RS 260 LO Field – Low-odor waterproofing resin for horizontal surfaces

ALSAN RS 260 LO Flash – Low-odor waterproofing resin for slopes and details

### FINISH/SEALER TOP COAT RESINS

ALSAN RS 281 Clear Finish – Clear finishing resin

ALSAN RS 287 Color Finish Base – Colorless resin base to which a colored additive is added

ALSAN RS 289 Textured Base – Non-slip resin with premixed aggregates to which a colored additive is added

ALSAN RS 210 – Resin used in conjunction with ALSAN RS 223 to create ALSAN RS 233 Self-Leveling Mortar

ALSAN RS 240 LO – Low-odor base resin mixed with ALSAN RS 223 Mixing Powder to create ALSAN RS 263 Self-Leveling Mortar

### RELATED PRODUCTS

ALSAN RS Paste – Patching resin used in surface preparation and repairs

ALSAN RS Detailer – Sealing resin combined with micro-fiber fleece reinforcement

ALSAN RS Catalyst Powder – Catalyzing agent used to induce curing process

ALSAN RS Fleece – Polyester based reinforcement used with all RS membrane resins

Natural or Colored Quartz Aggregates – Slip-resistant and decorative surfacing

ALSAN RS Deco Chips – Flat, angular pigmented polymer flakes used as a decorative medium

ALSAN RS Cleaner – Clear solvent used to clean and prepare transition areas

ALSAN RS Color Additive – Colored additive intended to be mixed into a liquid PMMA/PMA resins

\*All components of ALSAN RS systems are sold separately.