

IN THE LOOP

a scandinavian grassroots approach



In our proposal, In The Loop, we aim to create a bright sustainable future for the people of Montpelier. Our proposal is an integrated vision and solution that invites the community of Montpelier to take an active role throughout the project's development. Together, we'll look beyond energy efficiency and renewal by setting an even higher goal of creating a place and community that also ensures human well-being. Our proposal meets the ambition of achieving a Net Zero Montpelier in 2030 and in particular, embraces those who hold the future - empowering the children of today for the future of tomorrow.

It loops in the people that make up a great city!

Our proposal, *In The Loop* guides the rejuvenation and reinforces the strong identity of Montpelier. Together we can create a downtown where people want to **live, participate, and visit**.

URBAN DESIGN

Starting point in the overall urban design strategy is to engage the community and to celebrate Montpelier by embracing its charm and vernacular. The design provides more density and a wide variety of smaller public and green spaces ensuring proximity, connectivity and accessibility for all.



phase 1



phase 2

A WINOOSKI RIVER PARK

At 3.5 acres, Winooski River Park establishes a green heart for Montpelier. The park accommodates both individuals and large gatherings. There are intimate places to commune with nature and open spaces for active recreation. The park embraces Taylor Street as an active hub in the center of the park.

The Basin, west of Taylor Street, forms an outdoor amphitheater for concerts and sunbathing. It draws people down to the water and it allows for fluctuating river levels, creating a dynamic space that changes through the seasons.

Meandering through the park is a generous river walk that ties east and west into the longer loops which extend through the city. A series of rain gardens flanking the rail line and running through the park functions as a green spine and an area of transition into the surrounding city fabric as well as a functional frame for the park.

B PARK BRIDGE

The park extends into the new Park Bridge along Taylor Street Bridge to strengthen the connection to south side of Winooski River. It provides a place to pause at the river in close contact with the water and is a safer pedestrian crossing and iconic entrance to Taylor Street and the civic district with the State House.

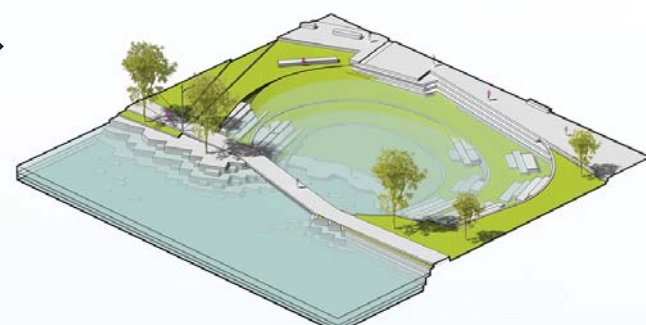

storm water retention in Winooski River park Bowl

C STRAINER STREETS

The existing street network and stormwater infrastructure is strengthened through the implementation of multiple small scale, low impact passive stormwater features. Streets abutting the rivers are vital in acting as "strainers" for runoff prior to it reaching the rivers. Rain gardens collect rain and snowmelt from vehicular surfaces, filtering the water and allowing for infiltration. Structural soils can be used under hardsurfaced areas to store water. Street trees add in uptake and evapotranspiration. Stormwater is made public in the form of visible, functional design where water is venerated, providing a purpose built landscape that is playful through the eyes of childrens and beautiful for residents in general.

D NET ZERO+ LAB

In the heart of Winooski River Park, the Net Zero+ LAB invites people to part take in the joined effort to reach beyond Net Zero by 2030 offering educational programs for the young, public internet access, being a meeting place for the community allowing for various usage by a variety of people.

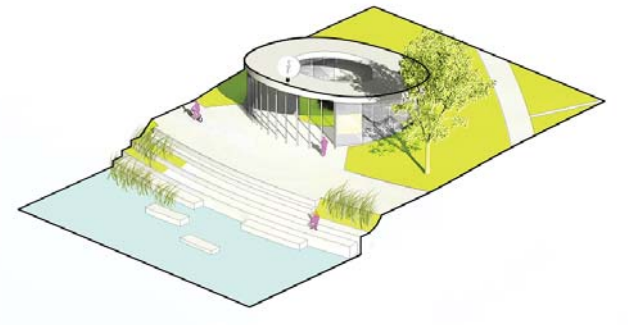

1 STATE STREET PARKING

State Street Parking is a new hybrid of a parking garage and a public park. Gradually climbing the timber constructed federal parking is a landscape park. Housing about 400 parking spaces, the exterior surfaces allow for a variety of playful outdoor activities during all seasons. It is envisioned to be a temporary parking structure that over time will transform into a mobility hub and community center and eventually housing.

2 270 SQUARE FEET

The Scandinavian model where no building permit is needed for structures less than 25 square meters or 270 square feet provides affordable opportunities and allows to densify existing neighborhoods. We suggest the city of Montpelier lifts building permission from structures smaller than 270 square foot and makes available D.I.Y. kits that ensure safe and Net Zero construction while allowing for modification to meet individual demands.

3 MAKER SPACE LIVING

The proposal introduces maker space living which is a new hybrid of residential units and shared work space with a highly flexible construction that enables the building to adapt to market demands. Maker spaces can become residential or office and vice versa which provide **excellent opportunities for younger generations** and art enthusiasts.

Prefabricated modular interior elements for smaller housing units and office space are placed within the timber construction frame and can be adjusted and replaced to meet changing market demands.

Additionally, an activated roof landscape within the urban context is an attractive feature that can help to build a strong social network of creative entrepreneurs.

4 RIVER HOUSING

The River Housing is a typology that includes a half sunken concrete plinth with apartments in timber construction above. The concrete plinth provides a solid foundation that can function as stormwater-storage during possible flooding while the timber apartments embrace the warmth of the landscape.

5 INDOOR FARMER MARKET

An indoor farmers market is incorporated in the design. Beyond the usual functions, the program also includes elderly housing and daycare bridging generations. A portion of exterior common garden provides an **opportunity for young and old** to mingle and smiles to be exchanged.



white+ARUP