



Montpelier is a city surrounded by rich nature. This idea intends to develop not just ordinary housing plan but to cultivate the area potential behind the compact city that would benefit nature engaged in urban life. In this proposal, we adapted multi-complex facility composed with physically and functionally integrated low-rise and high-rise buildings to provide human connection to urban sustainability.

The facility is situated between State St. on the south and Winooski River on the south, which was modified by vertical and horizontal zoning – basically, commercial zone on the lower part, office zone at the middle, and residential zone on the upper level adjacent to the river. Providing atrium and courtyards maximize the surface on the ground level while incorporating natural sense of space.

The project site is located on the south of State St. neighboring to Vermont's state government. The facility emphasizes the image of the area by connecting the Winooski River to the city.

The facility envisioned strengthening the community through the extensive common space and also to create new lifestyle emerging opportunities for younger generations.

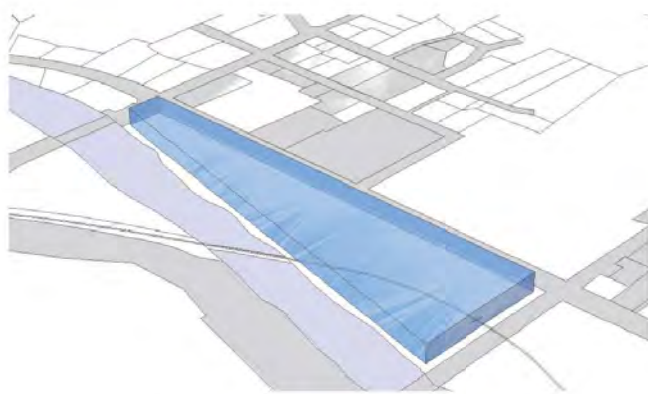

Maximize the horizontal land use

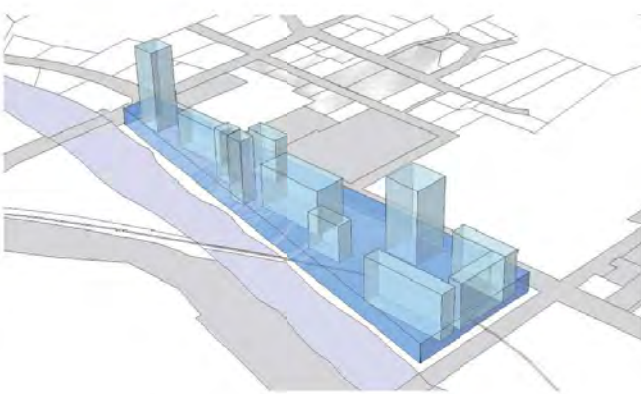

Residential zone in high-rise building



Atrium and courtyards to incorporate natural light



Limit the height to ensure great view



Open facility connecting the city and the river



Section A-A' scale=1:500
Set atrium and courtyards to maximize the horizontal space incorporating natural sense of space.

(Structure・Scale)		Main Finishing	
Structure	: Reinforced Concrete Structure	Flooring (Roof)	: Concrete substrates
Foundation	: Pile Foundation		Asphalt waterproof coating t-12
Numbers of Storey	: 20-Storeys		Anti-crack FRP waterproof coating t-2.5
			Trowel-finished (with white lime) concrete overlay
Maximum Height	: 91.00m	Exterior	: Landscape design (natural stone pavement, grass, trees)
Building Areas	: 20,270 m ²	Walls	: Trowel-finished lime concrete
Total Floor Area	: 97,080 m ²	Flooring	: Trowel-finished lime concrete slab on grade

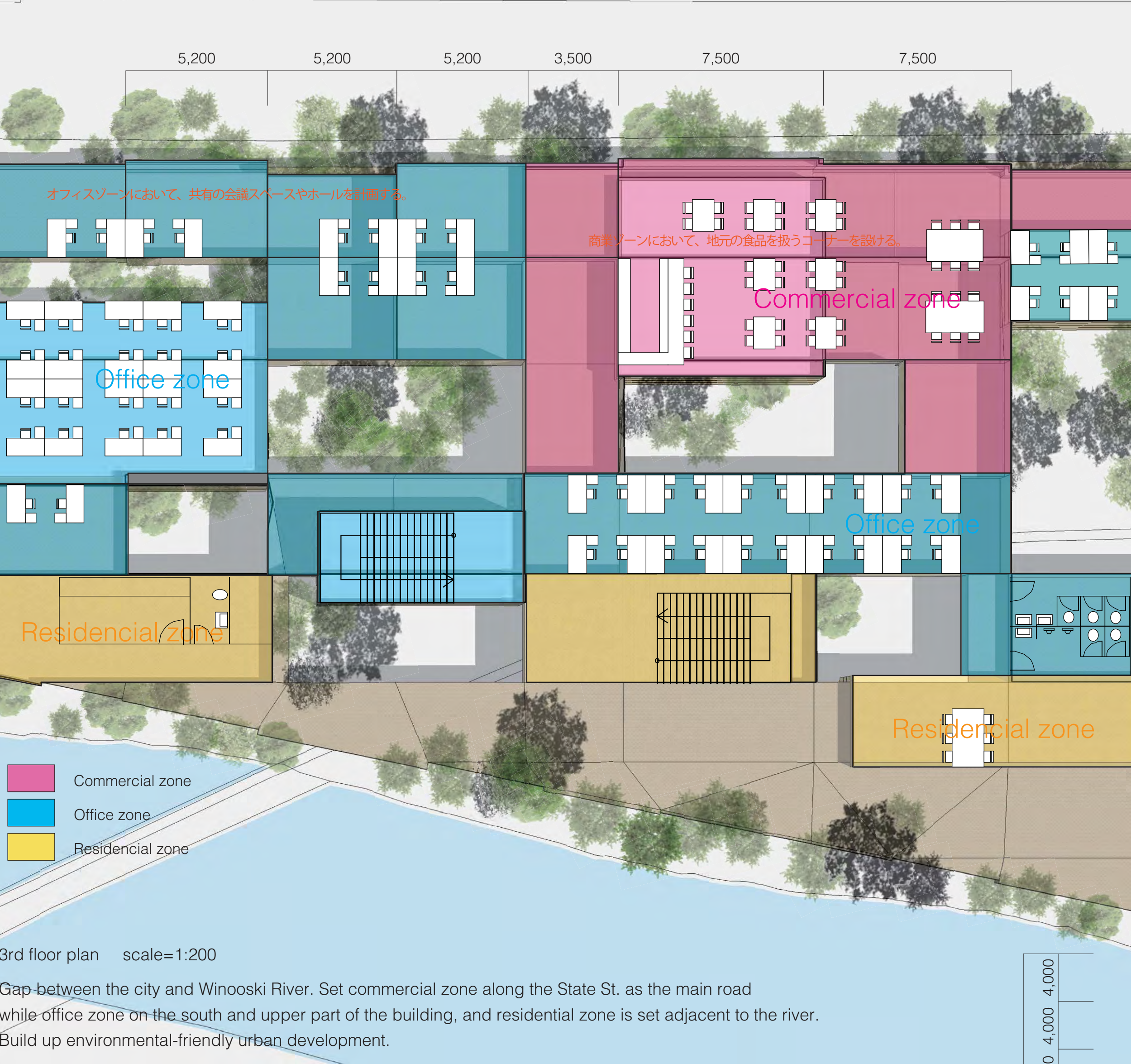

Dusk view - from the west
Incorporate natural light from the approaching space between the facility and the river.

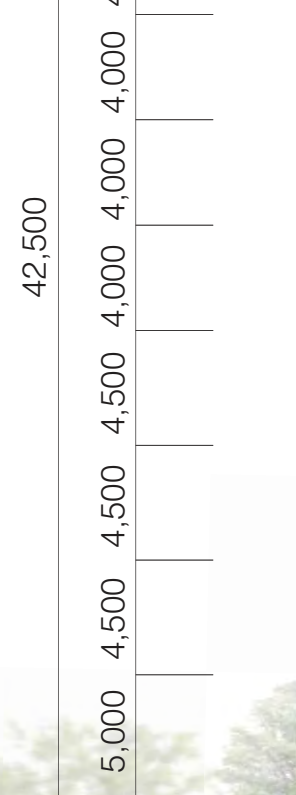

Section B-B' scale=1:200
Build up multi-complex facility while managing the environment. Develop the area potential behind the compact city that would benefit green space engaged in urban life.

