

Agenda

WINTER INSTITUTE

2019

FLOOR 1

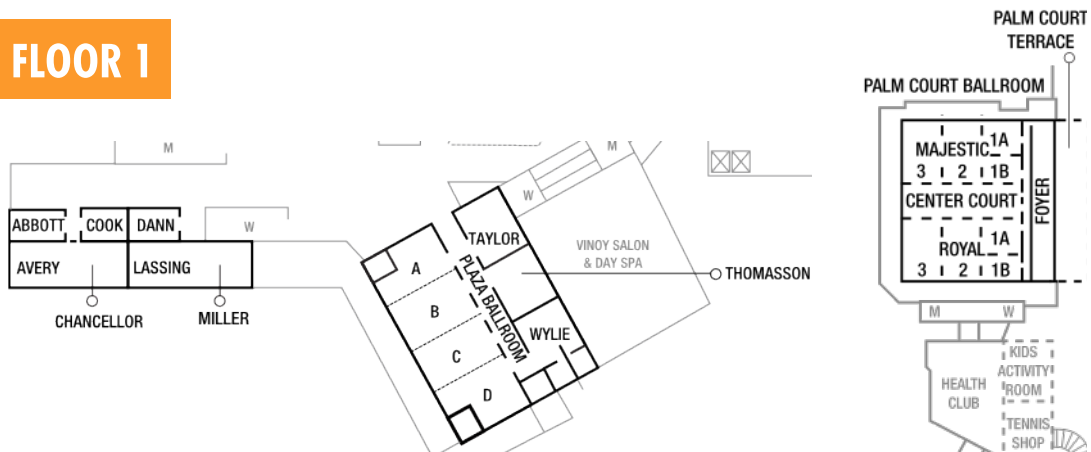

FLOOR 2

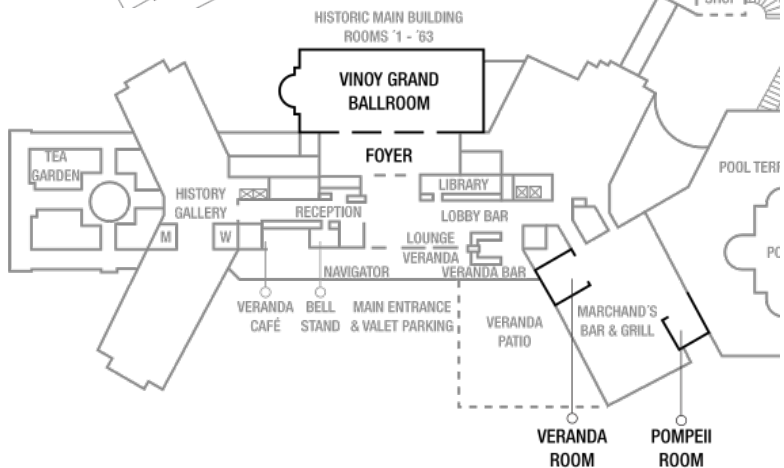

FLOOR 3

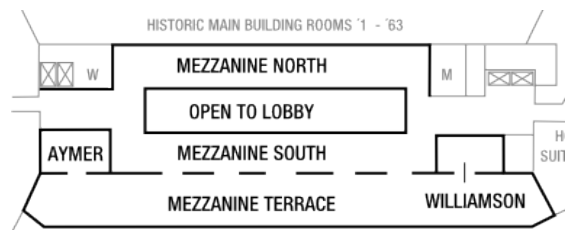

Schedule at a glance

Page	Thu 24	Fri 25	Sat 26	Sun 27
5	8-4:30	8-4:30	8-11:30	
6	8-4:30	8-4:30	8-4:30	
7	8-4:30			
9		8-4:30	8-4:30	8-4:30
10		8-4:30	8-4:30	
13		8-4:30	8-4:30	8-11:30
14		8-4:30	8-4:30	8-11:30

Fundamentals of Physician Leadership

CMO Academy

Population Health Series

Physician Wellness Academy + Women's Wellness

HFMA & AAPL Health Care Finance Academy

Quality Improvement Academy

Health Informatics Academy

Sponsors



WiFi SSID:
Renaissance_CONF

WiFi Password:
ImagemoverMD

Fundamentals of Physician Leadership

January 24–26

WINTER ²⁰¹⁹
INSTITUTE

Class 8:00am–4:30pm

Breakfast 7:00am–8:00am

Breaks 9:45am–10:00am & 2:30pm–3:00pm

Lunch 11:30pm–1:00pm

Fundamentals: Influence

January 24

Faculty: Carrie Kish, CPCC

Fundamentals: Negotiation

January 25

Faculty: Amanda Weirup, MBA, PhD

Leadership Journey: Your Blueprint (bundle only)

January 26 — 8:00am–11:30am

After attending these two live courses, you'll go over the tools and techniques you have learned with your physician leader peers.

CMO Academy

January 24–26

WINTER 2019
INSTITUTE

Class 8:00am–4:30pm

Breakfast 7:00am–8:00am

Breaks 9:45am–10:00am & 2:30pm–3:00pm

Lunch 11:30pm–1:00pm

Faculty:

Jonathan Burroughs, MD, MBA, FACHE, FAAPL

Richard Priore, ScD, MHA, FACHE, FACMPE

Are you an aspiring, new, or experienced chief medical officer? Expert faculty will provide you with tools that can help you promote safety, hold productive meetings, inspire teamwork, and change the overall culture and behavior at your health care organization.

Post-conference webinar: February 6th @ 2 pm EST

Population Health Series

January 24

WINTER 2019
INSTITUTE

Class 8:00am–4:30pm

Breakfast 7:00am–8:00am

Breaks 9:45am–10:00am & 2:30pm–3:00pm

Lunch 11:30pm–1:00pm

Faculty:

David Nash, MD, MBA

Population health isn't just a concept – it's a way to run your organization and provide high-quality patient care.

This course is the perfect opportunity to discuss with other physician leaders why an organization would move from a volume-based to a value-based model and how this benefits an organization, its providers, and its patients.

Post-conference webinar: February 7th @ 12 pm EST

ONLINE COURSE

Adapt with ease.



Embracing Change

This online course provides practical strategies to encourage and support adaptability and resilience during times of change. Through real-world examples, you'll have an opportunity to explore potential concerns and solutions while improving your attitude toward change.

VISIT [PHYSICIANLEADERS.ORG/CHANGE](https://www.physicianleaders.org/change)



Physician Wellness + Women's Wellness

January 25–27

WINTER
INSTITUTE 2019

Class 8:00am–4:30pm

Breakfast 7:00am–8:00am

Breaks 9:45am–10:00am & 2:30pm–3:00pm

Lunch 11:30pm–1:00pm

Physician Wellness Academy

January 25–26

Faculty: Dan Diamond, MD & Dan Friedland, MD

This course will explore a groundbreaking neuroscience and mindfulness-based framework that can help you manage stress and transform burnout into resiliency.

Women's Wellness Bonus Session

January 27

Faculty: Mamta Gautam, MD, MBA, FRCP(C), CCPE, CPE

In this course specially designed for women physicians, you'll explore your unique approach to personal and professional matters and learn how to build up resiliency, combat burnout, and maintain long-term career satisfaction.

January 25–26

WINTER
INSTITUTE 2019

Class 8:00am–4:30pm

Breakfast 7:00am–8:00am

Breaks 9:45am–10:00am & 2:30pm–3:00pm

Lunch 11:30pm–1:00pm

Faculty:

Todd Nelson, FHFMA, MBA

Charles R. Alsdurf, CPA

Katie Gilfillan, MSW

Sandra J. Wolfskill, FHFMA

Understanding the business of health care is everyone's business. And when administrators and clinicians talk the same language, both sides win.

This course will demystify the world of healthcare finance while advising you on how to best manage financial resources, reduce costs, and create actionable strategies at your organization.

Post-conference webinar: February 5th @ 1 pm EST

ONLINE COURSE

American Association for
**PHYSICIAN
LEADERSHIP**

Lead & Succeed.



TRANSITION FROM **Management to Leadership**

Medical training programs can fall short when it comes to preparing physicians for future leadership positions. In this course, you'll learn how to successfully transition from a management to a leadership role and how to properly time and stage this transition.

VISIT [PHYSICIANLEADERS.ORG/TRANSITION](https://www.physicianleaders.org/transition)

For Business Professionals with a focus on Medical and Dental Physicians!



insurance products

- Accidental Death and Dismemberment
- Business Overhead
- Dental and Vision
- Disability
- Group and Individual
- Health Insurance
- Long Term Care
- Medical Malpractice Insurance
- Medical Professional Liability
- Supplemental Medicare Insurance
- Term and Whole Life

member discounts

- Access Merchant Everyday Discount Program
- AllHeart™
- American Medical Forensic Specialists
- Board Vitals™
- Health Gorilla™
- HealthyPaws®
- IDShieldSM
- Legal ShieldSM
- Office Depot
- Orion Business Capital
- PennyMac®
- PPS Transport®
- Quantum Design Lab, LLC
- Value Line®



Physicians Planning Service Corp.
550 Fairway Dr, Suite 107, Deerfield Beach, FL 33441



Phone +1 800 221 2168
insurance@assnservices.com • physiciansplanning.com

Quality Improvement Academy

January 25–27

WINTER INSTITUTE 2019

Class 8:00am–4:30pm; January 27: 8am–11:30am

Breakfast 7:00am–8:00am

Breaks 9:45am–10:00am & 2:30pm–3:00pm

Lunch 11:30pm–1:00pm

Faculty:

Bruce Spurlock, MD
Steven Tremain, MD, FACPE

Learn the latest cutting-edge methods and strategies that will help you improve all aspects of your organization from its safety to the overall culture.

You'll participate in three days of lively discussion, hands-on exercises, and action planning, so you can return home with practical and actionable insights designed to improve the quality of your organization.

Post-conference webinar: February 6th @ 12 pm EST

Health Informatics Academy

January 25–27

WINTER INSTITUTE 2019

Class 8:00am–4:30pm; **January 27:** 8am–11:30am

Breakfast 7:00am–8:00am

Breaks 9:45am–10:00am & 2:30pm–3:00pm

Lunch 11:30pm–1:00pm

Faculty:

Bruce Levy, MD, CPE

Richard Taylor MD, CMIO

The era of data in health care is upon us, but many physicians are woefully unprepared for it.

In this two-and-a-half-day course, you'll engage in lively discussion and practical exercises that will not only provide you with a strong foundation in how electronic clinical systems are optimized and maintained, but how this data can improve overall patient care, safety, and organizational operations.

Post-conference webinar: February 6th @ 2 pm EST

WINTER INSTITUTE 2019

Special Events

January 24

11:30am–1:00pm: iHealthSpot, Physician Planning Services, & Bankers Health Group lunch presentations

January 25

6:15am–6:45am: Elevation Corporate Health Morning Fitness - Vinyasa Flow w/ Angela Nichols

11:30am–1:00pm: AAPL Diversity and Inclusion Panel Discussion lunch

5:00pm–6:30pm: Networking reception

January 26

6:15am–6:45am: Elevation Corporate Health Morning Fitness - Fit Camp w/ Micaela Robinson

7:00am–4:30pm: USF Poster Presentations

11:30am–1:00pm: University Partners Lunch Presentation

2019 Leadership Events

2019 **SPRING
SUMMIT**

■ [PHYSICIANLEADERS.ORG/SPRING](https://physicianleaders.org/spring)

WASHINGTON D.C. ■ MAY 3–5 ■ J.W. MARIOTT HOTEL

FALL 2019
INSTITUTE

■ [PHYSICIANLEADERS.ORG/FALL](https://physicianleaders.org/fall)

SCOTTSDALE, AZ ■ NOV 1–5 ■ WESTIN KIERLAND RESORT & SPA

2019 Capstones

May 16–19

July 18–21

Nov. 7–10

Tampa, FL

■ [PHYSICIANLEADERS.ORG/CALENDAR](https://physicianleaders.org/calendar)