



« Shaping Perfect Workspace »

Constructif

Modular Acoustic Space Divider System

Constructif creates acoustically optimal zones for living, working, collaborating and relaxing.

In today's multi-functional and ever-changing workplace, fixed walls are a constraint and solid partitions are quite literally barriers to collaboration. Constructif changes all that. Freestanding or suspended mobile modular frames can be configured – and reconfigured – by the users of the space to create zones to suit the need of the hour.

While the results achieved with Constructif are attractive and sophisticated, the actual build method is remarkably simple, and Constructif is a design medium in itself ideal for defining a focal point or special space.



Constructif
Modular
Acoustic Space
Divider System

Standard Units

Constructif's frame is made from tough, hollow steel as standard. Wooden tower units are also available. Shelving surfaces and backs can be specified in either steel, MDF, our acoustic polyester material Whisper, or a combination of all.

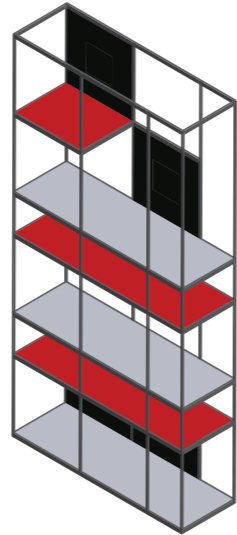

- A.**
H: 2000mm
W: 1000mm **x2**
D: 300mm
- H: 1200mm
W: 1000mm **x1**
D: 300mm
- B.**
H: 1200mm
W: 800mm **x3**
D: 300mm
- C.**
H: 2000mm
W: 1200mm **x2**
D: 300mm
- H: 2000mm
W: 300mm **x1**
D: 300mm
- D.**
H: 2400mm
W: 1200mm **x2**
D: 300mm
- H: 300mm
W: 1200mm **x1**
D: 300mm
- H: 1200mm
W: 1200mm **x1**
D: 300mm

STANDARD CONFIGURATIONS

A

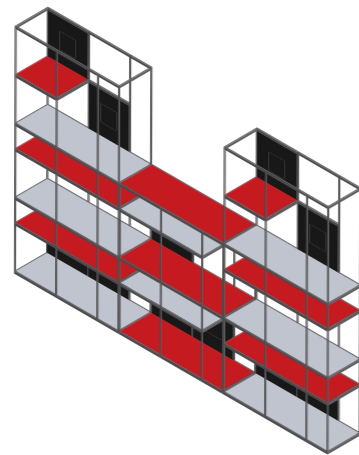

B

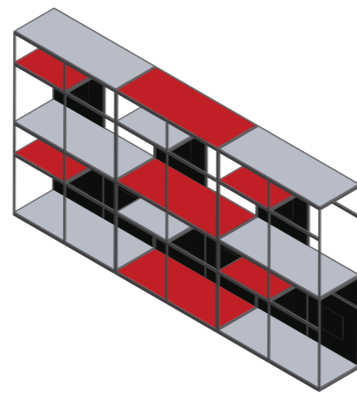

C

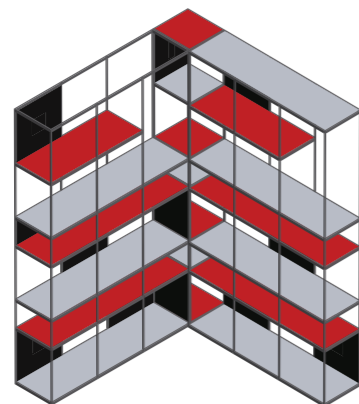

D

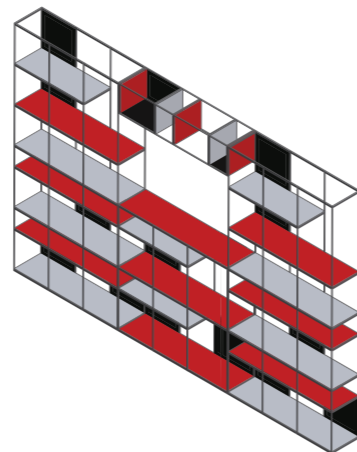

Constructif
Modular
Acoustic Space
Divider System

Frame Only Units

Frame only units can be combined with standard units, or used on their own to create seclusion zones with endless configuration options. Please note that frame only panels must have end-sections when they are not fixed at either end to standard units.

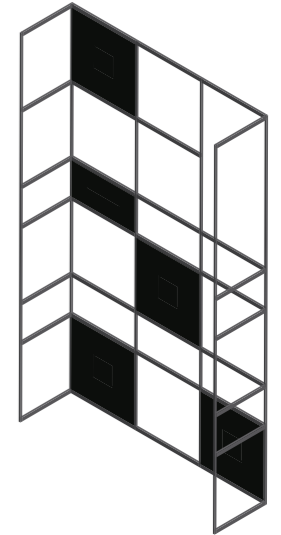

- A.**
H: 1200mm
W: 1200mm **x2**
D: 300mm
- H: 1200mm
W: 1200mm **x2**
*Frame only
- H: 1200mm
W: 800mm **x2**
*Frame only
- B.**
H: 1200mm
W: 1200mm **x2**
D: 300mm
- H: 1200mm
W: 1200mm **x2**
*Frame only
- H: 1200mm
W: 300mm **x1**
D: 300mm

FRAME ONLY UNITS - STANDARD CONFIGURATIONS

A

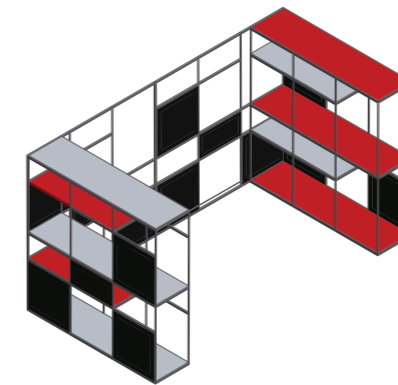

B

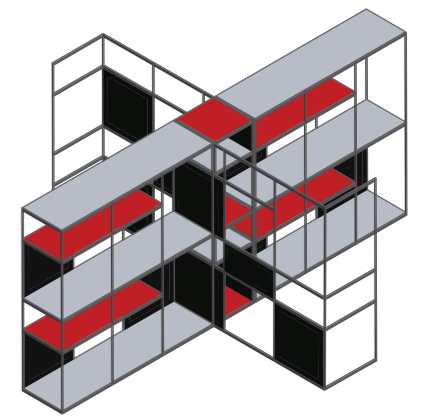

Sliding Units

Constructif units don't have to be static – our market-leading twin-point moving wall track can be installed along with sliding Constructif units to allow for space flexibility.

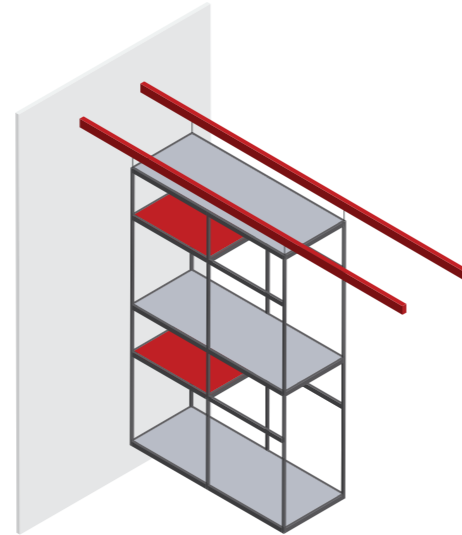

TRACK OPTIONS

At Creatif we understand the need for flexible space, and have been a leading installer of UK-manufactured moving walls for over 10 years – so we decided to make Constructif available on a ceiling track for space to be configured using movable units.

All Constructif units require four rollers (points of suspension) and two parallel ceiling tracks.

To the right is a section detail drawing of the track and roller used.

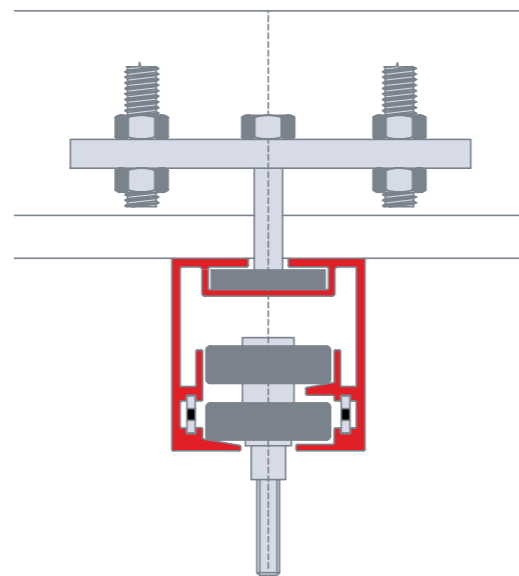

Stadia

In addition to providing space flexibility, Constructif also allows for incorporating seating – called Stadia. As with other unit types, endless configurations are possible – just use your imagination...

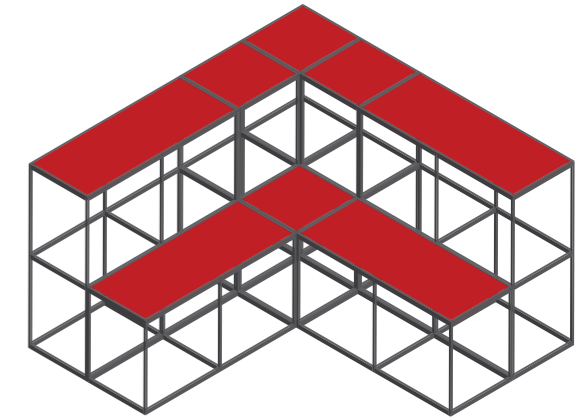

SIZES

A.
H: 820mm
W: 790mm
D: 590mm

B.
H: 820mm
W: 590mm

C.
H: 820mm
W: 790mm
D: 880mm

D.
H: 820mm
W: 880mm

A

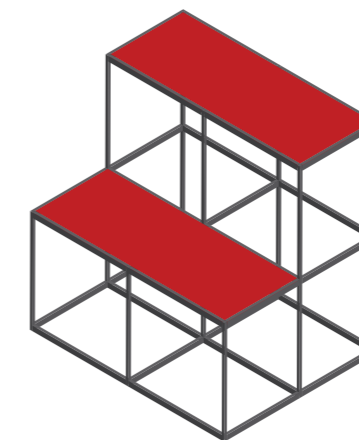

B

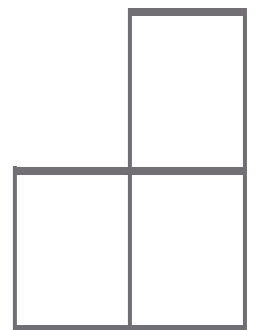

C

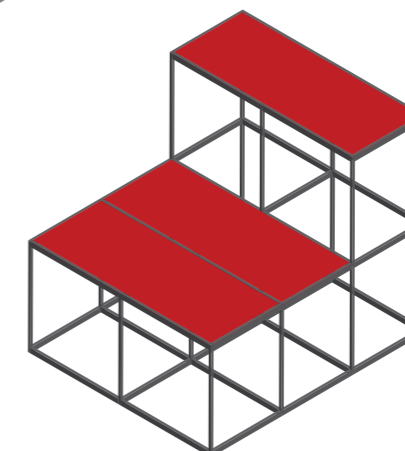

D

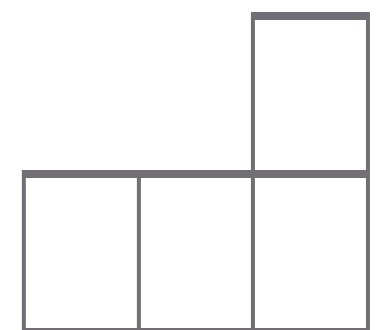

Accessories

Constructif's accessories are all bespoke, made by hand and are the perfect size to fit straight into the all units.

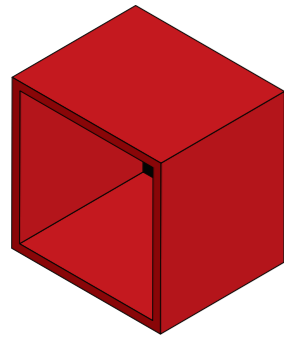

Shelf Boxes

Made from steel, MDF or our acoustic polyester Whisper material.

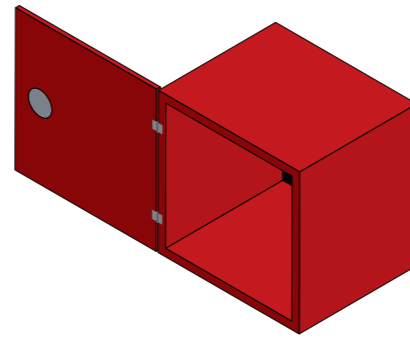

Shelf Cupboards & Lockers

Cupboards made from steel or MDF, with lockable options are also available.

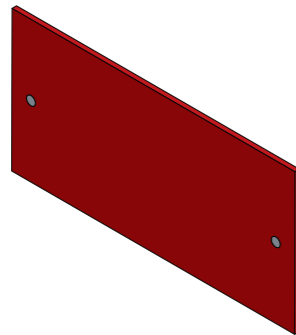

Removable Back Panels

Made from steel, MDF or our acoustic polyester Whisper material, with powerful magnetic dots. Specify as many or as few Whisper panels as you need.

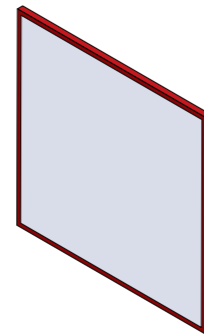

Drywipe Panels

Turn the back of your shelving accessories into writable surfaces.

FIXING METHODS

Constructif units are designed to be fixed together and taken apart with ease. Our super strong magnets ensure Constructif units of all shapes and sizes can be bolted together for an endless amount of configurations.

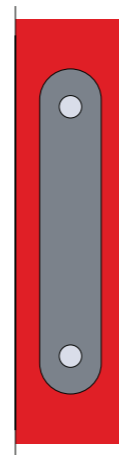

Contact us for a
Whisper sample card,
or see our Whisper
brochure for more
information.
For special frame
finishes, please
contact us.

Colour Options

Whisper Polyester Acoustic Panel Colour Options

Constructif's shelving surfaces, back panels and box accessories can be supplied in our acoustic polyester Whisper material.

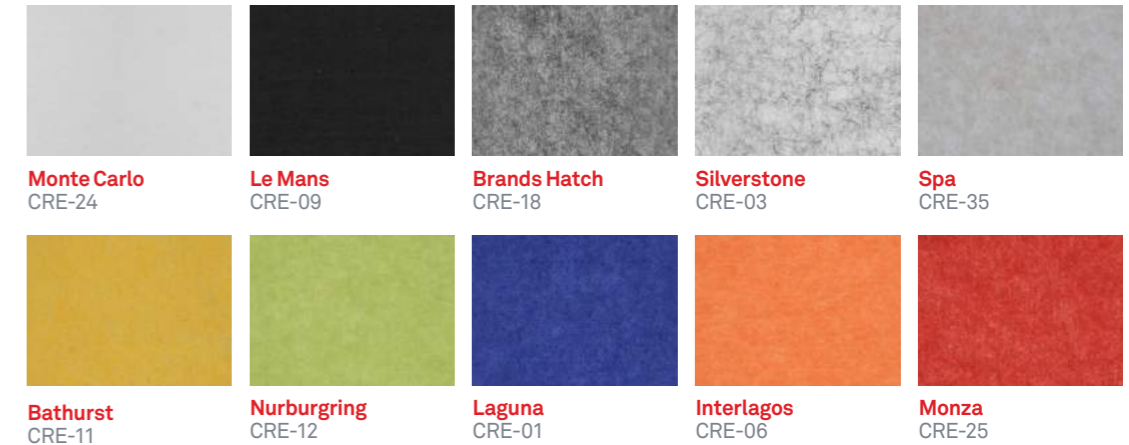

Frame & Fill Section Colours

Constructif's metal components have an endless choice of colours.

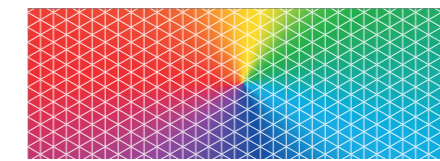

Painted to any RAL colour

MFC

Hand-crafted joinery can also form part of Constructif's makeup if desired. Shelving surfaces, back-panels and box accessories can all be specified in MFC, as well as free-standing tower units.

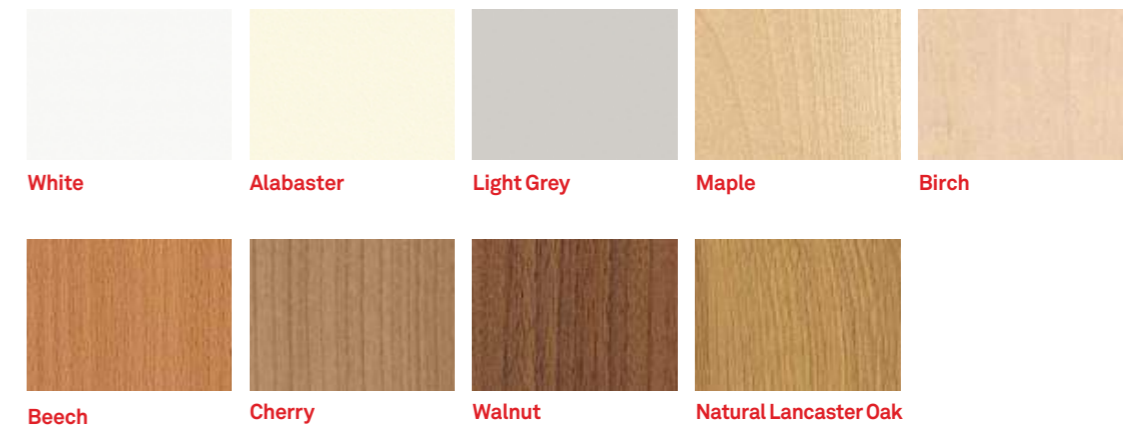

Whisper – Polyester Acoustic Panels

Shelf surfaces and back panels can be specified in our acoustic polyester Whisper material. Specify as many or as few Whisper panels as you need.

Acoustic Performance

Whisper is specifically designed to reduce and control reverberated (echo) noise in building interiors. Minimum Noise Reduction Coefficient 0.55.

Product Specs

Composition: 100% Polyester Fibre (PET)

Panel Dimensions: 1200mm x 2400mm (+5mm) (+10mm)
Thickness: 12mm + 24mm

Weight: 2400gsm 4800gsm
Density: 200kg/m³

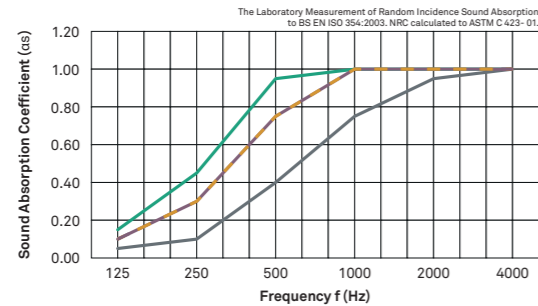

Frequency (Hz)	125	250	500	1000	2000	4000	NRC
12mm Whisper	0.05	0.10	0.40	0.75	0.95	1.00	0.55
12mm Whisper (Air Gap)	0.10	0.30	0.75	1.00	1.00	1.00	0.75
24mm Whisper	0.10	0.30	0.75	1.00	1.00	1.00	0.75
24mm Whisper (Air Gap)	0.15	0.45	0.95	1.00	1.00	1.00	0.85

Fire Ratings (Conducted on 12mm Whisper)

ISO 9705: 1993

Classification: Group 1-S
Smoke Production Rate: <5.0m²/s. As required by NZBC C/VM2

AS ISO 9705 - 2003

Classification: Group 1 (SMOGR_{arc}): <100m²/s²
As required by BCA C1.10 FI 4974 dated 16th September, 2012
EN13501-1:2007+A1:2009 B - s2, d2
WF 336911 dated 25th February, 2014

ASTM E-84-14

Class A, FS:0 - SD:45
RJ4479-2 dated 25th January, 2015

Thermal Performance

Whisper 12mm R0.41 (@15°C)
Whisper 24mm R0.82 (@15°C)

Impact Resistance

Whisper has been tested for impact resistance to EN13964:2004 and meets the criteria of Class 1A; not adversely affected at impact velocities over 16.5m/s.

VOC Emissions

Creatif polyester has been tested by Cetec Pty Ltd (Report: CV080408) for chemical emission and is classified as low VOC. VOC concentration: 0.01 mg/m³

Moisture Absorption

Polyester fibre when exposed to an atmosphere of 50°C at 90% relative humidity for four days showed moisture absorption of less than 0.03% by weight. Polyester is not affected by moisture, mould or mildew and will not rot or deteriorate in intended use situations.

Environmental

Creatif is committed to best practice through our ISO 9001 and ISO 14001 certified Quality and Environmental Management Systems. Whisper products contains a minimum of 65% previously recycled polyester fibre (from PET bottle-flake) ensuring comparatively low embodied energy Off-cuts and manufacturing waste is re-used or recycled wherever possible.

Uncontaminated Whisper can be recycled.

Whisper is manufactured from 100% polyester fibres and does not contain formaldehyde binders. Creatif polyester fibres support safer indoor air quality and will not become a potential airborne pollutant.

300mm Width Units

From left to right;

A.
300mm (W) x 800mm (H) x 300mm (D)

B.
300mm (W) x 1200mm (H) x 300mm (D)

C.
300mm (W) x 1600mm (H) x 300mm (D)

D.
300mm (W) x 2000mm (H) x 300mm (D)

E.
300mm (W) x 2400mm (H) x 300mm (D)

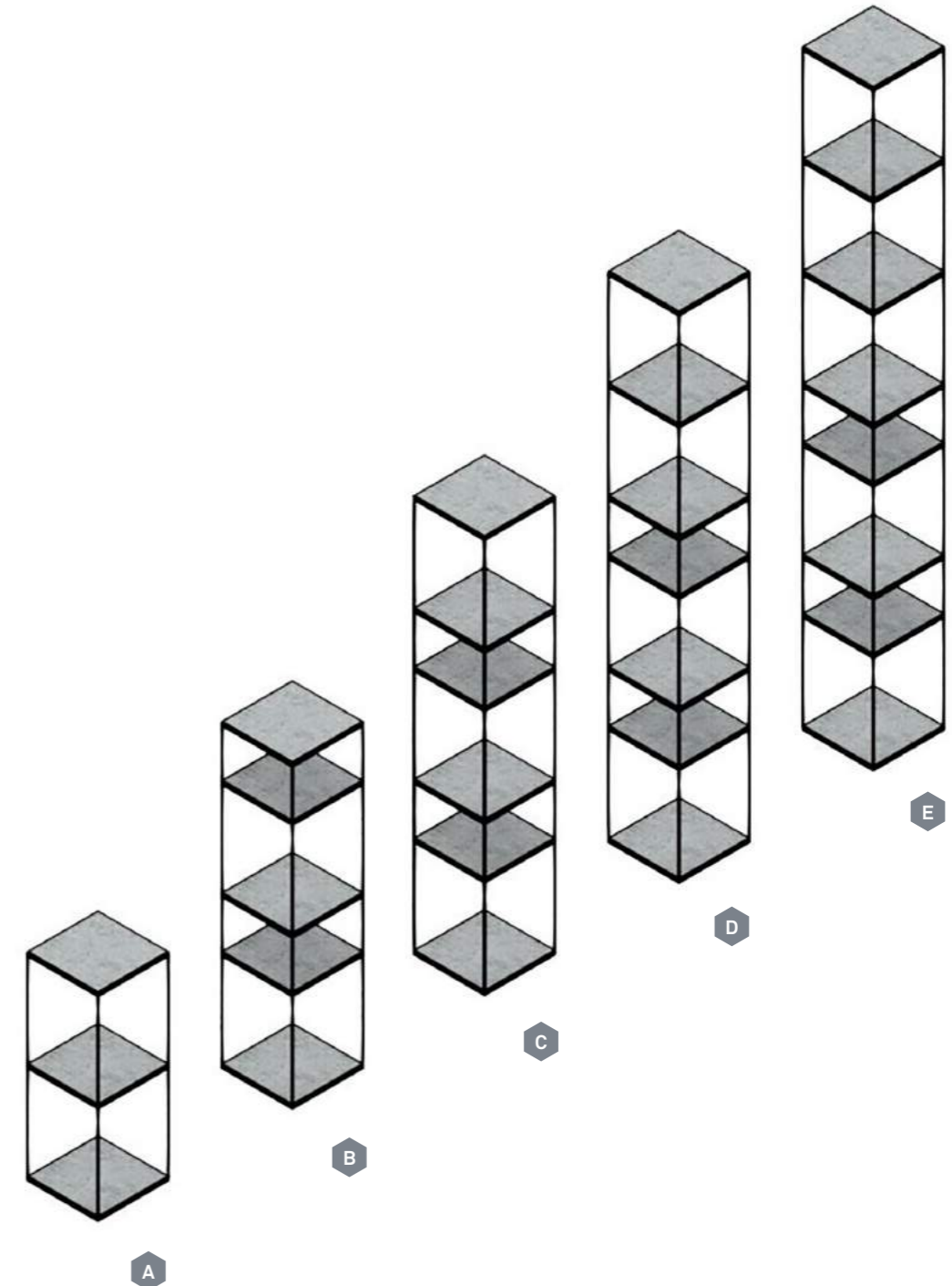

Constructif
Modular
Acoustic Space
Divider System

800mm Width Units

From left to right;

A.
800mm (W) x 400mm
(H) x 300mm (D)

B.
800mm (W) x 600mm
(H) x 300mm (D)

C.
800mm (W) x 800mm
(H) x 300mm (D)

D.
800mm (W) x 1200mm
(H) x 300mm (D)

E.
800mm (W) x 1600mm
(H) x 300mm (D)

F.
800mm (W) x 2000mm
(H) x 300mm (D)

G.
800mm (W) x 2400mm
(H) x 300mm (D)

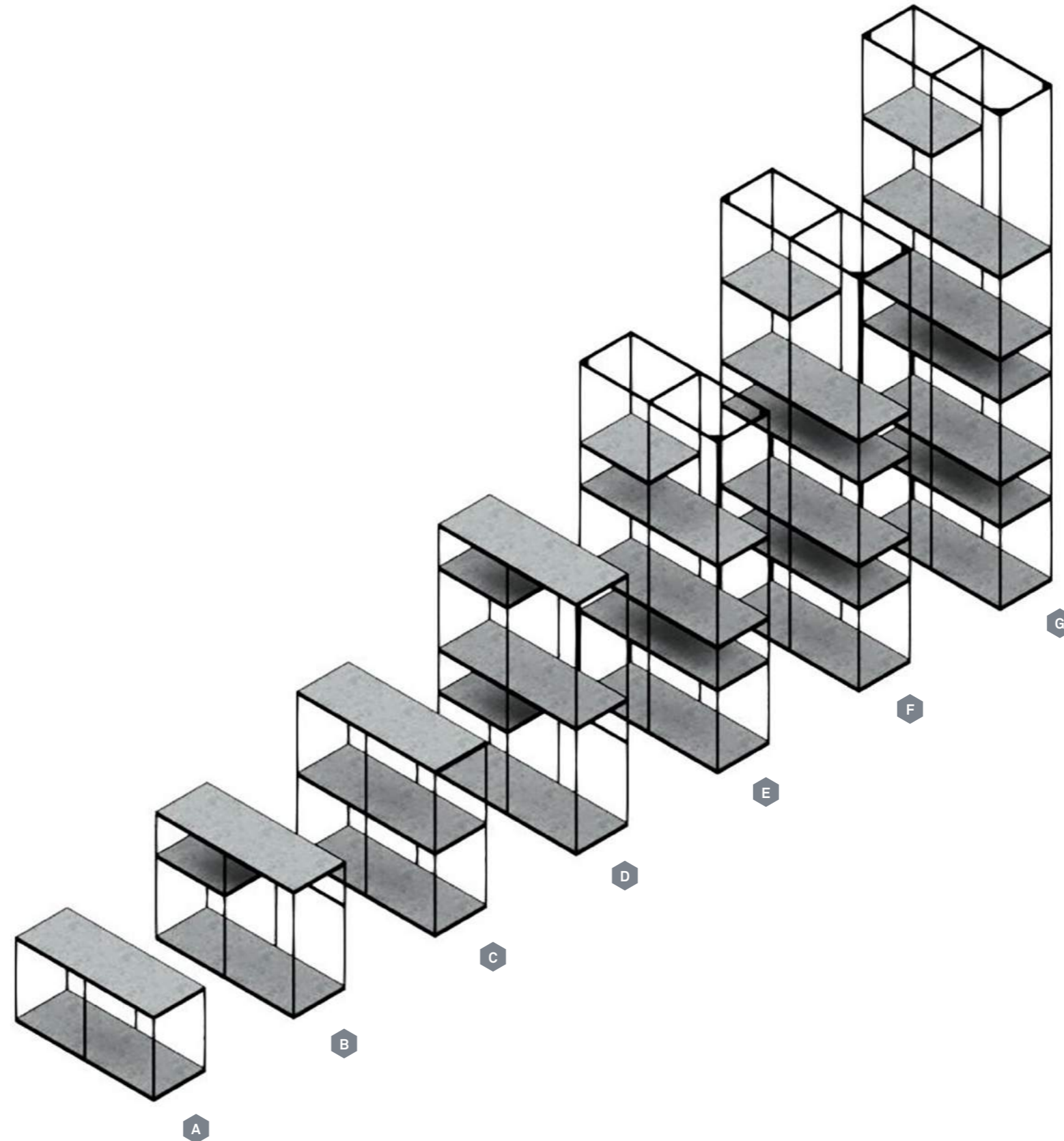

Constructif
Modular
Acoustic Space
Divider System

1000mm Width Units

A.
1000mm (W) x 400mm
(H) x 300mm (D)

B.
1000mm (W) x 600mm
(H) x 300mm (D)

C.
1000mm (W) x 800mm
(H) x 300mm (D)

D.
1000mm (W) x 1200mm
(H) x 300mm (D)

E.
1000mm (W) x 1600mm
(H) x 300mm (D)

F.
1000mm (W) x 2000mm
(H) x 300mm (D)

G.
1000mm (W) x 2400mm
(H) x 300mm (D)

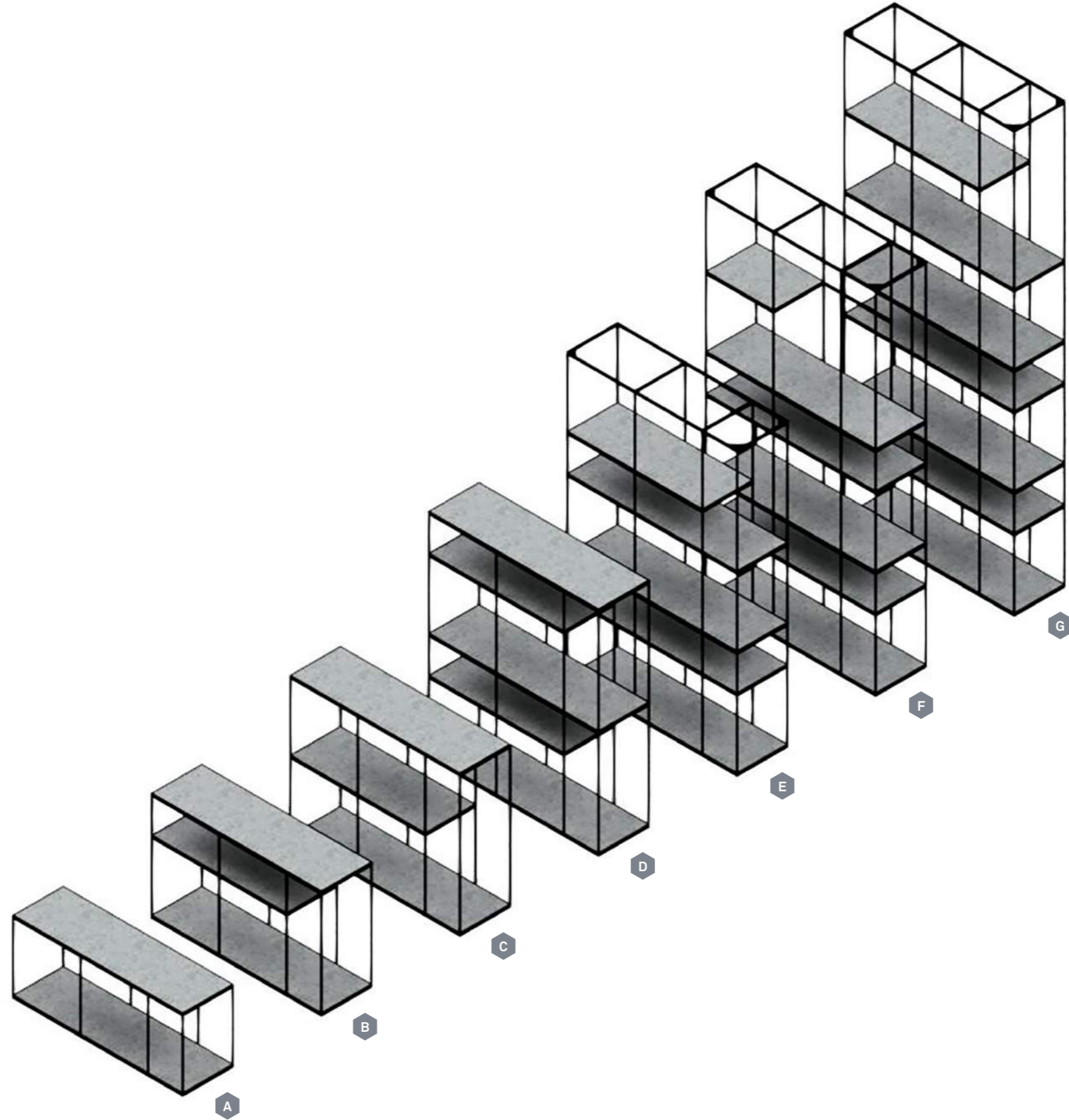

From left to right;

A.
1200mm (W) x 400mm
(H) x 300mm (D)

B.
1200mm (W) x 600mm
(H) x 300mm (D)

C.
1200mm (W) x 800mm
(H) x 300mm (D)

D.
1200mm (W) x 1200mm
(H) x 300mm (D)

E.
1200mm (W) x 1600mm
(H) x 300mm (D)

F.
1200mm (W) x 2000mm
(H) x 300mm (D)

G.
1200mm (W) x 2400mm
(H) x 300mm (D)

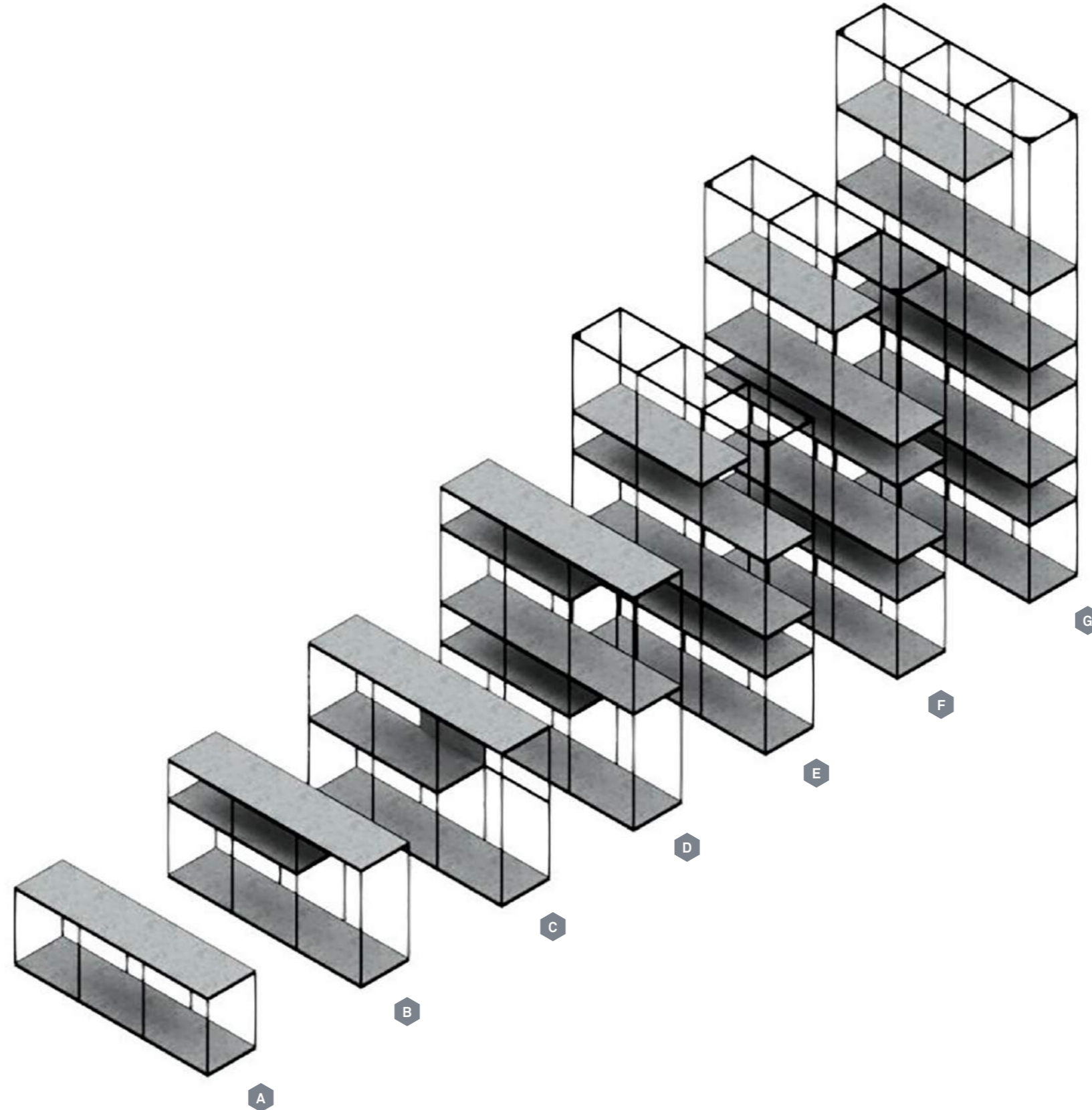



USPs

- » Felt shelves, panels and storage for acoustic comfort.
- » Infinite frame and felt panel colour combinations.
- » Freestanding, mobile, suspended and frame-only modules.

- » Comes ready built up for speedy install.
- » Made in the UK.
- » 100% recyclable.



Head Office
Unit 2, Hunslet Business Park,
National Road, Leeds LS10 1TE

London Showroom
79 Clerkenwell Road
London, EC1R 5AR

T +44 (0) 113 270 1239
F +44 (0) 113 239 1672
E info@creatif.org.uk

www.creatif.org.uk