

E155 INCREMENTAL ENCODER MOUNTING PROCEDURE:

1. PLACE THE ADAPTER OF ENCODER ONTO THE MOTOR REAR END PLATE.
2. INSTALL CENTERING TOOL ON MOTOR SHAFT TO CENTER THE ADAPTER WITH RESPECT TO THE SHAFT.
3. INSTALL HARDWARE SUPPLIED AND TIGHTEN TO SECURE THE ADAPTER. REMOVE CENTERING TOOL.
4. POSITION AND MOUNT THE ENCODER HOUSING ONTO THE ADAPTER WITH ITS 3 X 120° BAYONETSNAPS IN THEIR CORRESPONDING SLOTS. BE SURE THE ENCODER IS IN THE FULL COUNTERCLOCKWISE DIRECTION ON THE ADAPTER LEGS. THIS IS THE GAPPING POSITION 1.
5. PLACE THE HEX WRENCH INTO THE CODEWHEEL SET SCREW. TIGHTEN THE SET SCREW WHILE PUSHING THE CODEWHEEL DOWN.
6. PUSH DOWN AND TWIST THE ENCODER 30° CLOCKWISE TO LOCK IT IN PLACE AT POSITION 2.

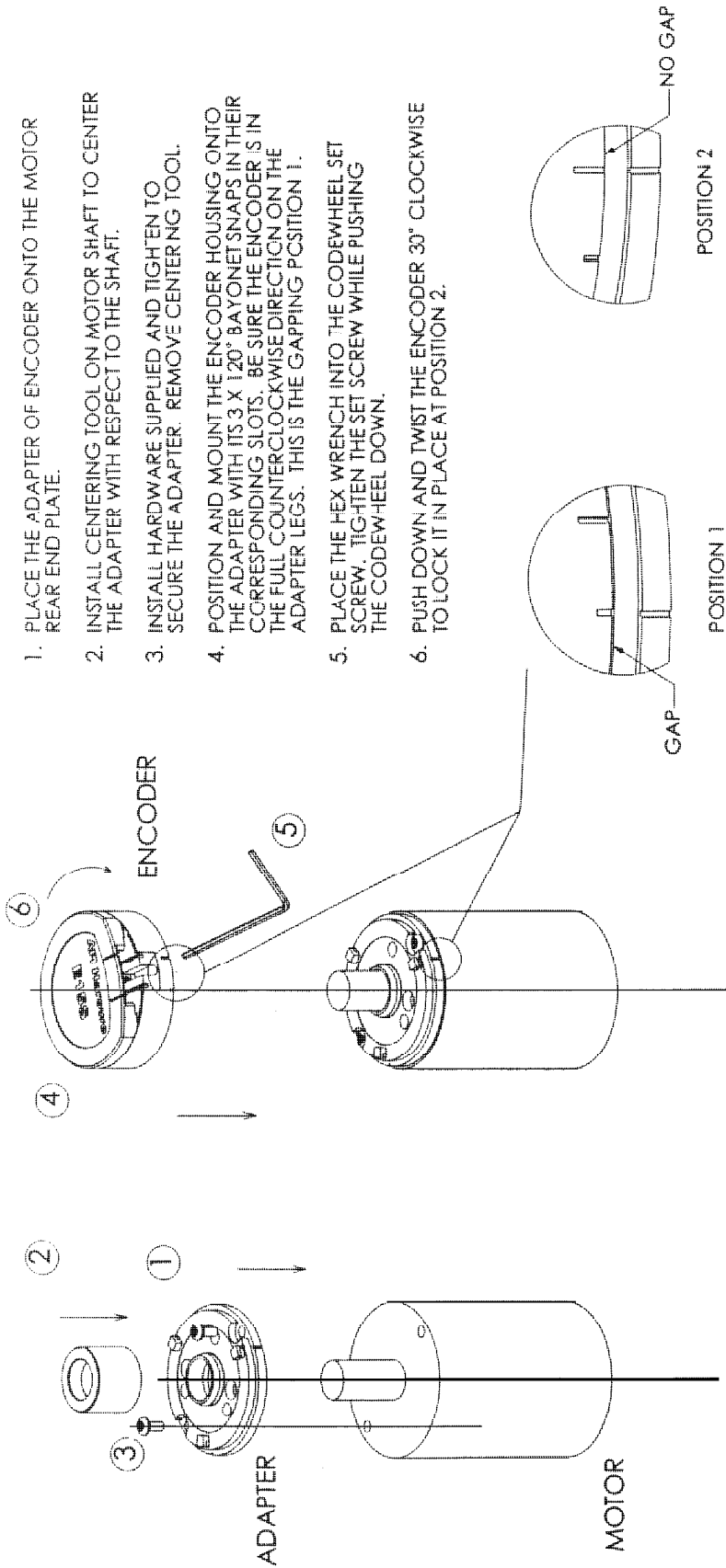

THIS DRAWING HAS BEEN CREATED BY CAD. DO NOT MANUALLY REVISE OR UPDATE.	TOLERANCING		DATE		APPR	CHG		REVISION	DATE	APPR	
	Tolerancing Complies with ANSI/ASME Y14.5M-1994										
API Harrowe WEST CHESTER, OH 43882			E155			E155			A		
PROPERTY RIGHTS OF API HARROWE ARE INCLUDED IN THE INFORMATION DISCLOSED HEREIN. DO NOT DUPLICATE OR DISCLOSE TO THIRD PARTIES WITHOUT WRITTEN PERMISSION OF API HARROWE.			MATERIAL: N/A			FINISH: N/A					
NET WT: .55			MATERIAL: N/A			FINISH: N/A					
DATE: AL 9/27/99			DATE: DEB 9/27/99			DATE: MCP 10/4/99					
BY: A. LEUNG			BY: DEB			BY: MCP					
CHECKED: AL 9/27/99			CHECKED: DEB 9/27/99			CHECKED: MCP 10/4/99					
DATE: AL 9/27/99			DATE: DEB 9/27/99			DATE: MCP 10/4/99					
SCALE: 1:1			SCALE: 1:1			SCALE: 1:1					
DWG NO.: DCUS-005			DWG NO.: DCUS-005			DWG NO.: DCUS-005					
REV: A			REV: A			REV: A					