

CPL COUPLINGS

Dynapar™ brand

Flexible Shaft Couplings

Key Features

- **Maximum Mechanical, Thermal, and Electrical Protection for Encoder Shaft Connections**
- **Three-Beam Helical Design Restricts Torque “Windup”**
- **Clamp Attachment. No Setscrews to Score or Pit Shafts**
- **Full Range of Models Designed To Match Specific Encoders are Supplied with Shaft Size Adaptors**



SPECIFICATIONS

STANDARD OPERATING CHARACTERISTICS

Predicted life: Tested in accordance with MIL-HDBK-5A for infinite life.

Material: 2024-T3.5 QQA225/6 aluminum with MIL A8625 Type II black anodize.

Insert/insulator: G10 glass filled phenolic. Sizes provided per *Models table, Secondary Bore*.

Clamps: Integral at each end, with black oxide finish hex socket cap screws. Grip is secure to peak torque rating of the coupling per *Models table, Peak Torque*.

Peak Torque: Per *Models table, Peak Torque*. Safety factor should be determined considering acceleration and deceleration loads, etc.

APPROXIMATE DIMENSIONS

Refer to Models Table for dimensions of specific models.

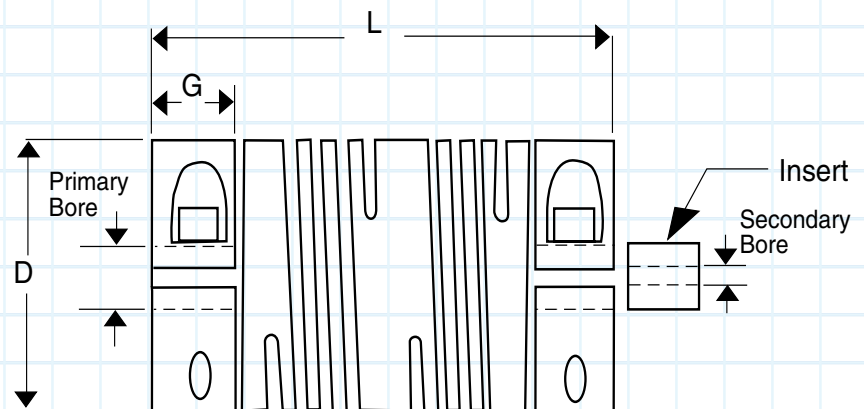

Shafts may extend beyond the clamp-grip-area to within the flexure area, but must not butt.

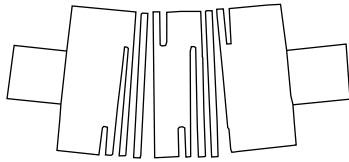

Angular Misalignment

When the center lines of the shafts extend and form an obtuse angle. The intersection of this obtuse angle should be at the center of the flexible beam area.

Proper shaft coupling protects precision encoders from all of these common hazards. Use of a well engineered coupling can save many times its cost by eliminating failures due to excessive shaft loading, electrical leakage, and thermal stress.

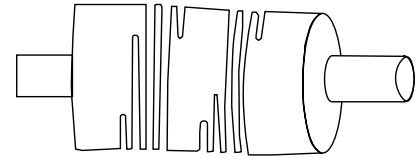

Skewed Misalignment

The shafts are not in the same plane. Center line extension is not parallel or intersecting. There can be two obtuse angles of varying degrees. These angles should be centered within the coupling.

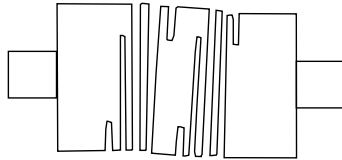

Parallel Misalignment

The shaft's center lines are parallel but offset. When the coupling is installed there should be two equal obtuse angles within the coupling.

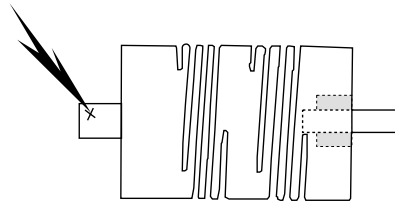

Electrical and Thermal Stress

The supplied insulator insert blocks transfer of static charges, leakage currents, and heat to the encoder. These stresses have been proven to be contributory to bearing damage as well as electrical failures.

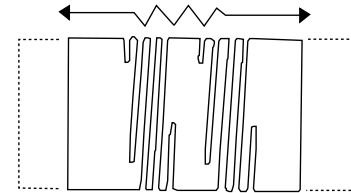

Axial Motion

Motion in the direction of the center lines of the shafts, such as motor shaft "thrust". Usually created by loose bearings or other elements that do not restrain the motion.

ORDERING INFORMATION

Coupling Model Numbers should be selected first by Encoder Application duty, then by specific encoder shaft size and drive shaft size. Most applications will use the Primary Bore as the encoder end, but it is permissible to reverse the coupling to accommodate specific shaft combinations. Each coupling is supplied with Secondary Bore insulator inserts as listed.

Model Number	Primary Bore	Secondary Bore	Dimensions			Maximum Misalignment			Peak Torque (lb. - in.)	Encoder Application (Series)
			D= Dia.	L= Len.	G= Grip	Angular	Parallel	Axial		
CPL00750125	1/8	1/8, 3/16	0.750	0.875	0.230	3°	0.020	0.035	35	Very Light Duty E12, E14,
CPL00750187	3/16	3/16, 1/4								
CPL00750250	1/4	1/8, 1/4								
CPL01000187	3/16	3/16, 1/4	1.000	1.250	0.290	5°	0.025	0.060	45	Light Duty E14, E23, H42, H25, 22 NexGen
CPL01000250	1/4	1/4, 3/8								
CPL01000375	3/8	3/16, 3/8								
CPL01250250	1/4	1/4, 3/8	1.250	1.250	0.348	7°	0.038	0.060	75	Medium Duty H42, H25, 60, 60P 22 NexGen
CPL01250375	3/8	3/8, 1/2								
CPL01250500	1/2	1/4, 1/2								
CPL01500375	3/8	3/8, 1/2	1.500	1.500	0.400	10°	0.035	0.060	100	Heavy Duty 60, 60P H25, X25
CPL01500500	1/2	1/2, 5/8								
CPL01500625	5/8	3/8, 5/8								
CPL02000875	7/8	3/8, 5/8	2.000	2.000	0.450	10°	0.040	0.060	300	Extra Heavy Duty H25, 60P
CPL02001000	1	3/8, 5/8								
CPL02001125	1 1/8	3/8, 5/8								
CPLM1000250	1/4	4, 5, 6 mm	1.000	1.250	0.290	5°	0.025	0.060	45	Light Duty E12, E14, E23, H25, 22 NexGen
CPLM1250375	3/8	6, 8, 10 mm	1.250	1.250	0.348	7°	0.038	0.060	75	Medium Duty H42, H25 22 NexGen
CPLM1500500	1/2	6, 8, 10 mm	1.500	1.500	0.400	10°	0.035	0.060	100	Heavy Duty 60, 60P

- Note:**
1. For extremely high acceleration rates, consider using the next larger coupling size.
 2. When coupling an encoder to a shaft which is stepped down from a larger size, always use a heavy-duty or extra-heavy-duty coupling.
 3. For maximum life, encoders must be installed and aligned such that the encoder shaft to driving shaft alignment is within the 0.003" TIR NEMA standard despite the maximum misalignment specified.



Worldwide Brands: NorthStar™ • Dynapar™ • Hengstler™ • Harowe™

DYNAPAR
INNOVATION - CUSTOMIZATION - DELIVERY
WWW.DYNAPAR.COM

Headquarters: 1675 Delany Road • Gurnee, IL 60031-1282 • USA

Customer Service:
Tel.: +1.800.873.8731
Fax: +1.847.662.4150
custserv@dynapar.com

Technical Support
Tel.: +1.800.234.8731
Fax: +1.847.662.4150
northstar.techsupport@dynapar.com

European Sales Representative
Hengstler GmbH
Umlandstrasse 49, 78554 Aldingen
Germany
www.hengstler.com