

2019 Audi Q8

Towing & Roadside Information

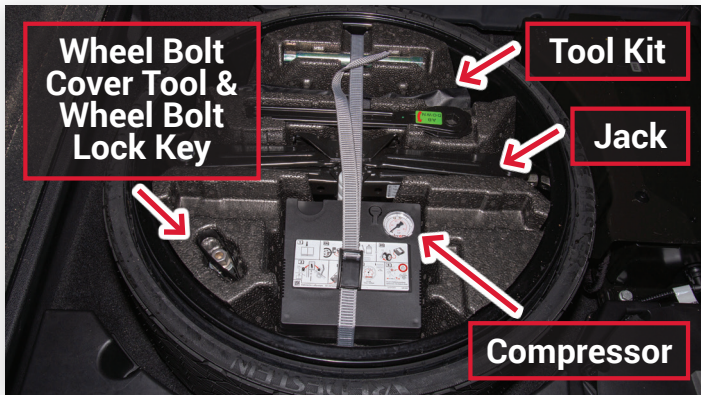

The roadside kit is located in the back of the collapsible spare tire.



Roadside kit.



Connect the air line to valve stem. Plug in the compressor to the power point in the cargo area.



Fill the tire to the recommended tire pressure specification.



Press the top of the front eyelet cover to remove.

Front Eyelet Only

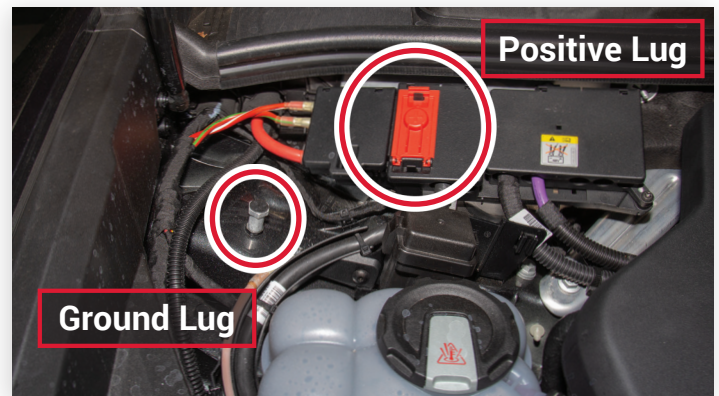

Jump Start procedure