



Liftmaster Chamberlain MyQ Garage Door Opener Integration Release Notes

Content

- Introduction...1
- Installing MyQ...2
- Connecting MyQ to ClareHome...2
- Configuring MyQ in ClareHome...4
- Creating Scenes with MyQ...8
- Creating Automations with MyQ...12
- Using the controls in the ClareHome app...16
- Contact information...16

Last modified: 05/02/18

Introduction

The Liftmaster Chamberlain MyQ enabled garage door openers are now supported in ClareHome. The MyQ garage door openers are position-aware and provides both audible and visual warnings prior to remotely activating garage door movement. This integration allows ClareHome users to control their garage door from their Android smartphone or iOS device.

Notes

- To determine if your Liftmaster/Chamberlain garage door is compatible with ClareHome, see <https://www.chamberlain.com/smartphone-control-products/smartphone-connectivity>.
- This integration requires a paid service from MyQ.
- It is recommended that the homeowner create and subscribe the MyQ service.
- Liftmaster/Chamberlain prevent MyQ devices from being used in Schedules.

Installing MyQ

Only qualified installation technicians should install the MyQ garage door opener. Refer to the installation instructions that came with your device. Clare Controls does not assume any responsibility for damages caused by improper installation or connection to the network. Register your MyQ device on the Chamberlain MyQ website before adding and configuring the device using ClareHome.

Connecting MyQ to ClareHome

Connecting MyQ to your ClareHome project requires the home owner to create a Liftmaster/Chamberlain MyQ account and subscribe to their service usage. Once an account is created and subscription select, an installer or home owner can authorize the MyQ devices in ClareHome.

To create a Liftmaster/Chamberlain MyQ account:

1. Open your web-browser, and then browse to the MyQ website.

<https://www.myliftmaster.com>

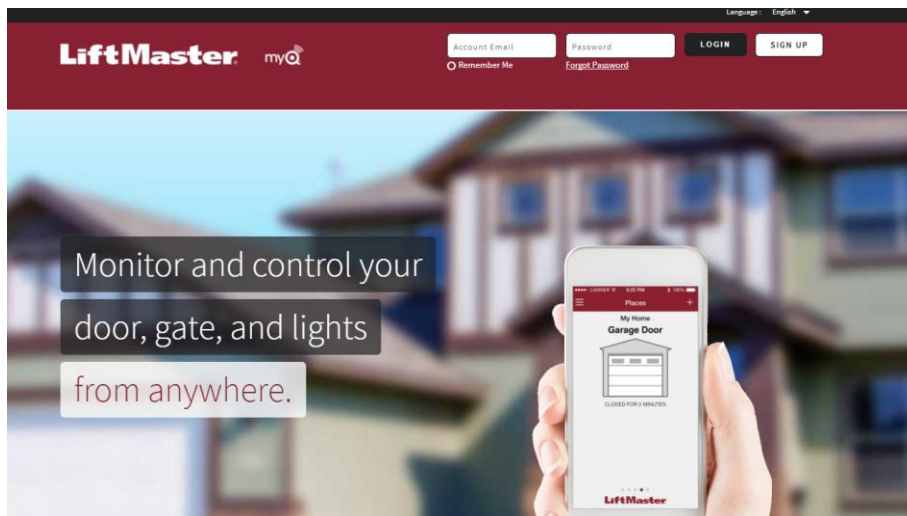

2. Click **SIGN UP**.
3. Fill out the form and confirm your account.
4. Once the account is created, subscribe to the MyQ service.

To subscribe to the MyQ service:

Note: This integration requires a paid service from MyQ.

1. Open your web-browser, and then browse to the MyQ service website.

<https://www.myqservices.com>

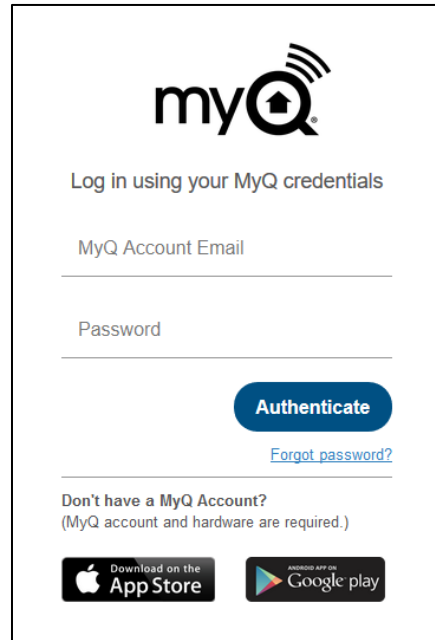

2. Enter the credentials for your Liftmaster/Chamberlain MyQ account, and then click **Authenticate**.
3. Select a subscription.

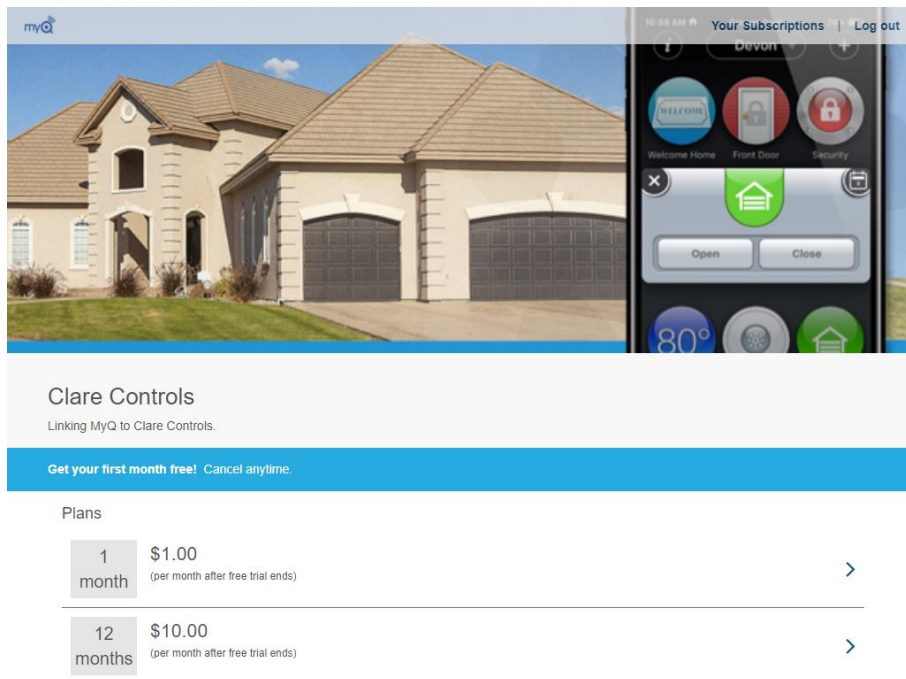

4. Complete the subscription form.

CREDIT CARD INFO

Card Number

MM YYYY CVV

Coupon Code

BILLING ADDRESS

First Name Last Name

Address City

State ZIP Code

Select Country

Due Now
Original plan price:
Estimated tax:
Applied coupon:
Order total:

Due After Trial Ends
Original plan price:
Estimated tax:
Applied coupon:
Order total:

5. Click **PLACE ORDER**, and then add your devices to your ClareHome account.

Configuring MyQ in ClareHome

Once you have installed and setup the MyQ device using the Chamberlain MyQ app, add and configure it with Clare Controls Install Assist (for installers) or the ClareHome app.

Notes

- Internet connection is required when adding a MyQ device. It cannot be added when the CLIQ.mini is in AP mode.
- You will need the Liftmaster Chamberlain MyQ account's credentials.
- When modifying your MyQ subscription after your MyQ device is added to ClareHome, you may need to exit the Configuration menu to view changes. It may take several minutes for MyQ Subscription changes to take effect.

To add a MyQ device using the Install Assist or ClareHome app:

1. Access the Clare Controls Install Assist app, and then tap **Add/Configure Devices**.

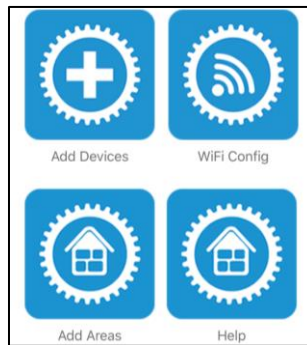

– or –

Access the ClareHome app's Mega Menu, and then tap **Devices**.

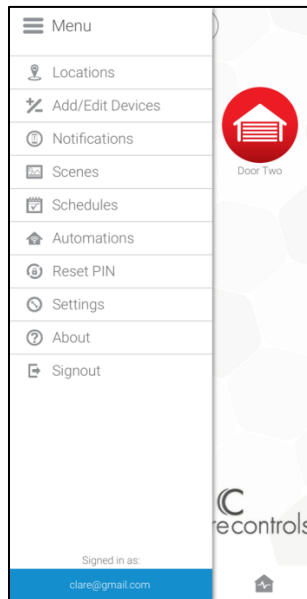

2. Tap the **Plus** icon  to add a new device, and then tap **Access**.

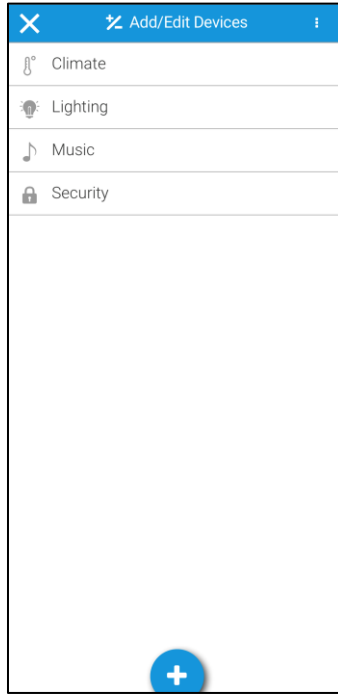

3. Tap **Chamberlain – MyQ Garage Door**.

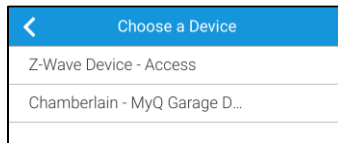

4. Read the displayed Device Authorization message, and then tap **Authorize Device**.

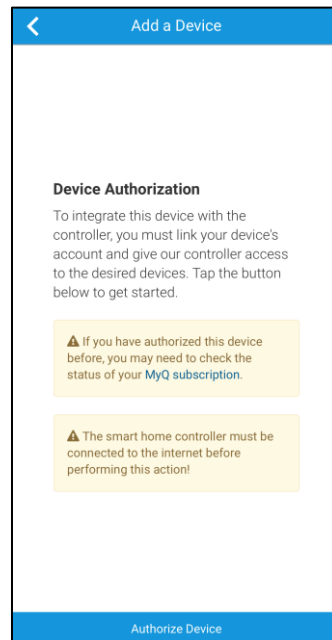

The Chamberlain authorization page displays.

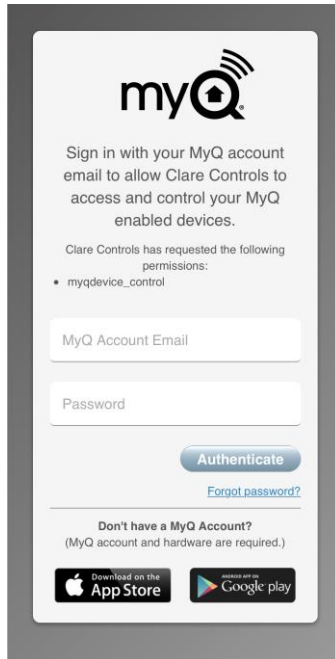

5. Enter your MyQ credentials, and then tap **Authenticate**.

Once the device(s) are authorized, a success message displays.

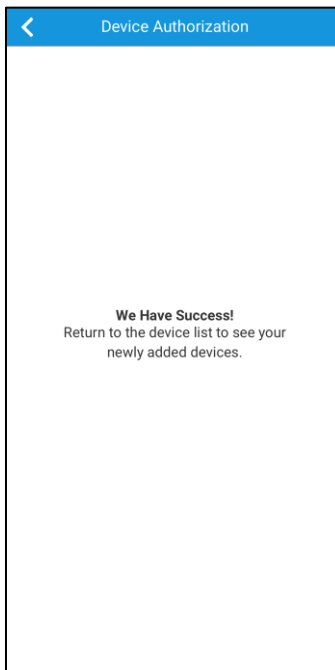

6. Access your garage door in the ClareHome app.

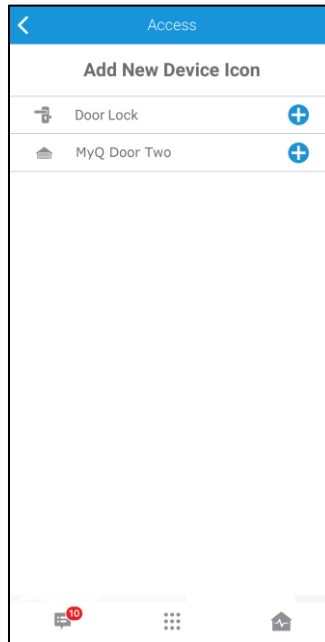

Creating Scenes with MyQ

Configure a Scene with your garage door. The example below walks through the creation of a lock up Scene, shutting the garage door and setting the alarm.

Note: The MyQ device cannot be set to open in a Scene. For security purposes, the device can only be opened when tapping the device and selecting open.

To create a lock up Scene:

1. Access the ClareHome app's Mega Menu, and then tap **Scene**.

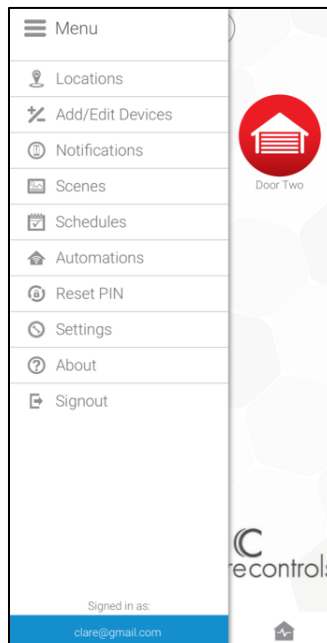

2. Tap the **Plus** icon  to add a new Scene.

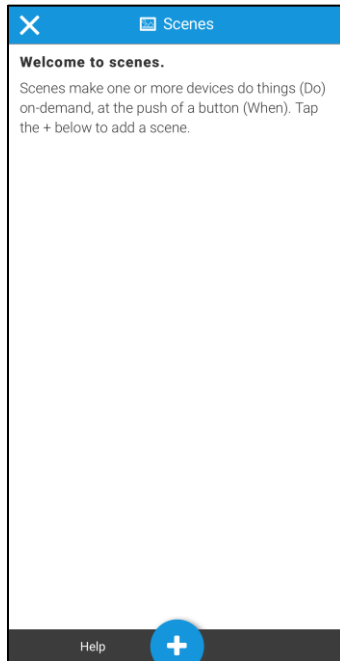

3. Enter a name for the Scene, and then tap **Access**.

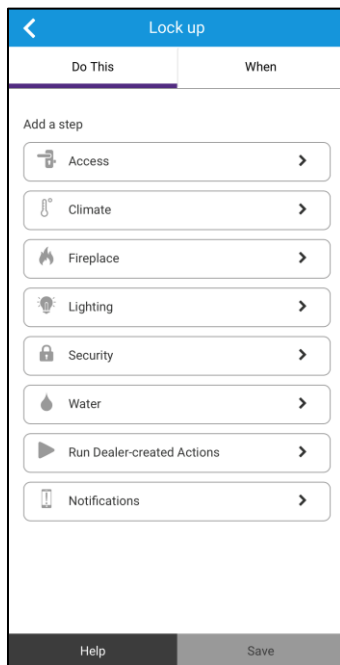

4. Select the Garage Door, and then tap **Close**.

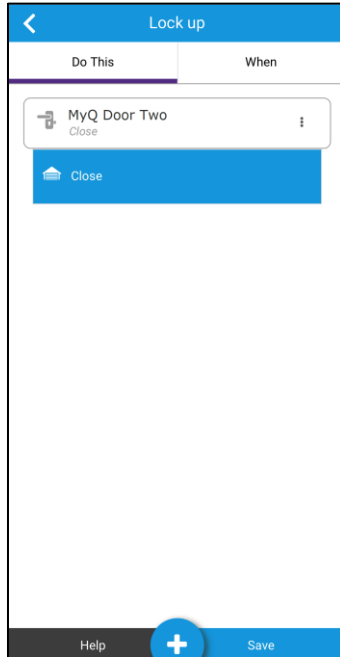

5. Tap the **Plus** icon  to add another device.
6. Select the security system and enter the alarm PIN.

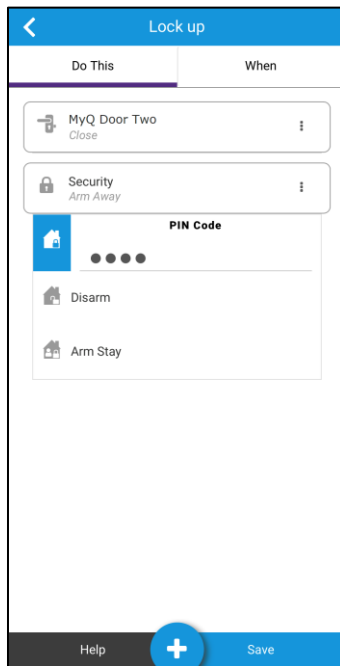

7. Tap the **When** tab, and swipe the screen left or right to select the desired icon.

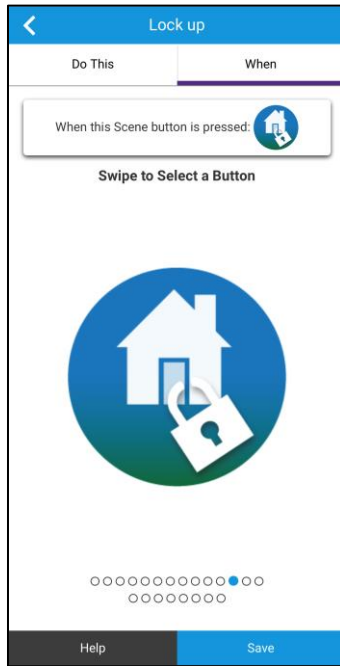

8. Tap **Save**.
The Scene is now accessible in Scenes list.

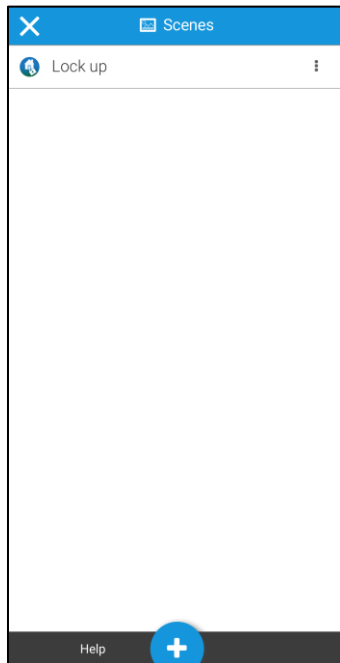

Creating Automations with MyQ

Create an Automation for your garage door. The example below walks through creating a lockdown Automation, locking the door lock when the garage door closes.

Note: The MyQ device cannot be set to open in an Automation. For security purposes, the device can only be opened when tapping the device and selecting open.

To create a lockdown Automation:

1. Access the ClareHome app's Mega Menu, and then tap **Automations**.

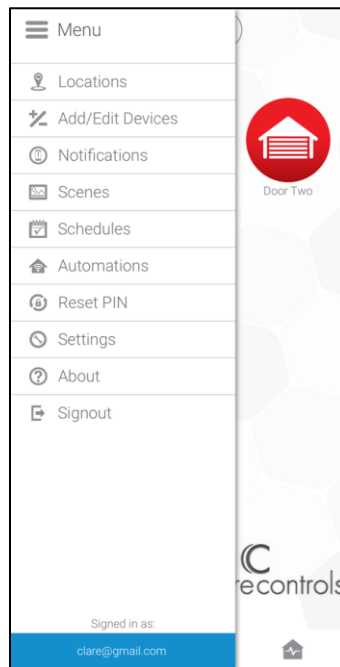

2. Tap the **Plus** icon  to add a new Automation.

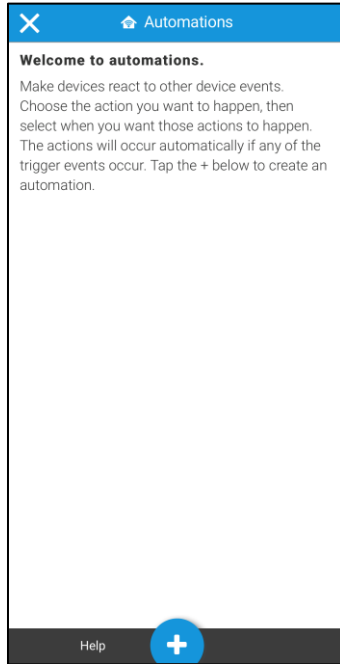

3. Enter a name for the automation, and then tap **Access**.

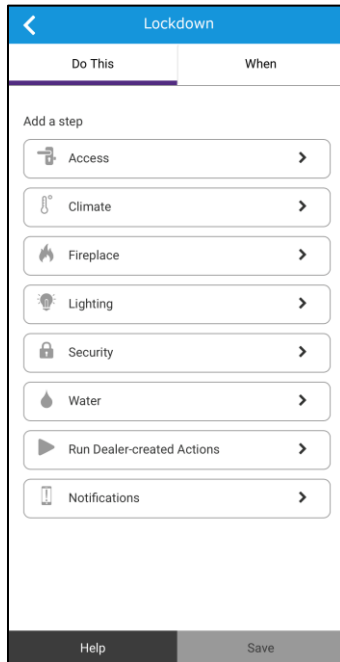

4. Select the door lock, and then tap **Lock**.

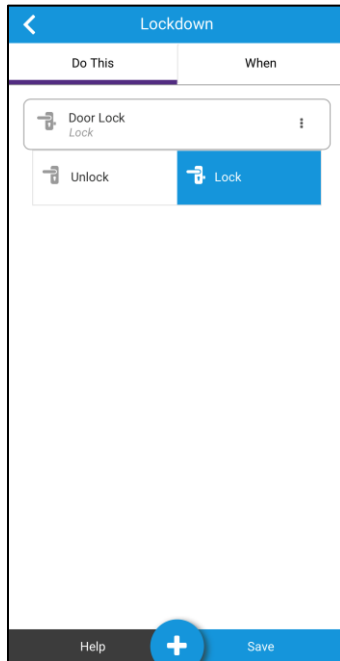

5. Tap the **When** tab, and then tap **Access**.

6. Select When an Access Device is Closed and the garage door.

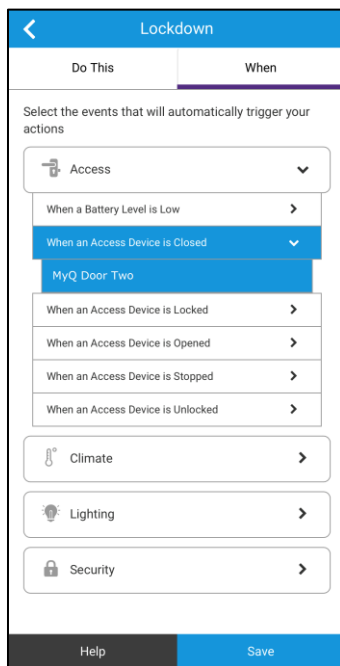

7. Tap **Save**.

The Automation is now displayed in the list.



Using the Liftmaster controls in the ClareHome app

Once deployed, the user can add the MyQ device to their space, and then tap the garage door icon in the ClareHome app to display and operate the garage door's controls, as shown below.

Figure 1: Locked and unlocked MyQ display

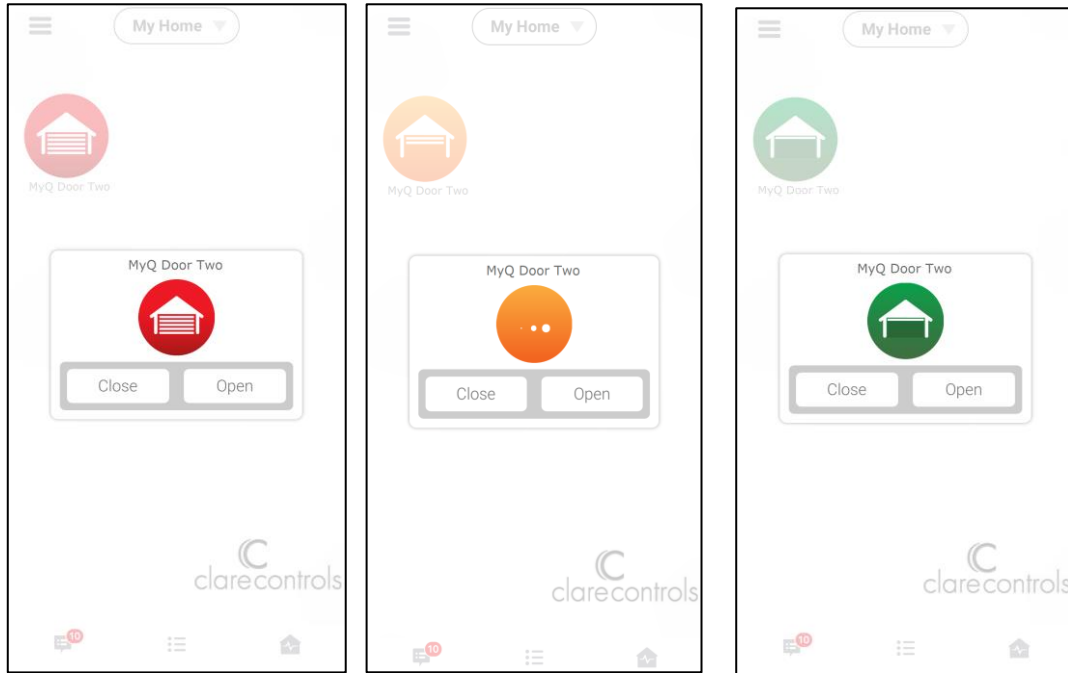

Table 1: Garage door state icon colors

Icon color	Garage door status
Red	The garage door is closed.
Orange	The garage door is in motion – up or down.
Green	The garage door is open.

Contact information

Clare Controls, LLC.

7519 Pennsylvania Ave, Suite 104

Sarasota, FL 34243

General: 941.328.3991

Fax: 941.870.9646

www.clarecontrols.com

Integrator/Dealer Support: 941.404.1072

claresupport@clarecontrols.com

Homeowner Support (ClareCare): 941.315.2273 (CARE)

help@clarecontrols.com