



Linear Garage Door Opener Integration Release Notes

For model GD00Z-5

Content

| |
|--|
| Preface...1 |
| Introduction...2 |
| Installing GD00Z-5 devices...2 |
| Pairing and configuring the Linear in the apps...2 |
| Pairing the garage door opener in Fusion...5 |
| Configuring rules with the Linear Garage Door Opener...9 |
| Installing the GD00Z-5 transceiver and tilt sensor...10 |
| Using the garage door opener in the ClareHome app...11 |
| Incompatible openers...11 |
| Contact information...12 |

Last modified: 09/25/18

Preface

For information on Z-Wave and ClareHome, see [Installing Z-Wave with ClareHome](#).

Notes

- When installing Z-Wave devices, ensure that there is nothing inhibiting their signal. Z-Wave relies on radio signals. Metal or thick walls may limit their signal strength.
- We recommend having 2 or more repeating Z-Wave devices.

Introduction

The Linear GD00Z-5 Garage Door Opener Remote Transceiver provides position-aware garage door integration to ClareHome via the Z-Wave network. It is compatible with most automatic garage door openers connected to a sectional garage door. Installers only need to pair (adding) the unit into the ClareHome Z-Wave network, mount the unit, and then connect two wires.

The GD00Z-5 provides both audible and visual warnings prior to remotely activating door movement. The GD00Z-5 ships with a wireless tilt sensor that attaches to the inside of the garage door, which reports the open, closed, and motion indication status to the controller.

By integrating the GD00Z-5 into a ClareHome control system, your customers can control the garage door from their Android or iOS devices.

Installing GD00Z-5 devices

Only qualified installation technicians should install the GD00Z-5. Follow the installation instructions that came with your GD00Z-5 equipment. We recommend that you pair the GD00Z-5 with the ClareHome Z-Wave controller before installing it in the garage.

Pairing and configuring the Linear in the apps

After installing the garage door, pair it.

Note: The garage door can be added using ClareHome, Clare Controls Install Assist, or Fusion.

To pair the garage door using ClareHome or Install Assist:

1. Access the Clare Controls Install Assist app, and then tap **Add Devices**.

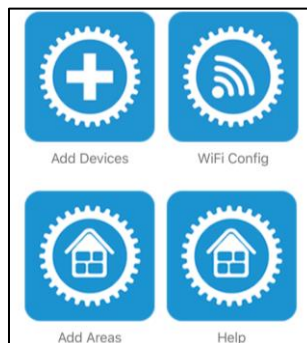

– or –

Access the ClareHome Mega Menu, and then tap **Add/Edit Devices**.

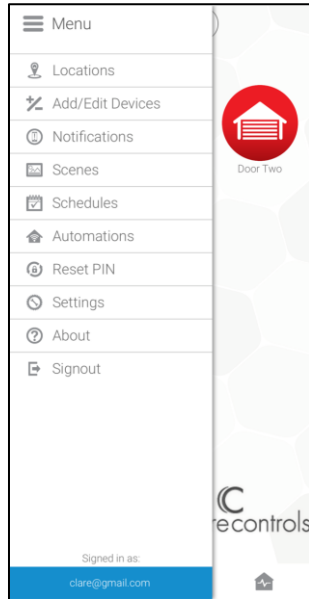

2. At the bottom of the screen, tap the plus icon .

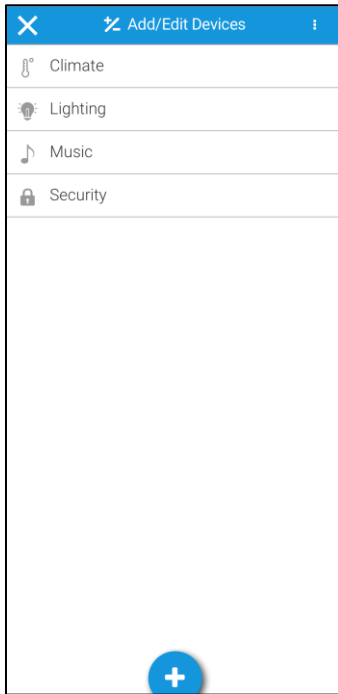

3. Tap **Access**.

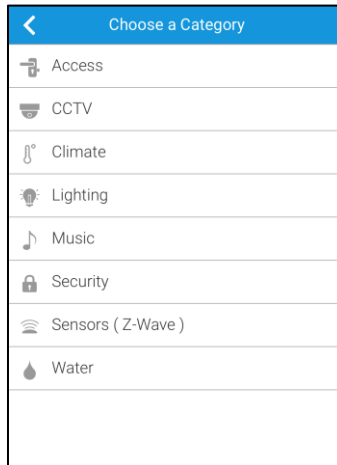

4. Tap **Z-Wave Device - Access**.

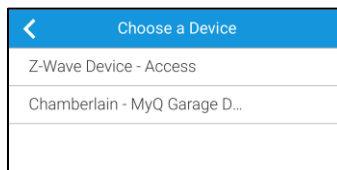

5. Tap **Start Discovery Mode**, and then pair the device as per the manufacturer's instructions.

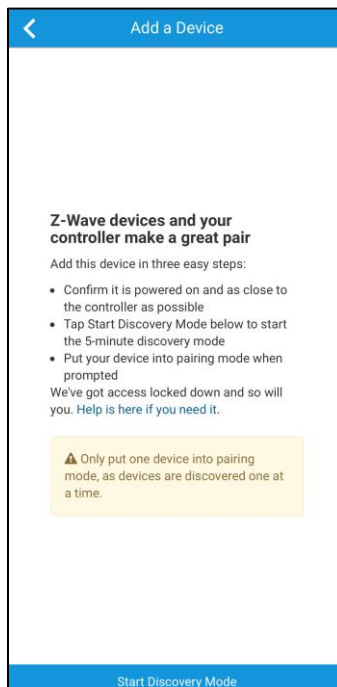

6. Enter a name for the garage door opener, and then select an area.

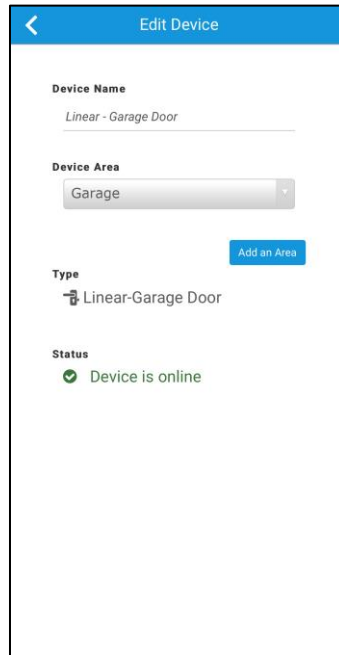

7. Tap outside of the area drop-down and the door lock automatically saves.

Note: For notification and automation configuration, see [ClareHome App Guide \(DOC ID 1750\)](#).

Pairing the garage door opener in Fusion

Before installing the garage door opener, pair it.

To pair the GD00Z-5 with Fusion:

1. Access your project, and then click the **Z-Wave Wizard** icon .

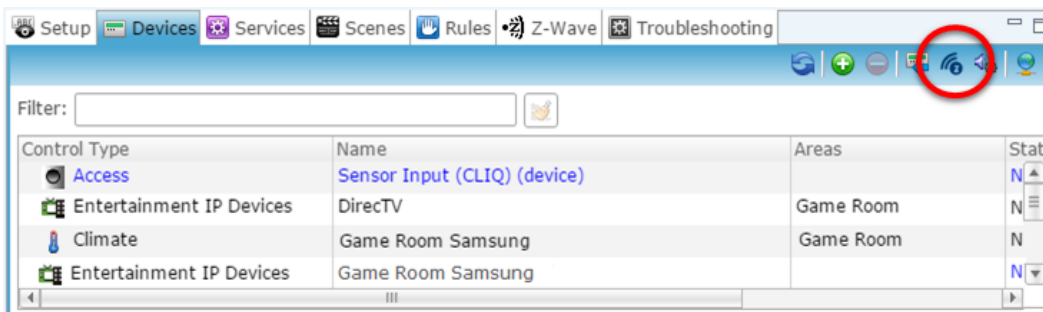

2. Click on **Z-Wave Devices**.

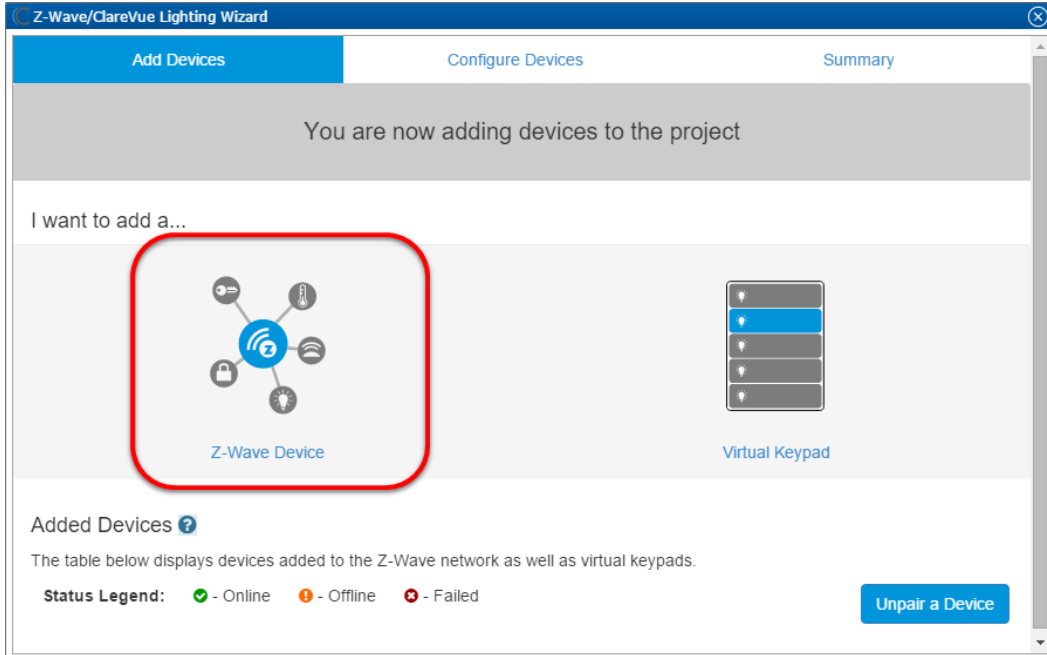

3. Select the device's location, and then enter a name for the device.

Notes

- We recommend naming the device after its location to avoid confusion. For example, Garage Door Opener.

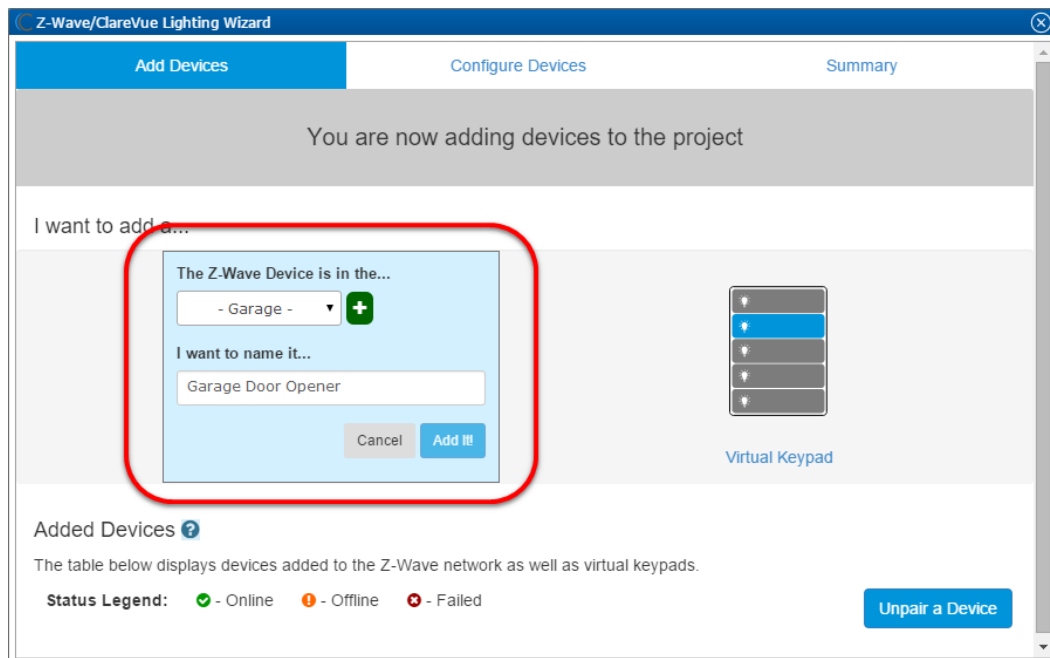

- If you want to add an area, click the green plus icon , enter a name for the area, and then click **Add Area**.

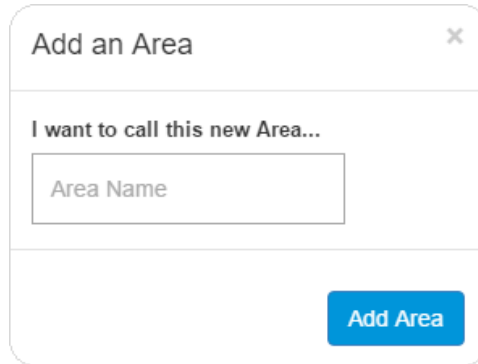

The dialog box titled "Add an Area" has a close button (X) in the top right corner. Below the title bar, the text "I want to call this new Area..." is displayed. Underneath this text is a text input field with the placeholder text "Area Name". At the bottom right of the dialog box is a blue button labeled "Add Area".

4. Click **Add It!**.

The Z-Wave adding mode dialog displays.

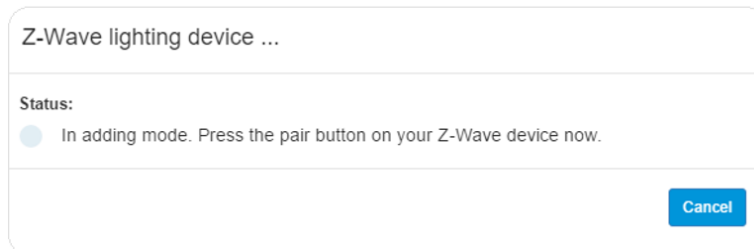

The dialog box titled "Z-Wave lighting device ..." has a "Status:" section. Below the status label, there is a blue circle icon followed by the text "In adding mode. Press the pair button on your Z-Wave device now." At the bottom right of the dialog box is a blue button labeled "Cancel".

5. Press the button on the GD00Z-5. Refer to installation instructions that came with your GD00Z-5 device.

Note: The Z-Wave lighting device dialog goes away when the device has been paired.

- The garage door opener appears in in the added devices list.

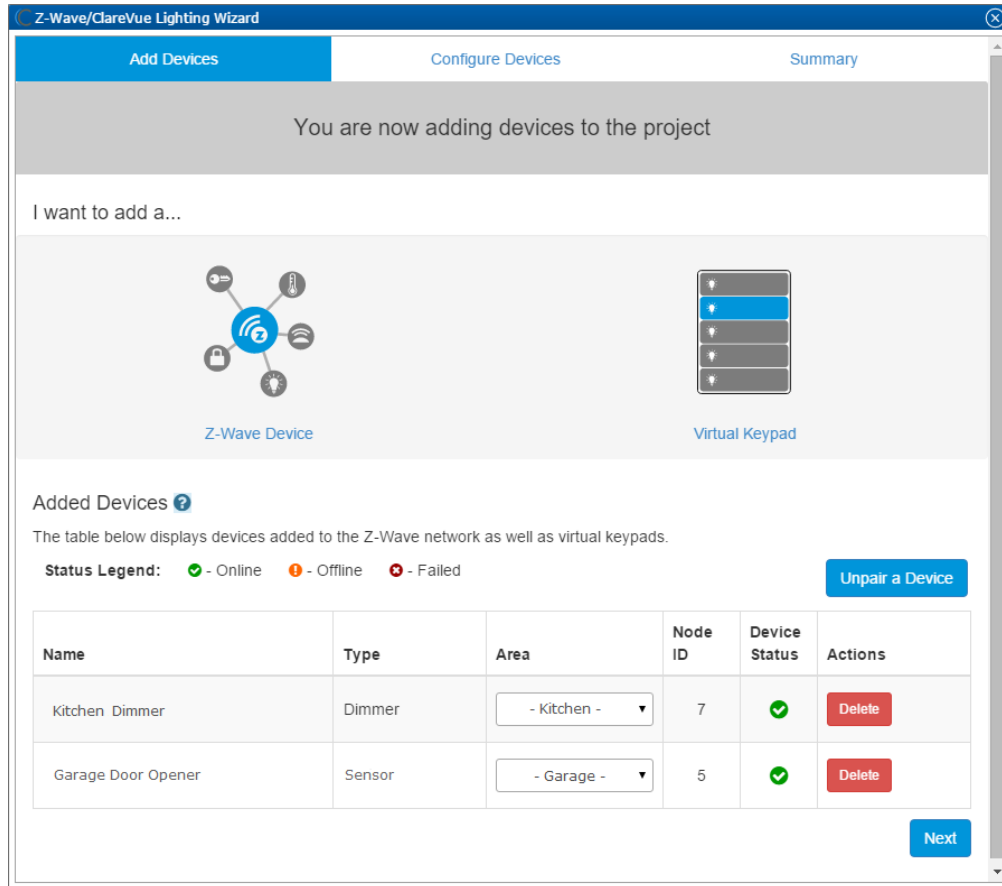

- Click the **Summary** tab to view all Z-Wave Wizard added devices and their status.

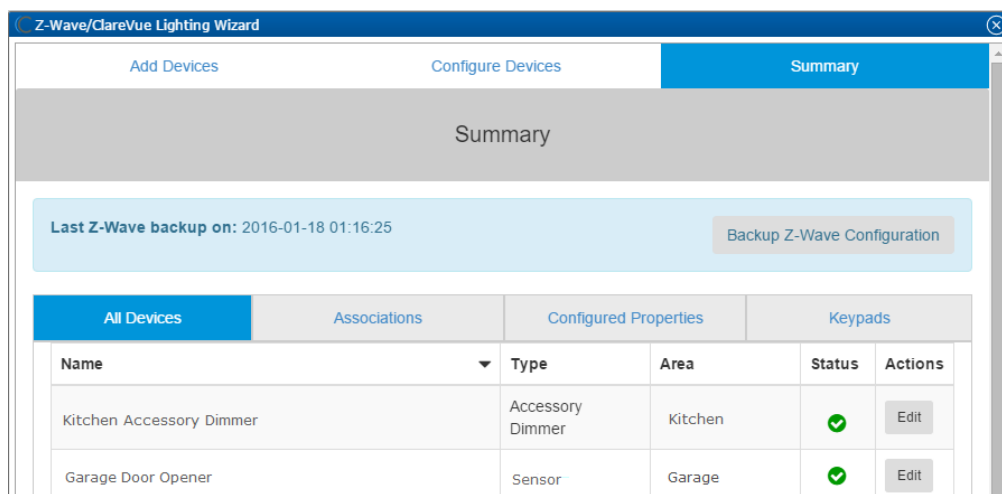

- Click the **Close Window** icon in the top-right of the wizard to exit and return to the **Devices** tab.

Note: The Z-Wave devices added with the Z-Wave Wizard are automatically imported on the **Devices** tab.

Configuring rules with the Linear Garage Door Opener

Configure a rule for the Linear Garage Door Opener.

The following example sets a closing rule. When the garage light switch is turned off, the Linear Garage Door Opener closes.

To create a closing rule in Fusion:

1. Access your project, and then click the **Rules** tab.

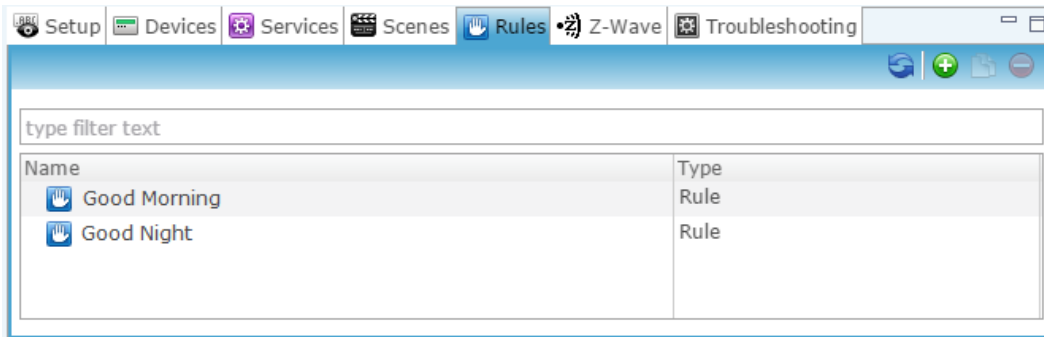

2. Click the **New Rule** button .
3. Enter a name for the rule, and then select the Enable Rule checkbox.

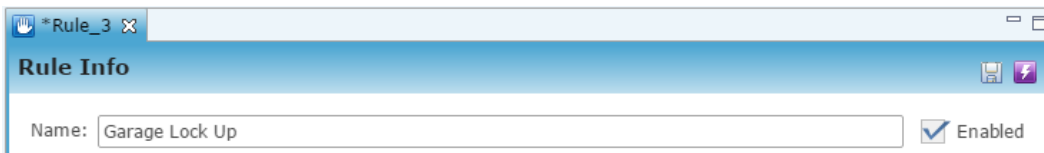

4. Configure the Event Part as below.
 - **Event Type:** Device Property Change Event
Note: The Device Property Change Event replaced the Device Property Value Event.
 - **Device:** Garage Light Switch
 - **Function:** Switch
 - **Property:** State
 - **Constraint:** =
 - **Value:** Switched Off

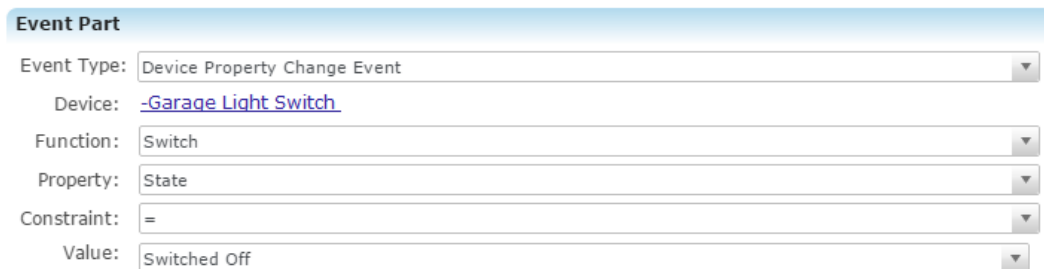

- Configure the Action part as below.
 - Action Type:** Invoke Device Operation
 - Device:** Linear Garage Door Opener
 - Function:** Barrier Operator
 - Operation:** Close

- Click the **Save** button , and then deploy the project.

Rule options for the Linear Garage Door Opener

When creating rules for the door/window sensor, consult the below table to better understand the options available.

Table 1: Linear Garage Door Opener properties

| Device | Event Type | Functions | Property | Constraint | Value |
|--------------------|------------------|------------------|----------|-----------------|-------------------|
| Linear Garage Door | Open/Close/State | Barrier Operator | State | >, <, =, >=, <= | True or False [1] |

[1] Detected/Not Detected: The garage door sensor either detects or does not detect that the garage door is shut.

Installing the GD00Z-5 transceiver and tilt sensor

To install the GD00Z-5 transceiver and tilt sensor:

- Install the GD00Z-5 transceiver and tilt sensor according to the manufacturer's instructions.
- Next, follow the manufacturer's system operations to synchronize the system.
- Access your ClareHome app and verify that the Linear garage door opener is now available in the devices menu.

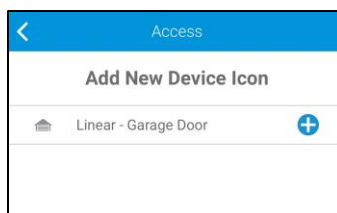

Using the garage door opener in the ClareHome app

Once deployed, the user can add the device to their space, and then tap the door icon in the ClareHome app to display and operate the garage door opener's controls, as shown below.

Figure 1: Locked and unlocked Linear display

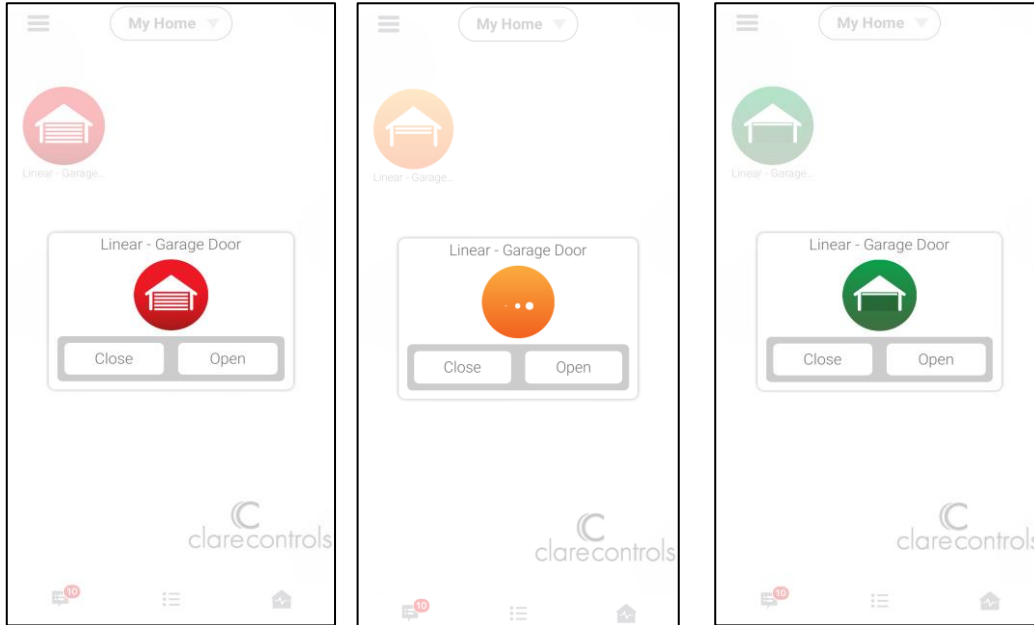

Table 2: Garage door state icon colors

| Icon color | Garage door status |
|------------|--|
| Red | The garage door is closed. |
| Orange | The garage door is in motion – up or down. |
| Green | The garage door is open. |

Incompatible openers

The GD00Z-5 is compatible with most sectional garage door openers manufactured after 1993; however, a few are known to be incompatible. The following lists the incompatible openers. This is not intended to be a complete list, but identifies some recent models commonly found in the retail marketplace.

Chamberlain MyQ Models:

- WD962KEV, KPEV and MLEV WD832KEV
- HD 930EV and 420EV LW500EV
- PD752D and KPV

Genie Series III Models:

- PowerMax 1500
- TriloG 1200 and 1500
- IntelliG 1000 and 1200

LiftMaster MyQ Models:

- 8355, 8360, 8500, 8550, 8557, and 8587

Craftsman AssureLink / MyQ Models:

- 3043 and 30437

Contact information

Clare Controls, LLC.
7519 Pennsylvania Ave, Suite 104
Sarasota, FL 34243

General: 941.328.3991
Fax: 941.870.9646
www.clarecontrols.com

Integrator/Dealer Support: 941.404.1072
claresupport@clarecontrols.com

Homeowner Support (ClareCare): 941.315.2273 (CARE)
help@clarecontrols.com