

# BE AUTHENTIC.

## CREATE AN AUTHENTIC BOARD AND BATTEN LOOK WITH 2" MIRATEC BATTEN

- The distinctive board and batten style is perfect for adding charm and dimension to any home's exterior.
- Use MiraTEC for its superior woodgrain texture and longer lengths for this attractive application
- Board and batten siding provides dimension, a strong pattern of light and shade as a design element to any exterior

### MIRATEC BATTEN SIZES

THICKNESS	SIZE		16' PIECES	
	NOMINAL	ACTUAL	BUNDLE	UNIT
5/8" Actual	2" x 192"	2"	12	336
4/4 Nominal (3/4" Actual)	2" x 192"	2"	12	336
5/4 Nominal (1" Actual)	2" x 192"	2"	9	252

## NO OTHER TRIM PERFORMS LIKE MIRATEC

- Resists moisture, rot and termites.
- Reversible with a woodgrain texture on one side and a smooth surface on the other.
- Handles like wood; easy to machine, cut and nail.
- Won't check, split or crack.
- TEC™ patented manufacturing process makes MiraTEC a solid board that has uniform properties throughout for consistent performance in every piece.
- Primed 4 sides with an ultra-low VOC, white primer containing a mildewcide.
- Industry-best 50-year limited warranty.



CCMC 14015-L

Building code compliant in the U.S. (ESR-3043 from the ICC-ES) and in Canada (14015-L from the CCMC).



**MIRATEC**<sup>®</sup>  
by JELD-WEN

# ANYONE CAN TALK PERFORMANCE MIRATEC PROVES IT.



- Moisture resistant: As measured by ASTM D1037 for Water Absorption and Thickness Swelling.
- Rot resistant: Tested per AWPA E16 Field Test for Evaluation of Wood Preservatives to be Used Out of Ground Contact: Horizontal Lap-Joint Method.
- Termite resistant: Tested per AWPA E7 Standard Method of Evaluating Wood Preservatives by Field Tests with Stakes.

## NOTHING IS FRIENDLIER TO THE ENVIRONMENT

- Sustainable Materials – No old growth wood is used in the manufacture of MiraTEC trim. It is made from wood that has no commercial timber value and is the byproduct of other operations.
- No Added Urea Formaldehyde – MiraTEC trim is certified to contain no added urea formaldehyde.
- Complies with CARB – MiraTEC trim is acknowledged by the California Air Resources Board's (CARB) Airborne Toxic Control Measure (ATCM) 93120 to utilize exempt status ultra-low emitting formaldehyde (ULEF) resins.
- Contributes to Green Building Programs – MiraTEC trim contributes to industry programs such as LEED and the National Green Building Standard.

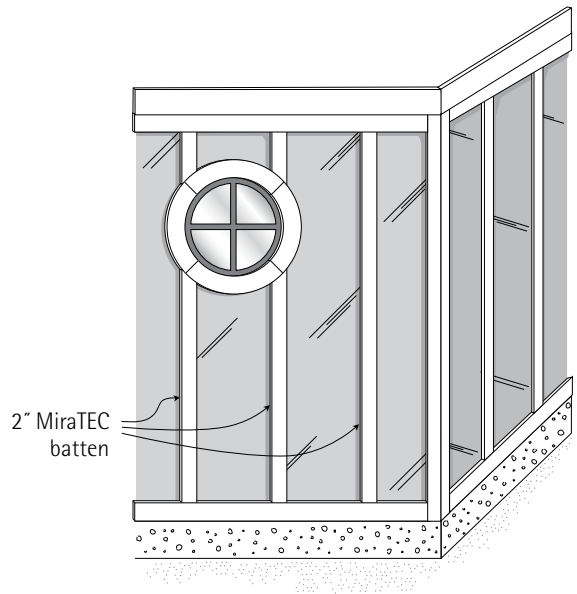

Check out  
[miratectrim.com](http://miratectrim.com)  
for all the details.

**MIRATEC**<sup>®</sup>  
by JELD-WEN  
**BORN TO BE BADDEST.**

1.800.255.0785  
[miratectrim.com](http://miratectrim.com)

Copyright © 2016 JELD-WEN, inc. Trademarks shown are owned by JELD-WEN, inc. or licensed by third parties. All rights reserved.



ENVIRONMENTAL  
CLAIMS  
VALIDATION  
by SCS Global Services

**NO ADDED UREA  
FORMALDEHYDE**