

A hand holding a pen over a document with a rainbow graphic. The background is dark and blurred, showing a hand holding a pen over a document with a rainbow graphic.

**blackline**safety

The Loner M6 Safety System

---

# CONTENTS

About the device

Starting your shift

During your shift

Generating Manual Alerts

Receiving a voice call

Ending your shift

Questions?



# ABOUT THE DEVICE

There are three primary mechanical components of the Loner device.

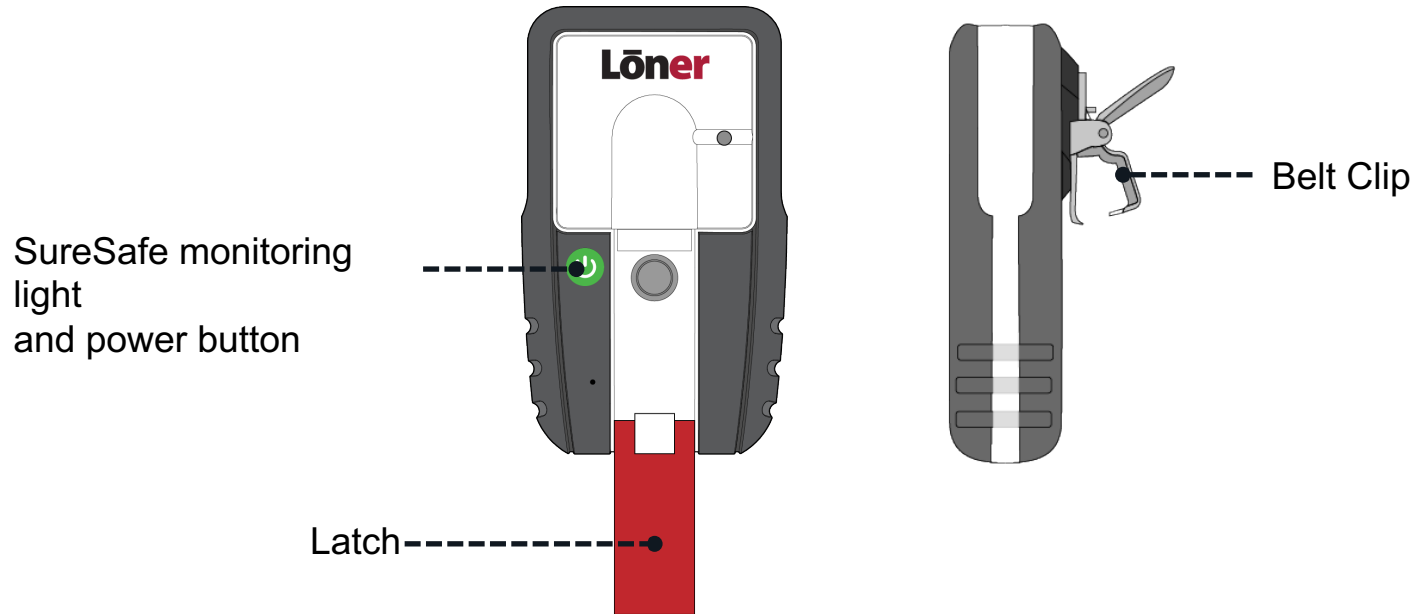

A pair of hands, one light-skinned and one dark-skinned, are shown holding a smartphone. The background is a colorful, abstract pattern with shades of red, green, blue, and orange. The text "STARTING YOUR SHIFT" is overlaid in the center in white, bold, uppercase letters.

STARTING YOUR SHIFT

## TURNING ON YOUR LÖNER

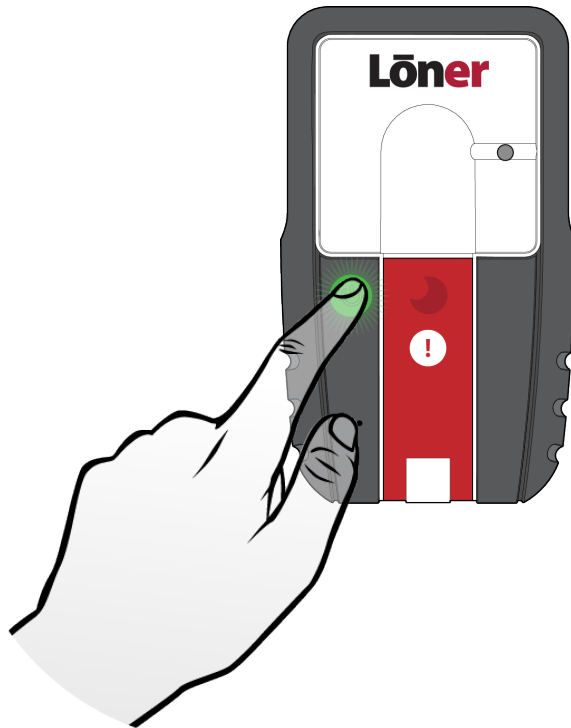

Press the power button

The green SureSafe light will blink until it is connected to the Blackline Safety Network.

Once connected, the light will be **SOLID GREEN.**

This means your safety is now monitored.

## WEARING YOUR LONER

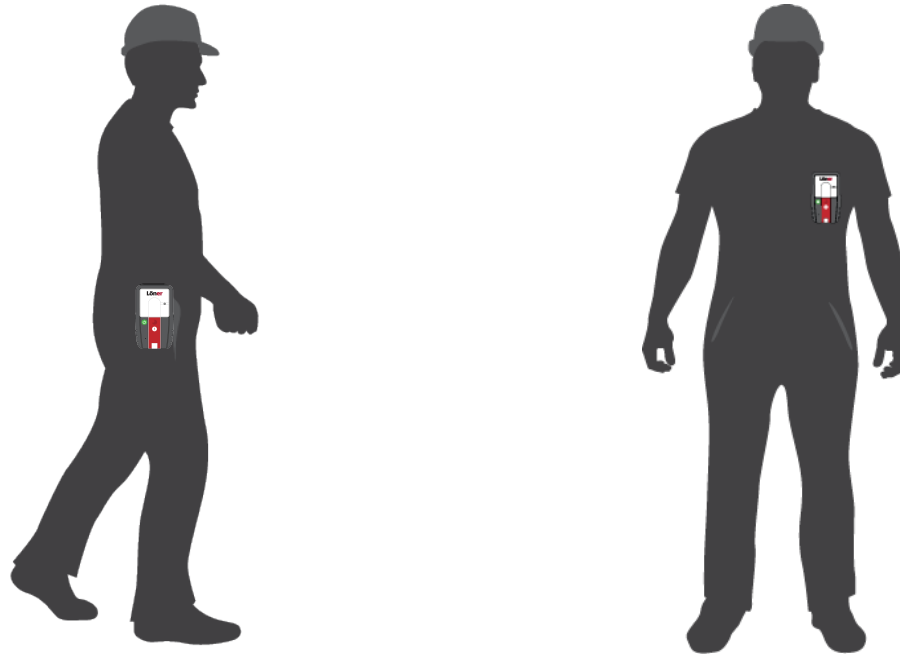

Clip the device to the side of your hip or to your chest pocket

Do not leave Loner unattended when powered on

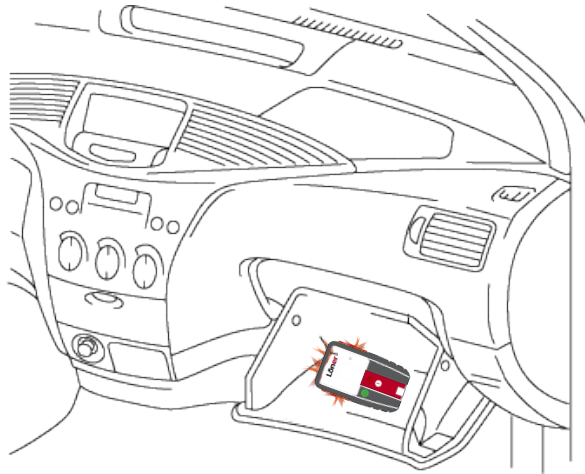

This can lead to false alerts





DURING YOUR SHIFT

## AUTOMATIC FEATURES

During your shift, the device may ask you to confirm that you are OK when it detects one of the following:

No-motion



Fall detection

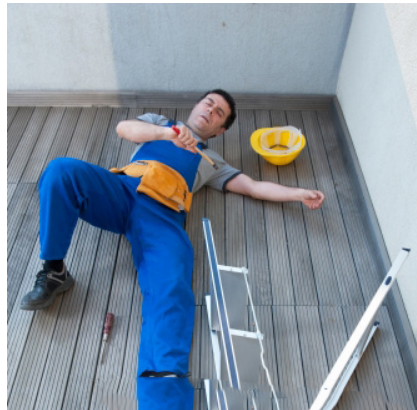

Check-in



## AUTOMATIC FEATURES – IF YOU’RE OK

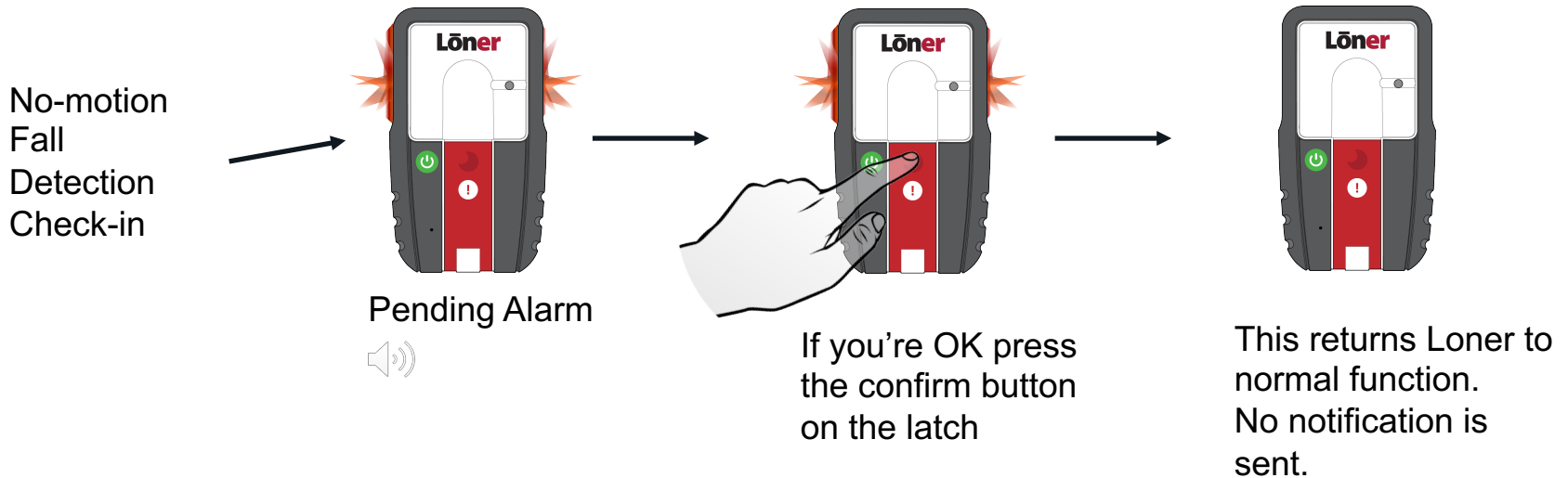

# AUTOMATIC FEATURES – IF YOU CAN'T CONFIRM

No-motion  
Fall  
Detection  
Check-in



Pending Alarm



If you can't press the confirm button after a certain period of time, the device will go into high alarm 



This sends an alert notification



Once an alert is acknowledged by monitoring personnel, the löner will display a blue light



The high alarm can be silenced by pressing and holding the button. The alert notification still remains active.

## PRE CHECK-IN

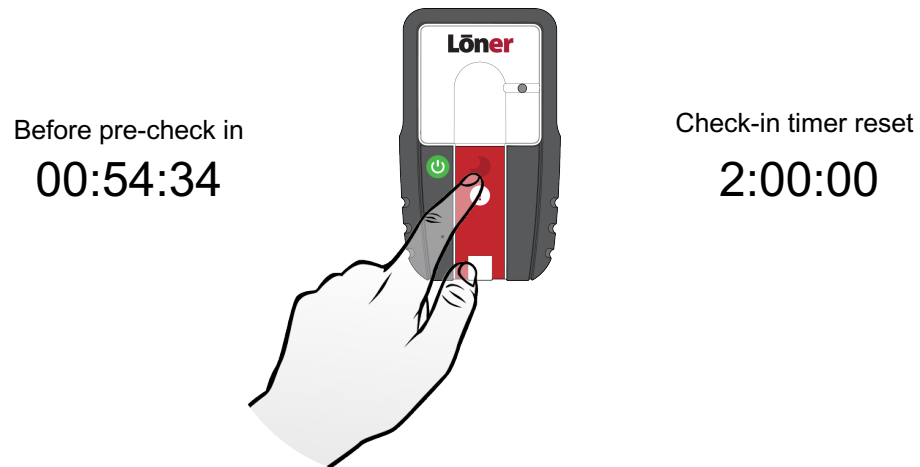

To do this, press and hold the latch for two vibrations. This will reset the check-in timer before the automatic alarm sounds.

Your device will automatically check you in if you are driving over 35 km/h.

## MANUAL FEATURES

During your shift, you may need to request help using one of the manual features:

Emergency alert  
(Audible)



Silent alert



## Emergency alert

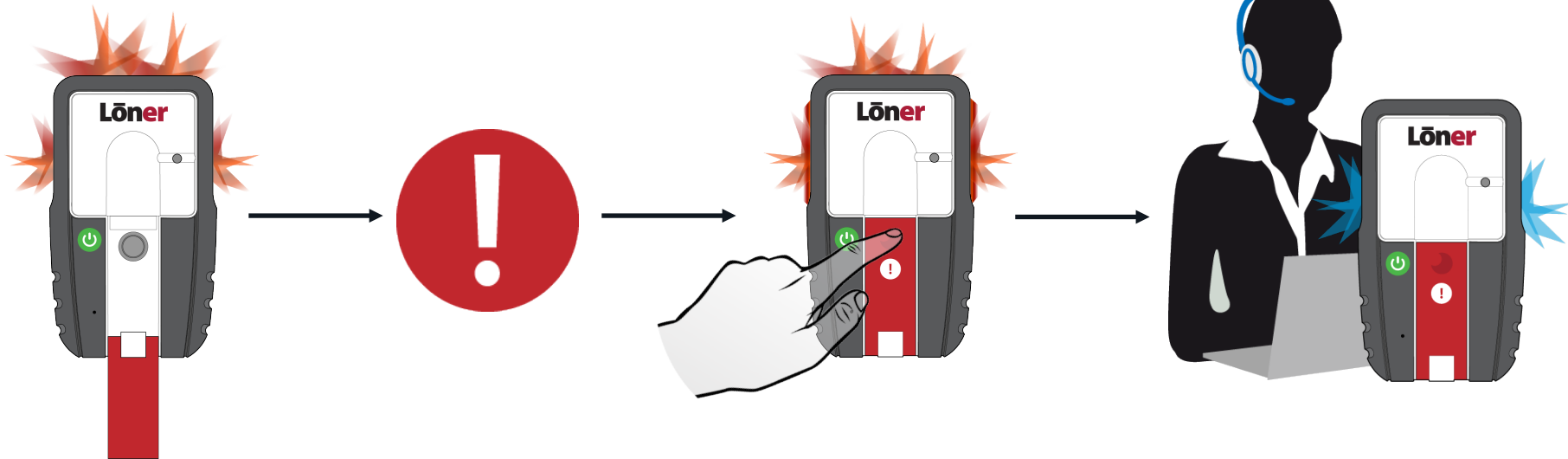

Request help by pulling down the latch



An alert notification will be sent to monitoring personnel

The high alarm can be silenced by pressing and holding the button. The alert notification still remains active.

Once an alert is acknowledged by monitoring personnel, the loner will display a blue light

## Silent Alert

(No audible or visual alarm is generated on the Loner device)

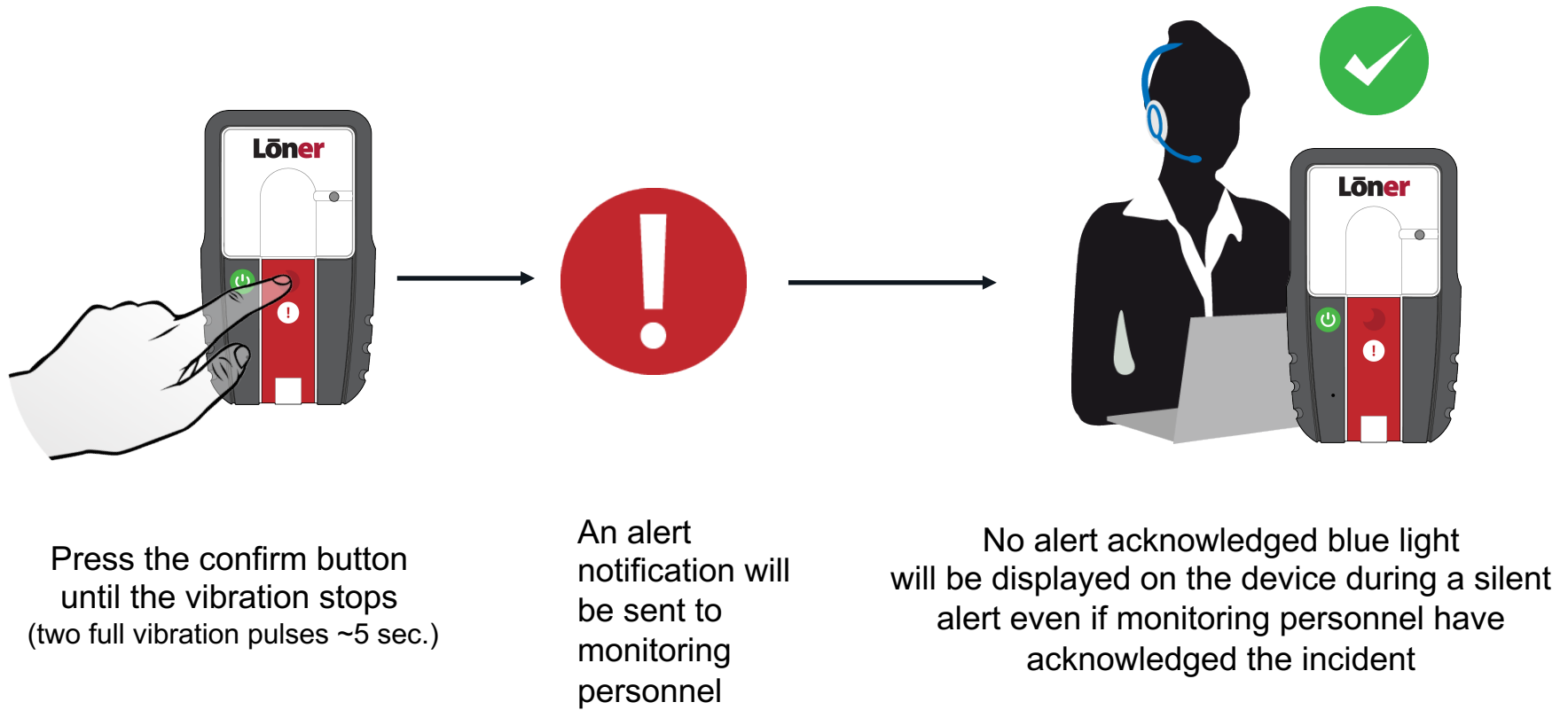





# RECEIVING A VOICE CALL

# RECEIVING A VOICE CALL

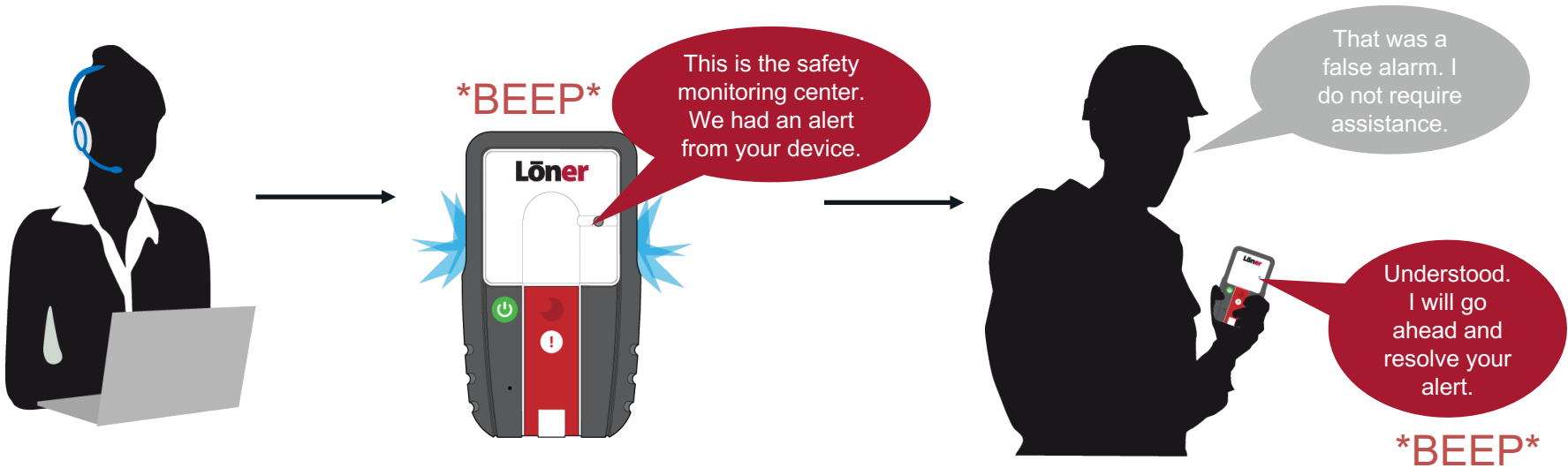

A voice call can be made by monitoring personnel directly to the device. After an alert is triggered the device will beep once when a call is connected.



Once the call is connected you can speak back and forth to monitoring personnel. When the call has ended the device will beep once more.

## RECEIVING A VOICE CALL – AFTER A SILENT ALERT

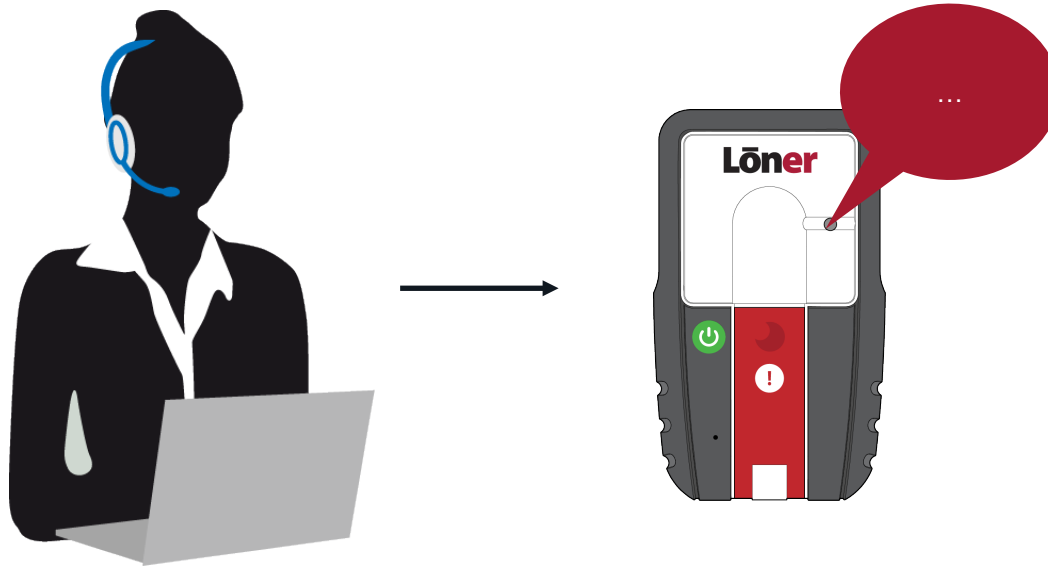

When a silent alert is generated, monitoring personnel can still connect with the Loner device. However the Loner will not beep and it will be in a 'listen only' mode.

A hand holding a smartphone with a notification bubble. The background is dark, and the phone is the central focus. A notification bubble is visible on the screen, and there are some blurred lights on the phone's surface.

NOTIFICATIONS

## Link lost alarm

Your Loner will notify you if it loses cellular communication.



Your Loner SureSafe light will begin blinking to confirm that your safety is not being monitored. If configured, the device may initiate a link lost alarm.

## Low battery alarm

Your Loner device is configured to signal to you when the battery falls below a certain configured percentage



Low battery alarm is characterized by a short beep and a quick flash every 5 minutes. Charge your device as soon as possible.



ENDING YOUR SHIFT

## TURNING OFF YOUR LONER DEVICE

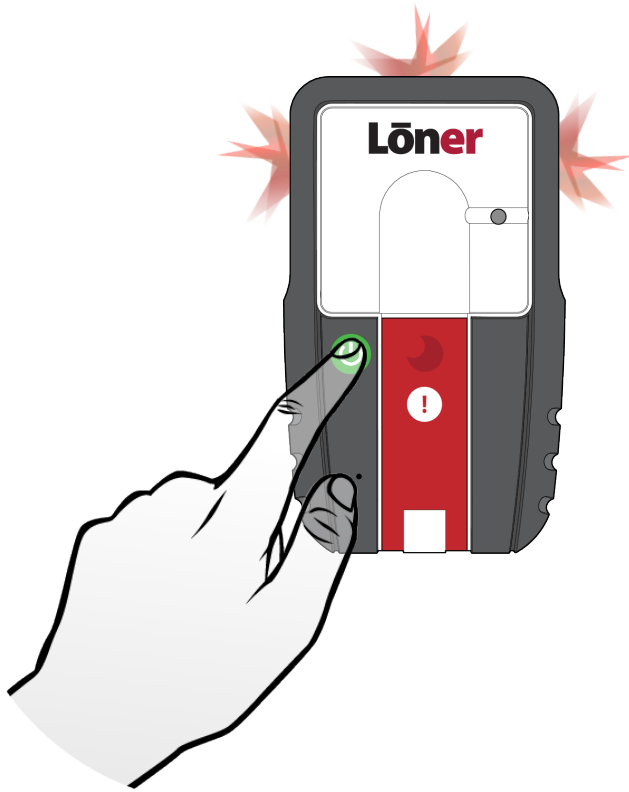

Press the power button until beeping and vibration stops (usually 3 seconds)

The device will begin its shutdown sequence and the SureSafe light will flash and then turn off once your Loner logs off from the Blackline Safety Network.

Your safety is no longer being monitored

## CHARGING YOUR LÖNER

Full charge takes approx 4 hours  
Battery Life is 20 hours

Insert the charger into the bottom of the device and connect to power source

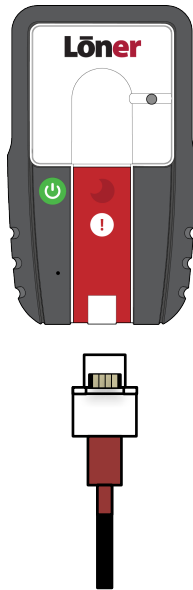

While the device is charging the red lights on the base will flash

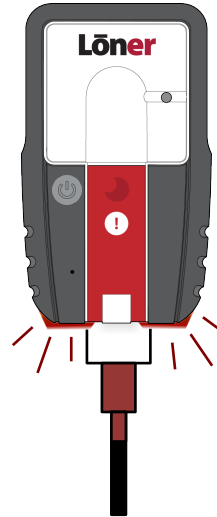

When Löner is charged, the red lights will turn on continuously.

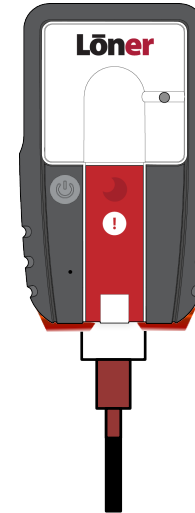



QUESTIONS?

# blacklinesafety

For more support materials,  
Please visit [support.blacklinesafety.com](https://support.blacklinesafety.com)

Customer Care: 1-877-869-7212