

# blacklinesafety

## G7 DOCK

### Multi-dock Setup Guide

### MULTI-DOCK SET UP

In situations where multiple G7s require calibration and bump testing, docks can be joined together to perform these functions simultaneously. Multiple G7 Docks can be connected to a single gas cylinder by using tubes and T-connectors. One gas cylinder is able to support up to five G7 Docks at one time.

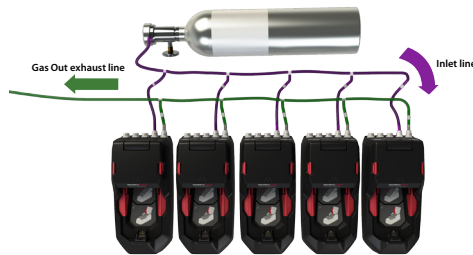

#### This kit includes:

- Tubing
- Inlet Connector A
- Inlet Connector B
- Exhaust Connector A
- Exhaust Connector B

#### You will also need:

- G7 Dock
- Gas Cylinder

### IN YOUR KIT

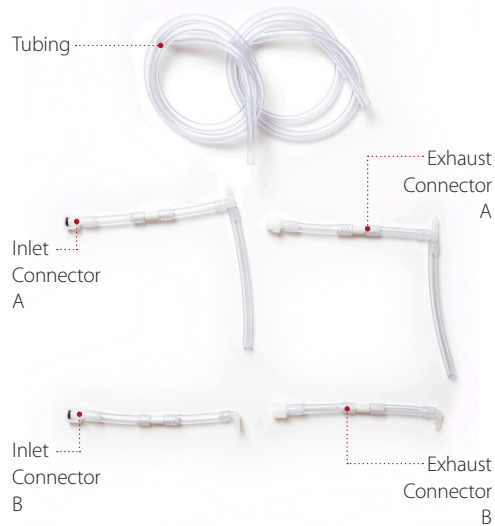

#### How do I know if it is an inlet or an exhaust connector?

Inlet and exhaust connectors can be differentiated by the black ring on the end of the quick connect. Inlet connectors have the black ring, whereas exhaust connectors do not.

Inlet connector



Exhaust connector



### CONNECTING GAS EXHAUSTS

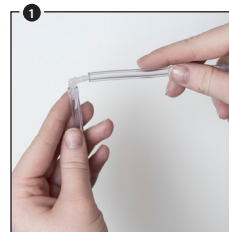

#### Connect Exhaust A to B

Join exhaust connector A to connector B by inserting the T-connector into the open end of the tubing.

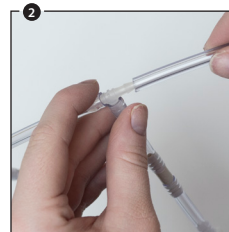

#### Connect to tubing

Attach the exposed T-connector to the tubing.



#### Connect to quick connects

Attach the quick connects of the exhaust connectors to the exhaust outlet on the back of all G7 Docks.

**NOTE:** If you wish to link more than two docks together, you can add up to five A connectors in step 1 before moving to step 2.

### CONNECTING INLETS

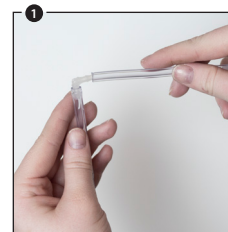

#### Connect Inlet A to B

Join inlet connector A to connector B by inserting the T-connector into the open end of the tubing.

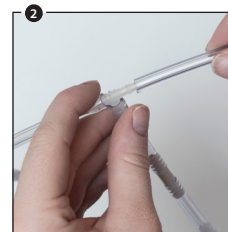

#### Connect to tubing

Attach the exposed T-connector to the tubing.



#### Connect to gas cylinder

Attach the open end of the tubing to the demand-flow regulator on the gas cylinder.



#### Connect to quick connects

Attach the quick connects of the inlet connectors to the corresponding gases on the back of all G7 Docks.

**NOTE:** If your docks have more than one type of gas inlet, repeat steps 1-4 for all inlets you wish to link.

### LEARN MORE

Visit [support.BlacklineSafety.com](https://support.BlacklineSafety.com) for other support documents on G7 Dock.

### CUSTOMER CARE

For technical support, please contact our Customer Care team.

#### North America (24 hours)

Toll Free: 1-877-869-7212 | [support@blacklinesafety.com](mailto:support@blacklinesafety.com)

#### United Kingdom (8am-5pm GMT)

+44 1787 222684 | [eusupport@blacklinesafety.com](mailto:eusupport@blacklinesafety.com)

#### International (24 hours)

+1-403-451-0327 | [support@blacklinesafety.com](mailto:support@blacklinesafety.com)