

(3) 1/4" DIA. HOLES IN TURN BACK FOR OPTIONAL WALL BRACKETS

REAR OF BOTH END SPLASHES CLOSED

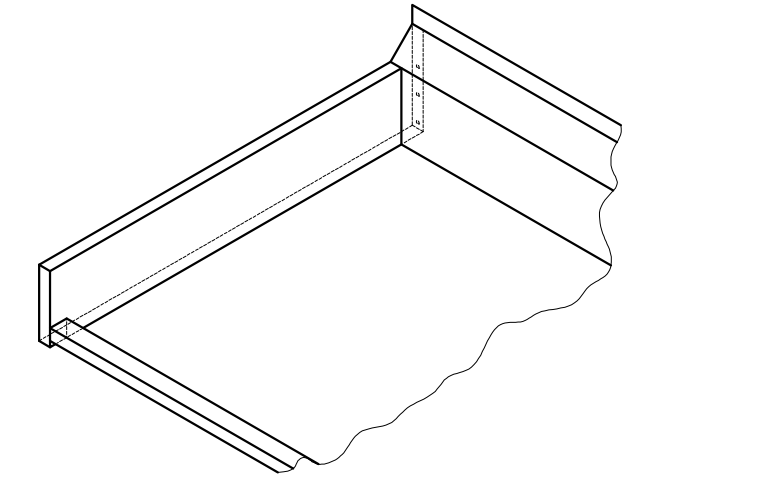

TYPICAL ENDSPLASH DETAILS

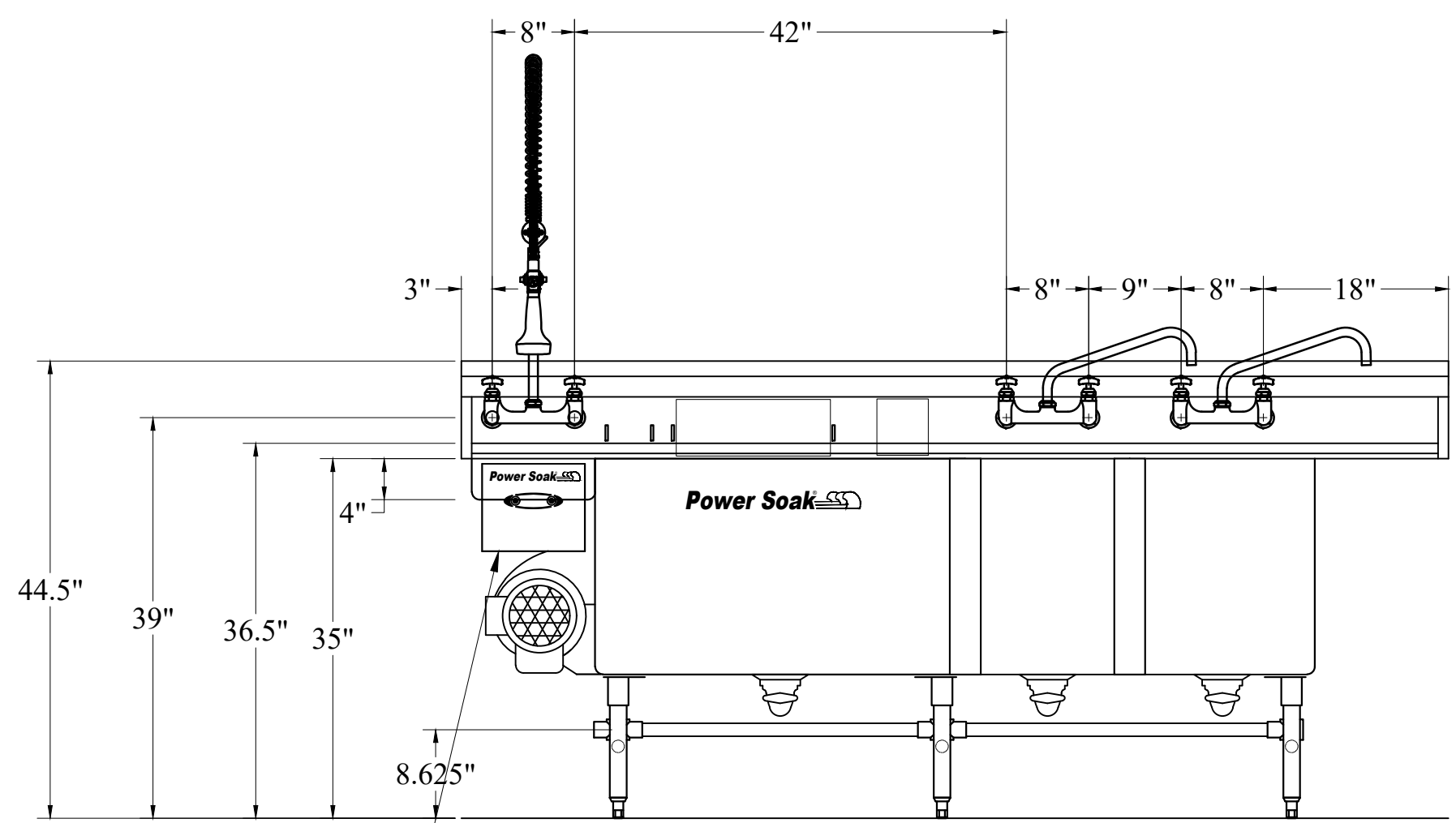

ELECTRICAL CONNECTION #PS200 CONTROL 2 HP PUMP/MOTOR, WITH AUTOMATIC WASH TANK HEAT, 208V/3PH, 26.7 AMPS

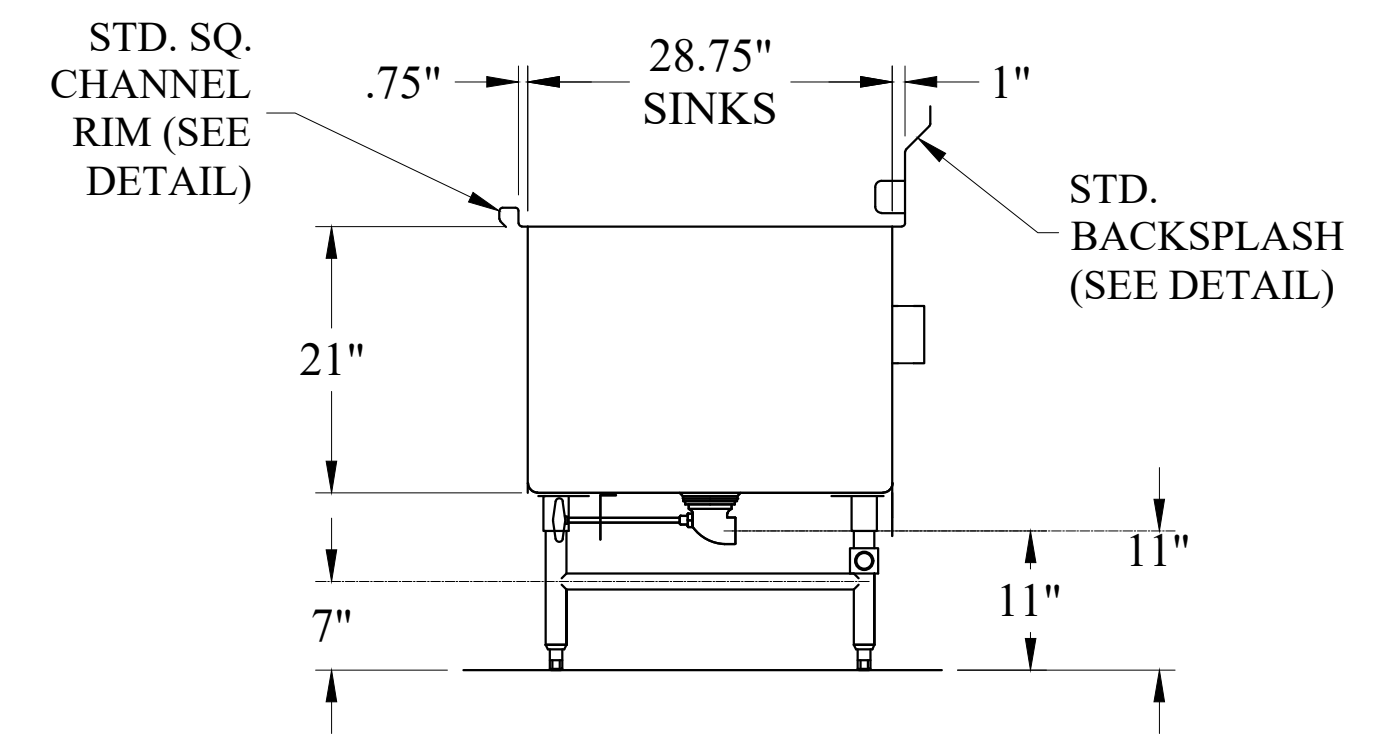

SECTION "A"

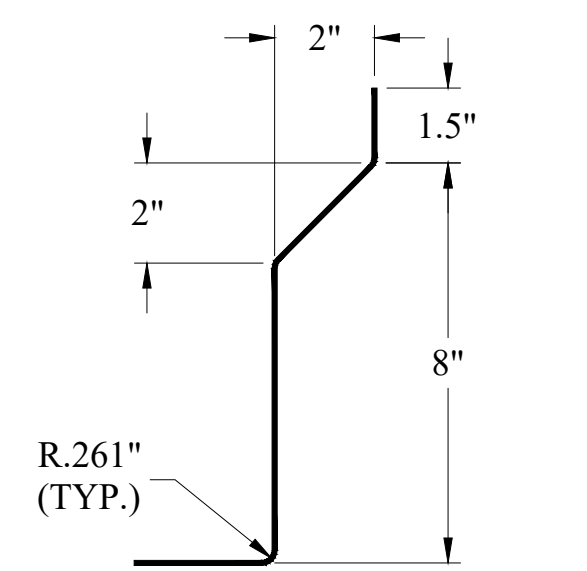

BACKSPLASH DETAIL

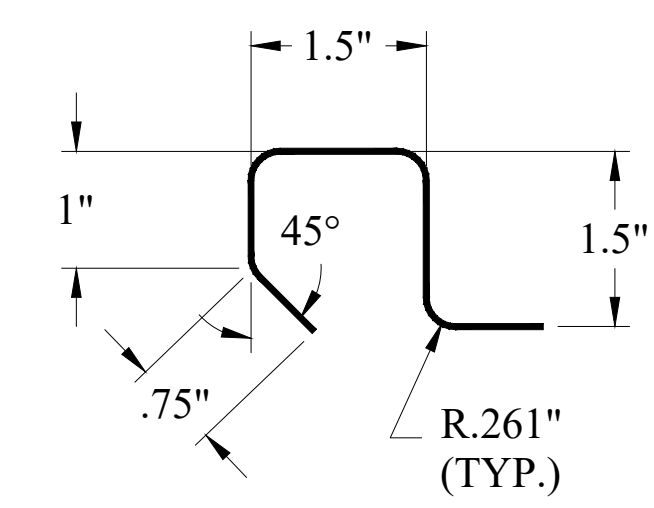

SQUARE CHANNEL RIM DETAIL

COMPONENTS SUPPLIED BY POWERSOAK		
COMPONENT / MODEL	QTY	PART NO
GEN3 WASH SYSTEM		
BULLET FEET		
1.5" IPS OPEN DRAIN, #E16-4051-PS	1	
3 SLOT, GEN 3, INDIVIDUAL SHEET PAN RACK SECTION	1	
10 SLOT, GEN 3, INDIVIDUAL SHEET PAN RACK SECTION	1	
GEN 3 UTENSIL BASKET	1	
1/2" PRE-RINSE FAUCET, 1.25" DIA. MTG HOLES	1	
3/4" HIGH-FLOW FAUCET WITH 14" SPOUT	2	
1.5" IPS REAR-EXIT ROTARY BALL VALVE DRAINS, #DBN-9100-PS	3	

unified brands

THIS DRAWING IS THE PROPERTY OF UNIFIED BRANDS. THE DOCUMENT MAY CONTAIN PROPRIETARY INFORMATION OF UNIFIED BRANDS AND IS FOR THE USE OF UNIFIED BRANDS AND THEIR CUSTOMERS. INFORMATION CONTAINED IN THIS DOCUMENT IS CONFIDENTIAL AND SHALL BE KEPT AS SUCH. ALL USE OF PATENTED DESIGN OR TRADEMARK SHALL NOT BE SUBSEQUENT TO THE PUBLIC OR FILED IN ANY PUBLIC RECORD UNLESS REQUIRED BY LAW.

REVISIONS		DATE	PROJECT MANAGER	REV NUMBER
DATE	DESCRIPTION	BY	SCALE	HOW ORDER NUMBER (ONLY USE ONLY)
8/31/2018	NTS	JDB	1	
2070473				1 of 1

PROJECT NAME: Frontier
CONTRACTOR: Frontier
SEALER: Frontier

STATUS: **PRELIMINARY**
NOT FOR CONSTRUCTION USE
Date: _____ Project File

4502 546 Street, WPF, Ppvt, OK 74861 (800) 884-7636 www.unifiedbrands.com