

TOP MOUNT -T2

CHANNEL MOUNT -C11

CHANNEL MOUNT -C13

FACE MOUNT -F2

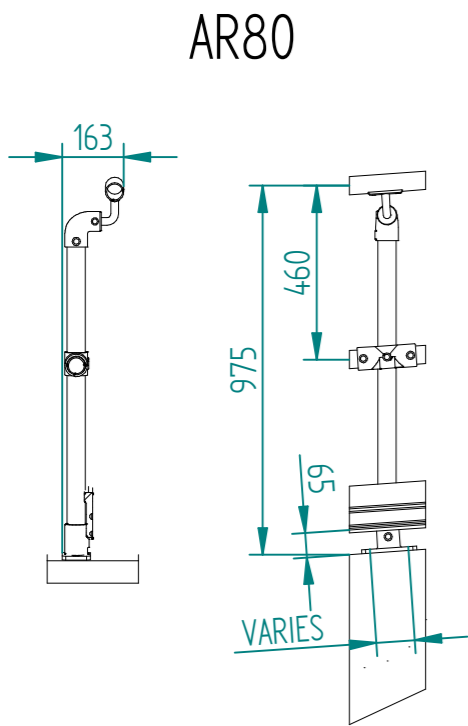

AR80

FOR ANGLES RANGING FROM 30° - 45° THE HOLE PITCHING IS 125mm. FOR ANGLES LESS THAN 30° BUT GREATER THAN 11° THE HOLE PITCHING IS 131mm.

ANGLE MOUNT -AM

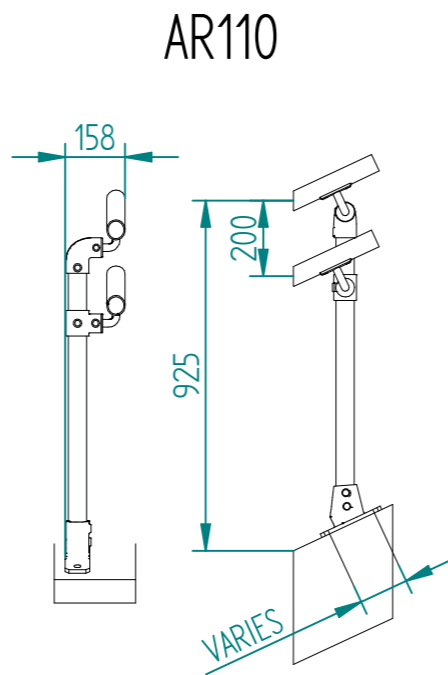

AR110

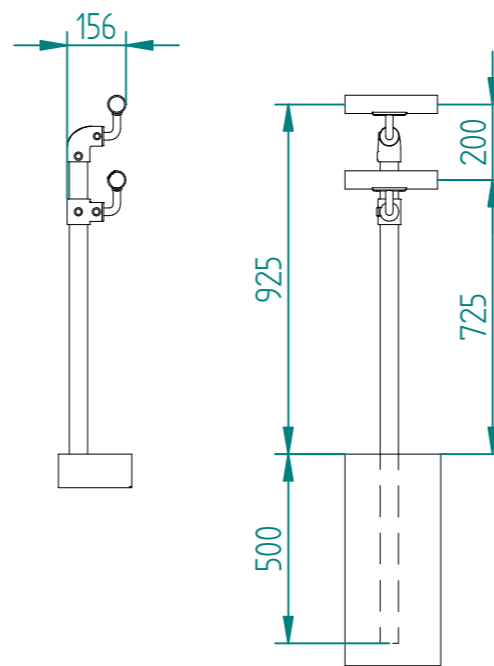

AR120

INGROUND MOUNT

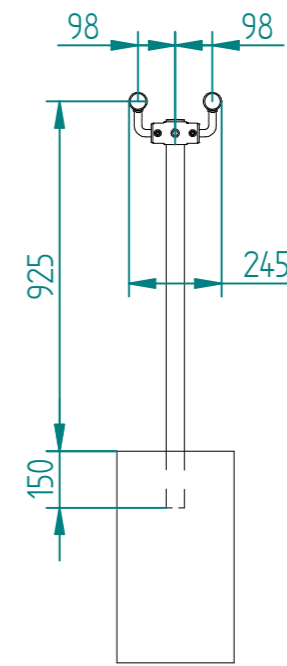

AR130

CORED MOUNT

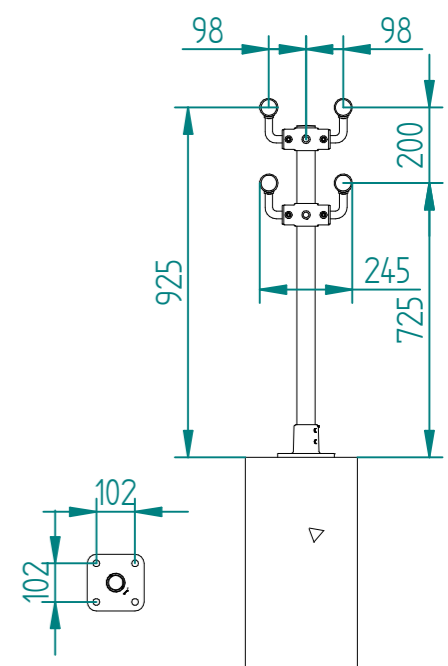

AR140

TOP MOUNT -T4

ALL DIMENSIONS IN MILLIMETERS  
 STANDARDS TOLERANCE ±1mm  
 MATERIAL FINISH: MINIMUM OF 1x1 BEVEL ON ALL EDGES  
 ALL PIPE TO CONFORM TO: AS 1074  
 GALVANIZED TO: AS/NZS 4680:2006

No	REVISION	DRAWN	DATE
0	Initial Design Intent	HGR	6/6/17



44 Kalman Drive  
 BORONIA VIC 3155  
 T1 03 8727 9055  
 E1 technical@moddex.com.au

SCALE	1:10	A3
DRAWN	HGR	25/07/17
CHECKED	RDS	25/07/17
DESIGNED	-	-
APPROVED	-	-

ASSISTRAIL DRAWINGS	
PICTORIAL RULES	
-	

DRAWING/PART No.				
-				
Sheet				1 OF 2
ISSUE	A	B	C	D

AR150

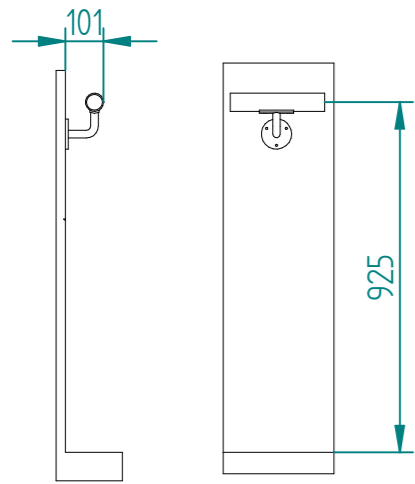

AR160

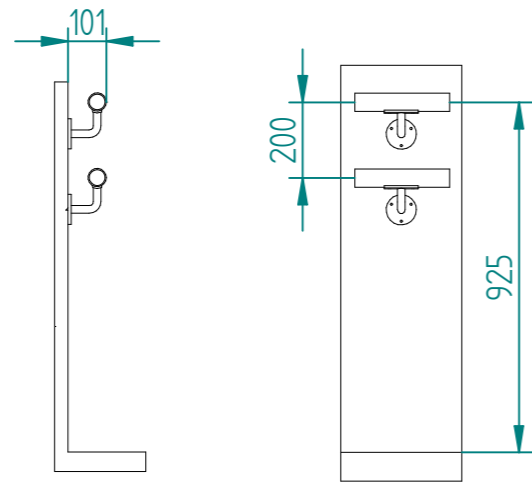

WALL MOUNT

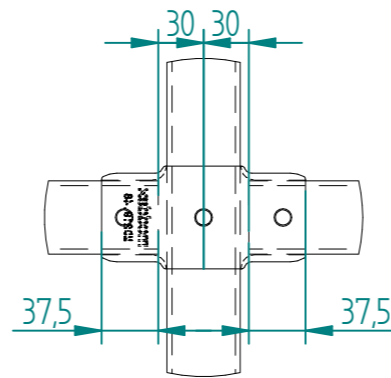

TYPICAL PIPE INSERTION

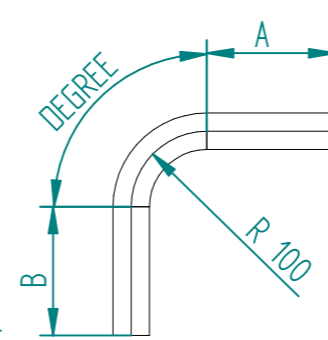

TYPICAL PIPE DIMENSIONS

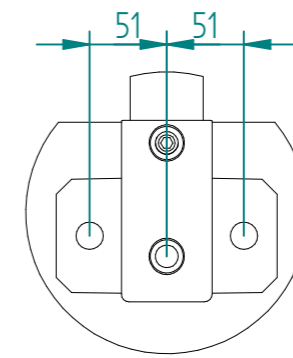

TYPICAL LEVEL HOLE CENTRES FOR F2, T2, C11 & C13

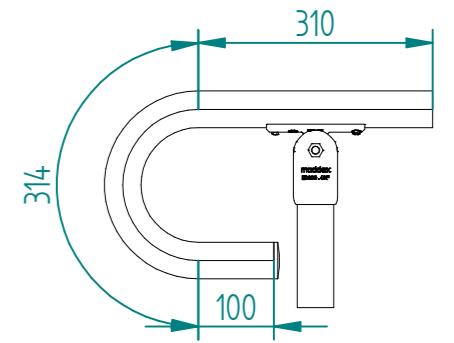

TYPICAL CLOSURE BEND

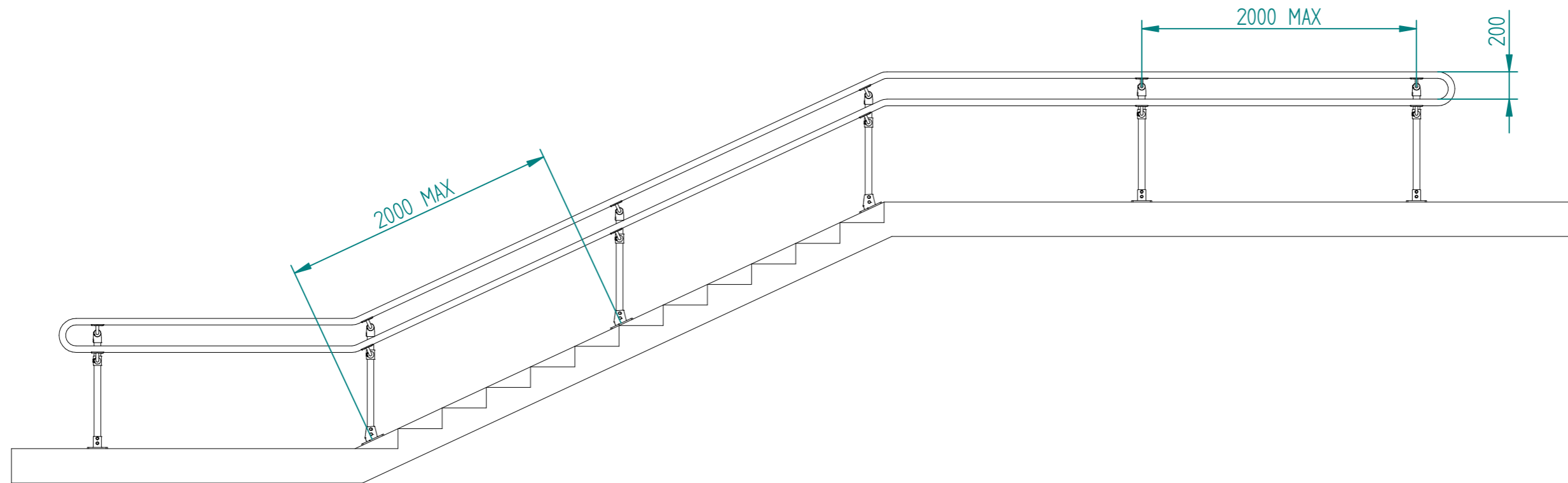

SECTION SHOWING STANDARD 2m SPACING

ALL DIMENSIONS IN MILLIMETERS  
 STANDARDS TOLERANCE ±1mm  
 MATERIAL FINISH: MINIMUM OF 1x1 BEVEL ON ALL EDGES  
 ALL PIPE TO CONFORM TO: AS 1074  
 GALVANIZED TO: AS/NZS 4680:2006

No	REVISION	DRAWN	DATE
0	Initial Design Intent	HGR	25/7/17

**moddex**

44 Kalman Drive  
 BORONIA VIC 3155  
 T1 03 8727 9055  
 E1 technical@moddex.com.au

SCALE	1:35	A3
DRAWN	HGR	25/07/17
CHECKED	RDS	25/07/17
DESIGNED		
APPROVED		

ASSISTRAIL DRAWINGS	
PICTORIAL RULES	
-	

DRAWING/PART No.				
-				
Sheet				2 OF 2
ISSUE	A	B	C	D