

Your Global Partner for

PRECISION MECHANICAL COMPONENTS



Supply Technologies[™]
The efficiency experts.

www.supplytechnologies.com

Providing the **PRECISION** **ENGINEERED COMPONENTS** You Demand. Every Day.

For 100+ years, Supply Technologies has continued with one defining goal: To help enable our customers to build their products better, smarter and faster than ever before.

For over a decade, our Precision Mechanical Components Team has seamlessly supplied millions of engineered products to the world's leading manufacturers, while establishing global benchmarks that define superior performance, quality and cost efficient procurement processes.

Through focused attention to our customers' diverse and growing needs, we have revolutionized the way companies plan, source, transport and manage their engineered components.

Supply Technologies is your expert partner in these key areas:

- Lowering total costs through reduction in resource requirements
- Consolidating multiple supply bases
- Establishing cost competitiveness in all markets
- Cost reduction through material process and labor optimization
- Positioned to service any account globally
- Providing proven value-engineered services
- Customized VMI programs specific to facility and need

For all of your Precision Mechanical Components, Supply Technologies is your comprehensive solution.

Precision Mechanical Components

Precision Mechanical Components (PMC) are individual highly engineered part(s) or a series of assembled parts that are unique to your finished product. Combined they enable your end product to function and operate to the desired operating specifications. We have a comprehensive list of PMC product capabilities to fulfill your needs. Our sales engineers can identify and source these components and make them a part of our overall product and service offering.

Comprehensive Product Capabilities

Castings (Ferrous/Non-ferrous)
CNC Machined Parts
Cold-Formed Parts
Extrusions
Latches/Handles (Hardware)
Plastic Parts (Extruded/Molded)
Powder Metal Components
Rubber Parts (Extruded/Molded)
Screw Machine & Turned Parts
Small Assemblies
Spring & Wire Forms
Stampings



Supply Technologies offers product development assistance including consulting, sourcing and delivery of a variety of complex components as prototypes and in production quantities.

Quality Assured

Our Technical Services Team performs the industry's most rigorous component testing, both at supplier facilities and our regional worldwide inspection centers. In addition, our supplier development and retention process proactively self-regulates our own quality standards. SupplyTechnologies' commitment to quality is embodied by our being third-party registered to the most current version of the following quality, environmental, and laboratory standards: ISO 9001, ISO 14001, ISO 17025 and AS 9120.

Designing Engineering Efficiencies

A critical function of our Technical Services Team is its ability to work closely with our customers' engineers to design efficiencies into existing and new products. We are an extension of your own departments by bringing experience to facilitate design development, improve assembly line ergonomics, and reduce costs.

At our **Dedicated Tear Down Facility**, we dismantle finished products regularly. Our goal is to develop the most technically superior end-use products and solutions available in the marketplace through:

- Improved designs
- Elimination of redundant parts
- Efficient assemblies

Supply Technologies offers assembly solutions to provide floor space optimization, supplier rationalization and inventory reduction.



We enable your engineers to focus on their next innovation.

Utilizing advanced technologies, including 3D Printing, CAD imaging for both end-use product and piece-part design, we have proven time and time again that our ultimate value extends beyond individual piece prices.

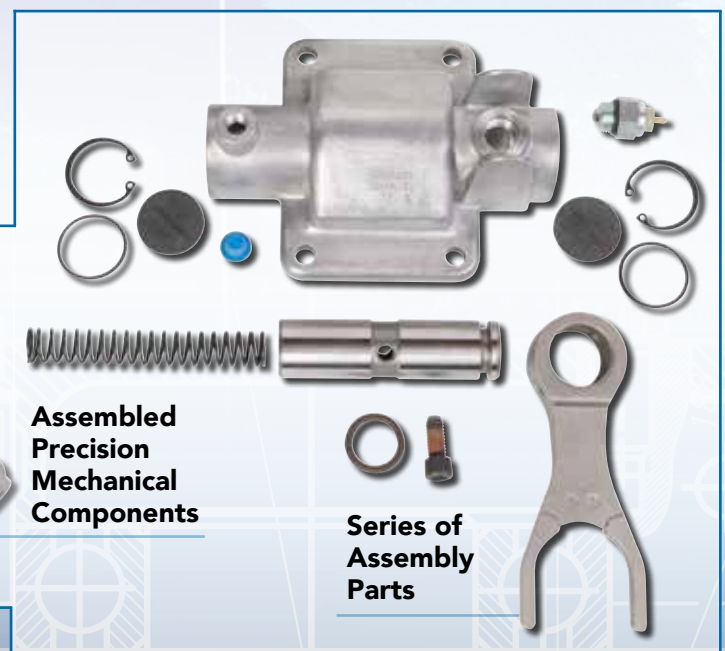

Assembled Precision Mechanical Components

Series of Assembly Parts



**Enabling manufacturers to build their
products better, smarter, and faster
than ever before.**



6065 Parkland Blvd., Cleveland, OH 44124

A ParkOhio Company
Cleveland, Ohio USA
NASDAQ Symbol PKOH

P: +1 440.947.2100

www.supplytechnologies.com

marketing@supplytechnologies.com