

How to make a template to mount your plaque to a surface

You will need the following items:

- A piece of heavy paper 3" – 4" wider than your plaque on all four sides (paper grocery bag works great too)
- Small amount of paint (latex dries the fastest)
- Small artist paint brush
- Putty knife
- Scissors
- Pen or pencil



Step 1: Clean an area off to work on. Lay your paper on a flat surface. Tape all four corners to the surface to restrict movement.

Step 2: Place your plaque face down on a flat clean surface. Ensure that the area is free of debris that could scratch the surface of the plaque.

Please note that there are multiple pre-drilled holes on the rear side of the plaque.

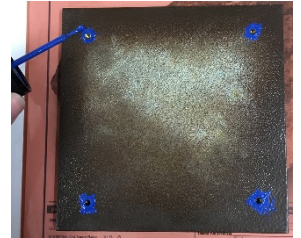

Step 3: Dip the small paint brush tip into the paint. Apply a small amount of paint around the perimeter of each pre-drilled hole, ensuring that there is enough paint to allow the transfer of each hole location onto the template. Turn the plaque over & place on the paper template (centered).



Using a pen or pencil, trace the outline of the plaque. Write the word "TOP" at the top above the plaque and "BOTTOM" at the bottom under the plaque on the paper to identify the orientation of the template on the surface the plaque will be mounted on.

Using a small putty knife, carefully tilt the plaque up on one side to reveal the transferred locations on the template. If there is not a round hole shown on template, draw it in with pen or pencil.



Step 4: Wipe the plaque clean to remove any remaining paint

Step 5: You are now ready to install your plaque using your template.

Blind Stud Mount is the most common plaque installation method. What adhesive should you use with a blind stud? Lighter and smaller plaques can be installed with silicone (a good universal adhesive). Heavier and larger plaques should be installed with a "stronger" adhesive – see list below. Match your adhesive to the mounting surface and part weight. If in doubt, use a stronger industrial adhesive such as lexel, liquid nails or epoxy.

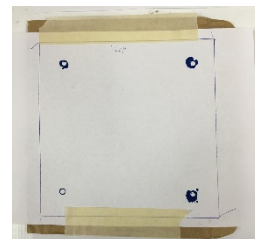



You will need the following items to install:

- Level
- Tape Measure
- Punch
- Drill (for installs on wood, stone, brick, concrete & etc.)
- Appropriate drill bit for the surface you'll be mounting the plaque on (studs are typically 3/16" or 1/8")
- Liquid adhesive (Lexel or equivalent)

Step 1: Select location on wall. Tape paper template onto surface, making sure position of plaque is level on the mounting surface. *Tip: If mounting on uneven surface, attach the pattern to cardboard first. Poke holes in cardboard per pattern.*

Step 2: Drill each hole location with a drill bit that is the same size in diameter than the stud size. Measure the length of studs to determine the depth of the hole, drilling slightly deeper than the stud. After all holes are drilled, remove the template from the wall. Make sure that all dust is then removed from the holes.

Step 3: Place your plaque face down on a flat clean surface. Screw studs into plaque – HAND TIGHTEN ONLY.

Step 4: Before using liquid adhesive, verify stud locations match all holes drilled (DO NOT INSERT INTO HOLES AS YOU MAY NOT BE ABLE TO REMOVE THE PLAQUE). If all the studs align with the holes, put a dab of liquid adhesive in the holes. *Tip: Coat the studs with ample adhesive by inserting into the liquid adhesive tube.*

Step 5: Press plaque into position. You may use a padded 2 x 4 block and mallet to drive the studs further into the holes (going side to side until it is firmly in place). Be sure plaque is tight against the surface (brace for an hour or two or as stated in the liquid adhesive instructions if needed).

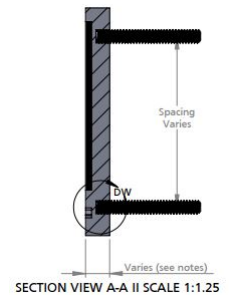
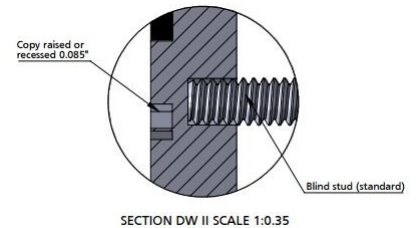
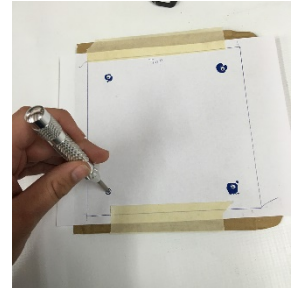

If you have any questions during installation, please contact us.

How to install your plaque on a rock

You will need the following items to install:

- Level
- Tape Measure
- Punch
- Drill
- Appropriate drill bit for rock (studs are typically 3/16" or 1/8")
- Liquid adhesive (Lexel or equivalent)

Step 1: Select location on rock. Tape cardboard template onto surface, making sure position of plaque is level on the mounting surface. *Tip: Poke holes in cardboard per pattern.*

Step 2: Drill each hole location with a drill bit that is the same size in diameter than the stud size. Measure the length of studs to determine the depth of the hole, drilling slightly deeper than the stud. After all holes are drilled, remove the template from the wall. Make sure that all dust is then removed from the holes.

Step 3: Place your plaque face down on a flat clean surface. Screw studs into plaque – HAND TIGHTEN ONLY.

Step 4: Before using liquid adhesive, verify stud locations match all holes drilled (DO NOT INSERT INTO HOLES AS YOU MAY NOT BE ABLE TO REMOVE THE PLAQUE). If all the studs align with the holes, put a dab of liquid adhesive in the holes. *Tip: Coat the studs with ample adhesive by inserting into the liquid adhesive tube.*

Step 5: Press plaque into position. You may use a padded 2 x 4 block and mallet to drive the studs further into the holes (going side to side until it is firmly in place). Be sure plaque is tight against the surface (brace for an hour or two or as stated in the liquid adhesive instructions if needed). *If you have any questions during installation, please contact us.*

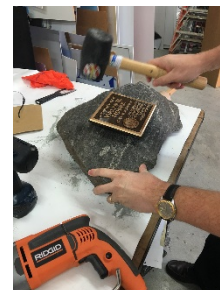
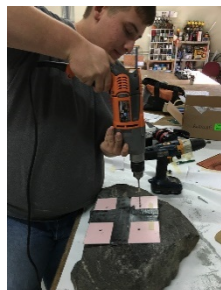
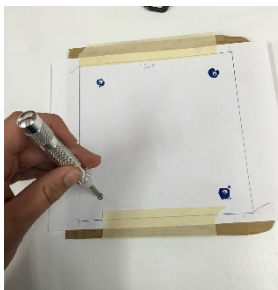



How to install your plaque on a stake

You will need the following items:

- Shovel (or Post Hole Digger to dig hole)
- Ready Mix Concrete
- Water
- 5 Gallon Bucket or similar
- Mixing Trough or similar
- Screw Driver

Step 1: Dig hole 6" deep for 24" stake or 8" deep for 36" stake.

Step 2: Mix concrete per instructions on package.

Don't use too much water. You want the concrete to be thicker rather than thinner/watery.

Step 3: Insert stake notched end down (Plaque installs on bent end).

Step 4: Cover concrete with dirt and landscaping/grass.

Step 5: Screw Plaque to Stake. DO NOT OVERTIGHTEN SCREWS!

If you have any questions during installation, please contact us.



How to install your plaque on a Post & Bracket

You will need the following items:

- Shovel (or Post Hole Digger to dig hole)
- Ready Mix Concrete
- Water
- 5 Gallon Bucket or similar
- Mixing Trough or similar
- Long Screw
- Screwdriver
- Hacksaw or similar tool to cut post

Step 1: Dig hole for post (decide the height of the plaque from the ground, you'll need a third of the height in the ground: i.e. 36" tall & 12" in the ground = 36" total).

Step 2: Cut the post to length with a hacksaw (or similar tool).

Step 3: Mix concrete per instructions on package.

Don't use too much water. You want the concrete to be thicker rather than thinner/watery.

Step 4: Prior to installing in the ground, screw a long screw through the end that will go into the concrete. This helps the post "grab" into the concrete.

Step 4: Cover concrete with dirt and landscaping/grass.

Step 5: Screw Plaque to Bracket. DO NOT OVERTIGHTEN SCREWS

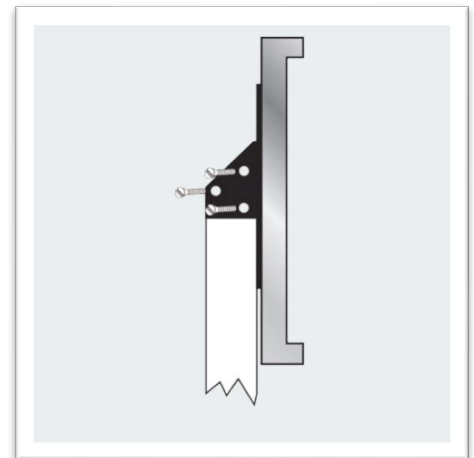

If you have any questions during installation, please contact us.



How to install your etched plaque on a wall with tape

You will need the following items:

- Level
- Masking Tape

Your Plaque will come with super adhesive 3M tape pre-applied to the back.



Step 1: Wipe surface down with cloth or paper towel.

Step 2: Cut strip of masking tape the same length of your plaque and use the level to adhere to wall.

Step 3: Peel tape off the back of plaque. Hold plaque 90 degrees and line the top of the plaque up with the bottom of the tape. Slowly tilt plaque down flush with the wall. Push firmly against wall to adhere. Remove masking tape when finished.

If you have any questions during installation, please contact us.

How to install your etched plaque on bench or wooden surface

You will need the following items:

- Level
- Tape Measure
- Drill
- Appropriate drill bits for the surface you'll be mounting the plaque on
- Liquid adhesive (Lexel or equivalent)
- Paper Template (from page 1)

Step 1: Select location. Tape paper template onto the wood, making sure position of plaque is level.

Tip: If mounting on uneven surface, attach the pattern to cardboard first.

Step 2: Drill each hole location with a drill bit that is the same size in diameter as the stud. Drill the holes through the wood or the length of the stud depending on the thickness of the wood. Measure the stud boss. Choose a drill bit the same size diameter as the stud boss. Using masking tape as a guide on the drill bit, place tape around the drill bit so only the size of the stud boss will be drilled (i.e. if your stud boss measures $\frac{1}{4}$ " place the tape $\frac{1}{4}$ " back from the tip of the drill bit as shown in the picture on the right). Re-drill holes for stud boss thickness. After all holes are drilled, remove the template. Make sure that all dust is then removed from the holes (if using liquid adhesive).

Step 3: Place your plaque face down on a flat clean surface.

Screw studs into plaque – HAND TIGHTEN ONLY.

Step 4: Press plaque into position. Be sure plaque is tight against the surface. Thread nuts on the studs on the back side of the wooden surface and tighten.

*If your plaque installs into a thick piece of wood, use a liquid adhesive to secure plaque in wood. Before using liquid adhesive, verify stud locations match all holes drilled (DO NOT INSERT INTO HOLES AS YOU MAY NOT BE ABLE TO REMOVE THE PLAQUE). If all the studs align with the holes, put a dab of liquid adhesive in the holes. *Tip: Coat the studs with ample adhesive by inserting into the liquid adhesive tube.* Press plaque into position. You may use a padded 2 x 4 block and mallet to drive the studs further into the holes (going side to side until it is firmly in place). Be sure plaque is tight against the surface (brace for an hour or two or as stated in the liquid adhesive instructions if needed).

If you have any questions during installation, please contact us.

