



# MH110

MATERIAL HANDLING | MACHINE TENDING | PRESS TENDING

### KEY BENEFITS

Increased design flexibility and layout options.

Small mounting surface and minimum interference radius save valuable floorspace.

Reduced floorspace requirements improve cycle time.

Ideal for a wide variety of applications.

Slim wrist profile for high density spacing and for reaching into confined spaces.

### SPECIFICATIONS

110 kg payload

2,236 mm horizontal reach

3,751 mm vertical reach

±0.07 mm repeatability

Floor mounted

### CONTROLLERS



DX200



MLX300\*

- Powerful six-axis handling robot features high-rigidity speed reducers and high-speed motion which reduce cycle times.
- Increased payload capacity and increased speed of each axis over previous models.
- High payload and high moment and inertia ratings allow this robot to handle larger and heavier payloads.
- Streamlined upper arm design features a slim wrist profile.
- New compact base design reduces robot interference radius to only 491 mm. This allows the robot to be mounted closer to machines and fixtures, making best use of valuable floorspace.
- New design removes the counterbalance from robot base. This reduces the mass of the arm, enabling higher acceleration, deceleration and speed.
- Up to 70% less power consumption during motion and 25% savings during idle periods compared to previous models.
- Cables and air lines are routed through robot base to upper arm to increase cable life, enhance safety and reduce teaching time.
- Pre-wired for servo gripper which allows a wider range of product handling.
- Pre-wired with internal DeviceNet cable that can be used for robot upper arm and/or gripper.
- Cable installation tube in robot base facilitates fieldbus routing to the upper arm and/or gripper.

# MH110 ROBOT

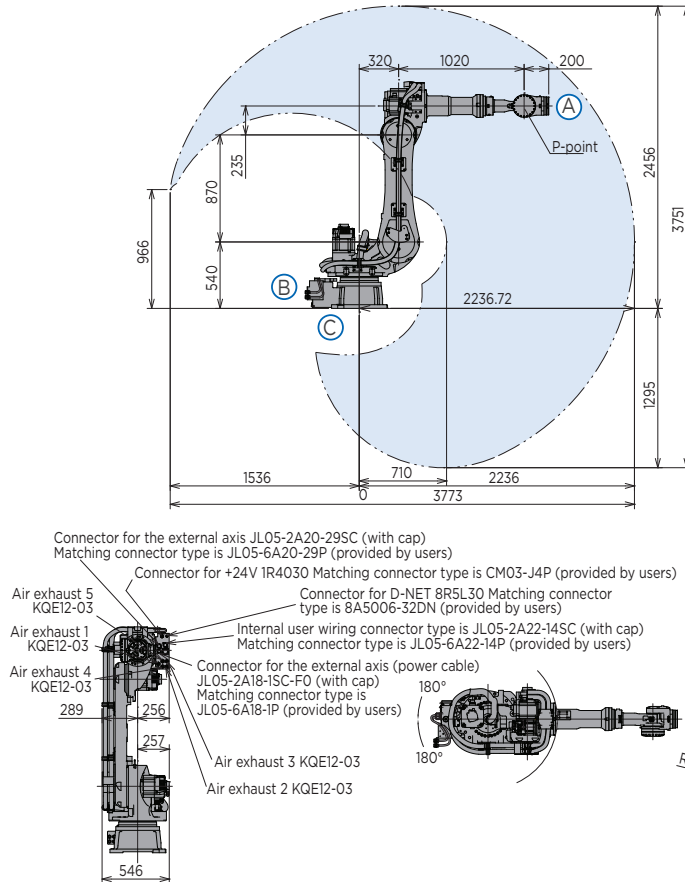

All dimensions are metric (mm) and for reference only.  
Request detailed drawings for all design/engineering requirements.

## VIEW A

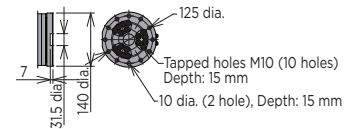

## VIEW B

Internal user wiring connector type is JL05-2A24-28PC (with cap)  
Matching connector type is JL05-6A24-28S (provided by users)

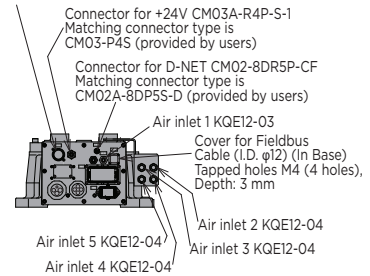

## VIEW C

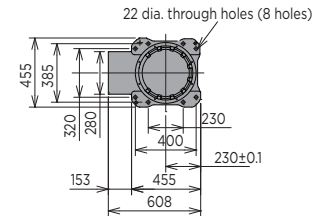

## SPECIFICATIONS: MH110

Axes	Maximum motion range [°]	Maximum speed [°/sec.]	Allowable moment [N·m]	Allowable moment of inertia [kg·m <sup>2</sup> ]	Controlled axes	6
S	±180	140	-	-	Maximum payload [kg]	110
L	+155/-90	110	-	-	Repeatability [mm]	±0.07
U	+160/-185	130	-	-	Horizontal reach [mm]	2,236
R	±360	175	721	60	Vertical reach [mm]	3,751
B	±125	175	721	60	Temperature [°C]	0 to +45
T	±360	255	294	33.7	Humidity [%]	20 - 80
					Weight [kg]	625
					Power requirements	3-phase; 240/480/575 VAC at 50/60 Hz
					Power rating [kVA]	5.0
					Internal I/O cable [conductors w/ ground]	24 conductors
					Internal air line [connections]	(5) 3/8"

\* The MLX300 software option is not available for use with arc or spot welding, coating, dispensing, cutting or other "path control" applications.  
MLX300 fieldbus cards, I/O cards and vision equipment must be purchased separately from the supplier. All peripherals are programmed using a PLC.

## OPTIONS

Extended length manipulator cables  
Robot risers and base plates  
External axis kits  
Wide variety of fieldbus cards  
Vision systems  
Robot base and upper arm I/O cables

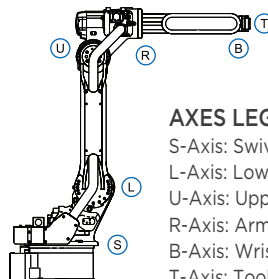

### AXES LEGEND

S-Axis: Swivel Base  
L-Axis: Lower Arm  
U-Axis: Upper Arm  
R-Axis: Arm Roll  
B-Axis: Wrist Bend  
T-Axis: Tool Flange

**Yaskawa America, Inc.**  
**Motoman Robotics Division**

100 Automation Way  
Miamisburg, OH 45342  
Tel: 937.847.6200  
Fax: 937.847.6277

**motoman.com**

# YASKAWA