



## MH5S II MH5LS II

ARC WELDING | ASSEMBLY | CASE PACKING | KITTING  
MACHINE TENDING | PART TRANSFER | PICK & PLACE

### KEY BENEFITS

Compact and powerful design  
Applicable to various industry environments  
Highly reliable  
Unlimited application possibilities

### SPECIFICATIONS

5 kg Payload  
Repeatability:  
MH5S II:  $\pm 0.02$  mm  
MH5LS II:  $\pm 0.03$  mm  
Maximum Reach:  
MH5S II: 706 mm  
MH5LS II: 895 mm

### CONTROLLERS

|                                     |                                     |
|-------------------------------------|-------------------------------------|
| <input checked="" type="checkbox"/> | <input checked="" type="checkbox"/> |
| DX200                               | FS100                               |
| <input checked="" type="checkbox"/> | <input checked="" type="checkbox"/> |
| MLX200                              | MLX300*                             |

- Compact, six-axis robots with 5 kg payload capacity and high axial speeds.
- The MH5S II features a horizontal reach of 706 mm and vertical reach of 1,193 mm; it offers the widest work envelope in its class.
- The MH5LS II features a horizontal reach of 895 mm and vertical reach of 1,560 mm due to its extended lower and upper arm.
- Lightweight and compact base design is ideal for tabletop-, ceiling- or wall-mount installations\*, saving valuable floor space.
- Slim upper arm design reduces potential interferences. Shortened distance between the B-axis and T-axis enhances carrying capacity with high moments of inertia.
- Internally routed airlines and electrical wires eliminate cable interference, enhance cable life and improve reliability.
- Auxiliary equipment, such as valve packs, can be mounted on upper arm to simplify design and maintain optimal tool performance.
- The MH5S II and MH5LS II robots are applicable to a wide range of tasks - from small parts assembly and machine tending, to high-speed case packing and arc welding.
- Available with several robot controllers tailored to specific application and plant skill set.

# MH5S II | MH5LS II ROBOTS

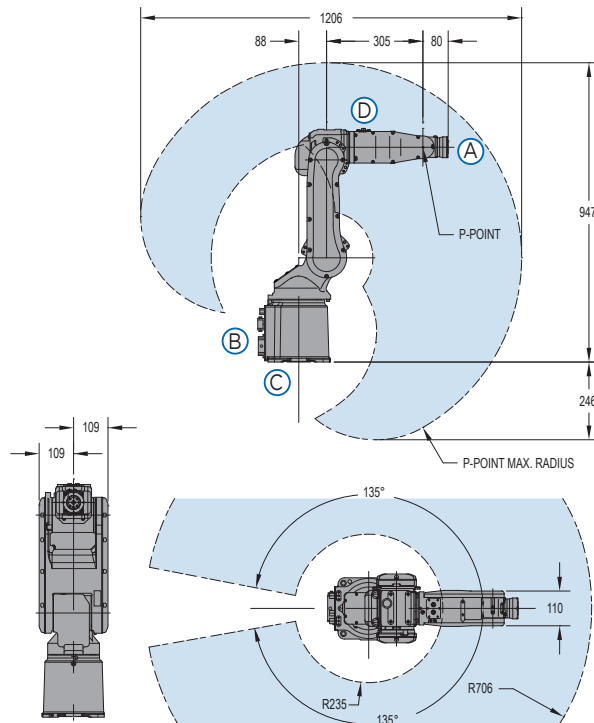

All dimensions are metric (mm) and for reference only.  
Request detailed drawings for all design/engineering requirements.

VIEW A

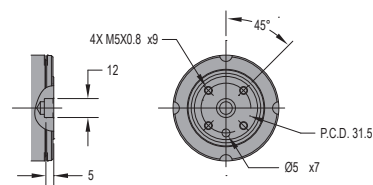

VIEW B

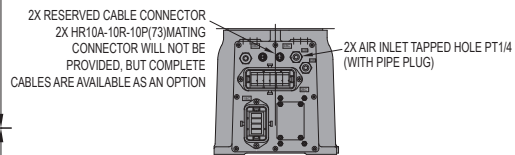

VIEW C

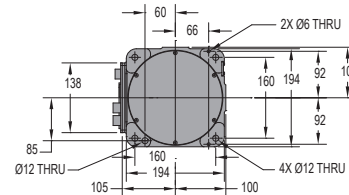

VIEW D

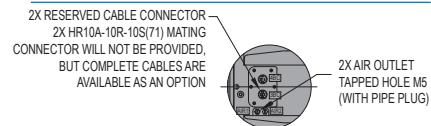

## SPECIFICATIONS: MH5S II | MH5LS II

| Axes | Maximum motion range [°] |           | Maximum speed [°/sec.] |          | Allowable moment [N•m] | Allowable moment of inertia [kg•m²] |                                      | MH5S II                                   | MH5LS II                                  |
|------|--------------------------|-----------|------------------------|----------|------------------------|-------------------------------------|--------------------------------------|---|---|
|      | MH5S II                  | MH5LS II  | MH5S II                | MH5LS II |                        |                                     | Controlled axes                      | 6   | 6   |
|      |                          |           |                        |          |                        |                                     | Maximum payload [kg]                 | 5   | 5   |
|      |                          |           |                        |          |                        |                                     | Repeatability [mm]                   | ±0.02                                     | ±0.03                                     |
| S    | ±170                     | ±170      | 376                    | 270      | -                      | -                                   | Horizontal reach [mm]                | 706                                       | 895                                       |
|      |                          |           |                        |          |                        |                                     | Vertical reach [mm]                  | 1,193                                     | 1,560                                     |
| L    | -65/+150                 | -65/+150  | 350                    | 280      | -                      | -                                   | Protection (IP rating)<br>Standard   | IP30                                      | IP30                                      |
| U    | -136/+255                | -138/+255 | 400                    | 300      | -                      | -                                   | Weight [kg]                          | 27  | 29  |
|      |                          |           |                        |          |                        |                                     | Power requirements<br>DX200 / MLX300 | 3-phase; 240/480/575 VAC<br>at 50/60 Hz   | 3-phase; 240/480/575 VAC<br>at 50/60 Hz   |
| R    | ±190                     | ±190      | 450                    | 450      | 12                     | 0.3                                 | FS100                                | 1- or 3-phase;<br>200/230 VAC at 50/60 Hz | 1- or 3-phase;<br>200/230 VAC at 50/60 Hz |
| B    | ±135                     | ±135      | 450                    | 450      | 12                     | 0.3                                 | MLX200                               | 3-phase; 200/230 VAC<br>at 50/60 Hz       | 3-phase; 200/230 VAC<br>at 50/60 Hz       |
| T    | ±360                     | ±360      | 720                    | 720      | 7                      | 0.1                                 | Power rating [kVA]                   | 1   | 1   |

\* The MLX300 software option is not available for use with arc or spot welding, coating, dispensing, cutting or other "path control" applications.  
MLX300 fieldbus cards, I/O cards and vision equipment must be purchased separately from the supplier. All peripherals are programmed using a PLC.

MLX-controlled robots are tested for floor mounting.  
Contact Yaskawa Motoman regarding different mounting requirements.

## OPTIONS

Extended length manipulator cables  
Robot risers and base plates  
External axis kits  
Wide variety of fieldbus cards  
Vision systems  
Robot base and upper arm I/O cables  
Blue robots

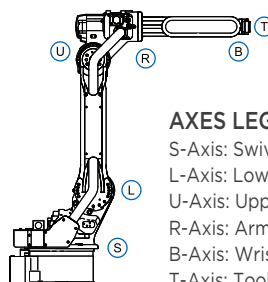

### AXES LEGEND

S-Axis: Swivel Base  
L-Axis: Lower Arm  
U-Axis: Upper Arm  
R-Axis: Arm Roll  
B-Axis: Wrist Bend  
T-Axis: Tool Flange

Yaskawa America, Inc.  
Motoman Robotics Division

100 Automation Way  
Miamisburg, OH 45342  
Tel: 937.847.6200  
Fax: 937.847.6277

[motoman.com](http://motoman.com)

# YASKAWA