

**5<sup>th</sup>**  
**ANNUAL**



**WORLD  
CONGRESS**

FORMERLY KNOWN AS

**biotechandmoney**  
WORLD CONGRESS

**medtechandmoney**  
WORLD CONGRESS

**5-6 FEBRUARY 2019**

**ETC. VENUES | 200 ALDERSGATE | LONDON | UK**

**#LSXWORLD**

[WWW.LSXLEADERS.COM/LSX-WORLD-CONGRESS](http://WWW.LSXLEADERS.COM/LSX-WORLD-CONGRESS)

ORGANISED BY:



The network  
for life science  
executive leaders

FORMERLY KNOWN AS  
**biotechandmoney**  
bringing deals to life

# STRATEGY, INVESTMENT AND PARTNERING FOR LIFE SCIENCE EXECUTIVE LEADERS

Welcome to the LSX World Congress (formerly known as Biotech and Money / Medtech and Money World Congress).

We've got a lot in store for the 5th annual edition of Europe's leading executive investment, partnering and strategy congress. The first thing to note is the change of name. After four successful years as the Biotech and Money World Congress, which expanded to incorporate Medtech and Money in 2017, we felt the name was not truly reflective of where we are heading, and the value that we are offering our customers and partners. LSX World Congress Europe represents the breadth and calibre of the science, senior leadership, and the strategic partnering and investment opportunities in Europe's world-class life sciences sector.

Welcome to **LSX** - **L**ife **S**cience **E**xecutive Leaders!

We retain our relentless focus on quality peer-to-peer discussion, high-level networking and partnering, unique formats and a vetted, high-calibre audience, to bring together the people that matter to the future of healthcare and life science funding, finance, investment and deal making.

For 2019, along with the change of name, we're excited to bring you a number of new exciting additions to the content, formats, networking and 1-2-1 partnering opportunities.

We have three very eventful days lined up and are delighted that you've chosen to join us for our biggest event to date. We hope you have an enjoyable and fruitful event!

**The LSX World Congress Team**

## KEY STATISTICS OF THE CONGRESS



**700+**  
EXECUTIVES



**300+**  
INVESTORS & PHARMA



**100+**  
SPEAKERS



**1500+**

PRE-ARRANGED MEETINGS



**60+**  
SHOWCASES



**#LSXWORLD**

# WHAT'S NEW IN 2019?



## TWO DAY STRATEGY & INNOVATION TRACK

ALONGSIDE FINANCE & INVESTMENT



## 3 CEO FORUMS

STARTUP, PRIVATE & PUBLIC



## INNOVATION ZONE



## BD LEADERS' FORUMS

PHARMA & COMMERCIAL LEADERS



## FINANCE AND CLINICAL WORKSHOPS

# CONTENTS

Introduction / Key Stats	2
Contents / What's New in 2019?	3
Why Attend?	4
Biotech Agenda at a Glance	5
Event Map	6
Biotech Day 1 Satellite Sessions	7-8
Innovation Zone	9
Biotech Day 2 & Satellite Sessions	10
Medtech Agenda at a Glance	11
Networking Opportunities	12
Sponsors	13
Pre-Day IPO Bootcamp / Venue	14
2018 Attending Companies	15
2018 Key Stats	16
Contact Us	17



**#LSXWORLD**

# 8 REASONS TO ATTEND...

- 1** **UNDERSTAND...** the latest trends, forecasts and insights from leading investment funds, life science company executives, pharma BD&L heads and industry KOLs
- 2** **HEAR...** case studies advice and key success factors from CEOs who have taken their companies through key milestones in our fireside chats
- 3** **UNCOVER...** the latest exciting new technologies being developed by Europe's leading research institutions in our Innovation Zone
- 4** **MEET AND PARTNER...** through our 1-2-1 partnering system to find investors, scout investment opportunities and connect with potential partners
- 5** **NETWORK...** with 700+ life science CxOs, investors and pharma convening to address key executive issues facing their businesses and the wider healthcare sector
- 6** **PRESENT...** your company to an audience of qualified investors and pharma BD&L in the Inv€\$table showcase sessions
- 7** **JOIN...** intimate workshops run by the industry's foremost experts to help prepare your company for key milestones and explore innovative models for company growth
- 8** **CONNECT WITH PURPOSE...** to our community of life science executive leaders

## SATELLITE SESSIONS

 **INV€\$TABLE**

 **INNOVATION ZONE**

 **PHARMA BD LEADERS FORUM**

 **COMMERCIAL LEADERS BD FORUM**

 **M&A WORKSHOP**

 **CLINICAL TRIALS INNOVATION WORKSHOP**

 **PUBLIC CEO FORUM**

 **PRIVATE CEO FORUM**

 **STARTUP CEO FORUM**

 **IPO BOOTCAMP**



**#LSXWORLD**

# BIOTECH AGENDA AT A GLANCE

## DAY 1



FINANCE &  
INVESTMENT

STRATEGY &  
INNOVATION



## DAY 2

# BIOTECH AGENDA AT A GLANCE - DAY 2



FINANCE &  
INVESTMENT

STRATEGY &  
INNOVATION



# EVENT MAP



**INVESTABLE**  
HEALTH/DEEP TECH

**INVESTABLE**  
BIOTECH

**PUBLIC**  
CEO FORUM

**INNOVATIVE**  
FINANCING  
WORKSHOP

**PRIVATE**  
CEO FORUM

**CLINICAL TRIALS**  
INNOVATION  
WORKSHOP

**COMMERCIAL**  
LEADERS  
BD FORUM

**STARTUP**  
CEO FORUM

**medtechandmoney**  
WORLD CONGRESS

**PHARMA BD**  
LEADERS FORUM

**INVESTABLE**  
MEDTECH

**STRATEGY &**  
**INNOVATION**

**FINANCE &**  
**INVESTMENT**

**INNOVATION**  
ZONE

**EXHIBITION**

**1-2-1 PARTNERING**

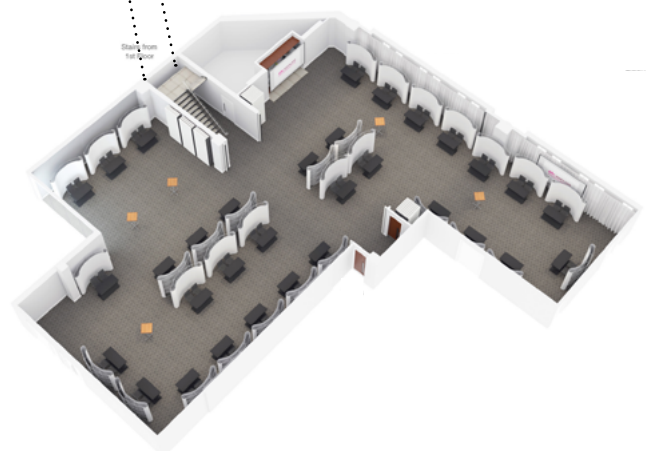
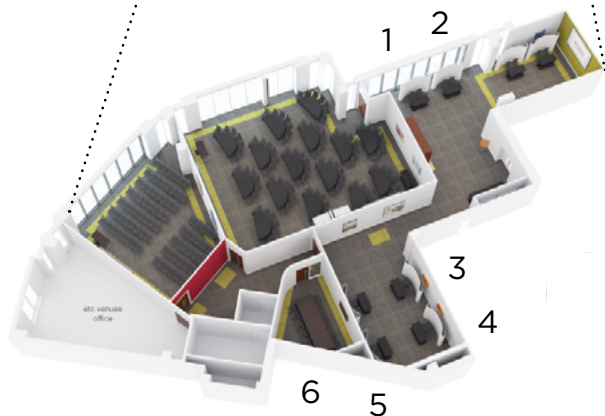

- 1 - Available
- 2 - Available
- 3 - Available

- 4 - Available
- 5 - Available
- 6 - Available

Private meeting and partnering booths alongside standard networking tables for pre-arranged meetings with our 1-2-1 partnering system, Meeting Mojo.

# DAY 1 - Showcases & Satellite Sessions

## NETWORKING BREAK

10.30

11.00



CEOs from the most progressive biotech companies take to the podium to present their company and technology to qualified investors and Pharma BD&L

Seven companies will present in each section of the showcase agenda for 15 minutes including Q&A.

Presentation are recorded and a professional pitch video is created and provided to the showcasing companies.



A Chatham House Rule, invite-only forum for CEOs, CFOs, CBOs and chairmen of listed life science and healthcare companies.

The forum will feature peer-reviewed CEO and partner case studies, and an interactive general discussion.

The Public CEO Forum is open only to life sciences companies listed on the public markets.

Co-Hosts:



WHITE & CASE



A Chatham House Rule, invite-only forum designed for global and regional BD heads from Pharma and large-cap Biotech companies.

A Chatham House Rule forum in which industry leaders discuss and shape the future of their sector with peers.

The Pharma BD leaders' forum is only open to Heads of BD and M&A from top 30 pharma.

Co-Hosts:

12.50

13.50

## NETWORKING LUNCH



CEOs from the most progressive biotech companies take to the podium to present their company and technology to qualified investors and Pharma BD&L

Seven companies will present in each section of the showcase agenda for 15 minutes including Q&A.

Presentation are recorded and a professional pitch video is created and provided to the showcasing companies.



A Chatham House Rule, invite-only forum for CEOs, CFOs, CBOs and chairmen of private life science and healthcare companies.

The forum will feature peer-reviewed c-level and partner case studies, and an interactive general discussion.

The Private CEO Forum is only open to post series A private biotech companies.

Co-Hosts:



GOODWIN



A Chatham House Rule, invite-only forum designed for global and regional BD heads from Pharma and large-cap Biotech companies.

A Chatham House Rule forum in which industry leaders discuss and shape the future of their sector with peers.

The Pharma BD leaders' forum is open only to Heads of BD and M&A from top 30 pharma

Co-Hosts:

15.40

## NETWORKING BREAK

# DAY 1 - Showcases & Satellite Sessions

16.10



CEOs from the most progressive biotech companies take to the podium to present their company and technology to qualified investors and pharma BD&L

Five companies will present in each section of the showcase agenda for 15 minutes including Q&A.

Presentations are recorded and a professional pitch video is created and provided to the showcasing companies.



A Chatham House Rule, invite-only forum for CEOs of life science and healthcare startups.

The forum will feature peer-reviewed c-level and partner case studies, and an interactive general discussion.

The Private CEO Forum is only open to pre-series A private biotech and spinouts of our TTO partners.

Co-Hosts:



17.30

NETWORKING DRINKS



Connect  
with  
purpose

## BIOTECH SPEAKER AND AGENDA ENQUIRIES

Josh Dance, Senior Vice President  
josh@biotechandmoney.com  
+44 (0) 203 637 5908

## INVESTOR ENQUIRIES

Emily Vipond, Senior Vice President  
emily@biotechandmoney.com  
+44 (0) 203 637 5908

## BIOTECH PARTNERSHIP ENQUIRIES

Matt Pullan, SVP BD & Partnerships  
matt@biotechandmoney.com  
+44 (0) 203 637 5908

## MARKETING ENQUIRIES

Paul Gilbertson, Head of Marketing  
paul@biotechandmoney.com  
+44 (0) 203 637 5908



# INNOVATION ZONE



The MSD Innovation Zone is a dedicated format and room at the where we will be showcasing Europe's best start-up and early-stage entrepreneurs.

The Innovation Zone is set up as a 'Digital Poster Zone' with a rotating number of startups sharing their slides over the course of the two days to the World Congress delegation.

We will work with Europe's leading Tech Transfer Offices who will nominate their most exciting biotech, medtech and healthtech startups to showcase. We will inviting the following TTOs and many more to participate:



## AGENDA

### DAY 1

### DAY 2

11.00

#### NETWORKING BREAK

15 TTOs and research institutions showcase their most exciting entrepreneurs and spin out companies through digital posters.

15 TTOs and research institutions showcase their most exciting entrepreneurs and spin out companies through digital posters.

Early stage investors and potential partners are invited to connect and uncover with the next wave of life science innovation.

Early stage investors and potential partners are invited to connect and uncover with the next wave of life science innovation.

12.50

#### NETWORKING LUNCH

15 TTOs and research institutions showcase their most exciting entrepreneurs and spin out companies through digital posters.

15 TTOs and research institutions showcase their most exciting entrepreneurs and spin out companies through digital posters.

Early stage investors and potential partners are invited to connect and uncover with the next wave of life science innovation.

Early stage investors and potential partners are invited to connect and uncover with the next wave of life science innovation.

15.20

#### NETWORKING BREAK

# DAY 2 - Showcases & Satellite Sessions

10.30

## NETWORKING BREAK

11.00



CEOs from the most progressive biotech companies take to the podium to present their company and technology to qualified investors and pharma BD&L

Six companies will present in each section of the showcase agenda for 15 minutes including Q&A.

Presentation are recorded and a professional pitch video is created and provided to the showcasing companies.



The LSX M&A Workshop is a 1.5hr intimate, interactive forum in which CEOs and CFOs navigate the how, what, where and when of a successful M&A.

Delivering strategy, tactics, mechanics and ideas which are unique to a successful approach, the M&A workshop is designed for CEOs, CFOs and CBOs who are considering a merger or aquisition deal.

Co-Hosts:

ALLEN & OVERY

12.50

## NETWORKING LUNCH

13.50



CEOs from the most progressive biotech companies take to the podium to present their company and technology to qualified investors and pharma BD&L

Six companies will present in each section of the showcase agenda for 15 minutes including Q&A.

Presentation are recorded and a professional pitch video is created and provided to the showcasing companies.



The LSX Clinical Trials Innovation Workshop is a 1.5hr intimate, interactive forum in which a leading CRO partner and CxOs who have used interesting business model discuss and debate innovative approaches to successful clinical trials.

The workshop is designed for CEOs, CSOs and R&D Heads who are working to find solutions for delivering successful, cost effective and punctual clinical trials

Co-Hosts:

15.20

# MEDTECH AGENDA AT A GLANCE

## DAY 1



COMMERCIAL STRATEGIC INVESTMENT IN MEDTECH



SEED FUNDING THE FUTURE OF MEDTECH

MEDTECH VENTURE CAPITAL

FUNDING NEW TECHNOLOGICAL FRONTIERS: AI, VR, AR

ANATOMY OF... FINANCING CASE STUDIES



CEOs from the most progressive medtech, diagnostic, device and healthtech companies take to the podium to present their company and technology to qualified investors and pharma BD&L

Seven companies will present in each section of the showcase agenda for 15 minutes including Q&A.

Presentation are recorded and a professional pitch video is created and provided to the showcasing companies.



An invite-only forum designed for global BD heads from Medtech Commercial Leaders.

A Chatham House Rule forum in which industry leaders discuss and shape the future of their sector with peers.

The Commercial Leaders BD forum is only open to Heads of BD from top 15 commercial leaders.

Co-Hosts:

## DAY 2



MEDTECH DEAL-MAKING & PARTNERSHIPS

BUILDING MEDTECH COMPANIES AT SCALE

MEDTECH MEGA DEALS

ANATOMY OF... DEAL CASE STUDIES



CEOs from the most progressive medtech, diagnostic, device and healthtech companies take to the podium to present their company and technology to qualified investors and pharma BD&L

Seven companies will present in each section of the showcase agenda for 15 minutes including Q&A.

Presentation are recorded and a professional pitch video is created and provided to the showcasing companies.

# NETWORKING OPPORTUNITIES

## 1-2-1 PARTNERING



The Congress provides dedicated out of session networking time to hold those all important face-to-face meetings. To ensure you maximise this time, we will provide attendees access to Meeting Mojo, the Congress' 1-2-1 partnering system to create an online profile, search for potential partners and book meetings.

The partnering system will go live around three weeks prior to the event. Meetings arranged through Meeting Mojo will be allocated a table in the partnering area at the Congress.

## DRINKS RECEPTION

The perfect way to network, unwind and make unexpected connections after an action-packed day at the World Congress!

Join the Life Science Executive Leaders community and raise a drink to a successful day of learnings, insights and connections!

The drinks reception takes place in the Galleria after the conference closes on day one.



## INNOVATION ZONE



Meet and connect with entrepreneurs from across Europe who are showcasing the latest life science and healthcare technologies coming out of Europe's leading academic and research and development institutions.

The Innovation Zone, hosted by MSD, runs across both days and is a unique opportunity to network and connect with the next wave of innovation in health!

## INVESTOR DINNER

Investors are invited to join our exclusive three-course investor dinner to relax and connect with their peers over great food and great wine.

Places are limited, so book your seat early.

The dinner will take place offsite at a banquet hall near the conference venue.



PLATINUM SPONSORS

---



GOLD SPONSORS

---

ALLEN & OVERY



COVINGTON



WHITE & CASE

SILVER SPONSOR

---



BIOTECH PARTNERSHIP ENQUIRIES

Matt Pullan, SVP BD & Partnerships  
matt@biotechandmoney.com  
+44 (0) 203 637 5908

MEDTECH PARTNERSHIP ENQUIRIES

Tom Roberts, VP BD & Partnerships  
tom@biotechandmoney.com  
+44 (0) 203 637 5908

9.00

The IPO Bootcamp is a full-day forum in which a team of some of the world's foremost experts, advisers, bankers and consultants help eight CEOs and CFOs navigate the how, what, where and when of a successful IPO. The key USPs are a very high level and calibre of attendee and program, exclusivity, and a personalised approach.

In addition to 'no holds barred' discussions, it features tailored sessions, where each registering executive and company received individual attention from the experts to talk through strategy, tactics, mechanics and ideas unique to them.

Discussions include, but are not limited to:

- Keynote address: the current state of capital markets
- Anatomy of an IPO: Back-to-back case study discussions of IPOs  
*One will feature a recent success story and one where the outcome was below expectation*
- Determining and defining your IPO strategy
- Legal preparations
- Financial PR and communications
- Regulatory requirements and IPO checklists

Co-Hosts:



COVINGTON



17.00

LEERINK



CLOSE OF BOOTCAMP

## VENUE - ETC. VENUES, 200 ALDERSGATE

Located at 200 Aldersgate near St. Paul's Cathedral & The Barbican, the is a state of the art conference and exhibition centre.

Benefiting from a fantastic location near to St. Paul's Cathedral and The Barbican, directly opposite the Museum of London, the venue is the perfect location for the biggest World Congress yet.

Etc. Venues St Paul's  
200 Aldersgate  
St Paul's  
London  
EC1A 4HD



# 2018 ATTENDING COMPANIES

28 North Discovery	Coulter Partners	Inceptua	Oxford BioMedica
4Bio Capital	Covington & Burling	Industrifonden	Oxford Technology Management
4D pharma	CRB Inverbio	InflaRx GmbH	Oxford University Innovation
4SC	Crescendo Biologics Ltd	Informa Group	Oxon
Abingworth	Crescent Enterprises	InHealth Ventures	OxSonic
Ablynx	CRISPR Therapeutics Limited	INKEF Capital	OxStem
Accelerace	CTI Life Sciences	Inmedix	Panakes Partners
Acceleris Capital	Curam Capital Management	Innogest	Panmure Gordon
Accelmed	Cypralis Ltd.	Inserm Transfert	Paul Capital
Active Needle Technology	Da Voltterra	Inserm Transfert Initiative / Sofimac	PCI Biotech
Addex Therapeutics	DDF Ventures	Instinctif Partners	Pentracor
AdRem Capital	DeBere Capital Partners	InterAx Biotech	Peppermint Venture Partners
Advent France Biotechnology	Deepbridge Capital	Interceptin	Perora GmbH
Advent Life Sciences	Dementia Discovery Fund	Inventages	Pfizer
Advokatfirman Vinge KB	Destiny Pharma	Invest Newcastle	PhagoMed Biopharma
Aglaris	Diamond Biopharm	IO Biotech	PharmaVentures
AKL	DN Capital	IP Group	Pharmstandard Ventures
Alacrita Consulting	Downing	IPF Partners	PI Trading
Albion Capital	DSM Venturing	ISA Pharmaceuticals BV	Poul Schmith
Albion Technology & General VCT	Duke Street	ISIF	Primer Capital
Alderley Park Ventures	Dyadic	Ivaldi Capital	Principia SGR
Allegra Therapeutics GmbH	Dynasty Biotechnology & The Sino-UK Fund	J O Hambro Capital Management	Privos Capital (Multi-Family Office LP)
Allen & Overy	e-Therapeutics	JAG Shaw Baker	Probiodrugg AG
Amadeus Capital Partners	Earlybird Venture Capital	Jefferies	Proteome Sciences Plc
Angel Investor	Edison	Johnson & Johnson Innovation	PsiOxus Therapeutics
Antabio	Edmond de Rothschild Investment Partners	JPI Fund	Q-linea AB
Apeiron Biologics	Eli Lilly & Co.	JSC Pharmstandard	Rainbow Seed Fund
Ardian	Eli Lilly and Company	Julz Co	RBC Capital Markets
Arecor	EMD Serono	Karolinska Development	RBV Capital
Arix Bioscience	Enesi Pharma	Keiretsu Forum	Re-Pharm
Arterial Capital Management	Enterprise Ireland	Kiadis Pharma	Reaplix
Arthurian Life Sciences	Entrust People	King's College London	RedEye
Artios Pharma	EP Vantage	Kinled Holding	Renephra Ltd.
Asarina Pharma	Epi-Endo Pharmaceuticals	Kreos Capital	ReNeuron
Astex Pharmaceuticals	Epidarex Capital	Kurma Partners	Renovos Biologics
Astraveus	EpimAb Biotherapeutics	Laurel Venture Capital	Rigontec
AstraZeneca	Ergomed	Leerink Partners	RMI Partners
Atelix	Esperante	LifeArc	Rosetta Capital
Atlantic Bridge	Eternans Limited	LIG Biowise	Rothschild
Atlantic Therapeutics	Ethris GmbH	Limerston Capital	RYSE Asset Management
Atriva Therapeutics	Eurocine Vaccines	LipoCoat BV	Sanara Ventures
ATXA Therapeutics Ltd	Euronext	Longevity Venture Partners	Scancell Holdings
Aurora-TT	European Investment Bank	Longwall Venture Partners	Scientific Protein Labs
Auspherix	European Investment Fund	Lonza	SCRIP
Avego Healthcare Capital	Exonate Ltd	LSX	Selvita
AVM Biotechnology	EY	Magle Chemoswed	Senzime
Balmes Transplantation	F-Prime Capital	MangoGen Pharma	Seroba Life Sciences
Baxter	F-star Biotechnology	Marks & Clerk	Shore Capital
Belsize Asset Management	Femeda	Masselos Family Office	Siemens Healthineers
BioArctic AB	Fiagon	MC Services	Silence Therapeutics
BioGeneration Ventures	Fieldhouse Associates	McLaren Applied Technologies	Simply Capital Partners
BioProtect Ltd.	Financial Times	Medherant	Sixth Element Capital
Biosana Pharma	Flagship Pioneering	Medicxi	SJB Technical Recruitment Ltd
BioScience Managers	Flowsium A/S	Medivir	Sofinnova Partners
BioSeed Capital	FOLIUM Food Science Limited	Medlumics	SOM Biotech
Biosignatures	Forbes	Medtech Insight	SPARK Impact
Biotech and Money	Forbion Capital Partners	Medtronic	Sphere Medical
BioTissue SA	Fountain Healthcare Partners	MEDX Xelerator	SR-One
Biovotion	FreeMind Group	Meneldor	Stifel
Blueprint Genetics	Fresenius Medical Care Ventures	Mercia Technologies	Storm Therapeutics
Boehringer Ingelheim	FTI Consulting	Merck Ventures	Summit Therapeutics
Bone Support	Fund Twenty8	Metalinear	Sunstone Life Science Ventures
Bone Therapeutics	Future Care Capital	Mironid	Surgacoll Technologies
Bonsai Capital	Galapagos	MISSION Therapeutics	SV Health Investors
Boston Scientific	Galecto Biotech	Mologen	SwabTech Limited
Boston Scientific Ventures	Genentech Partnering	Momentum Biotech	Syncona Ltd.
Boult Wade Tennant	GIC	MonTa Biosciences	SyndicateRoom Growth Fund
Bpifrance	Gilde Healthcare	Montagu	Takeda
BrainWaveBank	Gill Jennings & Every	MorphoSys	Talentmark
BRASTER S.A.	GIMV	MSD	Tassi & Co.
Bridge Biotech	Global Core Medical	MSIF	TAXIS Pharmaceuticals
British Expats in Life Sciences	GlobalData	MTIP	The Side by Side Partnership
Brothers & Partners Europe	Goldman Sachs	MVM Partners	Tillotts Pharma AG
Brown Rudnick	Goodwin Procter	MXC Capital	Topas Therapeutics
Calcvix	Graphite Capital	N+1 Singer	TPBioVentures Ltd
Cambridge Angels	GSK	NASDAQ	Trilantic Europe
Cambridge Enterprise	H.C. Wainright	NCL Technology Ventures	Trinity Delta
Cambridge Innovation Capital	Hadasi Medical Research Services and	NeoMed	Tusk Therapeutics
Cambridge Medical Robotics	Development	NetScientific	TVM Capital Life Science
Cambridge Medical Technologies	Hadean Ventures	New Science Global Healthcare Fund	TYG-Oncology
Cancer Research UK	Hansa Medical	New Wave Ventures	UCB Pharma
Cantargia AB	Harbert European Growth Capital	Newable Private Investing	UCB Ventures
Capital Cell	Haseltine Lake	Norgine Ventures	UMP
Capricorn Venture Partners	HBM Partners	North-East Healthcare Investment	Universitat Autònoma de Barcelona
Cardioentis	Health Equity Consulting	Nova Leah	University of Dundee
Carmell Therapeutics	Health Ventures	Novacyt	University of Edinburgh
Carnegie Investment Bank	HealthCap	Novintum Bioscience	University of Southampton
Catapult Digital	HealthCare Royalty Partners	Novo Holdings	ValiRx Plc
Catapult Ventures	Heat Biologics	Novo Ventures	Ventac Partners
Celgene	Heptares Therapeutics	NOXXON Pharma	VentureFounders
Celixir plc	Herantis Pharma	NY Consulting	Verona Pharma
Cell & Gene Therapy Catapult	Hermes Partners Intl.	O2h Ventures Limited	Vita Advisory
Chronos Therapeutics	High-Tech Gründerfonds	Oisin Biotechnologies	Vivet Therapeutics
Citi Depository Receipt Services	Hogan Lovells	Olympus Europa	VolitionRx
Citigate Dewe Rogerson	Hogan Lovells	Omnes Capital	Waimangu Ventures
ClearlySo	Hookipa Biotech	Oncimmune plc	West Hill
Clinigen Group	Horizon Discovery Group	OncoGenesis	Wharton Alumni Angel Network
Clubb Capital	Idogen	Oncology Venture	Wharton Asset Management
CMS Cameron McKenna Nabarro Olswang	IGEM Therapeutics	Oncopeptides	White & Case LLP
LLP	Ignite Capital Partners	Optimum Communications	WideCells Group
CN Bio Innovations	Illumina Ventures	OR Productivity	Wren Capital
co.don	Image Analysis Group (IAG)	OrbiMed	Zilico Limited
Cocoon Networks	Immersive Rehab	Orca Therapeutics	ZOLL Medical, Asahi Kasei Group Company
Cole Capital	Immunicum	Ostara Biomedical	Zonda Partners
Consilium Strategic Communications	Immunocore	Ostoform	Zukunftsfonds Heilbronn
Cook Regentec	Imperial Innovations	OvuSense	
Cooley	Imperium Capital	Oxford AHSN	

## 2018 KEY STATS

**34%**  
CORPORATES

**44%**  
INVESTORS & PHARMA

**11%**  
TIER 1 SERVICES



**20+**  
NATIONALITIES

**635+**  
REGISTERED  
ATTENDEES

**88%**  
C-LEVEL & SENIOR  
MANAGEMENT

**265+**  
INVESTORS  
& PHARMA

**185+**  
UNIQUE INVESTMENT FIRMS

**425+**  
UNIQUE COMPANIES

**1200+**  
PRE-ARRANGED MEETINGS





## CONNECT WITH PURPOSE

### BIOTECH SPEAKER AND AGENDA ENQUIRIES

Josh Dance, Senior Vice President  
josh@biotechandmoney.com  
+44 (0) 203 637 5908

### MEDTECH SPEAKER AND AGENDA ENQUIRIES

Neil Darkes, Co-CEO  
neil@biotechandmoney.com  
+44 (0) 203 637 5908

### BIOTECH PARTNERSHIP ENQUIRIES

Matt Pullan, SVP BD & Partnerships  
matt@biotechandmoney.com  
+44 (0) 203 637 5908



### MEDTECH PARTNERSHIP ENQUIRIES

Tom Roberts, VP BD & Partnerships  
tom@biotechandmoney.com  
+44 (0) 203 637 5908

### INVESTOR ENQUIRIES

Emily Vipond, Head of Investor Relations  
emily@biotechandmoney.com  
+44 (0) 203 637 5908

### CONTENT ENQUIRIES

Louise Fordham, Editor  
louise@biotechandmoney.com  
+44 (0) 203 637 5908

### MARKETING ENQUIRIES

Paul Gilbertson, Head of Marketing  
paul@biotechandmoney.com  
+44 (0) 203 637 5908

**#LSXWORLD**

[WWW.LSXLEADERS.COM/LSX-WORLD-CONGRESS](http://WWW.LSXLEADERS.COM/LSX-WORLD-CONGRESS)

ORGANISED BY:



The network  
for life science  
executive leaders

FORMERLY KNOWN AS  
**biotechandmoney**  
bringing deals to life