

# LEGEND **FLEET SOLUTIONS**

## SPRINTER 170" EXT. WB HIGH ROOF WALL LINERS INSTALLATION INSTRUCTIONS



### NOTES:

1. Before commencing, remove all wall liners and "D" Rings already installed in the vehicle.
2. Consult layout PDF and compare vehicle layout allocated Legend.
3. Prepare hardware shown below and have them ready for installation.
4. Wall liners will be installed in the order shown in the instructions.
5. A drill with a Phillips driver is required to install hardware ( **C** ) #8 Screws, shown below.
6. Reinstall all "D" Rings once the wall liner kit installation is completed.

### Hardware

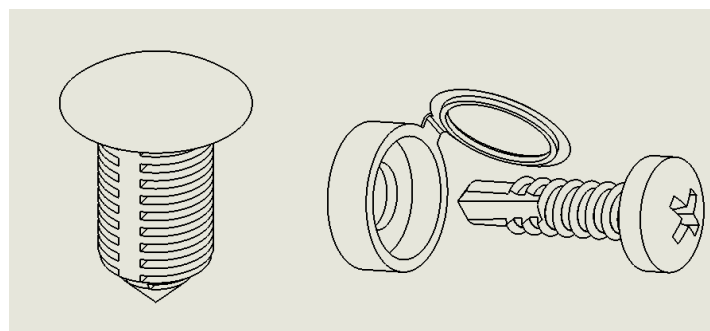

**A) Retainer**   **B) #8 Screw Cap**   **C) #8 Screw**

# SPRINTER 170" EXT. WB HIGH ROOF WALL LINERS

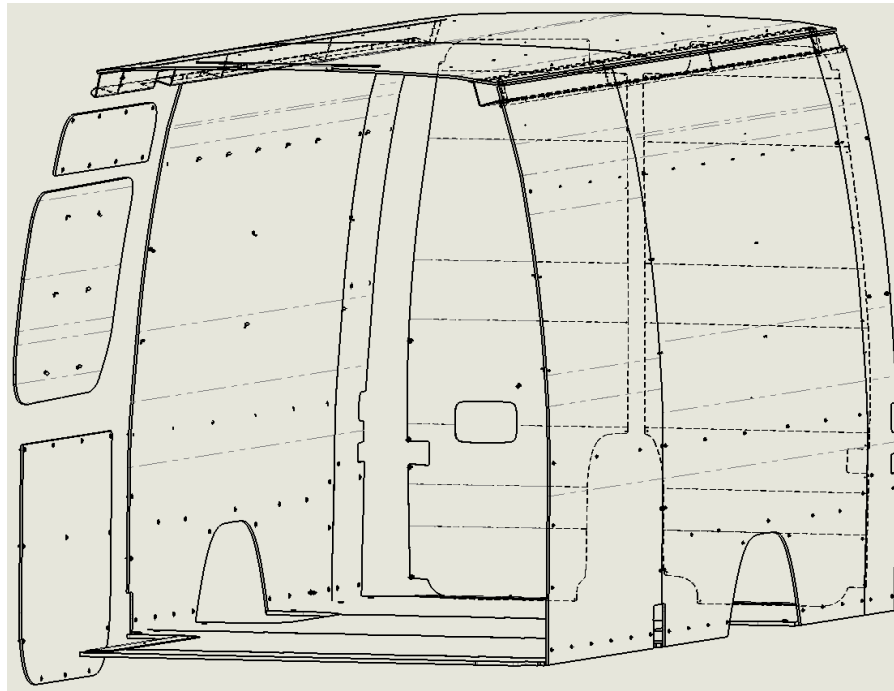

ITEM NO.	PART NUMBER	DESCRIPTION	QTY.
1	103-114-2613.HR	GREY REAR DOOR PANEL DRIVER SIDE SPRINTER HR	1
2	SCREW CAP	SCREW CAP	78
3	SCREW	SCREW - PHIL. PAN HD #8X.75 SELF DRILLING	150
4	103-114-2613.HR	GREY REAR DOOR PANEL PASSENGER SIDE SPRINTER HR	1
5	103-114-2613.HR	GREY UPPER PANEL SLIDING DOOR SPRINTER HR	1
6	103-114-2613.HR	GREY MIDDLE DOOR PANEL SLIDING GOOR SPRINTER HR	1
7	103-114-2613.HR	GREY BOTTOM PANEL SLIDING DOOR SPRINTER HR	1
8	RETAINER	RETAINER- BLACK NYLON	103
9	145-114-2613	GREY CEILING FRONT PANEL SPRINTER 170" EXT WB HR	1
10	145-114-2613	GREY CEILING REAR PANEL SPRINTER 170" EXT WB HR	1
11	144-114-2613	GREY FRONT DRIVER SIDE PANEL SPRINTER 170 EXT WB HR	1
12	144-114-2613	GREY FRONT A DRIVER SIDE PANEL SPRINTER 170 EXT WB HR	1
13	144-114-2613	GREY REAR DRIVER SIDE PANEL SPRINTER 170 EXT WB HR	1
14	147-151-1010	SILL-F SPRINTER 170" EXT WB HR	1
15	147-151-1010	SILL-D-1 SPRINTER 170" EXT WB HR	1
16	147-151-1010	SILL-F-1 SPRINTER 170" EXT WB HR	1
17	147-151-1010	SILL-D SPRINTER 170" EXT WB HR	1
18	147-151-1010	SILL-E SPRINTER 170" EXT WB HR	1
19	627-151-1010	JOINER PLATE- CEILING SILL	9
20	144-114-2613	GREY REAR PASSENGER SIDE PANEL SPRINTER 170 EXT WB HR	1
21	144-114-2613	GREY FRONT PASSENGER SIDE PANEL SPRINTER 170 EXT WB HR	1
22	147-151-1010	SILL-A SPRINTER 170" EXT WB HR	1
23	147-151-1010	SILL-A-1 SPRINTER 170" EXT WB HR	1
24	147-151-1010	SILL-B SPRINTER 170" EXT WB HR	1
25	147-151-1010	SILL-C SPRINTER 170" EXT WB HR	1
26	147-151-1010	SILL-C-1 SPRINTER 170" EXT WB HR	1
27	108-151-1010	SILL - FLOOR- REAR - SPRINTER	1
28	145-114-2613	CEILING BRACKET SPRINTER 170" EXT WB HR	1
29	142-xxx-6641	FLOOR #1 - SPRINTER 170" EXT WB	1
30	142-xxx-6641	FLOOR #3 - SPRINTER 170" EXT WB	1
31	142-xxx-6641	FLOOR #4- SPRINTER 170" EXT WB	1
32	142-xxx-6641	FLOOR #2 - SPRINTER 170" EXT WB	1
33	106-151-1010	SILL - FLOOR - SIDE DOOR - SPRINTER	1

## Note:

Model may differ depending if the vehicle purchased came with an OEM partition or not.

## Driver Side Wall Liner Installation

ITEM 11  
FRONT DRIVERS  
SIDE PANEL

ITEM 13  
REAR DRIVERS  
SIDE PANEL

ITEM 12  
FRONT A  
DRIVERS SIDE  
PANEL

FRONT

REAR

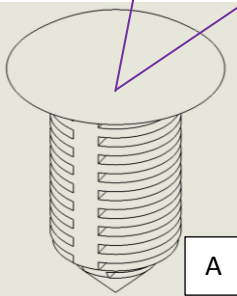

A

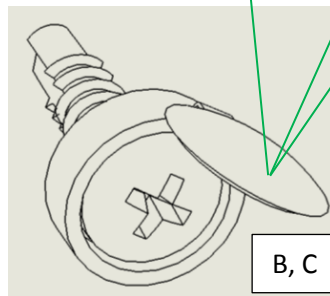

B, C

### Installation completed

Note: If a rear view camera option is installed, bend and

break downwards at the break lines the top section of all the panels so it fits under the plastic tubing. It can also be cut off if desired.

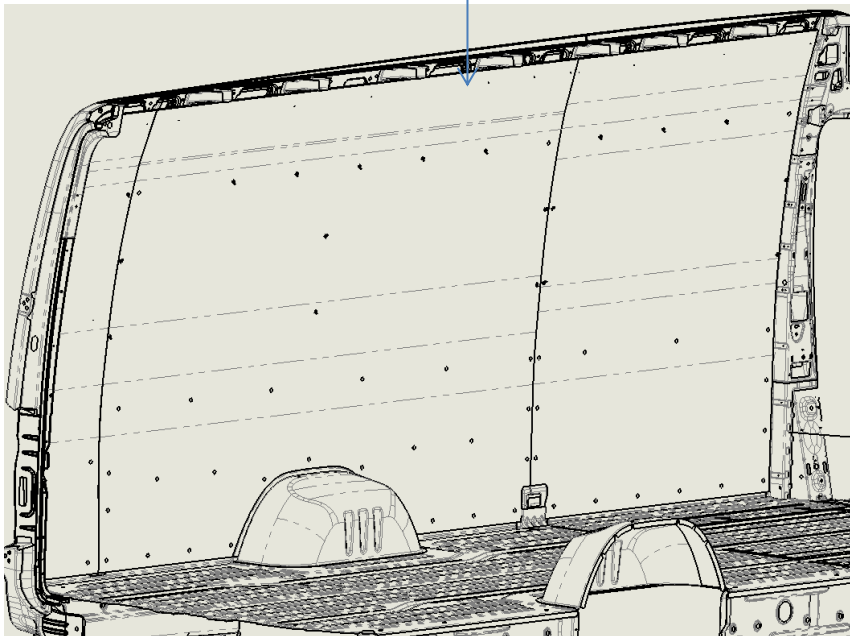

**1:** Install Item 12, Front-A Driver Side Panel.

- Align notch and edge of panel with the feature on the vehicle driver side front then align opposite side of panel edge with the contour features.
  - Install hardware (A) and (B,C), in the holes provided, on the bottom of the panel first, working your way up the panel to the top.
- 2:** Install Item 11, Front Driver Side Panel.

- Align notch and edge of panel with the feature on the vehicle driver side front then align opposite side of panel edge with the contour features.
- Install hardware (A) and (B,C), in the holes provided, on the bottom of the panel first, working your way up the panel to the top.
- Install Item 13, Rear Driver Side Panels.
- Align wheel well edge of the panel with the feature on the vehicle; position the contour of the panel to the vehicle wall.
- Install hardware (A), in the holes provided, on the bottom of the panel first, working your way up the panel to the top.

**NOTE: DO NOT INSTALL HARDWARE IN THE HOLES AT THE TOP OF THE PANELS, THESE ARE USED FOR THE SILL INTALLATION**

## Back Door Wall Liner Installation

### ITEM 4

REAR DOOR  
PASSENGER SIDE  
PANEL

### ITEM 1

REAR DOOR  
DRIVERS SIDE  
PANEL

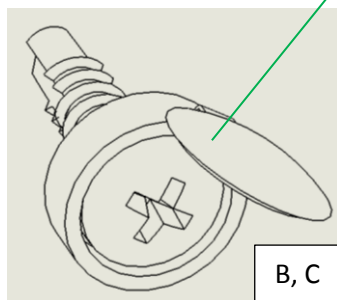
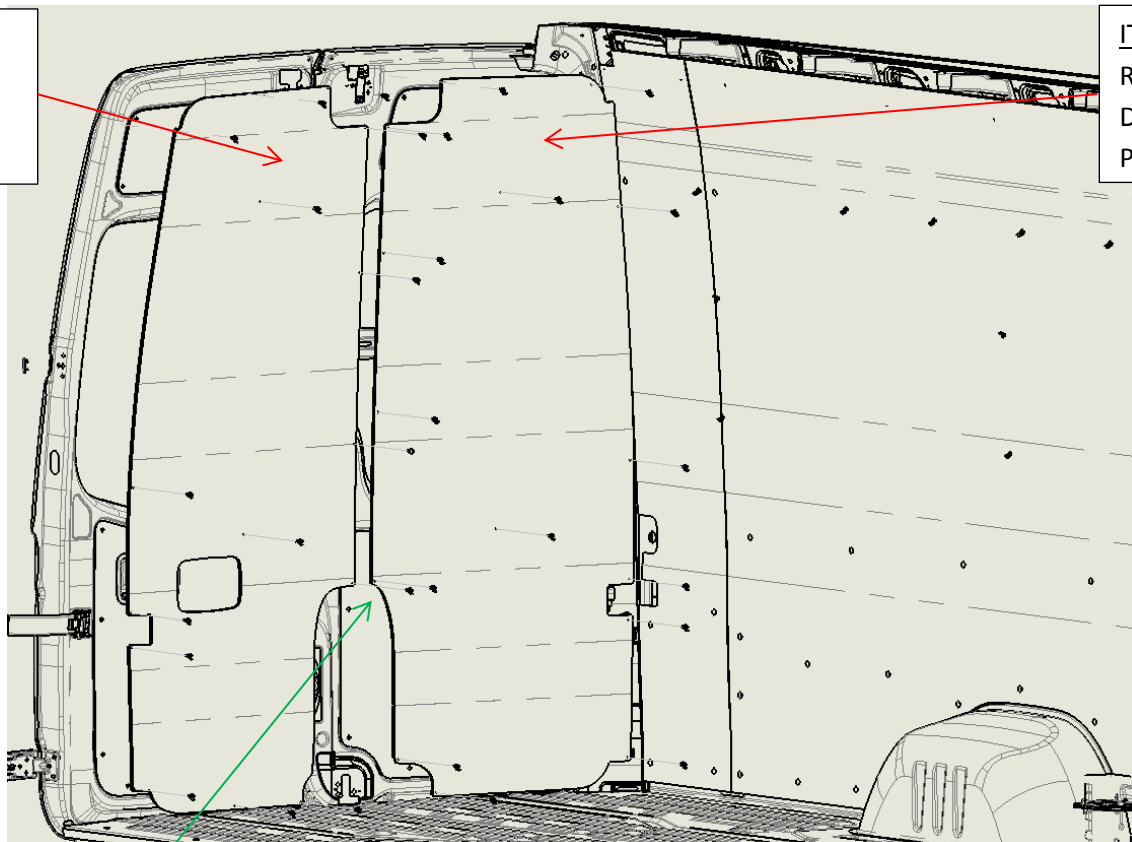

**3:** Install Item 1 and 4, Rear door panels,

**Note:** Rear doors must be closed when installing door panels.

- Align the panels with the door contour; **do not mount tight against the door seals.**
- Install hardware (B, C) on the bottom of the panel first, working your way up the panel to the top.

Installation completed

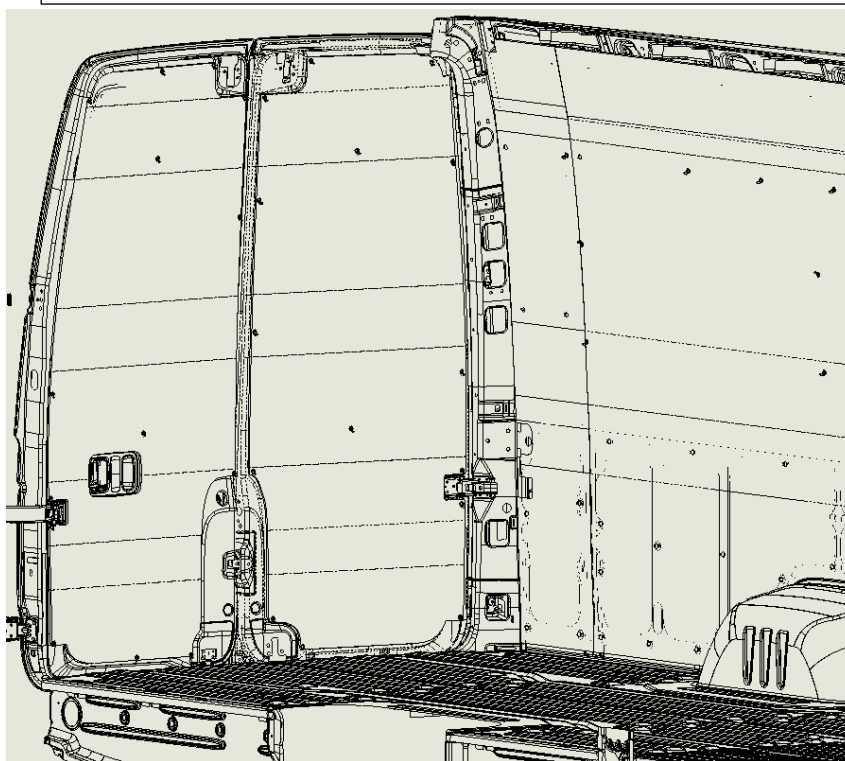

## Passenger Side Wall Liner Installation

ITEM 5  
UPPER  
SLIDING DOOR  
PANEL

ITEM 6  
MIDDLE  
SLIDING DOOR  
PANEL

ITEM 7  
BOTTOM  
SLIDING DOOR  
PANEL

\*DOOR RIBS

FRONT

ITEM 21 FRONT PASSENGER SIDE PANEL

ITEM 20 REAR PASSENGER  
SIDE PANEL

REAR

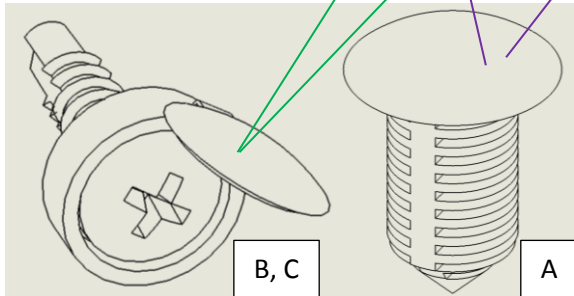
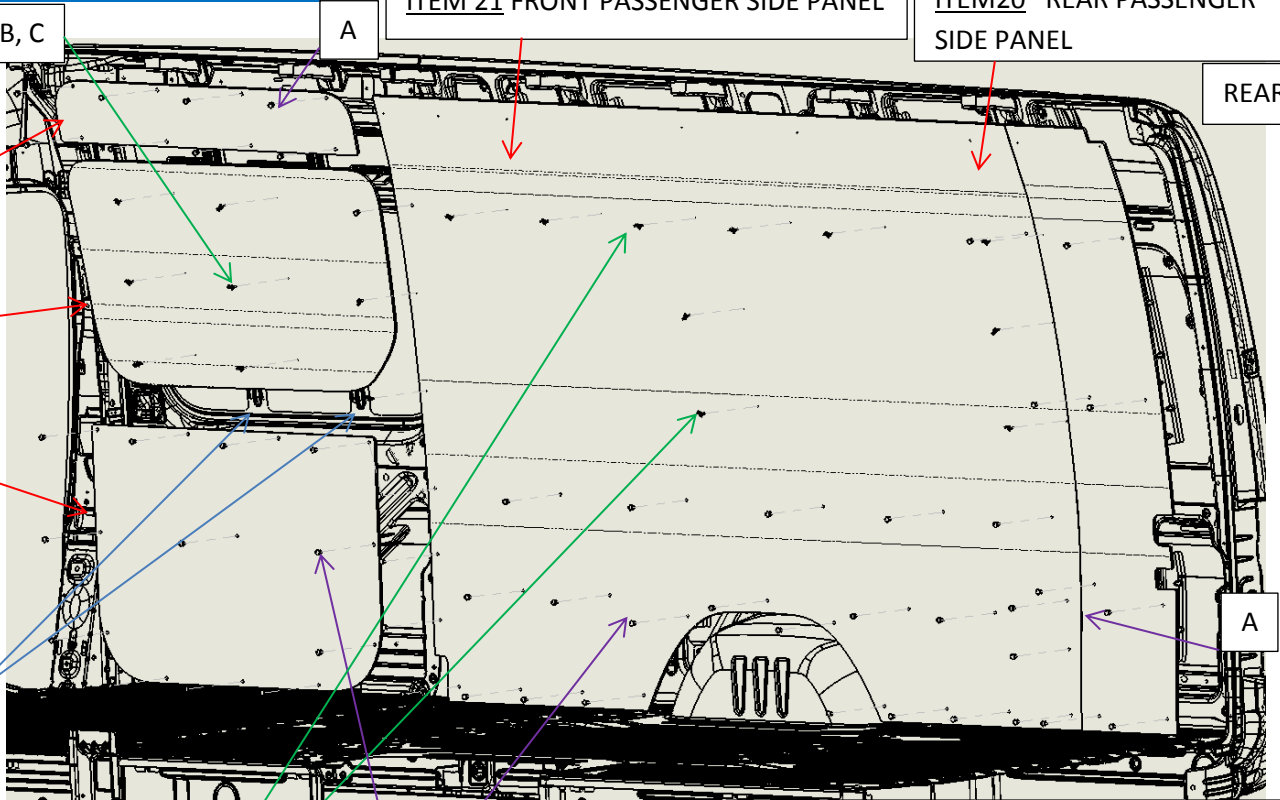

**NOTE: DO NOT INSTALL HARDWARE IN THE HOLES AT THE TOP OF THE PANELS; THESE ARE USED FOR THE SILL INTALLATION.**

**\*FOR ITEM 6, MIDDLE SLIDING DOOR PANEL, ALIGN HOLES IN THE PANEL TO THE RIBS OF THE DOOR TO ENSURE PROPER SCREW INSTALLATION.**

**4:** Install Item 21 and 22, Front and Rear Passenger Side Panel.

- Align wheel well edge of the panel with the feature on the vehicle; position the contour of the panel to the vehicle wall.
- Install hardware (A), in the holes provided, on the bottom of the panel first, working your way up the panel to the top. Install hardware (B, C) in the holes provided in the middle to the top part of the panel

**5:** Install Item 5, 6, 7, Sliding Door Panel.

First remove OEM bottom panel.  
Note: Sliding door must be closed to install panel;

- Insert panel into the sliding door sill cavity, align holes at the bottom half of the panel to the one on the door and insert hardware (A) in all of the holes provided.
- Install hardware (B, C) in the holes provided in the middle to the top part of the panel; make sure the panel does not interfere with the door seal.
- NOTE: DO NOT INSTALL HARDWARE IN THE HOLES AT THE TOP OF THE**

Installation completed

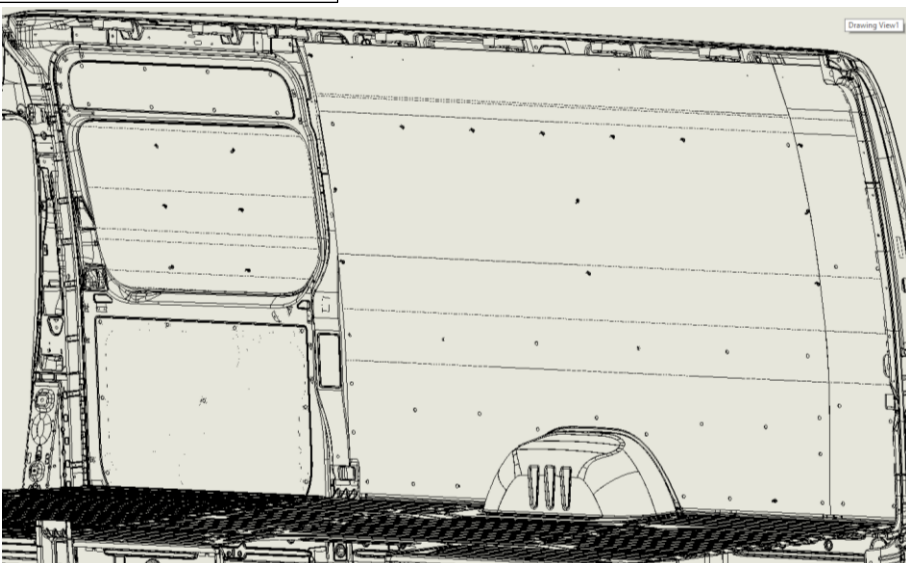



## Ceiling Liner Installation

VEHICLE IS UPSIDE DOWN

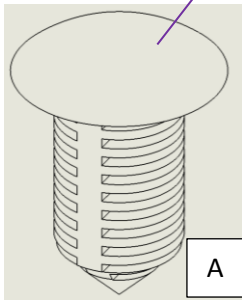
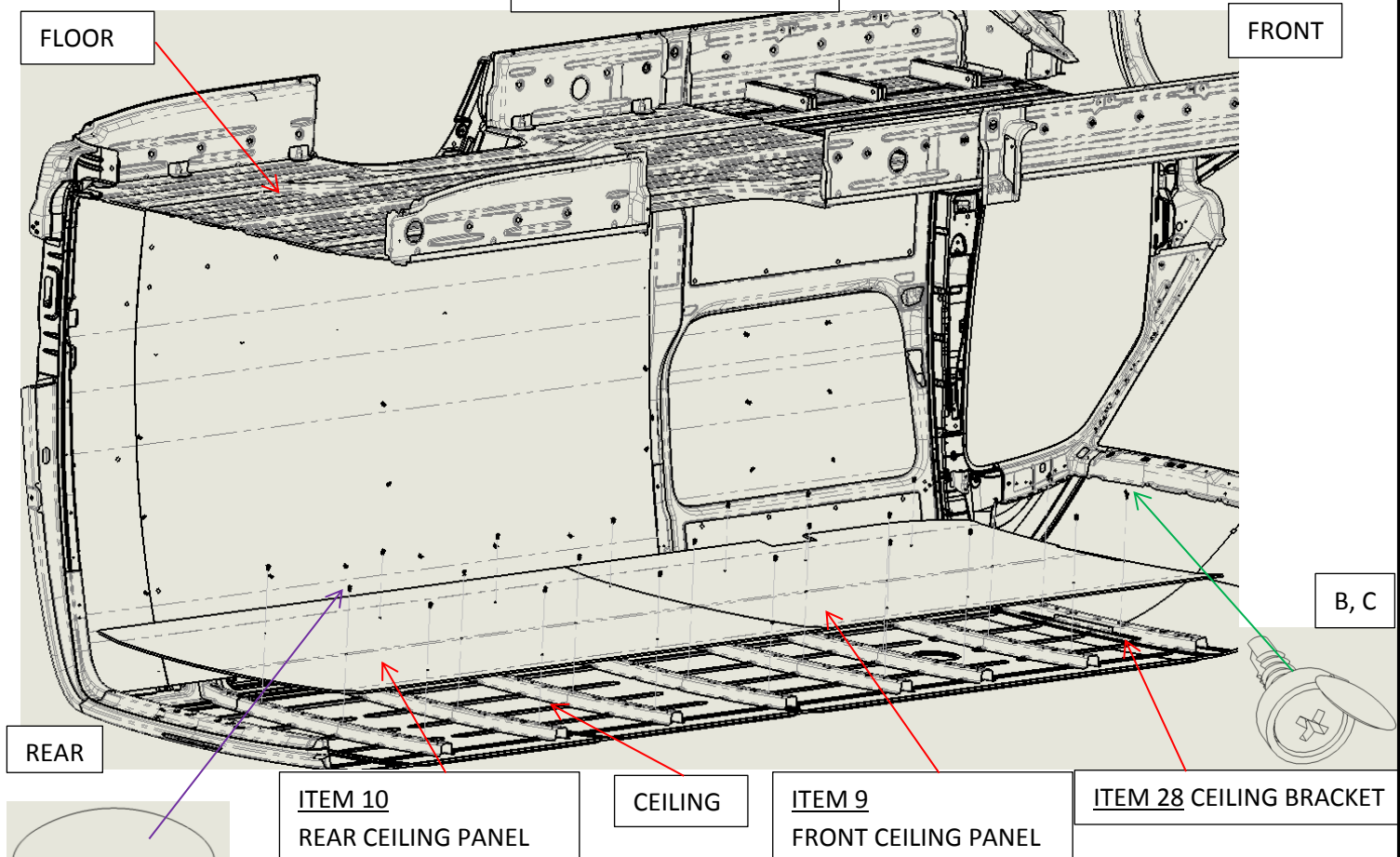

### 6: Install Item 9 and 10, Ceiling Panels and Item 28; Ceiling Bracket

- Align Ceiling panel with the feature on the vehicle in the front, insert the front of the panel between the headliner and the roof.
- Align the outside holes at the center of the panel with the holes in the ceiling cross bows and install hardware (A) on each side; this will align the panel with the ceiling.
- Push the panel against the ceiling and install hardware (A), in the holes provided starting from the front working your way towards the rear.
- Install Item 28 Ceiling bracket to the OEM partition and Ceiling panel with hardware (B,C).

Installation completed

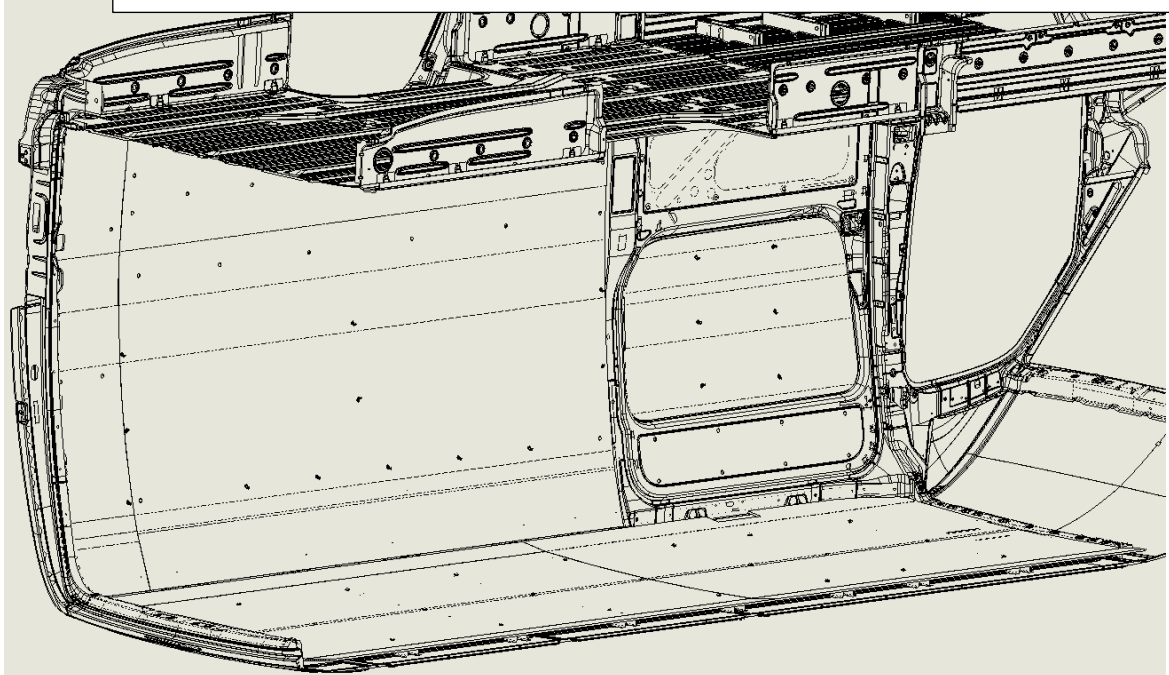

## Ceiling Sills Installation

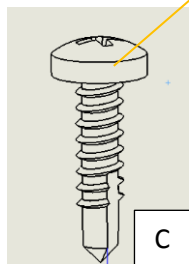
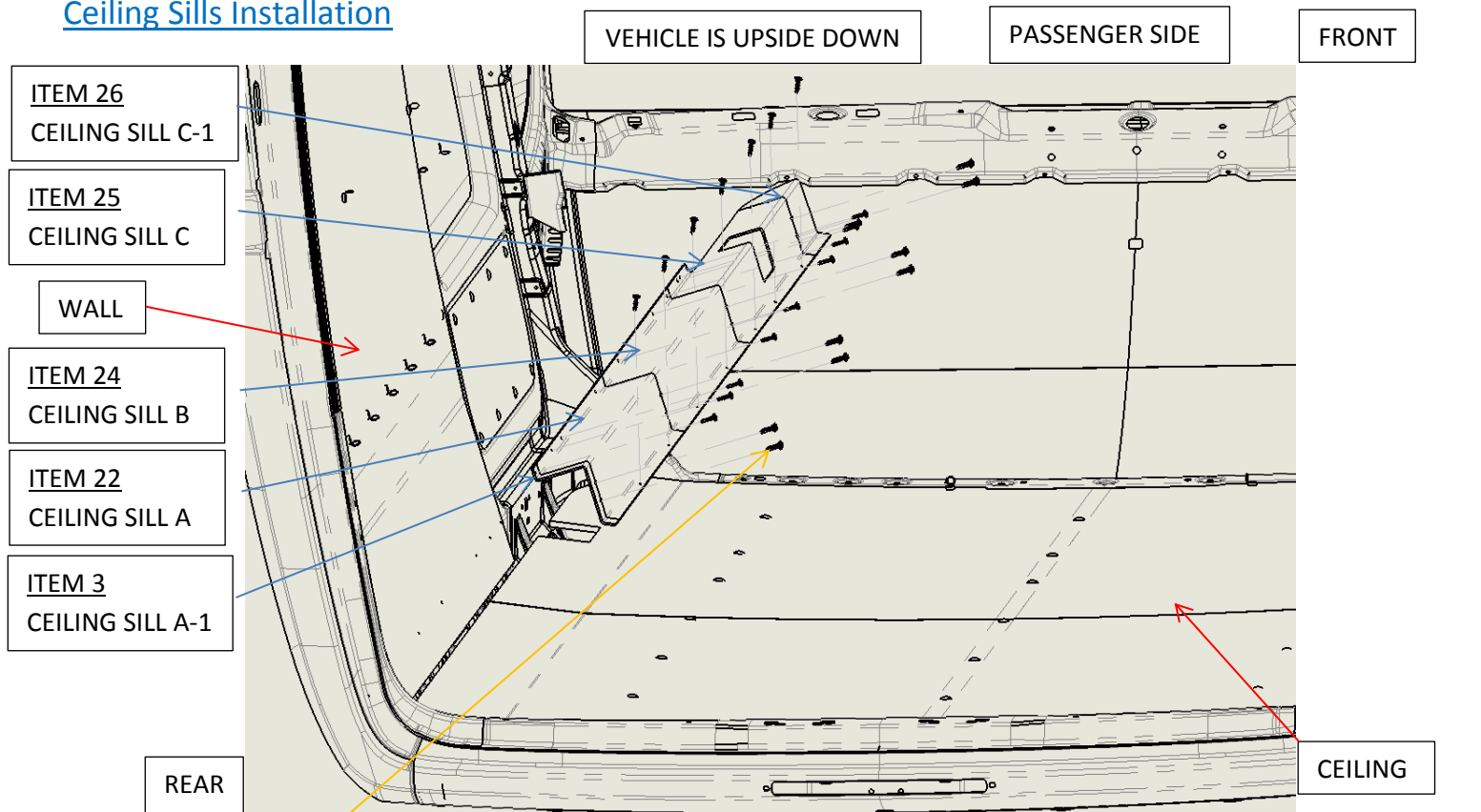

**Z:** Assemble Item 14, 15, 16, 17, 18 together with the Item 19, Sill Joining Plate (SHOWN BELOW), with hardware (C) in the holes provided.

FOR DRIVER SIDE.

NOTE: ITEM 15 IS NOT USED IF REAR CAMERA OPTION IS INSTALLED, ITEM 16 IS NOT USED IF THERE IS AN OEM PARTITION OPTION INSTALLED

- Assemble Item 22, 23, 24, 25, 26 together with the Item 19, Sill Joining Plate (SHOWN BELOW), with hardware (C) in the holes provided.

FOR PASSENGER SIDE

NOTE: ITEM 23 IS NOT USED IF REAR CAMERA OPTION IS INSTALLED; ITEM 26 IS NOT USED IF THERE IS AN OEM PARTITION OPTION INSTALLED

- Install the Sill assemblies on the Driver side as well as on the Passenger side using hardware (C) in the holes provided on the Sills.

**Installation completed**

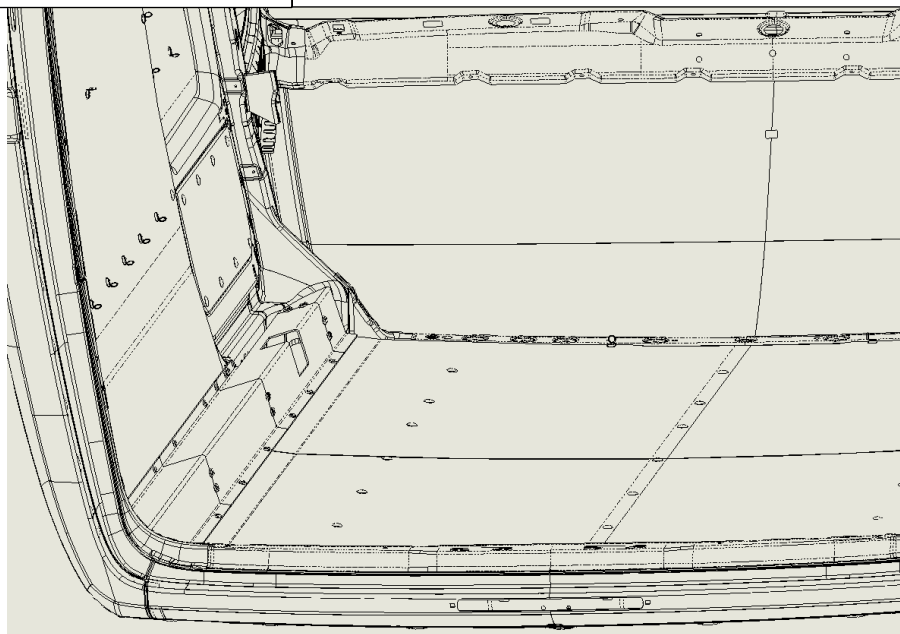

**ITEM 19**

SILL JOINING PLATE

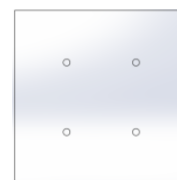

## Ceiling Sills Installation Details

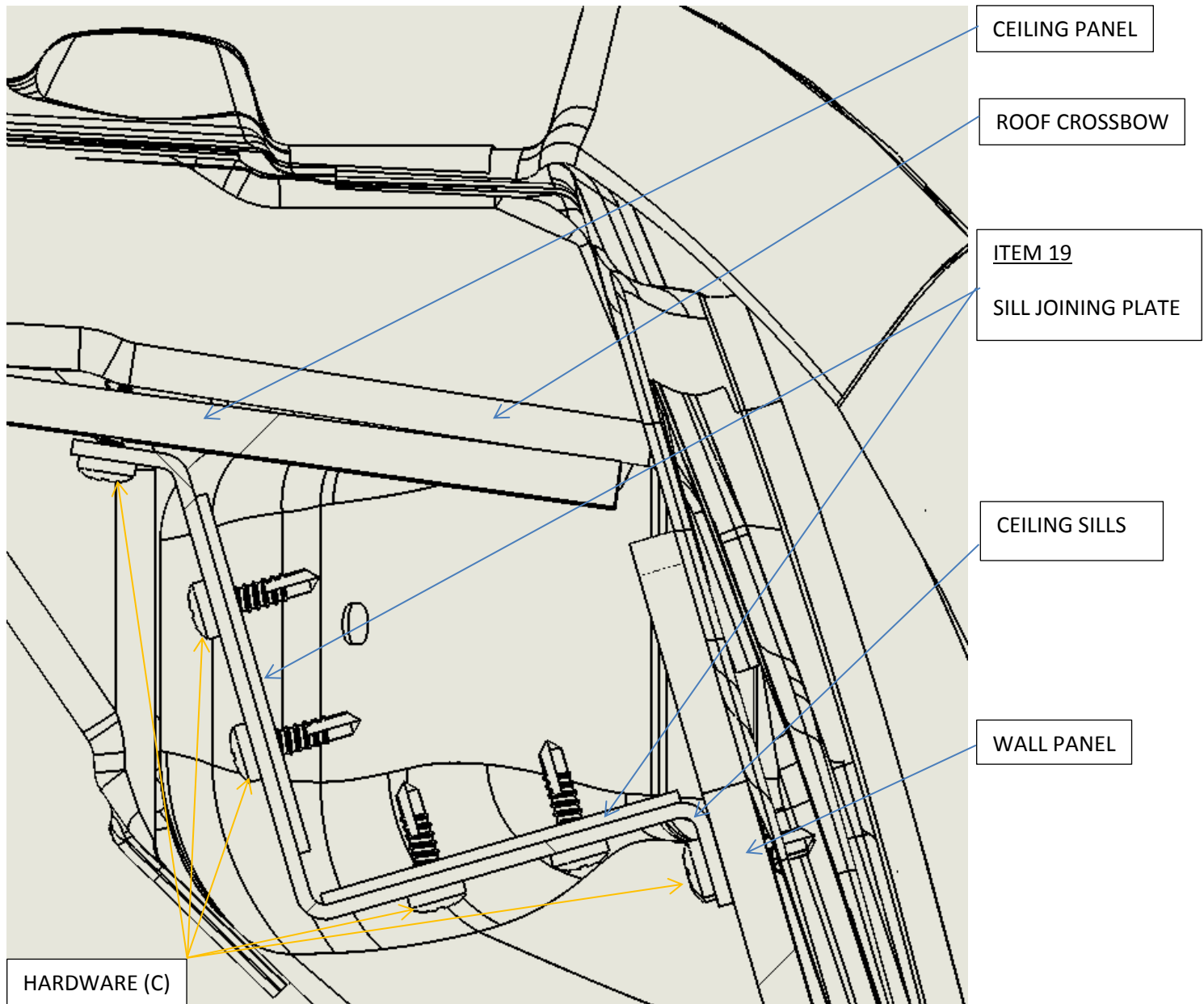



Installation completed

PASSENGER SIDE

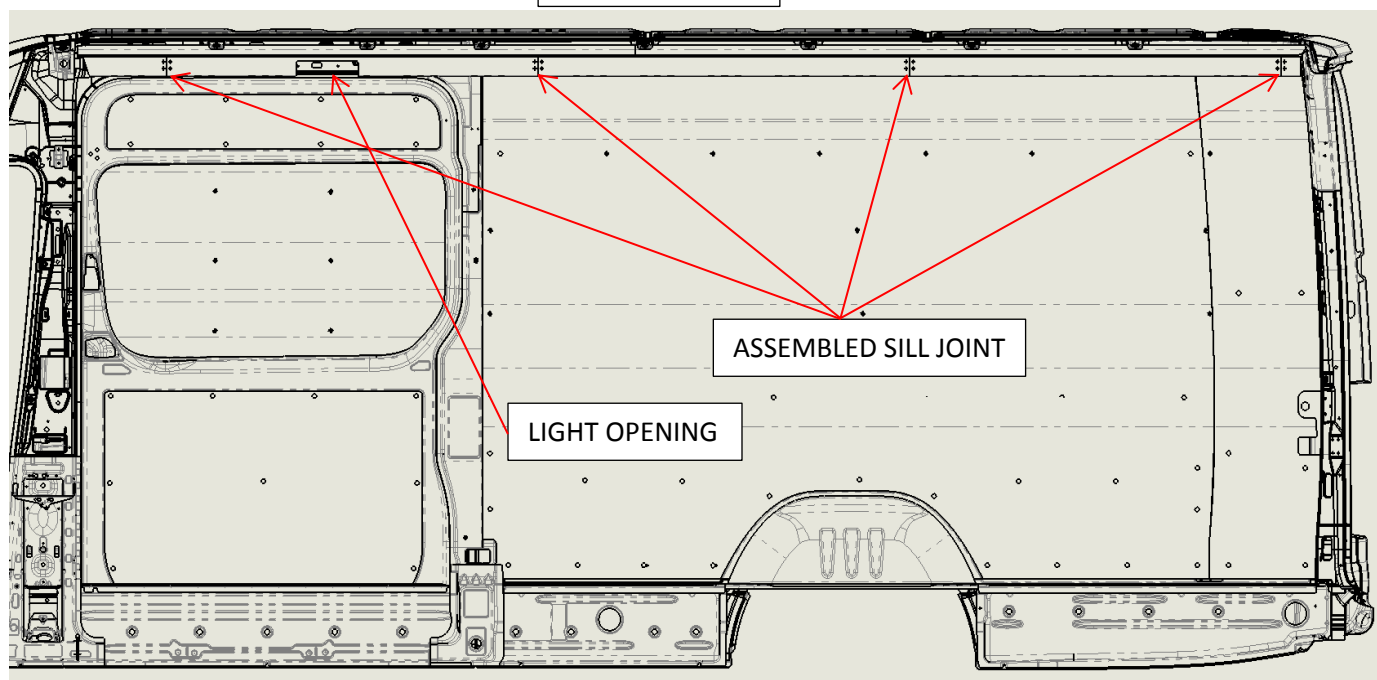

DRIVER SIDE

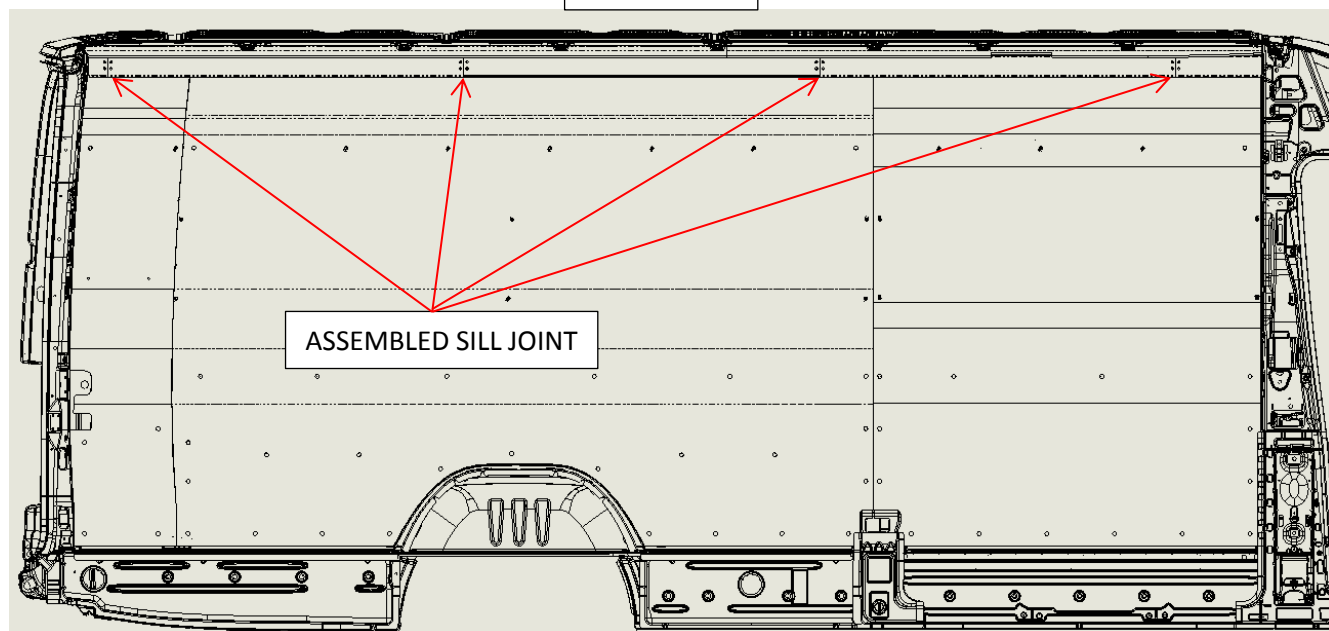

## Floor and Floor Sill Installation

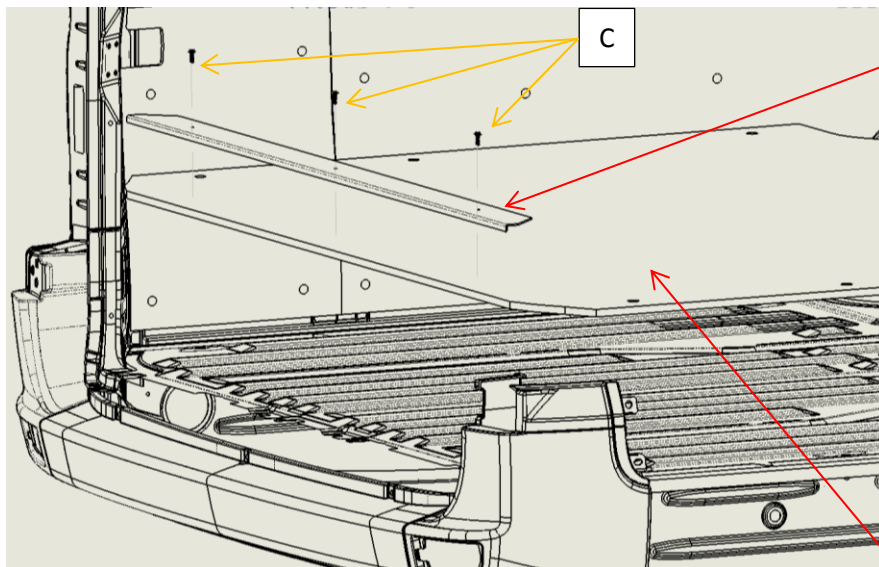

### ITEM 27

FLOOR SILL – REAR DOOR

**8:** Install Items 29, 30, 31, 32, FLOOR and Items 27, 33 FLOOR SILLS.

- Install floor inside the vehicle.
- Align the floor sills in their proper location with the floor edges and install hardware (C).

ITEM 29, 30, 31, 32  
FLOOR

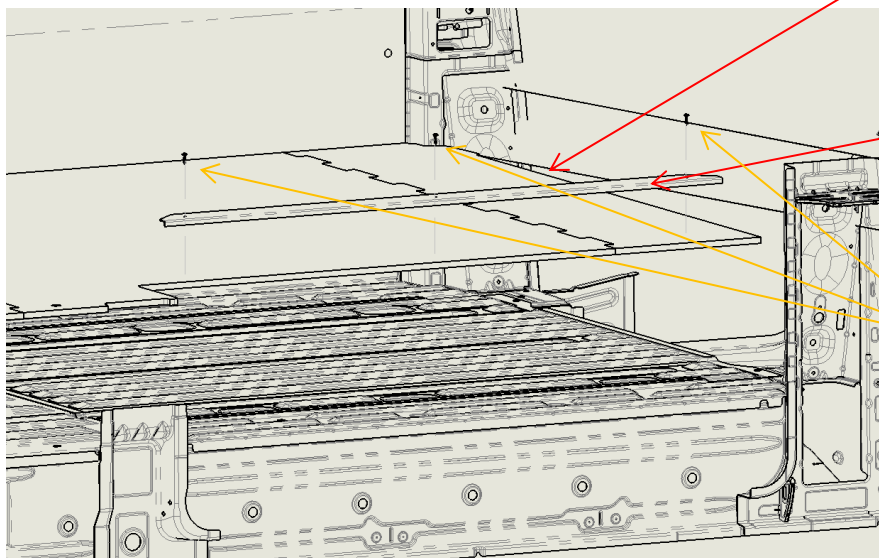

### ITEM 33

FLOOR SILL – SLIDING DOOR

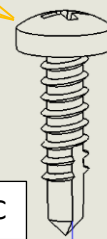

C

Installation completed

