

## Other Software



### Kofax VirtualReScan Basic

Leading image processing software, Kofax VRS Basic, improves readability of multiple-size documents with varying degrees of quality. Automatically straighten skewed pages without character degradation, optimize a document's brightness/contrast levels, and eliminate background noise and speckling.



### ENERGY STAR and the ENERGY STAR mark are registered U.S. trademarks.

Other company names and product names appearing in this brochure are the registered trademarks and/or trademarks of their respective owners.

## DR-M260 Specifications

Type	Desktop sheet-fed scanner	
Document size	Plain paper	Width : 50 mm to 216 mm Length : 54 mm to 356 mm * You can scan documents up to 5,588 mm long by setting the scanner to the Long Document mode.
	Business card	50 mm x 85 mm or larger
	Card	54 mm x 86 mm (ISO standard)
Document thickness and weight	Passport	88 mm x 125 mm (ISO standard) When scanning, be sure to open the passport and insert it in the separately sold carrier sheet (for passports).
	Plain paper	Page separation : 0.04 mm to 0.49 mm 27 to 413 g/m <sup>2</sup> Non separation : 0.04 mm to 0.49 mm 27 to 413 g/m <sup>2</sup> * A4 size or smaller : 80 sheets (80g/m <sup>2</sup> ) Larger than A4 size : 65 sheets (80g/m <sup>2</sup> ) Make sure stacks do not exceed 10 mm in height for either of the above.
	Business card	380 g/m <sup>2</sup> 0.45 mm or smaller
	Card	1.4 mm or smaller
Passport	6 mm or less (including carrier sheet)	
Document feeding method	Automatic	
Scanning sensor	Contact image sensor	
Light source	LED	
Scanning side	Simplex/Duplex	
Scanning modes	Black and White, Error Diffusion, 256-level Grayscale, Advanced Text Enhancement, Advanced Text Enhancement II, 24-bit Color	
Scanning resolution	100 x 100 dpi/150 x 150 dpi/200 x 200 dpi/240 x 240 dpi/300 x 300 dpi/400 x 400 dpi/600 x 600 dpi	
Scanning speed*	B&W/Grayscale	200 dpi/300 dpi : 60 ppm (Simplex), 120 ipm (Duplex)
	Color	200 dpi : 60 ppm (Simplex), 120 ipm (Duplex) 300 dpi : 50 ppm (Simplex), 100 ipm (Duplex)
Interface	USB3.1 Gen1	
Scanner driver/Software	ISIS/TWAIN Driver, CaptureOnTouch, CapturePerfect, Kofax VirtualReScan Basic	
Other functions	Folio scanning, Double feed detection	
Dimensions (W x D x H)	With the trays closed	285 mm (W) x 254 mm (D) x 231 mm (H)
	With the trays open	285 mm (W) x 652 mm (D) x 367 mm (H)
Weight (without AC adapter)	Approximately 3.4 kg	
Power supply (using AC adapter)	DC24V 1.0A	
Power consumption	Scanning : Maximum 23W or less In the sleep mode : Maximum 1.4W or less With power switch OFF : Maximum 0.1W or less	
Operating environment	Temperature	10°C to 35°C
	Humidity	20% to 80% RH
Options/Consumables	Flatbed Scanner Unit 102/201, Barcode Module, 2D code Module, Exchange Roller Kit (feed roller and retard roller), Carrier Sheet (Passport), Carrier Sheet (A4)	

\* Actual scanning speed may vary depending on your system configuration and PC.  
\* Specifications are subject to change without notice.

# Canon

Delighting You Always

## SOUTH & SOUTHEAST ASIA REGIONAL HEADQUARTERS

### Canon Singapore Pte. Ltd.

1 Fusionopolis Place, #15-10,  
Galaxis, Singapore 138522

Tel: 65-6799 8888 | Fax: 65-6799 8882

www.canon-asia.com | www.canon.com.sg

### AFGHANISTAN

**Megaplus Afghanistan Limited.**  
House No.83, Street No.3, Taimani,  
District No.10, Kabul, Afghanistan.  
Tel: (+93) 700-228832 / (+93) 700-979510  
Fax: (+93) 20-2212363  
Email: info@megaplus.com.af

### BANGLADESH

**Flora Limited**  
Admanjee Court Annex-2 (4<sup>th</sup> Floor)  
119-120 Motijheel C/A,  
Dhaka-1000, Bangladesh  
Tel: 88-02-9567846 | Fax: 88-02-9550030  
www.floralimited.com

### J.A.N. Associates

House-13/1, Vasa Soinik Abdur Rashid  
Torkabagish Sarak, Road # 5,  
Dhanmondi R/A, Dhaka, Bangladesh  
Tel: 880-2-9660601 | Fax: 880-2-8610410  
Email: jan@bangla.net  
www.jan-bd.com

### BRUNEI

**Interhouse Company**  
No.5-7 Bunut Jaya Complex  
Spq 574 Jalan Tutong BF1320  
P.O. Box 423, Seri Complex  
Bandar Seri Begawan, BA1779  
Brunei Darussalam  
Tel: 673-2653001 | Fax: 673-2653003

### CAMBODIA

**Royal Cambodia Co., Ltd**  
#437 Preah Monivong Blvd, Phnom Penh  
Kingdom of Cambodia  
Tel: 855-23-428955 | Fax: 855-23-722961

### HONG KONG

**Canon Hongkong Co., Ltd.**  
19/F., The Metropolis Tower,  
10 Metropolis Drive, Hung Hom,  
Kowloon, Hong Kong  
Tel: 852-3191 2388 | Fax: 852-2369 3800  
www.canon.com.hk

### INDIA

**Canon India Private Limited**  
7<sup>th</sup> Floor, Tower B, Building #5,  
DLF Epitome, DLF Phase III,  
Gurgaon 122002, Haryana, India  
Tel: 91-124-416 0000 | Fax: 91-124-416 0011  
www.canon.co.in

### INDONESIA

**PT Datascrip**  
Gedung Datascrip  
Jl. Selaparang Blok B-15 Kav.9,  
Kompleks Kemayoran,  
Jakarta Pusat 10610  
Tel: 62-21-6544515 | Fax: 62-21-6544811 to 13  
www.datascrip.com

### MALAYSIA

**Canon Marketing (Malaysia) Sdn. Bhd.**  
No.6-2-01, Canon Tower,  
UOA Business Park (Tower 6),  
Jalan Pengerang U1/51A,  
Seksyen U1, 40150 Shah Alam,  
Selangor, Malaysia  
Tel: 60-1800-88-2000 | Fax: 60-3-5567 9441  
www.canon.com.my

### MALDIVES

**Simdi Company Pvt Ltd.**  
G. Manaam Building, 2/1 Neelofaru Magu,  
Male' 20-129, Maldives  
Tel: 960-333 4421 | Fax: 960-333 4424

### MONGOLIA

**ITZone**  
4<sup>th</sup> floor, City Tower, Great Chinggis Khan square 5,  
Bagu toiruu 14200, 8<sup>th</sup> khoroo, Sukhbaatar district,  
Ulaanbaatar, Mongolia  
Tel: +(976)-11-323705 | Fax: +(976)-11-312699

### MYANMAR

**Myanmar Golden Rock International Co., Ltd**  
6<sup>th</sup> Floor, Building 18, Myanmar ICT Park,  
Hlaing Township, Yangon, Myanmar  
Tel: 95-1-6548110 to 19 (10 Lines),  
95-1-654844 to 48 (5 Lines)  
Fax: 95-1-654820

### NEPAL

**International Electronics Concern (P) Ltd**  
Kha 14, 1<sup>st</sup> Floor, Haratibhawan Putalisadak,  
Ramshah Path, Kathmandu, Nepal  
P.O. Box 12588  
Tel: 977-1-442 1991 | Fax: 977-1-442 1909

### PAKISTAN

**Shirazi Trading Company (Pvt.) Ltd**  
8<sup>th</sup> Floor, Adamjee House, I.I. Chundrigar Road,  
Karachi 74000 Pakistan  
Tel: 92-21-3241 (7659), (7737) or (7746)  
Fax: 92-21-(3241 7747), (3242 0417) or  
(3242 0418)  
www.shirazitrading.com.pk

### PHILIPPINES

**Canon Marketing (Philippines), Inc.**  
7F Commerce and Industry Plaza,  
1030 Campus Avenue corner Park Avenue,  
McKinley Hill, Fort Bonifacio, Taguig City,  
Metro Manila, Philippines 1634  
Tel: 632-884 9090 | Fax: 632-556 1456  
www.canon.com.ph

### SRI LANKA

**Metropolitan Office (Pvt) Ltd**  
12, Magazine Road  
Colombo 08, Sri Lanka  
Tel: 94-11-470 0200 | Fax: 94-11-470 0267  
www.metropolitan.lk

### TAIWAN

**Canon Marketing (Taiwan) Co. Ltd**  
19F, No.100, Sec.2 Roosevelt Road,  
Taipei, Taiwan, R.O.C  
Tel: 886-2-6632 8888 | Fax: 886-2-7725 5860  
www.canon.com.tw

### THAILAND

**Canon Marketing (Thailand) Co. Ltd.**  
No.98 Sathorn Square Office Tower,  
22<sup>nd</sup> - 24<sup>th</sup> floor, North Sathorn Road,  
Sliorn, Bangkok, Bangkok 10500  
Tel: 66-2-344 9999 | Fax: 66-2-344 9960  
www.canon.co.th

### VIETNAM

**Canon Marketing (Vietnam) Co. Ltd**  
Level 10, President Place,  
93 Nguyen Du, Dist 1,  
Ho Chi Minh City, Vietnam  
Tel: 84-8-3820 0466 | Fax: 84-8-3820 0477  
www.canon.com.vn

Dealer's Stamp

0208W374 © 2017 Canon Singapore Pte. Ltd.  
All rights reserved. Printed in Singapore.

# Canon

Delighting You Always

# imageFORMULA DR-M260



## New-generation DR scanner

Remarkable scanning performance with supreme paper-handling reliability to keep your workflows fluid and enhance productivity.

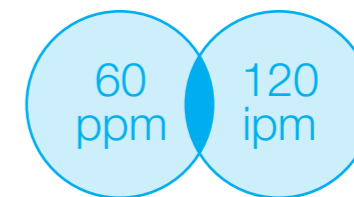

Business **can** be simple



# A more efficient, powerful and user-friendly scanner is here.

DR-M260 supports a variety of documents in differing lengths, sizes and thickness, ranging from business cards to thin documents such as order forms and delivery statements. With the bulk-scanning capability of the Automatic Document Feeder, users may load documents of different sizes simultaneously and scan with ease. Productivity will also be significantly boosted by the combination of high-speed scanning and versatile feeding power.



## Equipped with the DR Processor, a newly developed image processing engine

The scanner mounts a new image processing engine, the DR Processor, which is equipped with a high-speed CPU. This makes fast, high-quality scanning possible without depending on the performance of your PC. It also makes support possible for the newest interfaces such as USB3.1 Gen1.



The DR Processor reduces uneven coloring, allowing documents to be scanned as images that are more suitable for OCR (Optical Character Recognition).

## High-speed scanning

Whether color, gray, or black and white, up to 120 sides (60 two-sided documents, 200 dpi, A4 portrait) can be scanned per minute in a fast, one-pass operation. In addition, the heavy-duty Auto Document Feeder can hold up to 80 sheets of paper.

## User-friendly LCD Panel

Scanning status and count can be easily checked on LCD panel. Up to 99 jobs can be registered by combining commonly used scanning modes and output destinations. Users may select and execute a job from the LCD panel with a single click. With error and roller replacement notification incorporated to the LCD panel, the administrator is able to respond quickly should any problem arise.



## Quiet operation

Noise is significantly reduced compared to the previous model, thanks to the improvements of incorporated mechanical components. Comfortable user environment is realized.

## Easily scan various types of documents

DR-M260 is designed to handle various documents, which include thin receipts, thick cards and licenses. In addition, passport scanning is supported via the Automatic Document Feeder with the help of the carrier sheet. For large documents, they may be folded in half and scanned. After which, they can be recombined back into one image. Documents scanning of up to 5,588 mm (200 dpi) in length are supported as well.

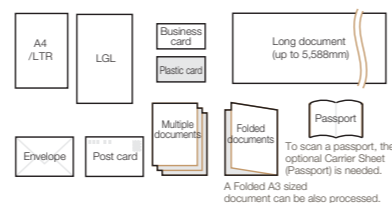

## Supreme paper-handling reliability

Featuring intelligent self-revolving feeder rollers, the DR-M260 prevents skewed feeding when documents of different sizes are inserted together as its left and right rollers rotate independent of each other.

In the event of paper jam, the detection by two types of sensors occur to prevent damage of important documents. The paper feeding error detection sensors quickly detect skewed documents and paper jams. The Paper Eject sensor, on the other hand, detects unusual document transit time, in order to prevent damaging of documents.

## Flexible double feed support

DR-M260 cleverly features an ultrasonic detection sensor that stops feeding automatically on detecting multiple overlapping documents passing through the scanner. Furthermore, the scanner is also equipped with the Separation Retry function which then returns the documents to feed tray for re-feeding automatically without the need for manual handling.

For scanning that involves more than one layer, i.e. carrier sheet, double feed detection setting may be disabled in order to proceed. Users will encounter double feed detection with error alert on LCD panel. They may select "Save and Continue" followed by pressing the "OK" button to continue with scanning.

## Bundled software

### CaptureOnTouch

CaptureOnTouch V4 provides easier and more effective scanning with new GUI, including a simple one-click operation for routine tasks such as scan-to-email or scan-to-desktop.



Two scanning methods are available to satisfy a variety of needs including adhoc and daily scanning. There is a "Standard Scanning" mode where scanning mode and output mode can be separately configured, and a "Scanning Shortcut" method where the specific scanning mode and output method are preconfigured, allowing one-click operation.

### CapturePerfect

CapturePerfect is Canon's own scanning application that makes it easy to get great scans straight out of the box. Through a user-friendly interface, the software provides users a wide selection of file-saving formats and file distribution options, such as searchable and encrypted PDF, Scan to Mail, Scan to Folder, and more.



### Driver Setting tool

The Driver Setting tool is a new enhancement which is exclusive for DR-M260. Utilizing the tool, customers are provided with access to change driver's default setting and given the flexibility to customize according to their needs.



In addition, system administrators can retrieve scanner information and status, as well as configure settings for maintenance.

## New V4 improved for business use

Automatic sorting and saving functions have been significantly improved on CaptureOnTouch V4.

Besides blank paper separation, scanned originals can be divided into single files based on barcode and counter separation as well. File name can either be set by using text scanned from the document, or simply with pre-configured text.

Files can also be sorted and saved into existing or new folders that are automatically created based on file-division such as barcode.

Once users have configured a set of rules, similar operations can be performed much more efficiently moving forward.

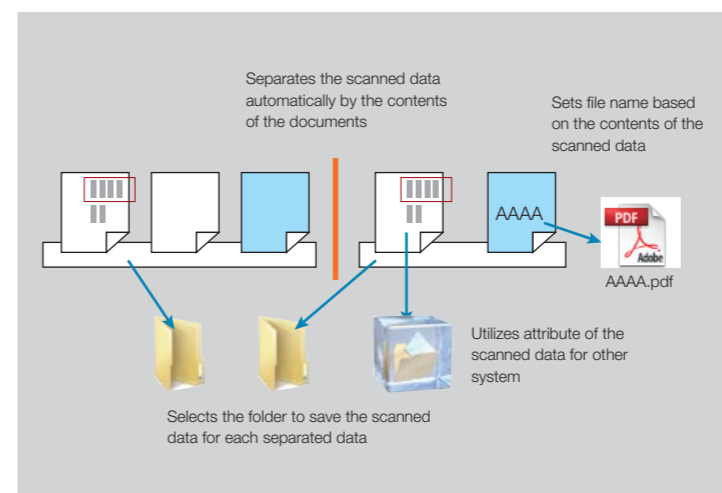

## A variety of image processing options

- Batch separation using blank sheets\***: Insert a blank sheet that will be recognized as a batch separator to automatically separate files.
- Folio**: Folded document → Scanned image
- Deskew**: Skewed image → Deskewed image
- Eliminator bleed-through/remove background**: Original → ON
- Text enhancement**: Original → ON
- Skip blank page**: Two-sided documents with a blank side → Image with blank page skipped
- Color dropout/enhancement**: Color document → Image with red drop-out set (red filtered)
- Text orientation detection**: B, D → B, D
- Automatic page size detection**: Document → Scanned image
- Image rotation**: ABCD → EFGH