

**1) Direct Restorations and Intraoral Repair of Restorations with Composite Resin**

Dispense one drop each of TOKUYAMA UNIVERSAL BOND A and B into the same disposable mixing well and mix.

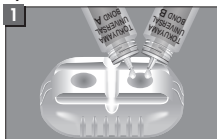

Apply the mixed bond.

No Need to Wait

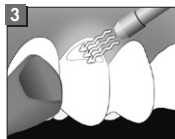

Apply weak air continuously to the surface until the runny bond stays in the same position without any movement, then mild (medium) air to the surface.

No Need to Light-Cure

Restore with a composite resin

**\*In the case of intraoral repair of restorations**

If the adherent surface includes tooth structure and restorations (ceramics, porcelain, metals or composite materials), apply TOKUYAMA UNIVERSAL BOND to the entire adherent surface at once. No extra primers are needed.

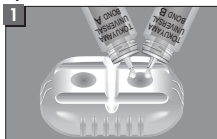
**2) Cementation of Indirect Restorations**

Dispense one drop each of TOKUYAMA UNIVERSAL BOND A and B into the same disposable mixing well and mix.

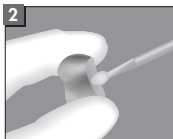

Apply the mixed bond.

No Need to Wait

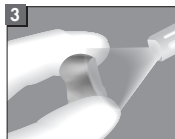

Apply mild (medium) air to the surface.

No Need to Light-Cure

Cementing

● **Etching of the tooth structure (optional)**

Clinically adequate adhesive bonds are achieved by the application of the adhesive. Selectively etching the enamel or using the "total etching procedure" can achieve higher adhesive values.

(a.) Selective-enamel-etch technique

Apply phosphoric acid gel only to the enamel surrounding the margin of prepared cavity and leave phosphoric acid gel in place for 10-15 seconds. Rinse the etched surface thoroughly (at least 15 seconds) with water, and then dry with mild air.

(b.) Total etch technique

Apply phosphoric acid gel onto the prepared enamel first, and then the dentin. The etchant should be left to react on the enamel and dentin for 10-15 seconds. Rinse thoroughly (at least 15 seconds) with water and dry with mild air or with cotton pellets; do not overdry.