

PRODUCT DATASHEET

Prefabricated Secondary Leads for Two Core Cables

**KDC501, -502,
KDC507 & -508**

FAA AC5345-26, L-823, Class A, Type I & II

KDC secondary leads are used for connecting the transformer and the secondary circuit. KDC secondary leads with double insulated two core cable provides unique dielectric strength for secondary circuit, since cable's outer sheath and all connections are made from same thermoplastic elastomer (TPE). Secondary leads are delivered either in prefabricated leads or in extension cords. Secondary leads are available with various cable diameter and with frangible break-away feature. KDC secondary leads are FAA certified and fulfill specifications MIL-C-3432, MIL-C-4921 and ICEA S-66-524.



Cable information for secondary leads

- Two core cable
- Dual insulation: EPR-insulated & TPE-sheathed
- Core insulation: special EPR compound
- Outer sheath: halogen free TPE compound (IEC 60752-2 / EN 50267-2-3)
- Copper conductors, Class 5 (IEC 60228)
- Size options: 1.5 mm², 2.5 mm², 4 mm²
- Nominal voltage: 600 V
- Temperature range: -40 to +120°C (-40 to 248 ° F)
- Short term short circuit temperature resistance 300°C (570°F)
- Bending radius: 5D
- FAA L-824 certified
- Fulfills specifications: MIL-C-3432, MIL-C-4921 & ICEA S-66-524

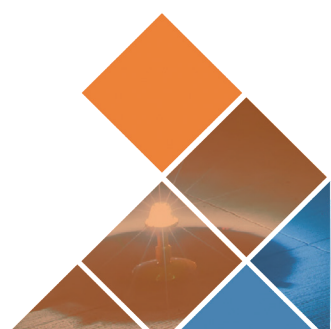













Two core cable information

EFLA Type	Diameter of insulation (mm, approx.)	Outer diameter (mm)	Max. conductor resistance at 20 °C (ohm/km)
2x1.5 mm ²	0.8	8.5 ± 0.3	13.7
2x2.5 mm ²	3.7	9.7 ± 0.3	7.98
2x4 mm ²	4.6	11.7 ± 0.1	4.98

Free end of the leads

The standard free end is sheath stripping of 5 cm. The following connectors are available.

		Free end type
	2 pcs 1.5-2.5 mm ² 6.3 mm flat connectors, uninsulated	KDCO1
	2 pcs 1.5-2.5 mm ² 6.3 mm flat connectors with common insulator	KDCO2
	2 pcs 1.5-2.5 mm ² 6.3 mm flat connectors with single insulators	KDCO3
	2 pcs 2.5 mm ² M4 cable shoes	KDCO10
	2 pcs 1.5 – 2.5 mm ² M6 cable shoes	KDCO11
	2 pcs 0.5 – 1.5 mm ² M4 cable shoes	KDCO12
	2 pcs 1.5 – 2.5 mm ² M5 cable shoes	KDCO13
	2 pcs 0.75-1.5 mm ² flat connectors, uninsulated	KDCO14
	2 pcs 1.5 mm ² flag connectors, uninsulated	KDCO15
	2 pcs 1.5-2.5 mm ² flag connectors, uninsulated	KDCO16
	2 pcs 1.0-1.5 mm ² flag connectors, uninsulated	KDCO17
	2 pcs 1.5 mm ² insulated flag connectors	KDCO18
	2 pcs 1.5-2.5 mm ² wire-end claws	KDCO19



Ordering information

KDC50X . X . X . X → Free end Type				
EFLA type			Cable cross section	
KDC501	secondary plug	Style 1	1	1.5 mm ²
KDC502	secondary receptacle	Style 7	2	2.5 mm ²
KDC507	secondary receptacle	Style 7	4	4 mm ²
KDC508	secondary receptacle	Style 8		
			Cable length = X	
			Standard lengths	Customized lengths, i.e
			30 (cm)	5 (cm)
			60 (cm)	10 (cm)
			100 (cm)	1000 (cm)
			150 (cm)	5000 (cm)

Outline

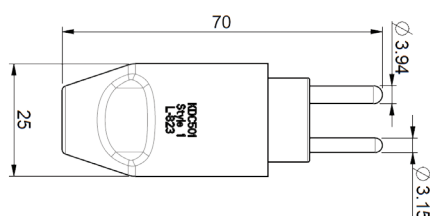

KDC501-series

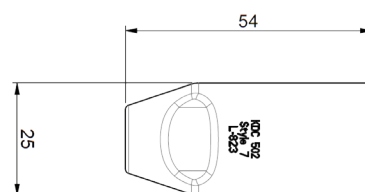

KDC502-series

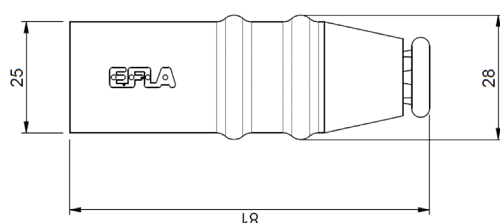

KDC507-series

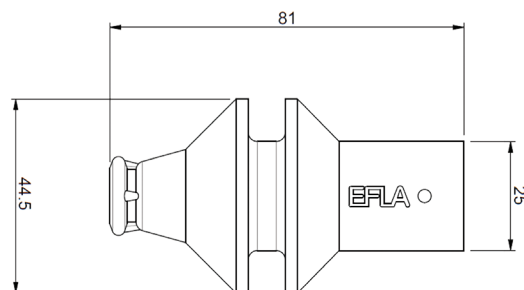

KDC508-series

Extension cords

These types above can be made to a specific length, with plug on one end and receptacle on the other. For example **KDCE501.4.3000** (4 mm² and 30 m).



EFLA is the world's leading supplier of seamless power and communication products for airfield ground lighting circuits. With more than 30 years experience in the field, it develops, manufactures and sells globally-certified series isolation transformers, connector kits and prefabricated cable leads. The company's components meet the highest qualifications in materials and electrical design to withstand challenging installation in underground pits and cans and direct underground installation. Headquartered in Porvoo, Finland, EFLA supplies products to international airports around the world.