

Temperature Measurement & Face Recognition Terminal Quick Start Guide

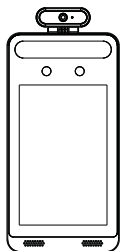

- High-accuracy IR body temperature measurement
- Non-contact body temperature measurement
- Human-sounding voice prompt
- Real-time face mask detection
- Face liveness detection technology distinguishing real faces from non-real face spoof attacks
- Highly accurate face recognition using deep learning algorithm
- Stand-alone device, ready for networking
- Exporting details to excel (if using SD card)
- Exporting details to excel, searching and statistics (using CMS)
- Mask detection
- Capable of pushing facial recognition database to multiple tablets (using CMS)
- WAV file uploads, create your own audible voice comments
- Create Custom Recordings
- Red/green light alarm output trigger for over/healthy scans

1 Package

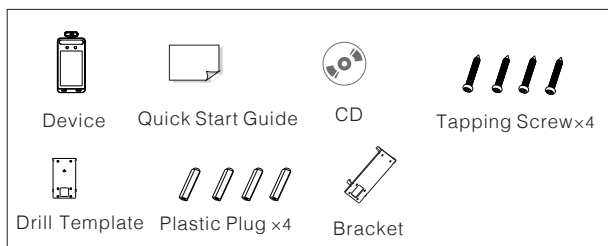

2 Overview

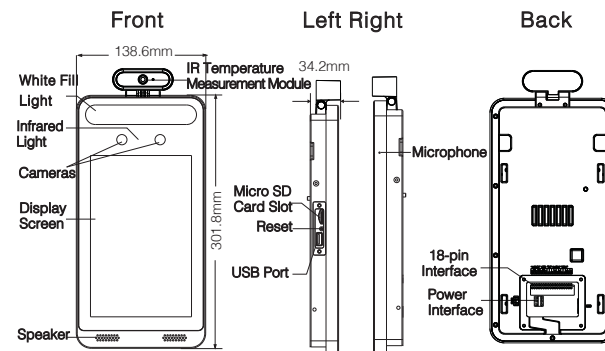

3 Cable Connection

18-pin Interface

1	2	3	4	5	6	7	8	9	10	11	12	13	14	15	16	17	18
NO2	COM2	NO1	COM1	NO3	COM3	NC3	D+	D-	IN1	GND	IN2	GND	D0	D1	GND	BUT	GND
2CH alarm output				Lock interface			RS 485		2CH alarm input				Wiegand interface			Exit Button Connector	

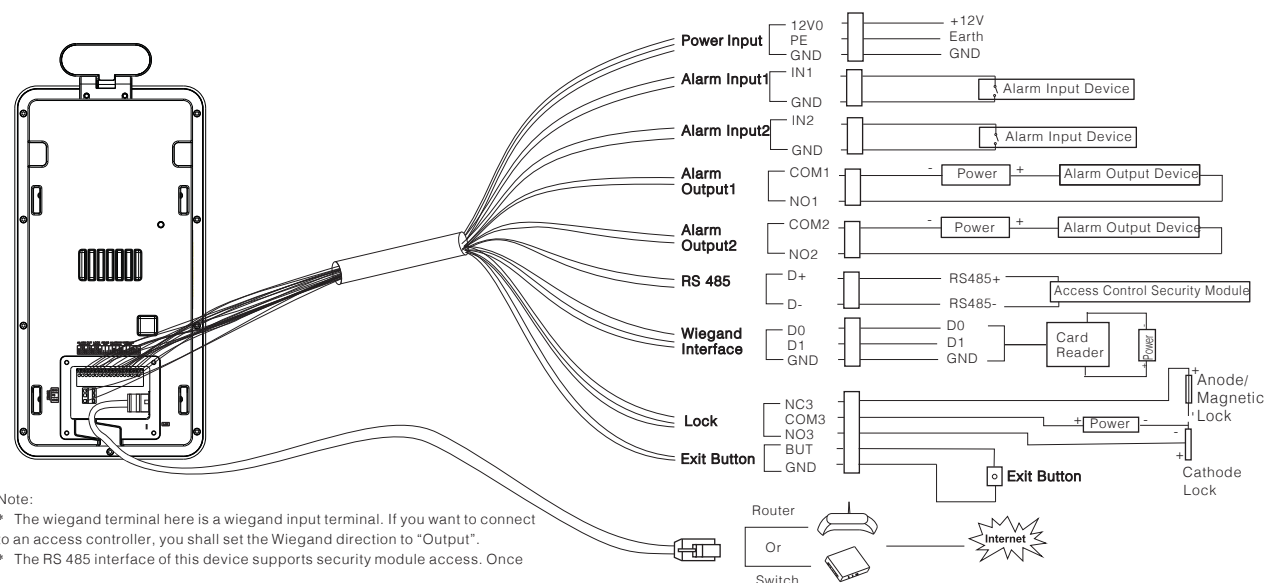

Note:

- * The Wiegand terminal here is a Wiegand input terminal. If you want to connect to an access controller, you shall set the Wiegand direction to "Output".
- * The RS 485 interface of this device supports security module access. Once

Power Supply Sold Separately

4 Installation

Ambient Illumination Requirement

Make sure faces can be captured clearly.

Avoid direct sunlight and backlight.

The device should be at least 2 meters away from the light, and at least 3 meters away from the window or door.

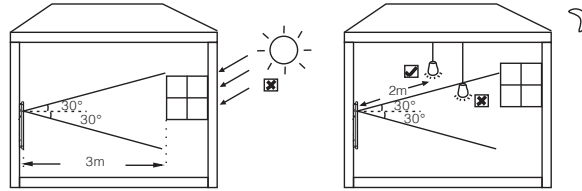

Installation

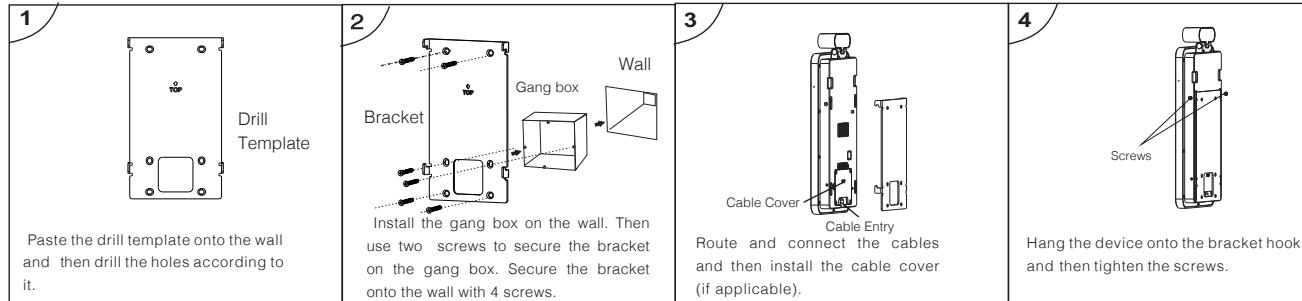

Pole Mounting

Note: Pole mounting bracket is not supplied with the device by default.

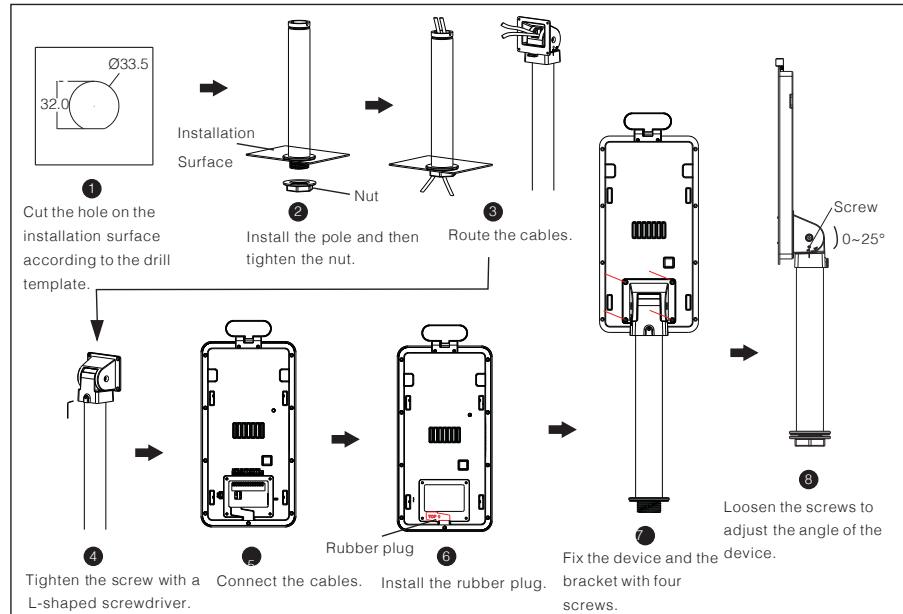

Height Requirement

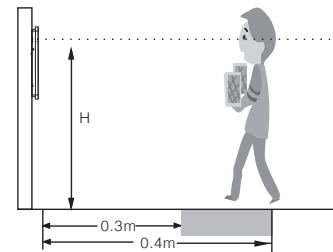

- The recommended installation height (H) is from 1.30m to 1.45m which can cover human height of 1.4m ~ 1.9m in the detection area. It can be adjusted according to the actual scene.
- The best temperature measuring distance ranges from 0.3m to 0.4m.

5 Accessories



- IPM-TABLETDESK:
Desktop Bracket For PAR-P2TEMPTABLET



- IPM-TEMPPED2
Stand Bracket FOR
PAR-P2TEMPTABLET



- IPM-TABLETURN:
TURNSTILE BRACKET For
PAR-P2TEMPTABLET



- IPS-2.5AMP:
12V Plug-in Power
Supply, 2.5 AMP

- Wall Mount Included