



Leaders in Superabrasive Finishing Systems

LPM Series Single-Pass Bore Finishing



Single-Pass Bore Finishing Model LPM-4000ES shown

High Precision, Tight Tolerance, Low Per Part Cost
For high volume applications, Engis single-pass bore finishing systems are the unsurpassed solution for forward thinking manufacturers to improve roundness, concentricity and finish.

Utilizing the single-pass process, extremely tight tolerances can be held reliably and consistently in your production environment, at a lower overall cost per finished piece. Additionally, Engis diamond plated and superabrasive bore finishing tools ensure high quality by achieving – in standard and semi-blind bores – bore geometries to within one half of a micron (0.000020”) bringing precise accuracy to your finished part.

Single-Pass Bore Finishing Benefits include:

- Reduced labor costs through automated finishing
- Lower cost per hole through long tool life
- Predictable, consistent results
- Improved bore quality
- Fewer rejects
- Less frequent part inspection
- Shorter cycle times
- Higher production rates
- SPC values >2.0 Cpk

This series is a standard line of machines designed to meet the needs of job shops for medium to large size parts. Available in 4, 6 and 8 spindle models, these systems are primarily for parts up to 6” diameter.

BORE FINISHING

LPM SERIES

Standard features:

- Servo fed column design
- 635mm (25”) stroke
- Electric index table
- Mitsubishi full CNC Controls

Machine Also Includes:

- Class 7 duplex spindle bearings
- 1-3/8” diameter ASA spindles
- Pre-lubed for life slides and ball screw
- Pneumatic counter balance on head
- Optional automation, gauging, brushing and guarding packages are available

ENGIS CORPORATION

Leaders in Superabrasive Finishing Systems
105 W. Hintz Road, Wheeling, IL 60090-6038
Tel: 847.808.9400 • Fax: 847.808.9430 • Toll Free 800.99.ENGIS
www.engis.com





Leaders in Superabrasive Finishing Systems

LPM Series

Optional automatic tool size compensation is available using a servo motor controlled, precision drawbar on each spindle.

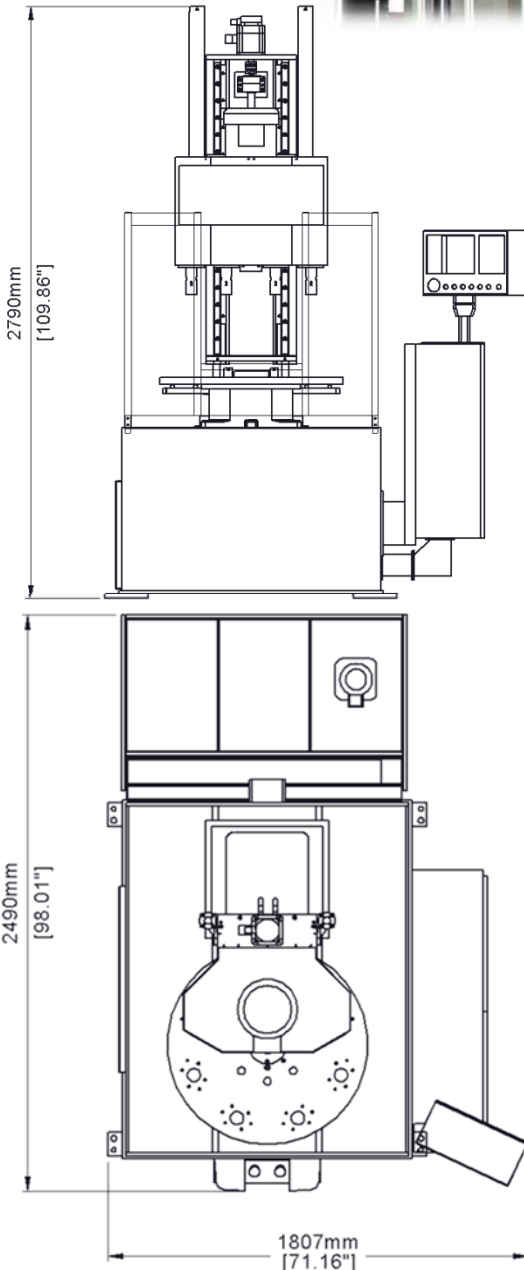

SPECIFICATIONS:

Machine Weight:	2,500 kg (5,500 lbs)
Required Air Pressure:	90 PSI 5 CFM
Operating Voltage:	460V 50/60Hz 3Pz
Dial Plate Diameter:	864mm (34")
Z-axis Travel:	635mm (25") standard Extended stroke available
Maximum Rapid Speed:	8890 mm/min (350 IPM)
Spindle Motor:	7.5 HP Standard (up to 15 HP available)
Spindle Speed:	100-1500- RPM
Spindle:	1-3/8 diameter ASA
Spindle Nose to Table Max:	740mm (29") standard Extended length available
Available # of Tools:	4, 6 and 8
Controller:	Mitsubishi (standard) Other types available
Programming:	G-Code
Able to process 2 parts/cycle	

OPTIONS:

- 208 liter (55 gallon) coolant system with double cartridge filtration
- Rotary manifold for pneumatically activated clamping
- Spindle crash protection
- Solid tool holder with or without crash protection
- Floating tool holder with or without crash protection
- Floating tool holder with angle modification with or without crash protection
- Full perimeter guarding
- Automation and gauging packages available
- Standard and custom fixturing packages
- Automatic Size Compensation

BORE FINISHING

ENGIS CORPORATION

Leaders in Superabrasive Finishing Systems

105 W. Hintz Road, Wheeling, IL 60090-6038

Tel: 847.808.9400 • Fax: 847.808.9430 • Toll Free 800.99.ENGIS

www.engis.com

Engis is a registered trademark of Engis Corporation U.S.A and other countries.

LPM-004-1116