

BASELINE PROGRAM

| | |
|-------------------|----|
| PHONE BOOTHS | 1 |
| MEETING ROOMS | 2 |
| EXECUTIVE OFFICES | |
| DESK COUNT | 28 |

ADDITIONAL PROGRAM

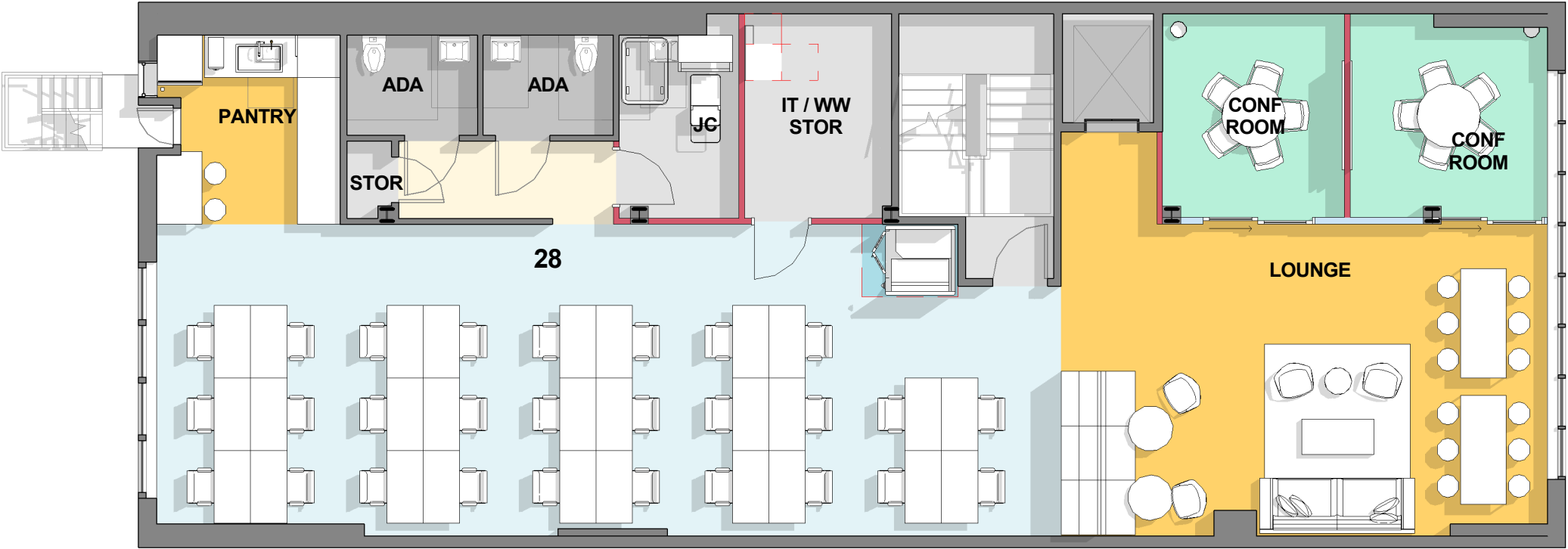

PROGRAM CATEGORIES

| | |
|-----------|------------|
| CIRCULATE | WASH |
| MEET | WORK |
| OPERATE | ADDITIONAL |
| WE | |

WALL TYPES

| | |
|----------|----------|
| EXISTING | GLASS |
| COLUMNS | GYP |
| | BRANDING |

CONFIDENTIAL
S203

SALES
FLOORS 4 & 5

130 Madison