

PROJECT: _____	UNIT TAG: _____	QUANTITY: _____
REPRESENTATIVE: _____	TYPE OF SERVICE: _____	DATE: _____
ENGINEER: _____	SUBMITTED BY: _____	DATE: _____
CONTRACTOR: _____	APPROVED BY: _____	DATE: _____
	ORDER NO.: _____	DATE: _____



### CMBE 10-54 I-U-C-E-D-G

Compact booster set for water supply in light commercial applications. Pump materials in contact with the liquid are in stainless steel AISI 304 (EN 1.4301)

Product photo could vary from the actual product

Conditions of Service	Pump Data	Motor Data
Flow: _____	Liquid temperature range: 32 .. 140 °F	Rated power - P2: 2 HP
Head: _____	Maximum ambient temperature: 122 °F	Rated voltage: 200-240 V
Efficiency: _____	Shaft seal: AQQE	Main frequency: 50 / 60 Hz
Liquid: Water	Product number: 98548118	Enclosure class: IP55
Temperature: 68 °F		Insulation class: F
NPSH required: ft		
Viscosity: _____		
Specific Gravity: 1.000		

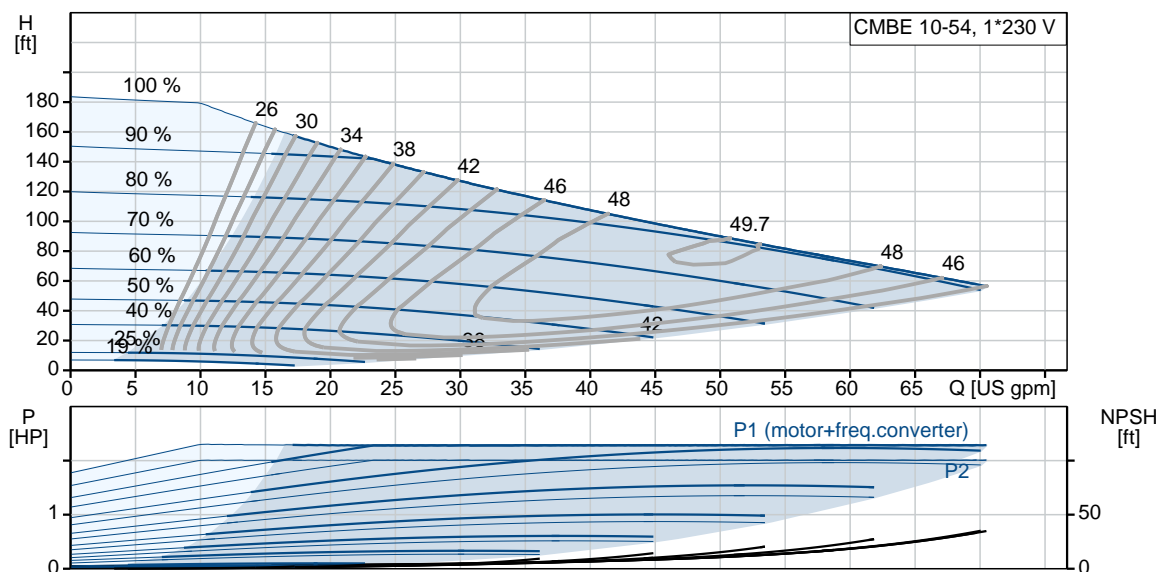

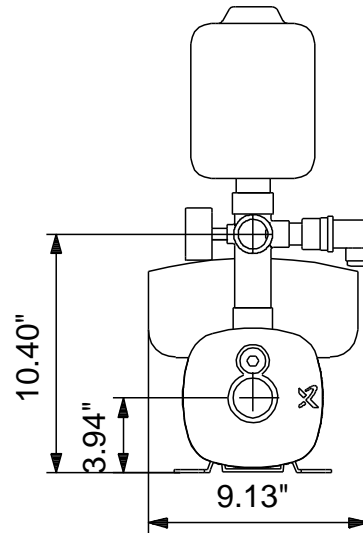
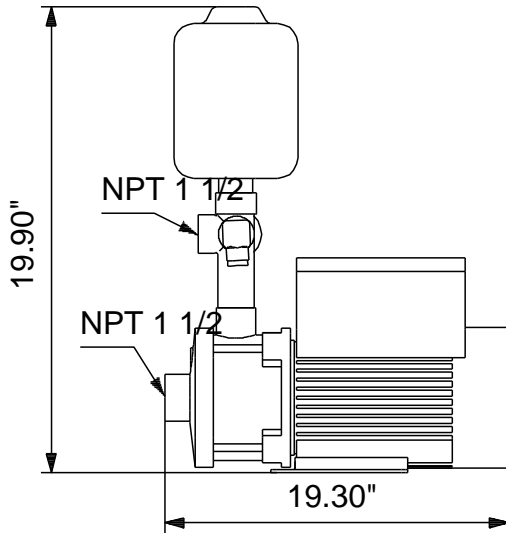

**Materials:**

- Pump housing: Stainless steel  
AISI 304
- Impeller: Stainless steel  
DIN W.-Nr. 1.4301  
AISI 304
- Rubber: EPDM

Count	Description														
1	<p data-bbox="288 405 592 439"><b>CMBE 10-54 I-U-C-E-D-G</b></p> <div data-bbox="443 456 544 696" style="text-align: center;">  </div> <p data-bbox="288 734 568 768">Product No.: <a href="#">98548118</a></p> <p data-bbox="288 792 916 999">The Grundfos CME Booster is a compact booster system for water supply in domestic applications. The integrated speed controller enables the CME Booster to keep constant pressure in the pipe system. A pressure sensor monitoring changes in the water consumption will signal to the speed controller to change the motor speed to adapt performance to the new state.</p> <p data-bbox="288 1003 963 1093">The CME Booster is very easy to install. When the pipework has been installed, it is all a matter of plugging the unit into a socket, and the system is operational.</p> <p data-bbox="288 1097 632 1131">The CME Booster consists of:</p> <ul data-bbox="288 1135 836 1272" style="list-style-type: none"> <li>• CME pump with integrated frequency converter</li> <li>• 5-way valve</li> <li>• expansion tank</li> <li>• pressure gauge</li> <li>• manometer</li> </ul> <p data-bbox="288 1301 400 1335"><b>Features</b></p> <ul data-bbox="288 1339 804 1480" style="list-style-type: none"> <li>• Constant pressure, integrated speed control</li> <li>• compact</li> <li>• robust, stainless steel</li> <li>• easy installation</li> <li>• dry run protection</li> </ul> <p data-bbox="288 1509 512 1543"><b>Thermal protection</b></p> <p data-bbox="288 1547 940 1581">CME Booster pumps require no external motor protection.</p> <p data-bbox="288 1585 892 1659">The MGE motor incorporates thermal protection against slow overloading and blocking (IEC 34.11: TP 211).</p> <p data-bbox="288 1720 384 1753"><b>Liquid:</b></p> <table data-bbox="288 1758 798 1865"> <tr> <td>Pumped liquid:</td> <td>Water</td> </tr> <tr> <td>Liquid temperature range:</td> <td>32 .. 140 °F</td> </tr> <tr> <td>Selected liquid temperature:</td> <td>68 °F</td> </tr> <tr> <td>Density:</td> <td>62.29 lb/ft³</td> </tr> </table> <p data-bbox="288 1895 424 1928"><b>Technical:</b></p> <table data-bbox="288 1933 903 2018"> <tr> <td>Pump speed on which pump data is based:</td> <td>3868 rpm</td> </tr> <tr> <td>Rated flow:</td> <td>54.2 US gpm</td> </tr> <tr> <td>Rated head:</td> <td>82.35 ft</td> </tr> </table>	Pumped liquid:	Water	Liquid temperature range:	32 .. 140 °F	Selected liquid temperature:	68 °F	Density:	62.29 lb/ft³	Pump speed on which pump data is based:	3868 rpm	Rated flow:	54.2 US gpm	Rated head:	82.35 ft
Pumped liquid:	Water														
Liquid temperature range:	32 .. 140 °F														
Selected liquid temperature:	68 °F														
Density:	62.29 lb/ft³														
Pump speed on which pump data is based:	3868 rpm														
Rated flow:	54.2 US gpm														
Rated head:	82.35 ft														



Company name: Hurley Engineering  
Created by:  
Phone:

Date: 5/20/2020

Count	Description
	Primary shaft seal: AQQE Approvals and markings: CE,CULUS Curve tolerance: ISO9906:2012 3B Return valve: YES Start pressure: Integrated Frequency converter
	<b>Materials:</b> Pump housing: Stainless steel AISI 304 Impeller: Stainless steel DIN W.-Nr. 1.4301 AISI 304 Rubber: EPDM
	<b>Installation:</b> Maximum ambient temperature: 122 °F Pump inlet: NPT 1 1/2 Pump outlet: NPT 1 1/2
	<b>Electrical data:</b> Rated power - P2: 2 HP Main frequency: 50 / 60 Hz Rated voltage: 1 x 200-240 V Maximum current consumption: 9.10-7.60 A Rated speed: 360-4000 rpm Enclosure class (IEC 34-5): IP55 Insulation class (IEC 85): F Type of cable plug: NONE Mains cable: NO CABLE m
	<b>Tank:</b> Tank volume: 0.528 gal
	<b>Others:</b> Net weight: 53 lb Gross weight: 75 lb Country of origin: US Custom tariff no.: 8413.70.2040



Company name: Hurley Engineering  
Created by:  
Phone:

Date: 5/20/2020

### 98548118 CMBE 10-54 I-U-C-E-D-G

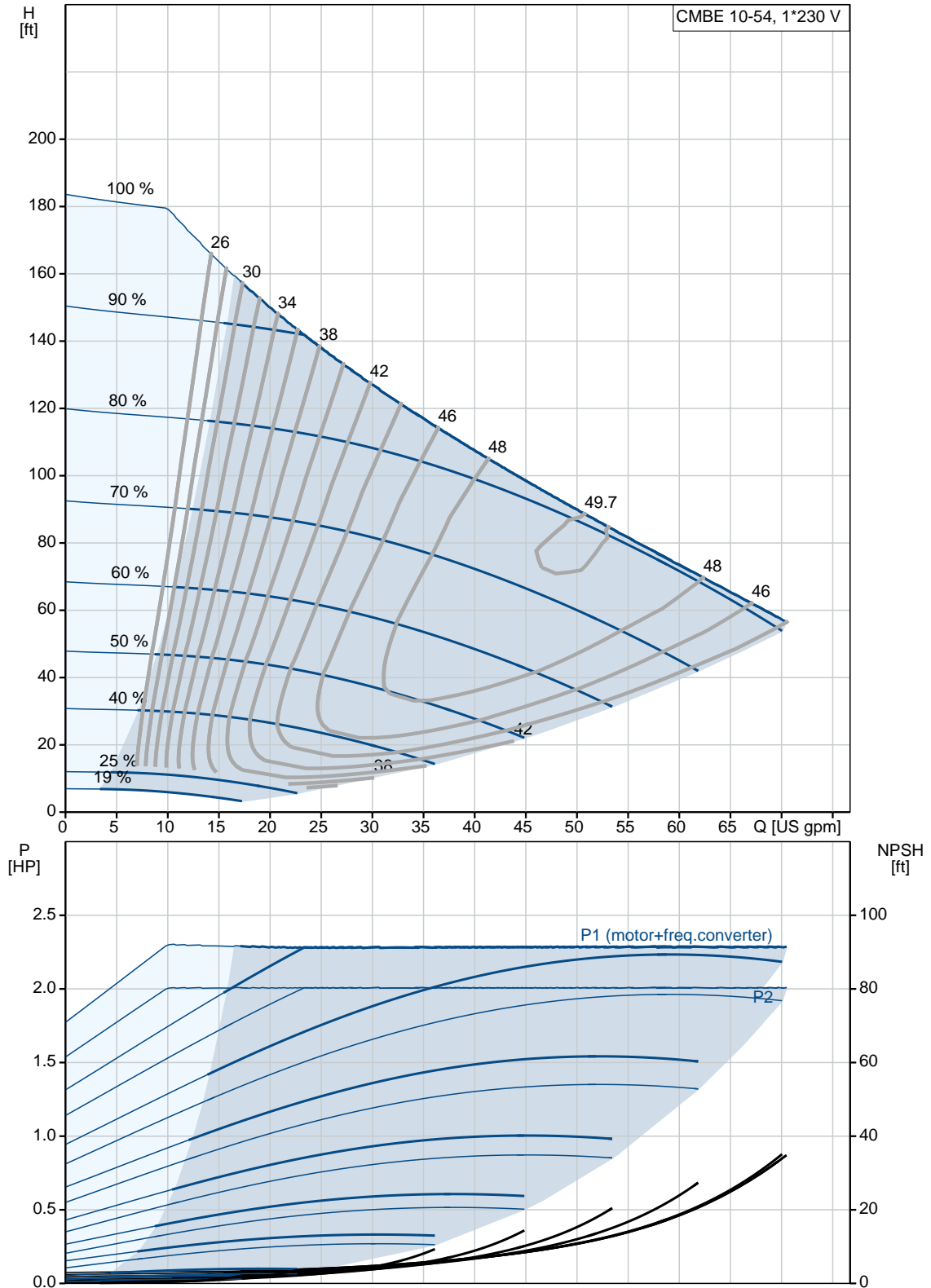

Description	Value
<b>General information:</b>	
Product name:	CMBE 10-54 I-U-C-E-D-G
Product No.:	98548118
EAN:	5711496977558 5711496977558
<b>Technical:</b>	
Pump speed on which pump data is based:	3868 rpm
Rated flow:	54.2 US gpm
Rated head:	82.35 ft
Impellers:	2
Primary shaft seal:	AQQE
Approvals and markings:	CE,CULUS
Curve tolerance:	ISO9906:2012 3B
Model:	A
Return valve:	YES
Start pressure:	Integrated Frequency converter
<b>Materials:</b>	
Pump housing:	Stainless steel AISI 304
Impeller:	Stainless steel DIN W.-Nr. 1.4301 AISI 304
Rubber:	EPDM
<b>Installation:</b>	
Maximum ambient temperature:	122 °F
Pump inlet:	NPT 1 1/2
Pump outlet:	NPT 1 1/2
<b>Liquid:</b>	
Pumped liquid:	Water
Liquid temperature range:	32 .. 140 °F
Selected liquid temperature:	68 °F
Density:	62.29 lb/ft <sup>3</sup>
<b>Electrical data:</b>	
Rated power - P2:	2 HP
Main frequency:	50 / 60 Hz
Rated voltage:	1 x 200-240 V
Maximum current consumption:	9.10-7.60 A
p max system:	145.04 psi
Rated speed:	360-4000 rpm
Enclosure class (IEC 34-5):	IP55
Insulation class (IEC 85):	F
Type of cable plug:	NONE
Mains cable:	NO CABLE m
<b>Tank:</b>	
Tank volume:	0.528 gal
<b>Others:</b>	
Net weight:	53 lb
Gross weight:	75 lb
Config. file no:	98442578
Country of origin:	US
Custom tariff no.:	8413.70.2040

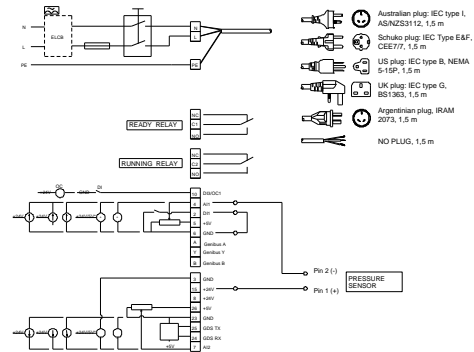
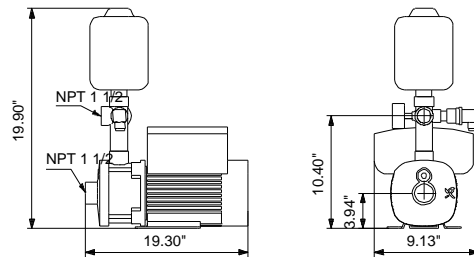
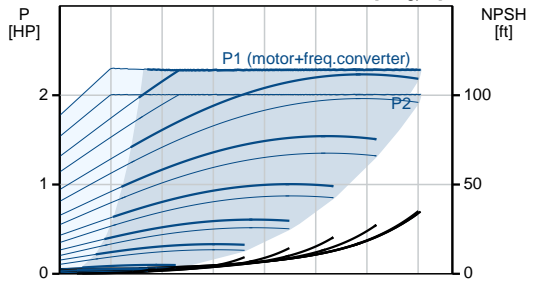
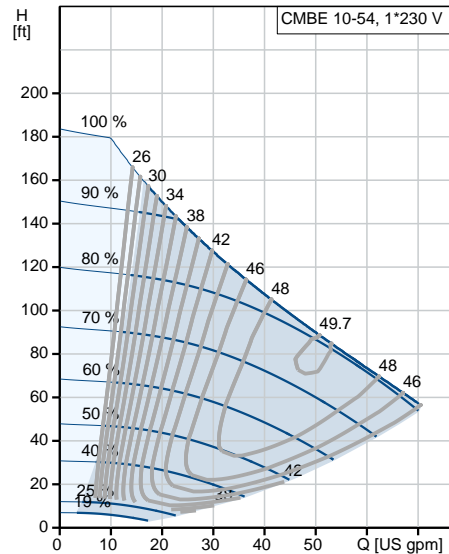

**98548118 CMBE 10-54 I-U-C-E-D-G**

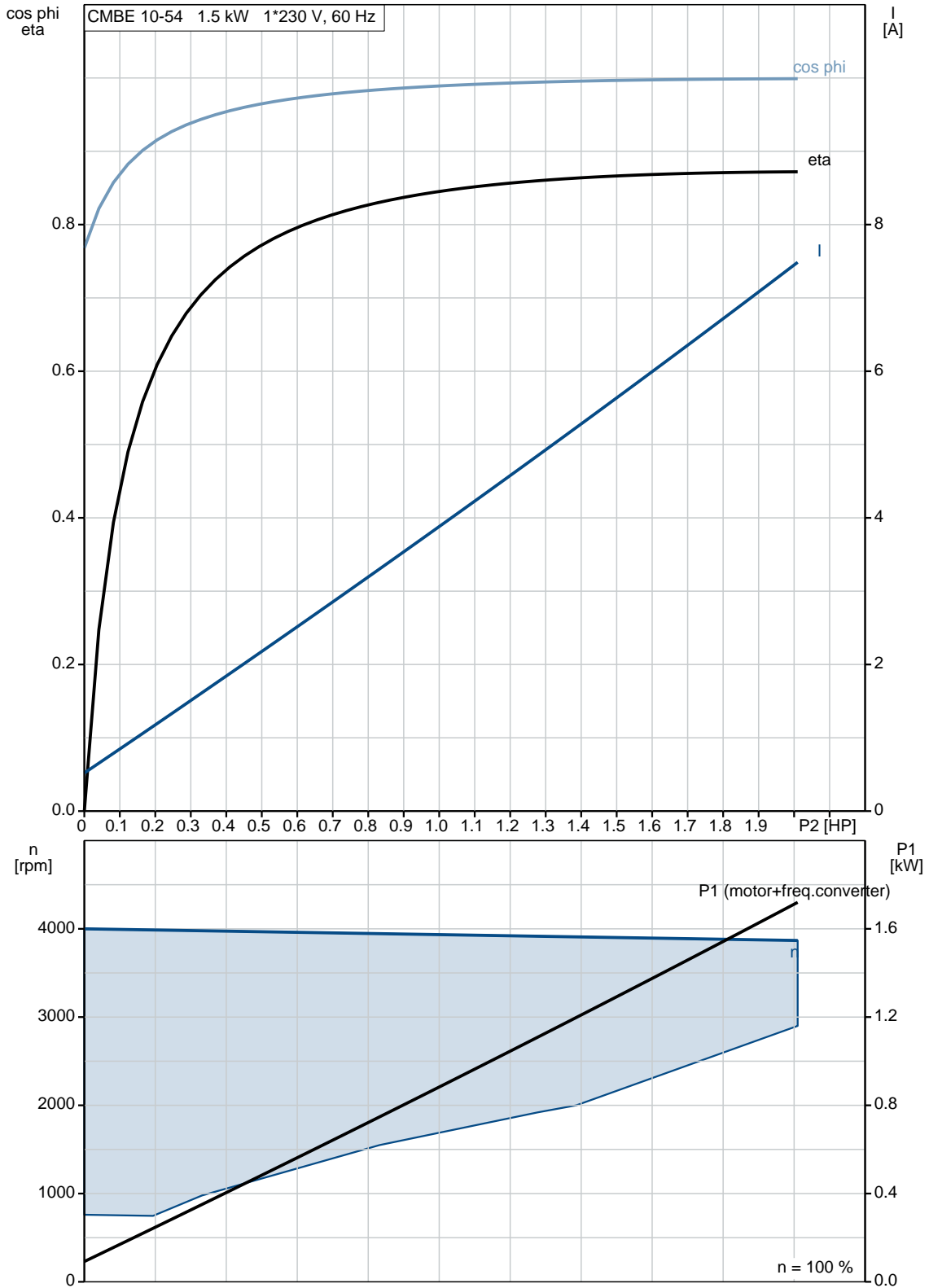



Company name: Hurley Engineering  
Created by:  
Phone:

Date: 5/20/2020

### 98548118 CMBE 10-54 I-U-C-E-D-G

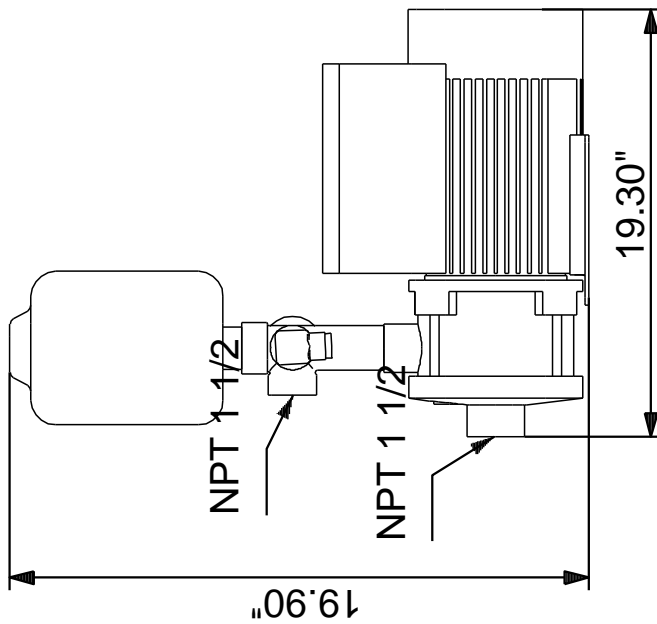
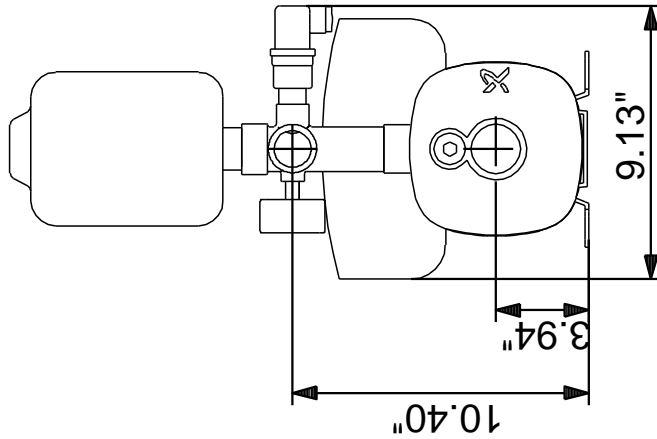

Note! All units are in [in] unless otherwise stated.  
Disclaimer: This simplified dimensional drawing does not show all details.



## 98548118 CMBE 10-54 I-U-C-E-D-G

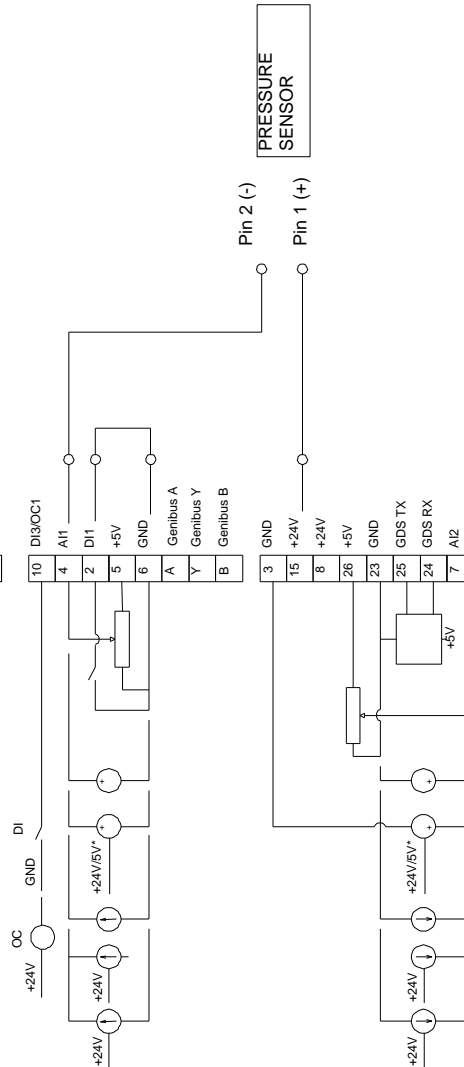
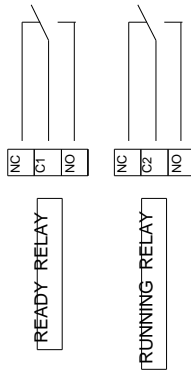
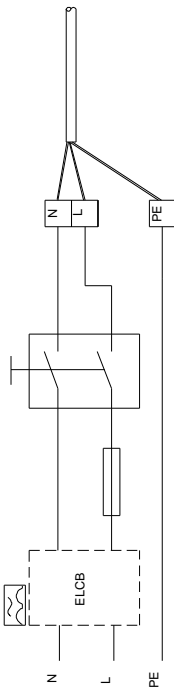
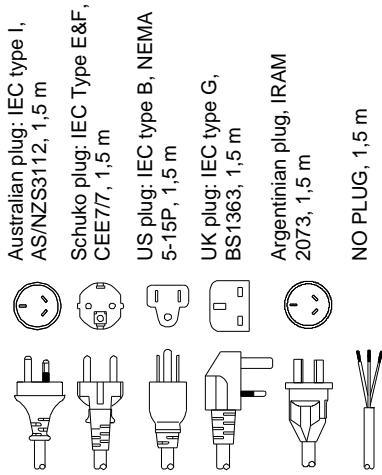

PRESSURE SENSOR

All units are [in] unless otherwise presented.



**Company name:** Hurley Engineering  
**Created by:**  
**Phone:**

**Date:** 5/20/2020

---

**Order Data:**

Product name: CMBE 10-54 I-U-C-E-D-G  
Amount: 1  
Product No.: 98548118

Total: Price on request

---