

RTV-304, 404, 504, 604, 801

EXTRA LARGE CENTER BORE • DUAL DISC HYDRAULIC CLAMPING

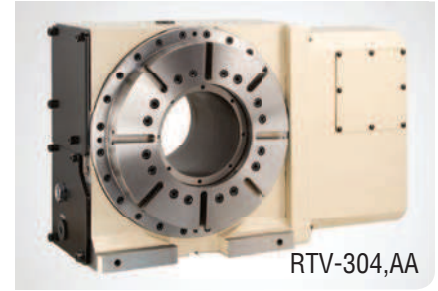



The RTV-Series rotary tables feature a extra large center bore. RTV tables utilize a powerful dual disc hydraulic clamping mechanism. An optional air/hydraulic booster is also available. “AA” tables have the motor mounted on the right. “BA” tables have the motor mounted on the left.

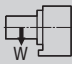

RTV-304,AA

Specifications ►

Dimensions = mm

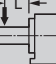
Table Model		RTV-304	RTV-404	RTV-504	RTV-604	RTV-801
Versions available		AA, BA	AA, BA	AA, BA	AA, BA	AA, BA
Table diameter	mm	350	450	550	650	800
Center height	mm	235	280	350	400	530
Center bore	Nose Diameter	mm	190H7	250H7	315H7	385H7
	Thru Diameter	mm	160	209	270	340
Table T-slot width		14H7	14H7	18H7	18H7	18H7
Guide block width		18h7				22h7
Servo motor (Fanuc)*		Alpha 12i				
Maximum motor speed		rpm				
Speed reduction ratio		1/90	1/90	1/120	1/180	1/360
Maximum table speed		rpm	33.3	33.3	25	16.6
Inertia converted into motor shaft		$\times 10^{-3} \text{kg} \cdot \text{m}^2$	2.70	4.05	6.01	5.48
Clamp system**		Hydraulic				
Clamp torque @500psi		Nm (ft. lbs.)	2,700 (1,990)	4,600 (3,390)	5,800 (4,275)	10,000 (7,370)
Indexing accuracy		arc sec.	±7.5			
Repeatability		arc sec.	±2			
Net Weight		kg (lbs.)	180 (396)	430 (946)	590 (1,298)	910 (2,000)
Allowable wheel torque		Nm (ft. lbs.)	1,370 (1,010)	2,630 (1,938)	4,200 (3,095)	5,500 (4,053)
Allowable work inertia		$\text{kg} \cdot \text{m}^2$	10.0	20.0	30.0	58.0
Allowable work weight	 kg (lbs) [w/ tailstock]	300 (660) [500 (1,100)]	350 (770) [700 (1,540)]	500 (1,100) [1,000 (2,200)]	550 (1,210) [1,100 (2,420)]	600 (1,320) [1,500 (3,300)]
	 kg (lbs)	500 (1,100)	700 (1,540)	1,000 (2,200)	1,100 (2,420)	1,500 (3,300)
Allowable load when table clamped	 N (lbf)	29,400 (6,586)	45,000 (10,080)	54,000 (12,096)	54,000 (12,096)	64,400 (14,426)
	 Nm (ft. lbs.)	2,700 (1,990)	4,600 (3,390)	5,800 (4,275)	10,000 (7,370)	14,500 (10,687)
	 Nm (ft. lbs.)	3,626 (2,672)	8,000 (5,896)	15,132 (11,152)	15,132 (11,152)	27,000 (19,899)

* Other motors & RPM available

** Booster optional

Specifications subject to change without notice

Dimensions ►

Drawings not to scale • Dimensions = mm

RTV-304,AA

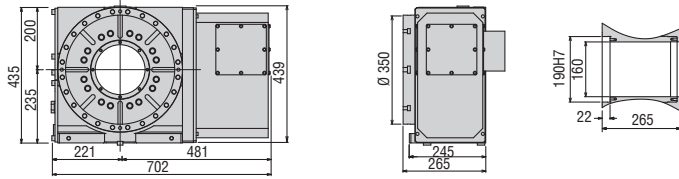

RTV-404,AA

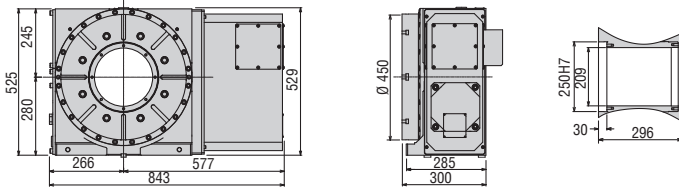

RTV-504,AA

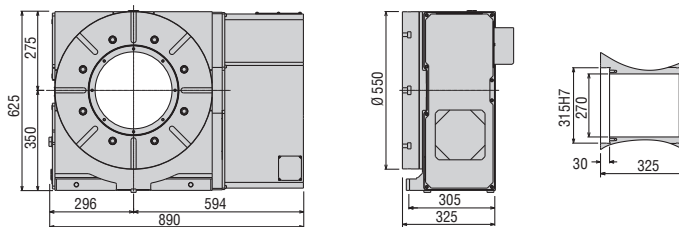

RTV-604,AA

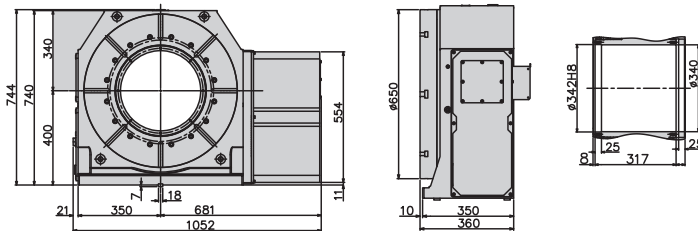

RTV-801,AA

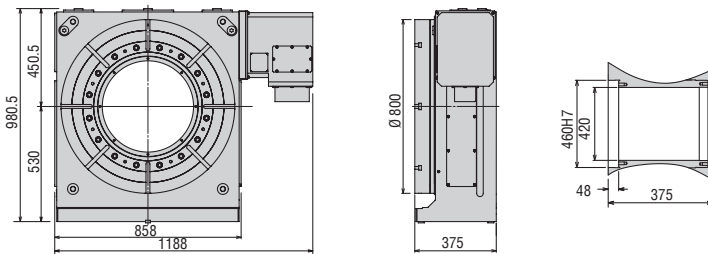

The dimensions above are for tables with a FANUC servo motor. Other motors available (dimensions may increase).

Clamping Block and Bolt ►

Dimensions = mm

	Type	Q'ty	T-Slot Width	A	B	C	D	E	F	G	H	I	J	K	L	M
RTV-304	I	4	18	30	15	90	16	31	43	25	21	11	70	46	28	16
RTV-404	I	4	18	40	20	109	18	42	50	25	21	11	70	46	28	16
RTV-504	I	4	18	40	20	109	18	42	50	25	21	11	70	46	28	16
RTV-604	II	4	18	40	20	63	18	15	30	58	21	11	105	60	28	16
RTV-801	II	4	22	60	28	95	29	16	50	88	27	13	145	100	32	20

Note: When using a machine with a T-slot pitch other than the above, use suitable clamping blocks and bolts that are available on the market, or order custom-made ones from KOMA (opt.)

• RTV-801,AA



• RTV Big Bore Chucks
Contact KOMA for custom big bore chuck information



Options & Accessories

TPC NC Controller	p.66
Chucks	p.77
Tailstock	p.79
Support Spindle	p.79
Encoder / Scale	p.82
Pull Stud Device	p.83
Rotary Joint	p.83
Air/Hydraulic Booster	p.84
PVC or Steel Cables	p.84

Type I

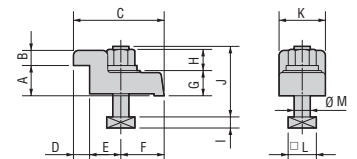

Type II

