



# SPARE PARTS

## COMBUSTION, CONTROL & SERVICES

## TURBO BLOWERS



Turbo Blowers  
8 to 24 osi – 70,000 to 700,000 cfh



Turbo Blowers 4-44 OSI & 55-11,500 CFM for  
standardized product 4-60 OSI, up to 100,000 CFM  
for custom product



Filter and Silencers for  
2300 and 2400 Blowers

- Direct drive blowers specifically for combustion applications
- Equipped with Premium Energy Efficient Motors
- Available in single or multiple stage designs at 1,800 rpm or 3,600 rpm

# AIR SYSTEMS / ACCESSORIES

## VALVES

### Butterfly Valves



- Motor Operated
- Manual



10'' Adjustable Port Air Valve  
Pneumatic Operator



2½'' Adjustable Port Air Valve  
Pneumatic Operator



Other valves for Air

## ACTUATORS



## OXYGEN DETECTORS



### Also detectors for:

- NO<sub>x</sub>
- CO
- NO

## PRESSURE SWITCHES & GAUGES



- Ranges from 0.16'' wc to 200'' wc
- SPDT snap-action switch
- FM and UL approved



- Ranges from 0.16'' wc to 200'' wc
- SPDT snap-action switch
- NEMA 4 enclosure
- FM, UL, CSA approved

# GAS SYSTEMS / ACCESSORIES

## VALVES



Adjustable Port



Shut-off



Butterfly solenoids, limiting orifice, etc.

## ORIFICE METERING SYSTEMS



## ACTUATORS



## REGULATORS



High Pressure



And Repair Kits for  
Regulators



Low Pressure

## PRESSURE SWITCHES & GAUGES



- Ranges from 0.16'' wc to 200'' wc
- SPDT snap-action switch
- FM and UL approved



- Ranges from 0.16'' wc to 200'' wc
- SPDT snap-action switch
- NEMA 4 enclosure
- FM, UL, CSA approved

# COMBUSTION SYSTEMS / EQUIPMENT

## GAS BURNERS



### High Velocity Gas Burners

Low NOx emissions  
High excess air and excess fuel  
Direct spark ignition  
Integral air and gas meters



### Low NOx Flat Flame

Excess Air Operation  
Minimal Forward Flame Velocity  
Preheated Air to 750°F



### For Ovens, Dryers and Air Heaters Natural gas, propane or butane

Less than 7" wc (178 mm H<sub>2</sub>O) gas pressure required at burner inlet  
Low NOx performance – less than 0.1 lb NOx/million Btu (161 mg/m<sup>3</sup> at 3% O<sub>2</sub>)

## OXYGEN BURNERS



- Diffused flame which spreads heat over a wider area compared to other oxygen burners.
- Can be used on metal melting furnaces without the risk of water/steam explosions.



- Superior luminous flame heat transfer
- Exceptionally Low NOx
- Low Oxygen Pressure Requirement
- Simple installation
- Low maintenance simple operation

## OIL BURNERS

Complete burners shown with optional (recommended) Sensitrol Oil Valve



- Oil-only Burner (light or heavy grade oil)
- 1.8 to 30 million Btu/hr
- Includes low pressure fuel oil atomizer
- Chambers up to 2,400 °F (with alloy nose)

## DUAL-FUEL BURNERS



- Wide capacity ranging from 3,000,000 to 30,000,000 Btu/hr
- Low NOx
- Different control options
- Built-in Fan: Delivers 100% of combustion air required for burner operation



- Dual Fuel Burner, gas or oil (light or heavy grade oil)
- Short and wide flame pattern
- 18 to 75 million Btu/hr
- For furnaces, boilers, air heaters, incinerators, gypsum kettles, etc.
- Broad stability range
- Chambers up to 2200F
- Includes high pressure tip emulsion atomizer

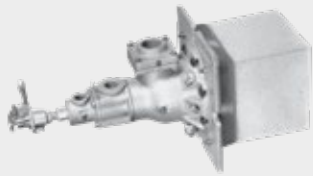

- Widely used on heat treatments and non-ferrous melting furnaces, kilns, ovens, air heaters, dryers, chemical process equipment where superior temperature uniformity is required



- High velocity
- Low NOx
- High turndown
- Inputs from 6 to 16 million Btu/hr
- Gas and light oil

## SPARK IGNITERS



- Improves ignition by increasing the spark area
- Eliminates gas pilot components and pilot maintenance
- Increases life by using combustion air to cool down the igniter

## PARTS OF AN IGNITION SYSTEM



Pilot Sets

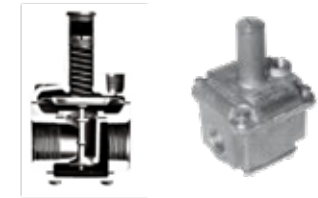

Pilot Gas Regulators

- Ignition Cables
- Pilot Mixers
- Nozzles

## SPARE PARTS FOR BURNERS



Observation Ports

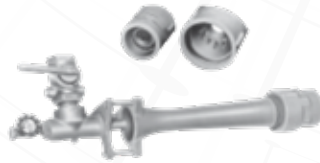

Flame Retention Nozzles

- Burner Blocks
- Burner Gaskets
- Mounting & Tile Assembly
- Atom Assembly
- Air tubes

## FLAME FAILURE SYSTEM

Flame Detectors



**And other accessories, such as Automatic Burner Control:**

- Flame Relay Module
- Time Delay Relay Module

**fives north american**





## GET IN TOUCH!

Kilns and Furnaces  
Email: [sales@nutec.com](mailto:sales@nutec.com)

Spare Parts  
Email: [spares@nutec.com](mailto:spares@nutec.com)

Technical Support  
Email: [techsupport@nutec.com](mailto:techsupport@nutec.com)

## HEADQUARTERS & GLOBAL SALES

### HEADQUARTERS

Carr. Saltillo - Monterrey No. 100 (Km. 62.5)  
Santa Catarina, N.L. 66359, México.

Phone: +52 (81) 8151 0800  
US Phone: +1 (855) 299 9566

## SALES AND SERVICE OFFICES

### USA / CANADA

Mobile: +1 (514) 268 2545

### EUROPE

Phone: +44 (0) 7717 880888  
Email: [europe@nutec.com](mailto:europe@nutec.com)

*You can also leave us a message describing your project on our website and we will be happy to contact with you!*

[Request a Quote](#)



[www.nutecbickley.com](http://www.nutecbickley.com)