

WIND-BARS *

ALL INTERMEDIATE SHEETS REINFORCED WITH 3/4" X 3/4" STEEL SQUARE TUBING FASTENED TO CURTAIN WITH 3/16" STEEL RIVETS.

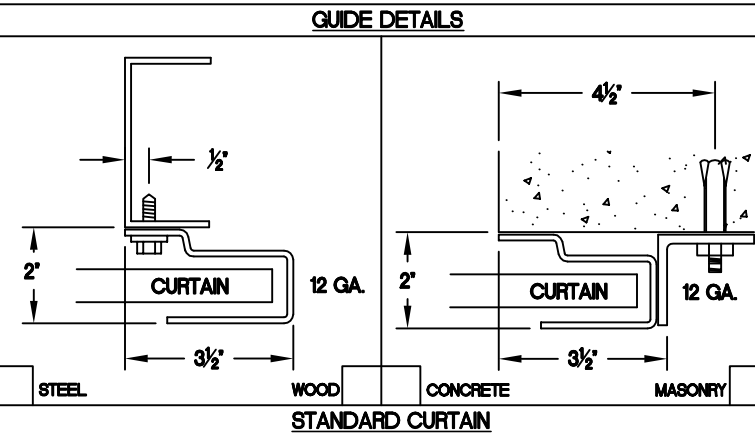

GENERAL NOTES:

CURTAIN:

- 26 GAUGE GALVANIZED STEEL WITH BAKED ON EPOXY PRIMER AND POLYESTER TOP COAT

GUIDES:

- ROLL FORMED 12 GAUGE GALVANIZED STEEL

OPERATION:

- RIGHT HAND SHOWN, LEFT HAND OPPOSITE

OTHER SURFACES:

- GALVANIZED OR SHOP COAT PRIMER

WIND-BAR:

- 3/4" x 3/4" STEEL SQUARE TUBING RIVETED TO CENTER OF ALL INTERMEDIATE PANELS.

SIDE ROOM REQUIREMENTS		SEE 'ELEVATION'	
<input checked="" type="checkbox"/>	CHOOSE TYPE OF OPERATION BELOW	A-1	A-2
<input type="checkbox"/>	HAND-ROPE PULL	7'	7'
<input type="checkbox"/>	REDUCTION GEAR CHAIN HOIST	10'	7'
<input checked="" type="checkbox"/>	ELECTRIC MOTOR OPERATOR KIT	10'	7'

MFK.	QTY.	OPENING SIZE		OPERATION	R.H.	CLEARANCES	
		WIDTH "W"	HEIGHT "H"			L.H.	"X"

PROJECT: _____

ARCHITECT: _____

CONTRACTOR: _____

DISTRIBUTOR: _____

DATE: _____ SHEET: _____ OF: _____ BY: _____ REF.# _____

MODEL 205 WIND-BAR COMMERCIAL SHEET DOOR w/ MOTOR



4255 McEver Industrial Dr.
Acworth, GA 30101
PH:(770) 924-2800
Fax:(770) 974-1455
www.astadoor.com

Asta Door Corporation is not responsible for the use of improper installation procedures, structural supports as well as field inspection prior to manufacturing and installation.

APPROVAL SIGNATURE: _____ DATE: _____