

APX



 BERETTA

INTRODUCING THE NEW APX

THE ULTIMATE STRIKER PISTOL FROM BERETTA.

The new Beretta APX semiautomatic pistol, utilizing a removable, serialized chassis frame, can be easily modified with replaceable grip frame housings and is simple to disassemble and maintain. Ease of use was the key driver in the development of the APX.

The APX's extremely low profile, snag free, design makes it easy to carry and draw from the holster. To accommodate right or left-handed use, the APX's magazine release button can be easily reversed. The light, durable grip frame housing employs modern thermoplastic technology through the use of fiberglass reinforced technopolymer.



TOP SAFETY

Striker Deactivation Button

Beretta APX pistols have a unique feature that allows the user to deactivate the internal striker mechanism prior to disassembly. This means the pistol can be field stripped **WITHOUT PULLING THE TRIGGER**.

Trigger Safety

The trigger safety stops the trigger from traveling rearward through inertia in case the pistol is dropped. When the trigger is intentionally pulled, the trigger safety is instantly deactivated.

Slide catch

The slide catch is a lever that holds the slide open after the last round is fired. This allows the user to immediately determine that the pistol does not have a round in the chamber or in the magazine. The slide catch of the APX is internal, ambidextrous and completely snag free.

Automatic striker block safety

Beretta APX pistols have a striker blocking device that prevents forward movement of the striker unless the trigger is completely pulled.



MODULARITY

Easy and quick disassembly
thanks to the latch conveniently
positioned on the side of the pistol.



**Slide catch lever located on both
sides of the frame, ambidextrous.**

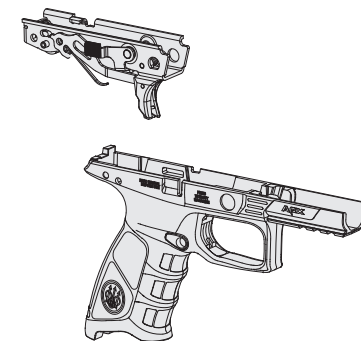

**Interchangeable grip frame
housing and
serialized chassis
frame**

The internal chassis
frame of this pistol is
serialized. This allows
grip frame housings
to be exchanged or
customized without
affecting the
serialized part.



**Large magazine release
button** for immediate
magazine change. Reversible.

Interchangeable backstraps
are included in three different sizes.
Allows shooter personalization.



ERGONOMIC

THE MOMENT YOU HANDLE IT YOU WILL UNDERSTAND WHY IT IS THE BEST

Technopolymer frame

The rounded, snag free surfaces of the pistol ensure trouble-free insertion and holster extraction. The squared-off trigger guard offers a support surface and accessory mounting interface. The grip features grooved finger rests to guarantee a secure and firm hold. Every control is flush with the polymer frame but always easy to reach and operate.

The pistol comes with a standard Picatinny rail (MIL-STD-1913) under the barrel for convenient mounting of a laser device, flashlight or other type of accessory.

Ergonomic and modular backstrap

The ergonomic grip frame features an optimal angle for instinctive aiming. The rear upper part of the grip is curved and recessed to snugly fit and protect the shooter's hand. Both the front and the rear of the grip feature a comfortable checkered surface to provide a solid grip.

Thanks to the new modular system, the pistol adapts to different hand sizes with interchangeable back-straps of different thicknesses and configurations for individualized performance.

Magazine

The Beretta APX pistol has an easily removable double stack magazine that allows for rapid reloading of the pistol. The 9mm x 19 Parabellum (or Luger) magazine capacity is 17 rounds; Optional 21 round extended magazines available.

Very low barrel axis for reduced muzzle rise.

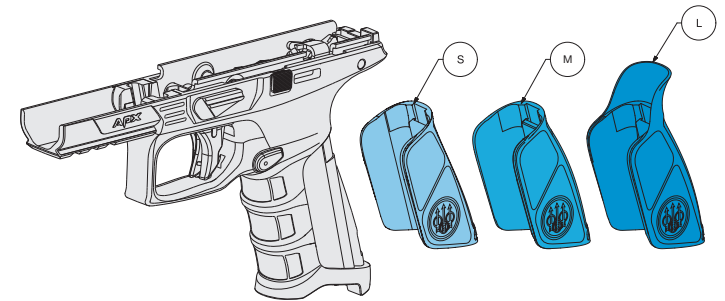

Trigger. Ergonomic, flat-faced design that features straight rearward trigger press. 6 lb. trigger weight with clean break and 3mm tactile reset.



Flush but easy to operate controls.

ERGONOMIC / SIGHTS

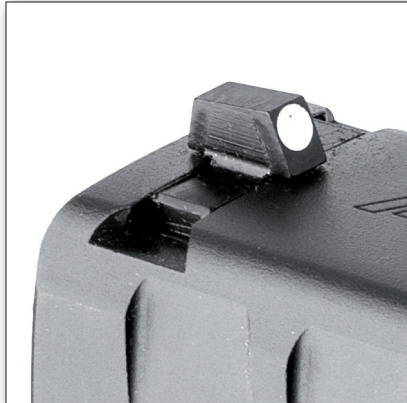

Three-dot sight system.

The high definition 3-dot sight system is designed for quick target acquisition. Squared rear sight profile for emergency and unconventional slide cocking. The sights can be removed for replacement with other types of sights. Tritium night sight configurations available.

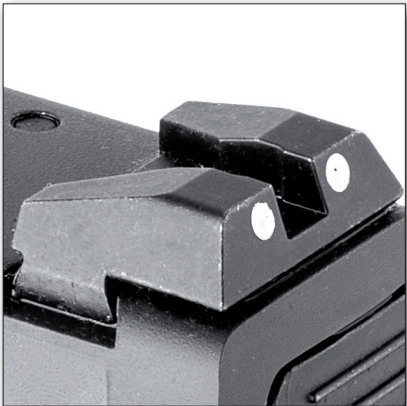

Large magazine bottom for quick and easy manual extraction.



Newly designed slide.

The sides of the slide offer snag-proof insertion and extraction of the pistol from its holster. The front and rear serrations on the distinctive slide facilitate slide operation and safety control in wet conditions.



Fully flat trigger guard provides a support surface and accessory mounting interface under the barrel.

PARTS / DATA

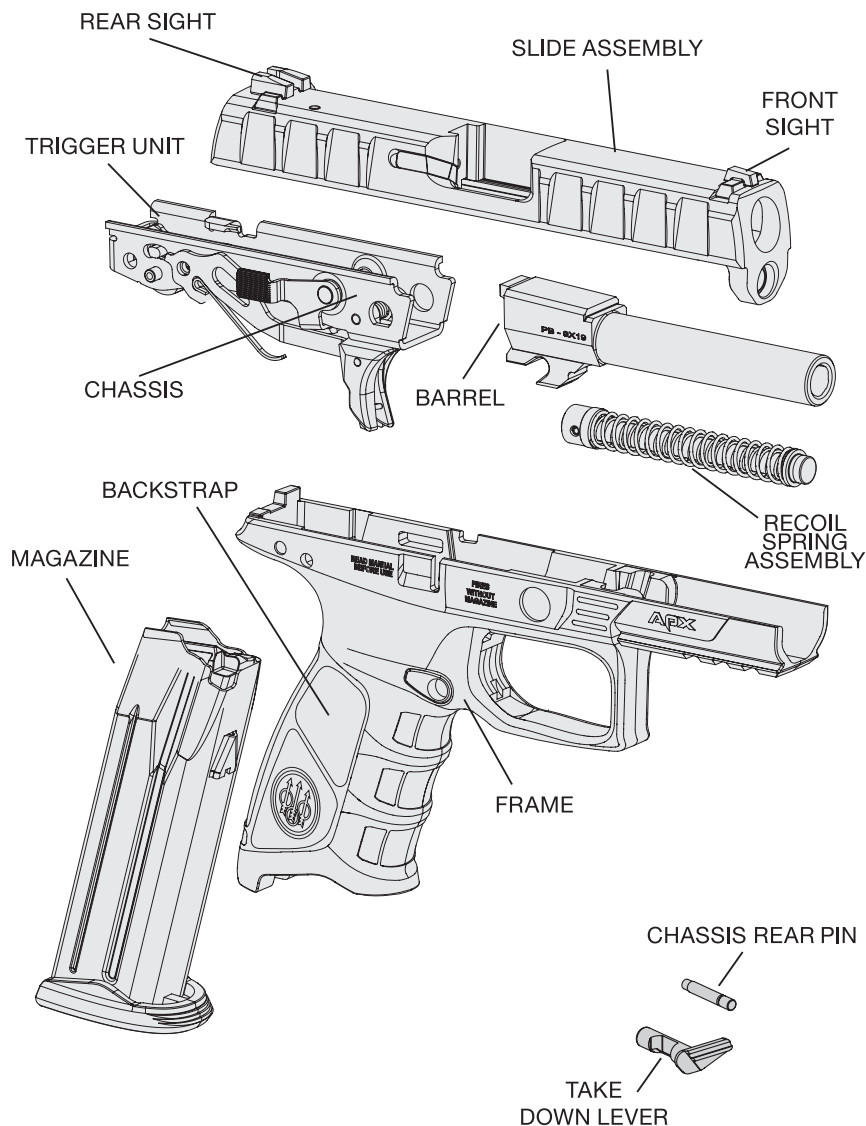

Model	APX
Caliber	9x19 (Parabellum or Luger), .40 S&W
Magazine *	10-15-17 rounds for the 9x19, 15 rounds for the .40 S&W
Rifling Pitch	10in / 250mm for the 9x19, 15.7in / 400mm for the .40 S&W
Rifling	R.H. - 6 grooves
General Operation	Semiautomatic, short recoil system
Locking System	Tilt-barrel, locked breech
Sights	Removable front and rear sights
Chassis frame	Stainless steel
Grip frame housing	Fiberglass reinforced technopolymer
Slide	Steel with black Nitride finishing
Barrel	Steel with black Nitride finishing
Action	Striker fired
Safeties	Striker deactivation button, firing pin block, safety, trigger safety, out of the battery disconnection.

* The magazine's capacity depends on the national regulations of the Country.

DATA

Overall length	7.56 in/ 192 mm
Barrel length	4.25 in/ 108 mm
Overall width	1.30 in/ 33 mm
Grip width	1.30 in/ 33 mm
Overall height	5.60 in/ 142 mm
Sight radius	6.30 in/ 160 mm
Approximate weight unloaded	28,21 oz/ 800 grams for the 9x19 28,92 oz/ 820 grams for the .40 S&W with empty magazine



Left side



Right side

ACCESSORIES

Colored Interchangeable frames

Available in: brown, green and grey. They are easy to replace.

Thanks to the separate internal serialized chassis, the frames are not to be considered gun's main components they are on sale without any legal restriction.



flat dark earth



wolf grey



olive drab

Adjustable sights

Removable standard dot sights can be replaced with other configurations: fiber optic red sights, white dot sights. Adjustable back sight. Available in after market.



Micrometric black back sight and fiber optic red front sight



3 white dot micrometric sights



Micrometric fiber optic sights



Optional magazine pouch



Optional holsters

FULL RANGE OF ACCESSORIES (available upon request)

- Aiming devices
- Flashlights
- Tactical holsters
- Magazine pouches
- Colored interchangeable frames
- Adjustable sights

FIELD STRIPPING



Slide



Barrel



Recoil spring and guide



Magazine
(.40 S&W)



Frame / Grip
(with chassis)



STORAGE CASE

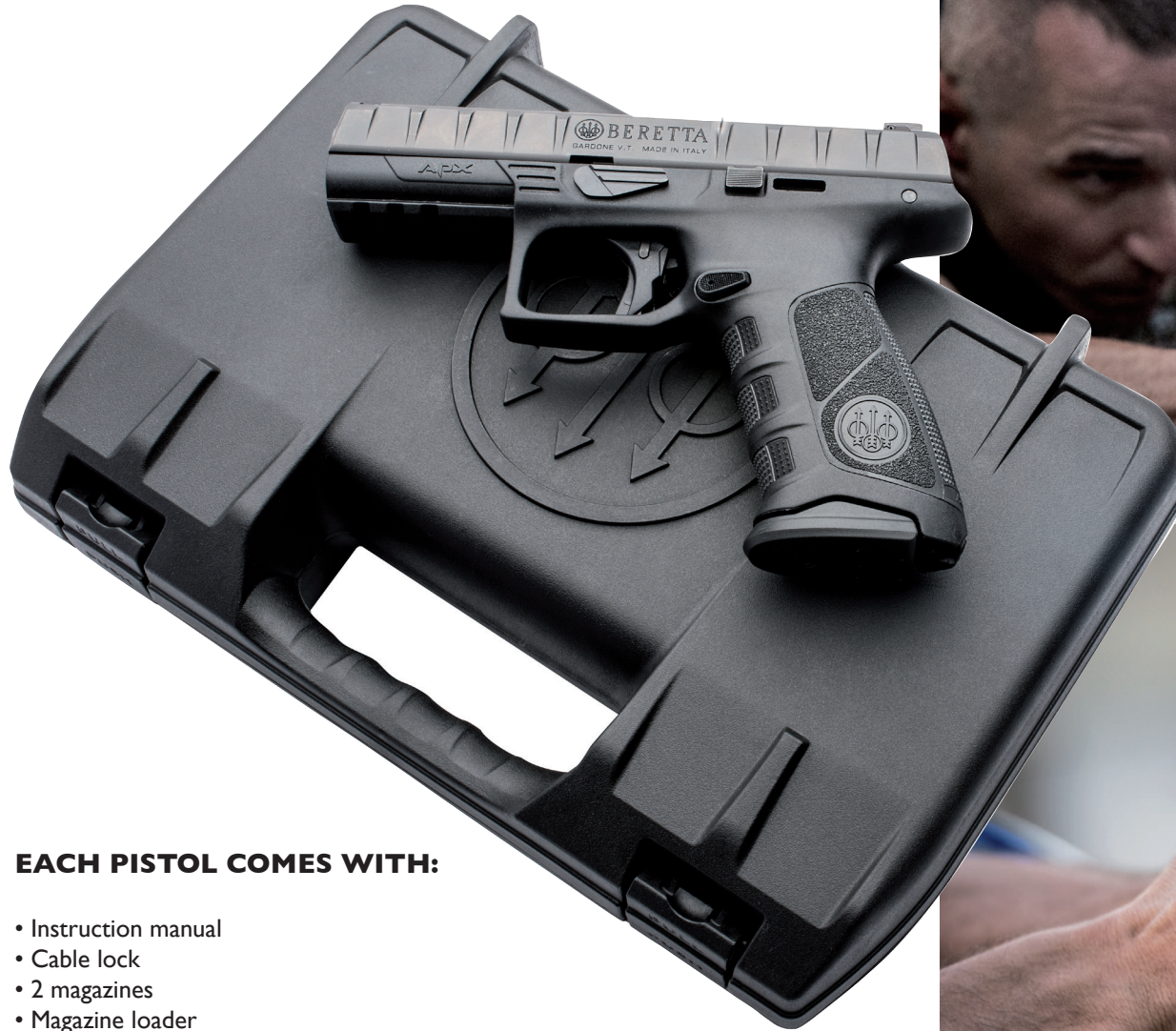

EACH PISTOL COMES WITH:

- Instruction manual
- Cable lock
- 2 magazines
- Magazine loader
- 3 backstraps
- Cleaning kit
- Storage case



PRODUCT SPECIFICATIONS



The addition of the APX completes the full size pistol portfolio and makes Beretta one of the few manufacturers to offer full size polymer and metallic framed handguns in both hammer and striker fired operating systems.

Designed specifically for military and law enforcement operators, the APX has been put through extensive testing and evaluation at the professional end user level. The result is a pistol platform that delivers superior performance in durability, reliability, accuracy and ergonomics.



1. Sight system. The high definition 3-dot sight system is designed for quick target acquisition. Squared rear sight profile for emergency and unconventional slide cocking. The sights can be removed for replacement with other types of sights. Tritium night sight configurations available.

2. Slide. The sides of the slide offer snag-proof insertion and extraction of the pistol from its holster. The distinctive front and rear serrations on the slide facilitates its operation and safety control in wet conditions.

3. Automatic striker block safety. Beretta APX pistols have a striker blocking device that prevents forward movement of the striker unless the trigger is completely pulled.

4. Slide catch. The slide catch is a lever that holds the slide open after the last round is fired. This allows the user to

immediately determine that the pistol does not have a round in the chamber or in the magazine. The slide catch of the APX is internal, ambidextrous and completely snag free.

5. Interchangeable back straps. Included in three different sizes. Allows shooter personalization.

6. Magazine bottom and well. Aggressive magazine well bevel facilitates faster tactical reloads. Large magazine bottom for quick and easy manual extraction.

7. Reversible magazine button. The magazine button is reversible for right- or left-handed shooters. Large size for immediate magazine change.

8. MIL-SPEC-1913 (Picatinny) rail. The integrated rail allows rapid attachment of tactical lights and laser aiming devices.

9. Interchangeable grip frame housing and serialized chassis frame. The internal chassis frame of this pistol is serialized. This allows grip frame housings to be exchanged or customized without affecting the serialized part.

10. Striker deactivation button. Beretta APX pistols have a unique feature that allows the user to deactivate the internal striker mechanism prior to disassembly. This means the pistol can be field stripped WITHOUT PULLING THE TRIGGER.

11. Trigger/Safety. Ergonomic, flat-faced design that features straight rearward trigger press. 6 lb. trigger weight with clean break and 3mm tactile reset. The trigger safety stops the trigger from travelling rearward through inertia in case the pistol is dropped. When the trigger is intentionally pulled, the trigger safety is instantly deactivated.

APX



FABBRICA D'ARMI P.BERETTA S.p.A
Via P. Beretta, 18 - CP 160
Tel +39 030 83411
25063 Gardone Val Trompia, Brescia ITALY

BERETTA.COM