

LOCKER SHOWN WITHOUT OPTIONAL 4" HIGH TOE KICK BASE

OPEN FRONT LOCKER, 30"W x 24"D x 72"H (NOT INCLUDING OPTIONAL BASE)

* 3/4" MAPLE VENEER PLYWOOD WITH 3MM WOOD EDGE BAND; COLOR MATCHED PVC EDGE BAND ON CURVED SIDE EDGES; SOLID HARDWOOD TRIM; GLUE AND DOWEL CONSTRUCTION

* INCLUDES BUILT IN COMBINATION LOCK ON UPPER CUBBY, FOOT LOCKER LIFT LID WITH HASP LOCK, 3 DOUBLE HOOKS, VERTICAL VENT SLOTS ON LOWER FOOT LOCKER FACE (BLACK COLOR)
ALL HARDWARE IS SILVER COLOR

DIMENSIONS ARE IN INCHES TOLERANCES: FRACTIONAL $\pm 1/16"$ ANGULAR: MACH ± 1 BEND ± 1 ONE PLACE DECIMAL $\pm .1$ TWO PLACE DECIMAL $\pm .05$ THREE PLACE DECIMAL $\pm .005$ DO NOT SCALE DRAWING	PROPRIETARY AND CONFIDENTIAL THE INFORMATION CONTAINED IN THIS DRAWING IS THE SOLE PROPERTY OF PIVOTAL HEALTH. ANY REPRODUCTION IN PART OR AS A WHOLE WITHOUT THE WRITTEN PERMISSION OF PIVOTAL HEALTH SOLUTIONS IS PROHIBITED.	Pivotal Health Solutions 3003 9th Ave SW, Watertown, SD 57201 pivotalhealthsolutions.com ph. 605-753-0110 fax. 605-882-8398
		Rev: 01
MATERIAL SEE BOM		FINISH See PO for Color
DESC. STANDARD LOCKER		
PART NUMBER - NAME LOCKER ASSY, 30X24X72 REC1		
SIZE: A	SCALE: 1:16	SAVE: 3/17/2020
WEIGHT: 117.882lbs		ENGR. MG
		SHEET 1 OF 3

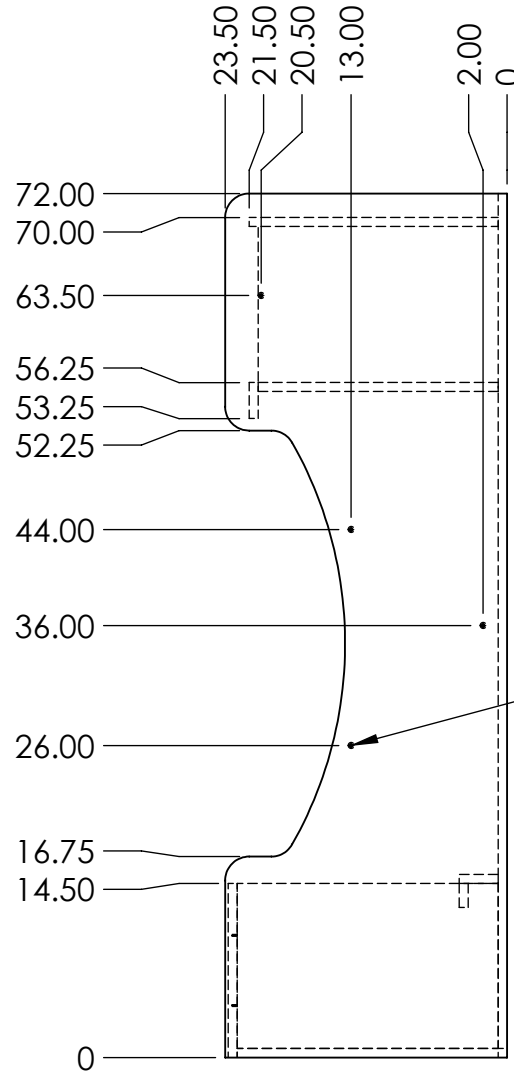
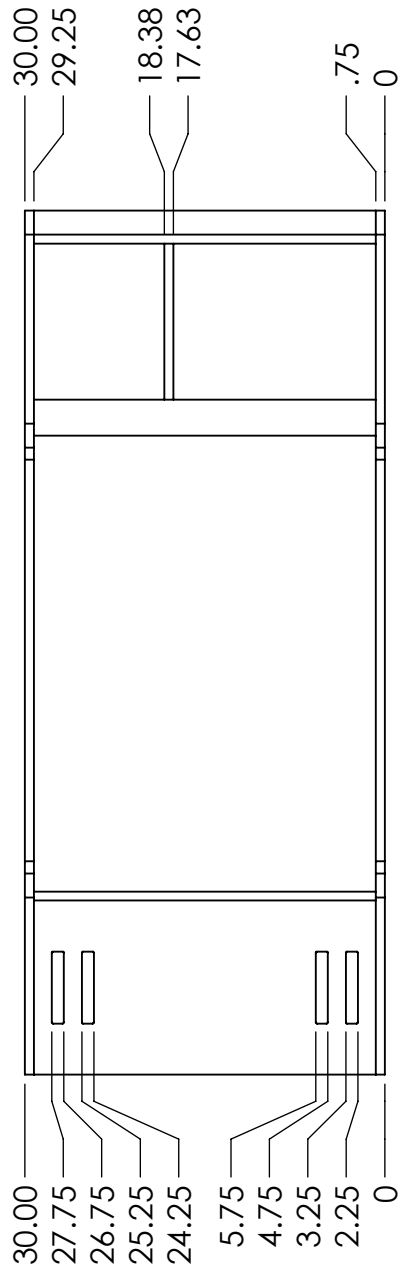

4X Ø .26 THRU
 □ Ø .50 ▽ .19

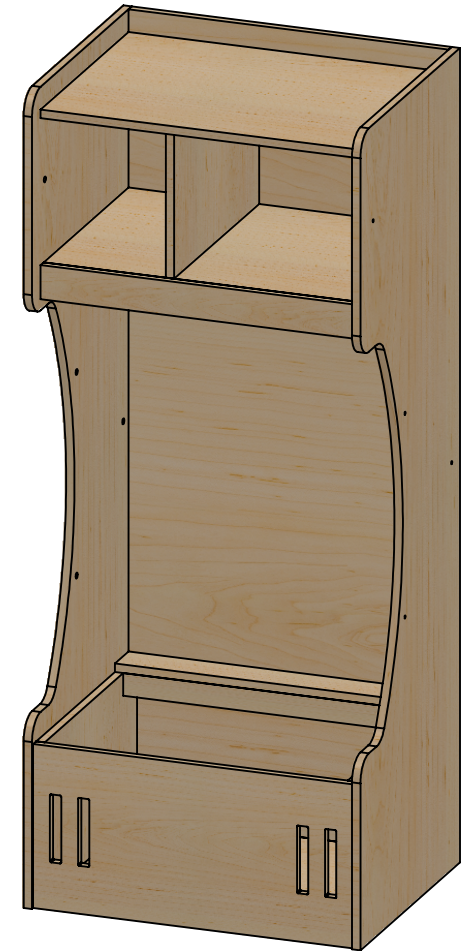

LOCKER SHOWN WITHOUT OPTIONAL 4" HIGH TOE KICK BASE

EACH LOCKER WILL INCLUDE HARDWARE FOR SIDE TO SIDE CONNECTION TO ADJACENT LOCKERS, SILVER COLOR

DIMENSIONS ARE IN INCHES TOLERANCES: FRACTIONAL: ± 1/16" ANGULAR: MACH ± 1 BEND ± 1 ONE PLACE DECIMAL ±.1 TWO PLACE DECIMAL ±.05 THREE PLACE DECIMAL ±.005 DO NOT SCALE DRAWING	PROPRIETARY AND CONFIDENTIAL THE INFORMATION CONTAINED IN THIS DRAWING IS THE SOLE PROPERTY OF PIVOTAL HEALTH. ANY REPRODUCTION IN PART OR AS A WHOLE WITHOUT THE WRITTEN PERMISSION OF PIVOTAL HEALTH SOLUTIONS IS PROHIBITED.	Pivotal Health Solutions 3003 9th Ave SW, Watertown, SD 57201 pivotalhealthsolutions.com ph. 605-753-0110 fax. 605-882-8398
		Rev: 01
		MATERIAL
		SEE BOM
		DESC.
STANDARD LOCKER		
PART NUMBER - NAME		
LOCKER ASSY, 30X24X72 REC1		
SIZE: A	SCALE: 1:16	SAVE: 3/17/2020
WEIGHT: 117.882lbs	ENGR. MG	SHEET 2 OF 3

REVISIONS								
ECO	Rev.	Engineer	Date	Approval	Date	ALE/AAL	Date	Changes
	01	MG	3/17/2020					NEW DOCUMENT

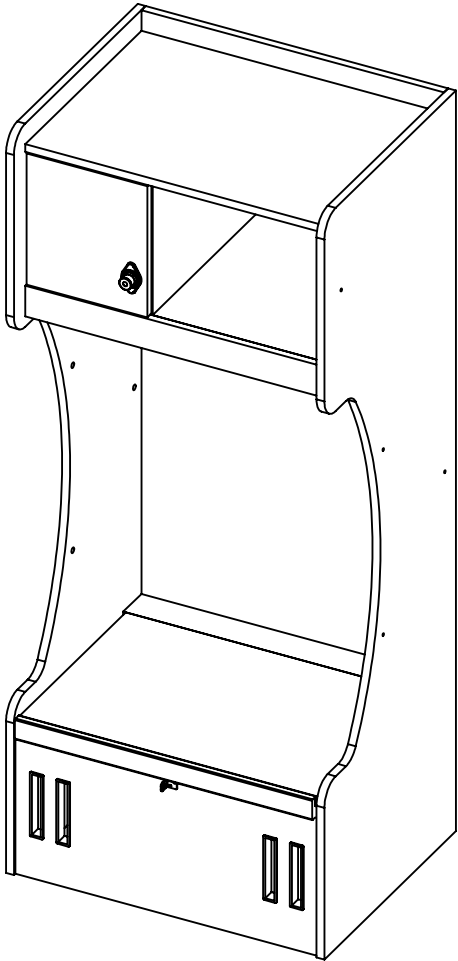

01

DIMENSIONS ARE IN INCHES TOLERANCES: FRACTIONAL: $\pm 1/16"$ ANGULAR: MACH ± 1 BEND ± 1 ONE PLACE DECIMAL $\pm .1$ TWO PLACE DECIMAL $\pm .05$ THREE PLACE DECIMAL $\pm .005$ DO NOT SCALE DRAWING		PROPRIETARY AND CONFIDENTIAL THE INFORMATION CONTAINED IN THIS DRAWING IS THE SOLE PROPERTY OF PIVOTAL HEALTH. ANY REPRODUCTION IN PART OR AS A WHOLE WITHOUT THE WRITTEN PERMISSION OF PIVOTAL HEALTH SOLUTIONS IS PROHIBITED.	Pivotal Health Solutions 3003 9th Ave SW, Watertown, SD 57201 pivotalhealthsolutions.com ph. 605-753-0110 fax. 605-882-8398
MATERIAL SEE BOM		Rev: 01	
DESC. STANDARD LOCKER		FINISH See PO for Color	
PART NUMBER - NAME LOCKER ASSY, 30X24X72 REC1			
SIZE: A	SCALE: 1:16	SAVE: 3/17/2020	WEIGHT: 117.882lbs
ENGR. MG		SHEET 3 OF 3	