

OPTIONAL  
6"Hx6"W CUSTOM  
DECAL AREA

OPTIONAL  
12"Hx12"W CUSTOM  
DECAL AREA

OPTIONAL  
6"Hx6"W CUSTOM  
DECAL AREA

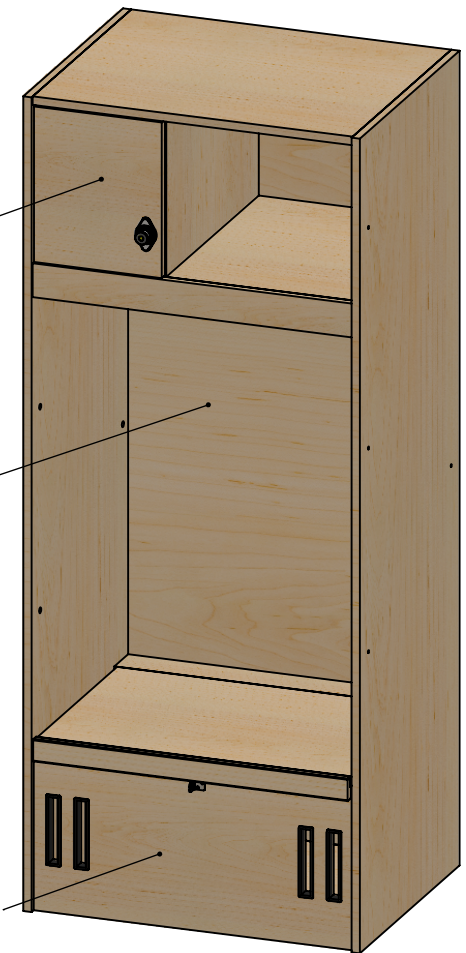

LOCKER SHOWN WITHOUT OPTIONAL 4" HIGH TOE KICK BASE

OPEN FRONT LOCKER, 30"W x 24"D x 72"H (NOT INCLUDING OPTIONAL BASE)  
\* 3/4" MAPLE VENEER PLYWOOD WITH 3MM WOOD EDGE BAND; SOLID  
HARDWOOD TRIM; GLUE AND DOWEL CONSTRUCTION  
\* INCLUDES BUILT IN COMBINATION LOCK ON UPPER CUBBY, FOOT LOCKER  
LIFT LID WITH HASP LOCK, 3 DOUBLE HOOKS, VERTICAL VENT SLOTS ON  
LOWER FOOT LOCKER FACE (BLACK COLOR)  
ALL HARDWARE IS SILVER COLOR

DIMENSIONS ARE IN INCHES  
TOLERANCES:  
FRACTIONAL  $\pm 1/16"$   
ANGULAR: MACH  $\pm 1$  BEND  $\pm 1$   
ONE PLACE DECIMAL  $\pm .1$   
TWO PLACE DECIMAL  $\pm .05$   
THREE PLACE DECIMAL  $\pm .005$   
DO NOT SCALE DRAWING

**PROPRIETARY AND CONFIDENTIAL**  
THE INFORMATION CONTAINED  
IN THIS DRAWING IS THE SOLE  
PROPERTY OF PIVOTAL HEALTH.  
ANY REPRODUCTION IN PART OR  
AS A WHOLE WITHOUT THE WRITTEN  
PERMISSION OF PIVOTAL HEALTH  
SOLUTIONS IS PROHIBITED.

**Pivotal Health Solutions**  
3003 9th Ave SW,  
Watertown, SD 57201  
pivotalhealthsolutions.com  
ph. 605-753-0110  
fax. 605-882-8398

**Rev: 01**

MATERIAL  
SEE BOM

DESC.

STANDARD LOCKER

PART NUMBER - NAME

**LOCKER ASSY, 30X24X72 STR1**

SIZE: A

SCALE: 1:16

DATE: 3/20/2020

WEIGHT: 127.725lbs

ENGR. MG

SHEET 1 OF 3

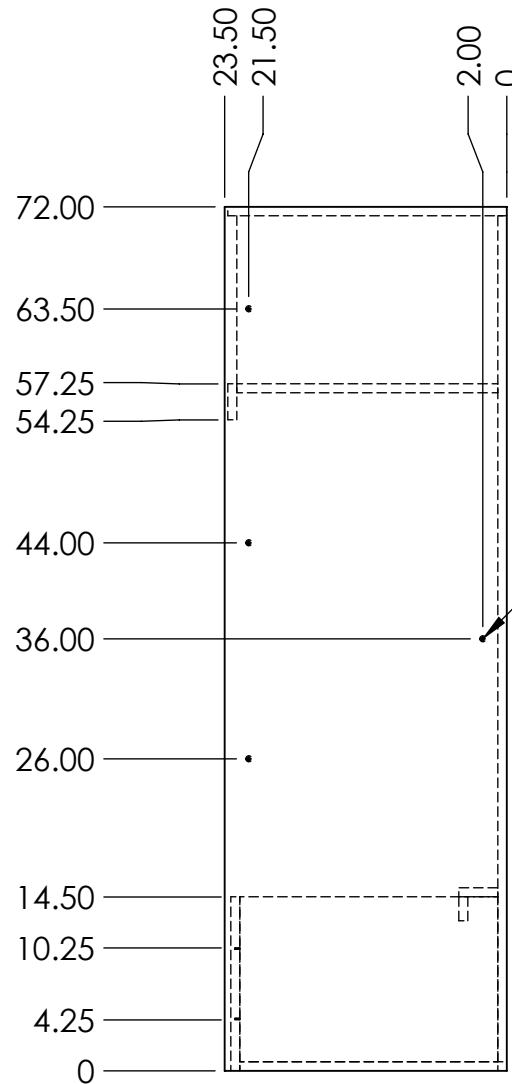
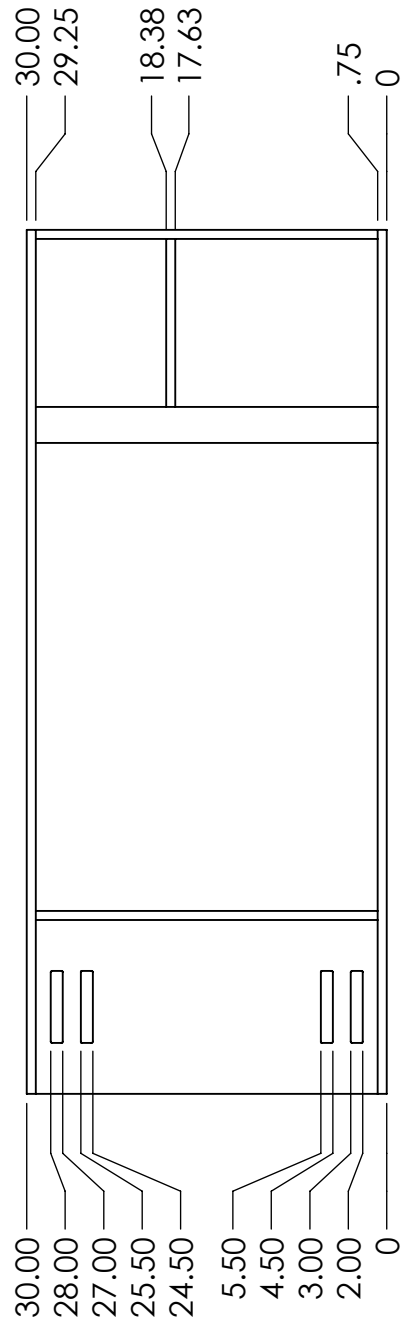

4X Ø .26 THRU  
 □ Ø .50 ↓ .19



LOCKER SHOWN WITHOUT OPTIONAL 4" HIGH TOE KICK BASE

EACH LOCKER WILL INCLUDE HARDWARE FOR SIDE TO SIDE CONNECTION TO ADJACENT LOCKERS, SILVER COLOR

DIMENSIONS ARE IN INCHES TOLERANCES: FRACTIONAL $\pm 1/16"$ ANGULAR: MACH $\pm 1$ BEND $\pm 1$ ONE PLACE DECIMAL $\pm .1$ TWO PLACE DECIMAL $\pm .05$ THREE PLACE DECIMAL $\pm .005$ DO NOT SCALE DRAWING			PROPRIETARY AND CONFIDENTIAL THE INFORMATION CONTAINED IN THIS DRAWING IS THE SOLE PROPERTY OF PIVOTAL HEALTH. ANY REPRODUCTION IN PART OR AS A WHOLE WITHOUT THE WRITTEN PERMISSION OF PIVOTAL HEALTH SOLUTIONS IS PROHIBITED.			Pivotal Health Solutions 3003 9th Ave SW, Watertown, SD 57201 pivotalhealthsolutions.com ph. 605-753-0110 fax. 605-882-8398					
MATERIAL SEE BOM						FINISH See PO for Color					
DESC. STANDARD LOCKER											
PART NUMBER - NAME LOCKER ASSY, 30X24X72 STR1											
SIZE: A		SCALE: 1:16		SAVE: 3/20/2020		WEIGHT: 127.725lbs		ENGR. MG		SHEET 2 OF 3	

REVISIONS								
ECO	Rev.	Engineer	Date	Approval	Date	ALE/AAL	Date	Changes
	01	MG	3/20/2020		3/20/2020			NEW DOCUMENT

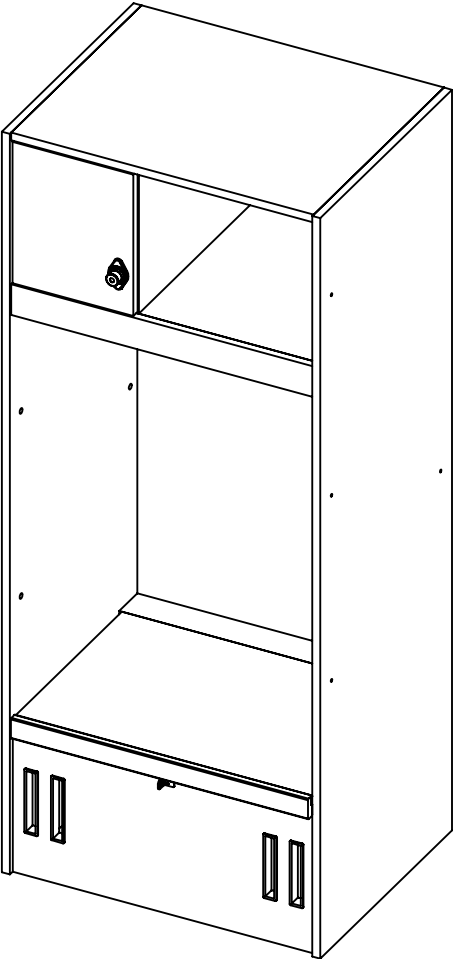

01

DIMENSIONS ARE IN INCHES TOLERANCES: FRACTIONAL: $\pm 1/16"$ ANGULAR: $MACH \pm 1$ BEND $\pm 1$ ONE PLACE DECIMAL $\pm .1$ TWO PLACE DECIMAL $\pm .05$ THREE PLACE DECIMAL $\pm .005$ DO NOT SCALE DRAWING		PROPRIETARY AND CONFIDENTIAL THE INFORMATION CONTAINED IN THIS DRAWING IS THE SOLE PROPERTY OF PIVOTAL HEALTH. ANY REPRODUCTION IN PART OR AS A WHOLE WITHOUT THE WRITTEN PERMISSION OF PIVOTAL HEALTH SOLUTIONS IS PROHIBITED.	Pivotal Health Solutions 3003 9th Ave SW, Watertown, SD 57201 pivotalhealthsolutions.com ph. 605-753-0110 fax. 605-882-8398	
MATERIAL SEE BOM			Rev: 01	
DESC. STANDARD LOCKER		FINISH See PO for Color		
PART NUMBER - NAME LOCKER ASSY, 30X24X72 STR1				
SIZE: A	SCALE: 1:16	SAVE: 3/20/2020	WEIGHT: 127.725lbs	ENGR. MG
			SHEET 3 OF 3	