

LOCKER SHOWN WITHOUT OPTIONAL 4" HIGH TOE KICK BASE

OPEN FRONT LOCKER, 30"W x 24"D x 72"H (NOT INCLUDING OPTIONAL BASE)

- * 3/4" MAPLE VENEER PLYWOOD WITH 3MM WOOD EDGE BAND;
- HARDWOOD TRIM; GLUE AND DOWEL CONSTRUCTION
- * INCLUDES BUILT IN COMBINATION LOCK ON UPPER CUBBY,
- 3 DOUBLE HOOKS, ALL HARDWARE IS SILVER COLOR

DIMENSIONS ARE IN INCHES TOLERANCES: FRACTIONAL $\pm 1/16"$ ANGULAR: MACH ± 1 BEND ± 1 ONE PLACE DECIMAL $\pm .1$ TWO PLACE DECIMAL $\pm .05$ THREE PLACE DECIMAL $\pm .005$ DO NOT SCALE DRAWING	PROPRIETARY AND CONFIDENTIAL THE INFORMATION CONTAINED IN THIS DRAWING IS THE SOLE PROPERTY OF PIVOTAL HEALTH. ANY REPRODUCTION IN PART OR AS A WHOLE WITHOUT THE WRITTEN PERMISSION OF PIVOTAL HEALTH SOLUTIONS IS PROHIBITED.	Pivotal Health Solutions 3003 9th Ave SW, Watertown, SD 57201 pivotalhealthsolutions.com ph. 605-753-0110 fax. 605-882-8398
		Rev: 01
MATERIAL SEE BOM		FINISH See PO for Color
DESC. STANDARD LOCKER		
PART NUMBER - NAME LOCKER ASSY, 30x24x72 STRO		
SIZE: A	SCALE: 1:16	SAVE: 3/18/2020
	WEIGHT: 122.993lbs	ENGR. MG
		SHEET 1 OF 3

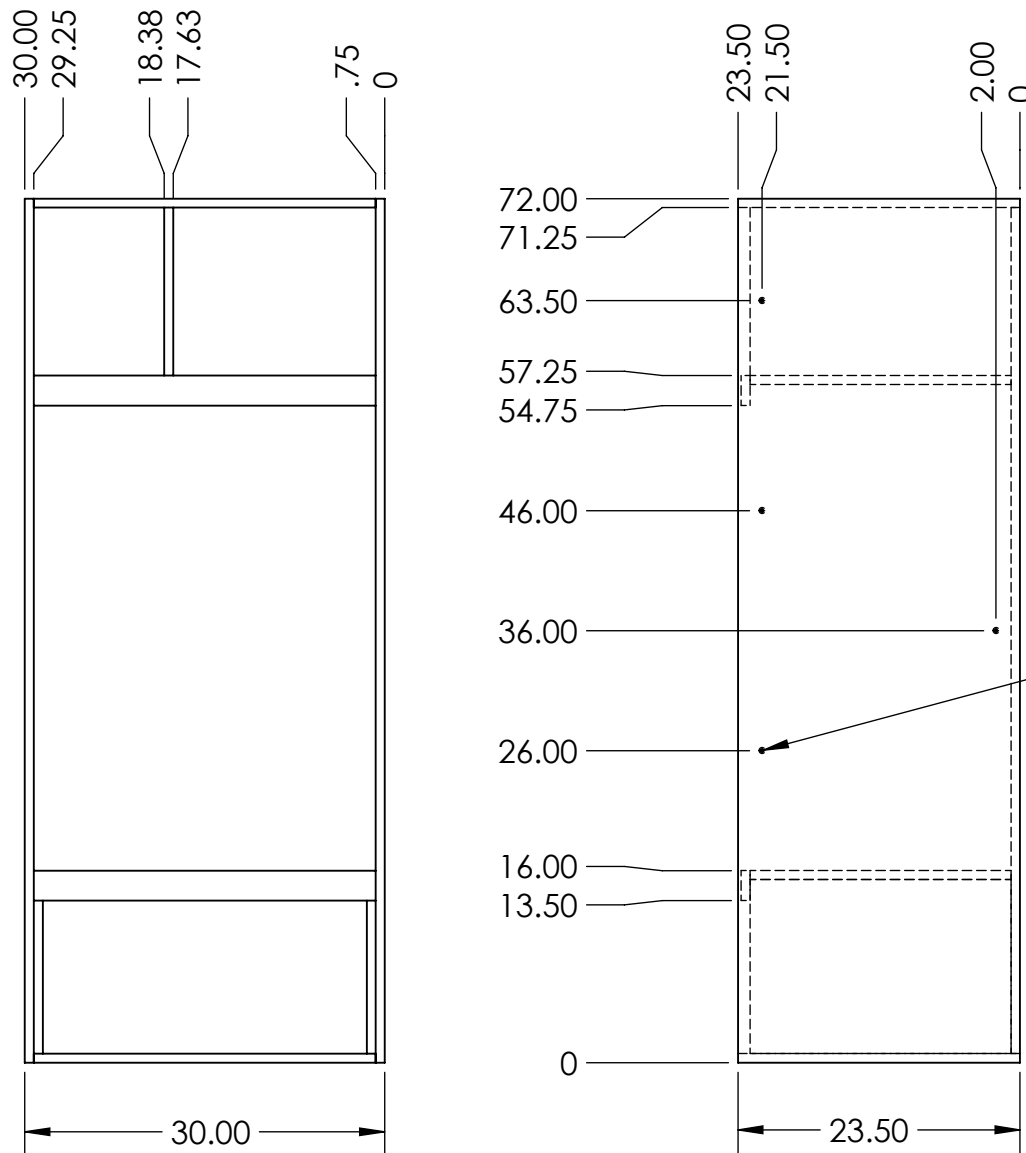

EACH LOCKER WILL INCLUDE HARDWARE FOR SIDE TO SIDE CONNECTION TO ADJACENT LOCKERS, SILVER COLOR

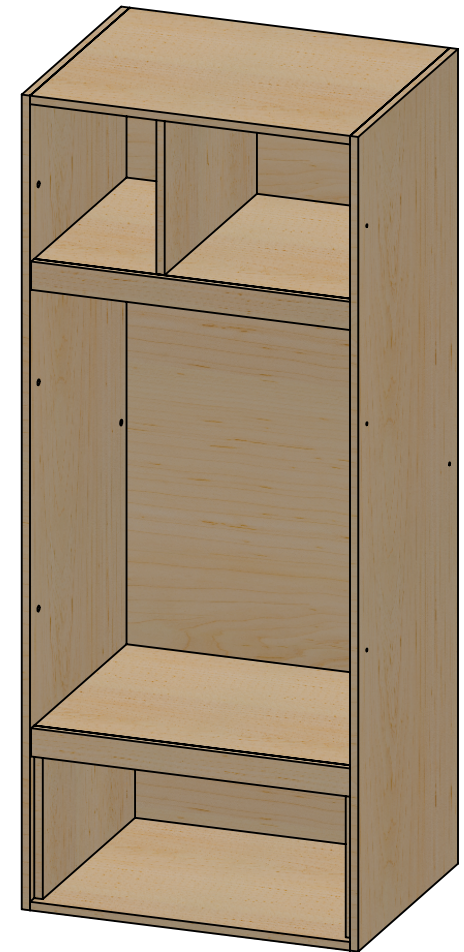

LOCKER SHOWN WITHOUT OPTIONAL 4" HIGH TOE KICK BASE

DIMENSIONS ARE IN INCHES TOLERANCES: FRACTIONAL ± 1/16" ANGULAR: MACH ± 1 BEND ± 1 ONE PLACE DECIMAL ±.1 TWO PLACE DECIMAL ±.05 THREE PLACE DECIMAL ±.005 DO NOT SCALE DRAWING		PROPRIETARY AND CONFIDENTIAL THE INFORMATION CONTAINED IN THIS DRAWING IS THE SOLE PROPERTY OF PIVOTAL HEALTH. ANY REPRODUCTION IN PART OR AS A WHOLE WITHOUT THE WRITTEN PERMISSION OF PIVOTAL HEALTH SOLUTIONS IS PROHIBITED.		Pivotal Health Solutions 3003 9th Ave SW, Watertown, SD 57201 pivotalhealthsolutions.com ph. 605-753-0110 fax. 605-882-8398	
				Rev: 01	
MATERIAL SEE BOM				FINISH See PO for Color	
DESC. STANDARD LOCKER					
PART NUMBER - NAME LOCKER ASSY, 30x24x72 STRO					
SIZE: A		SCALE: 1:16		DATE: 3/18/2020	
WEIGHT: 122.993lbs		ENGR. MG		SHEET 2 OF 3	

REVISIONS								
ECO	Rev.	Engineer	Date	Approval	Date	ALE/AAL	Date	Changes
	01	MG	3/16/2020					NEW DOCUMENT

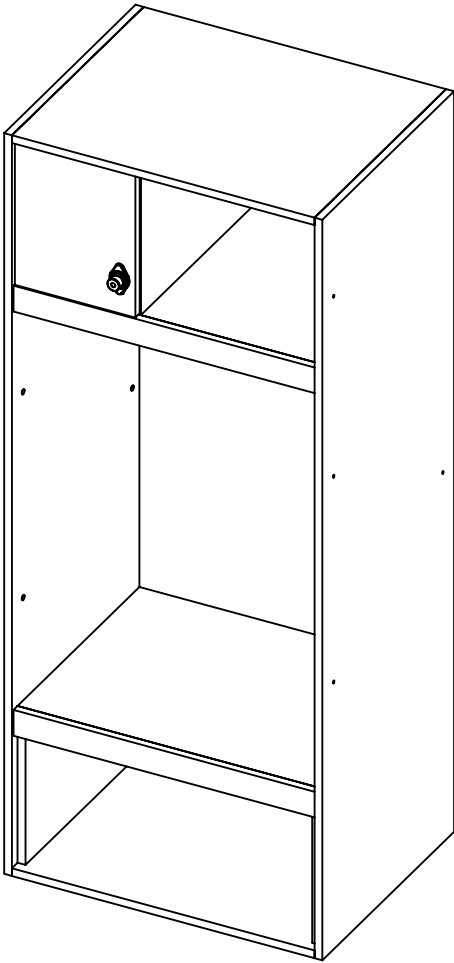

01

DIMENSIONS ARE IN INCHES TOLERANCES: FRACTIONAL $\pm 1/16"$ ANGULAR: MACH ± 1 BEND ± 1 ONE PLACE DECIMAL $\pm .1$ TWO PLACE DECIMAL $\pm .05$ THREE PLACE DECIMAL $\pm .005$ DO NOT SCALE DRAWING		PROPRIETARY AND CONFIDENTIAL THE INFORMATION CONTAINED IN THIS DRAWING IS THE SOLE PROPERTY OF PIVOTAL HEALTH. ANY REPRODUCTION IN PART OR AS A WHOLE WITHOUT THE WRITTEN PERMISSION OF PIVOTAL HEALTH SOLUTIONS IS PROHIBITED.	Pivotal Health Solutions 3003 9th Ave SW, Watertown, SD 57201 pivotalhealthsolutions.com ph. 605-753-0110 fax. 605-882-8398
MATERIAL SEE BOM		Rev: 01	
DESC. STANDARD LOCKER		FINISH See PO for Color	
PART NUMBER - NAME LOCKER ASSY, 30x24x72 STRO			
SIZE: A	SCALE: 1:16	SAVE: 3/18/2020	WEIGHT: 122.993lbs
		ENGR. MG	SHEET 3 OF 3