

# WAVEFORM ACCESS

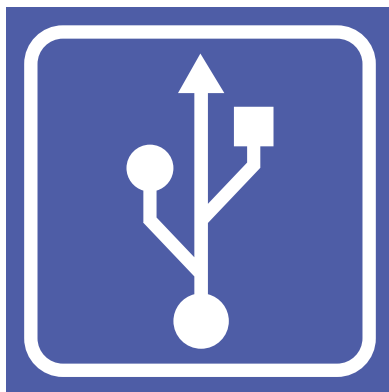

## PHASE ONE

### Patient Data Transfer Procedure

*A simple process designed to help your doctor access your infant's respiratory data.*

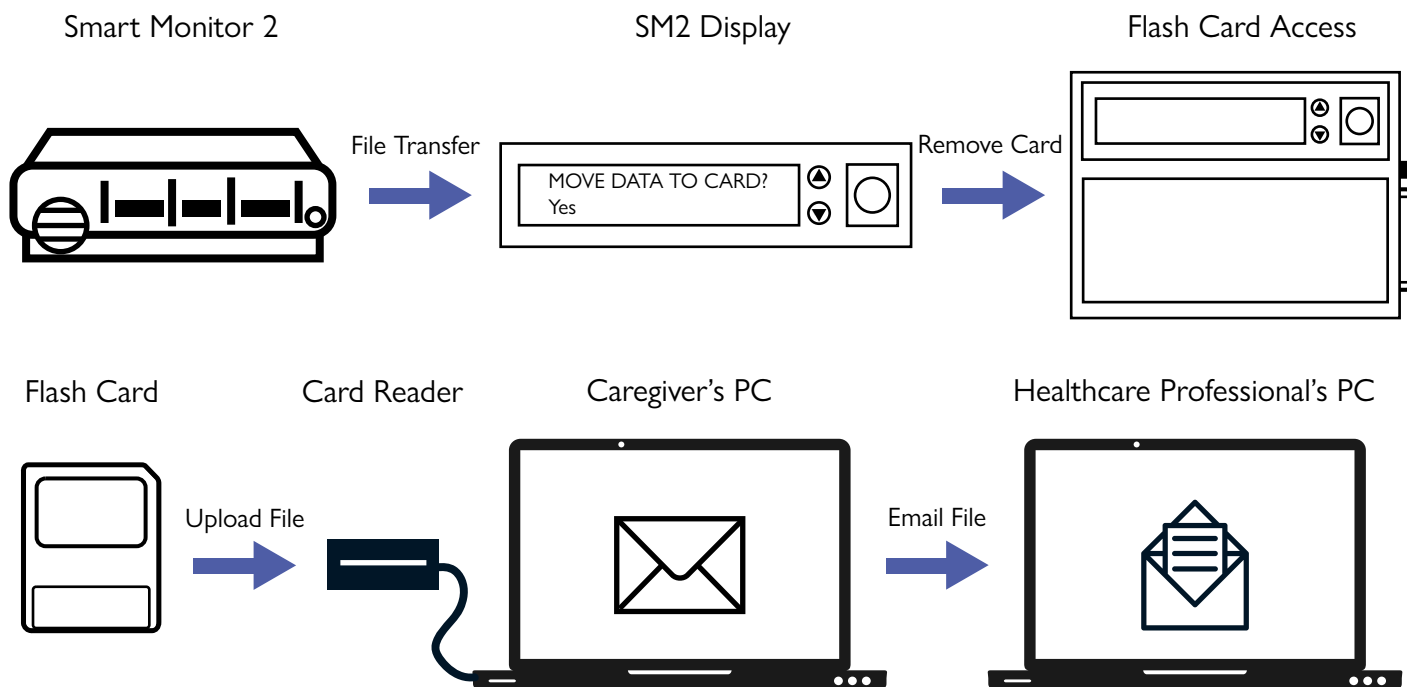



## INSTRUCTIONS FOR PATIENT DATA TRANSFER: COMPACT FLASH CARD AND CARD READER - SMARTMONITOR 2 (SM2)

### PRODUCT(S) COVERED

SmartMonitor 2 (SM2)

### PURPOSE/DESCRIPTION

This instruction details the process of transferring patient data from the Smart Monitor 2 unit to the DME utilizing a compact flash card and email.

### DEFINITIONS

LCD – Liquid Crystal Display

USB – Universal Serial Bus

### EQUIPMENT REQUIRED

#### A. Hardware/Tools Needed

1. SmartMonitor 2 Apnea Monitor w/Compact Flash (PC) Data card installed
2. Philips head screwdriver
3. Flash Card Reader

### PROCEDURE

#### **PLEASE READ THE ENTIRE PROCEDURE BEFORE ATTEMPTING.**

1. To successfully transfer data, please ensure the SmartMonitor 2 unit is powered off.
  - a. To turn monitor off, hold down the blue reset button and press the grey power button.
  - b. Release the grey button followed by the blue button.

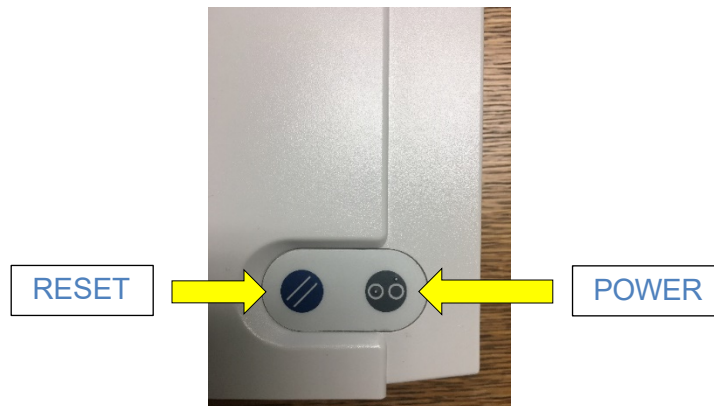

2. Turn over the SmartMonitor unit and use Philips screwdriver to remove LCD cover to expose keypad.
  - a. Please ensure that Compact Flash Card is installed into the SmartMonitor 2 unit.
    - i. To install Compact Flash Card, slide card into slotted provision in Smart Monitor 2 unit.

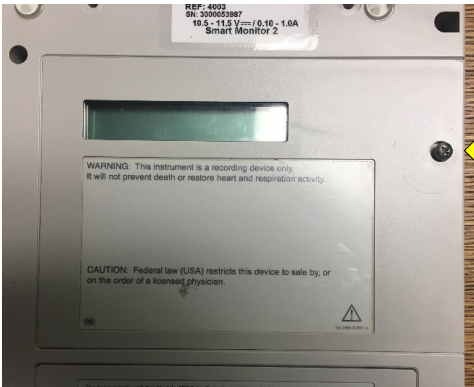

SCREW

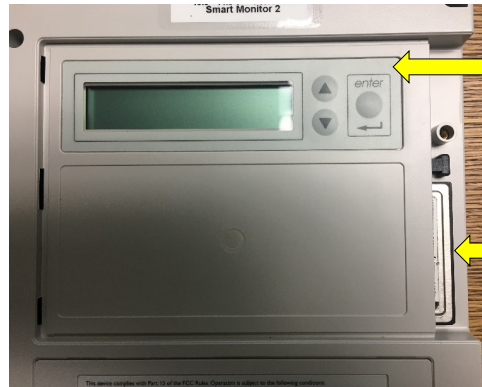

KEYPAD

COMPACT  
FLASH  
CARD

3. Press the grey power button to turn the SmartMonitor 2 unit on.

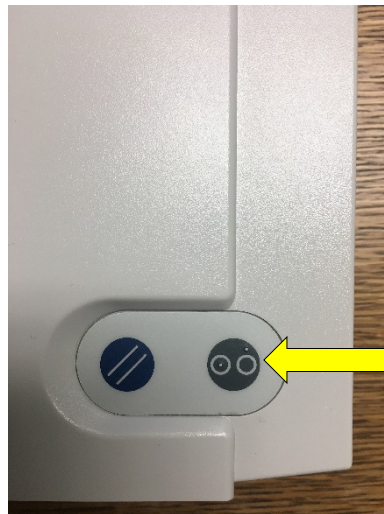

POWER



4. Turn the unit back over and view the LCD screen. The screen should initially display "Initializing Please Wait".



5. When the screen displays "Menu Mode? Enter Proper Key Sequence", press the **Enter** button once.
  - a. ***This process must be completed within 10 seconds of turning the SmartMonitor 2 on (Step #3).***
    - i. ***If the 10 second window is exceeded and a continuous alarm is audible, please proceed to Step #1 (How to turn off the monitor) and begin procedure again.***

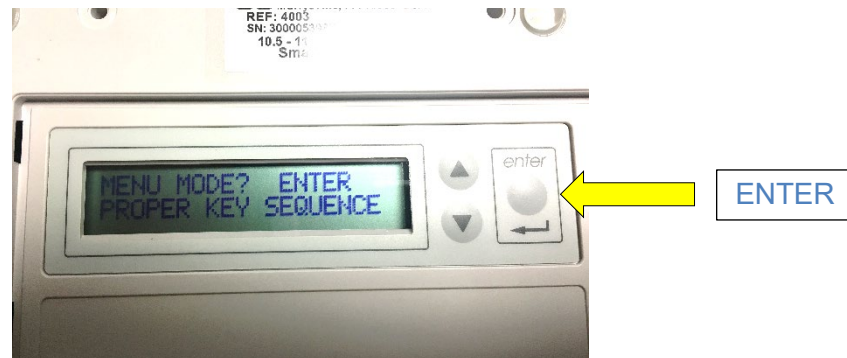

6. The display will then read “SmartMonitor 2 Menu Selection” along with an audible beep every 10 seconds.
  - a. *This feature verifies that the unit is now in the data download mode.*



7. Press the **down-arrow** button twice. The display will read “MOVE DATA TO CARD? No”.



8. Press the **Enter** button once. This will cause the word “No” displayed in screen to flash.

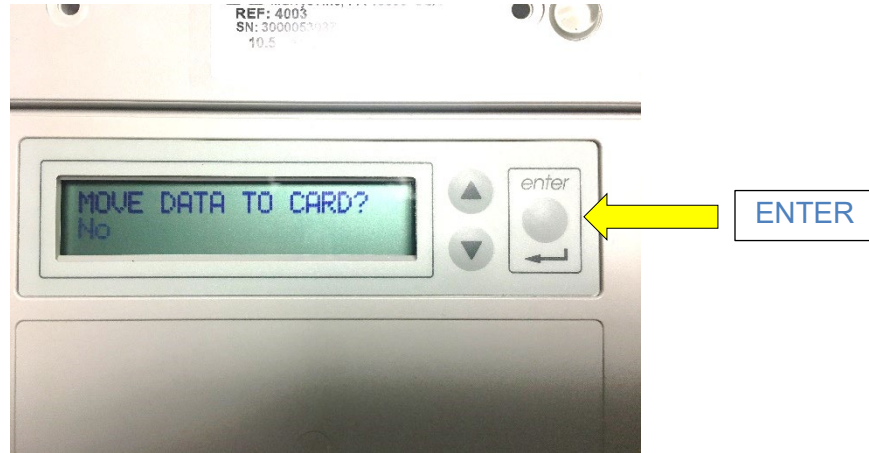

9. Press the **down-arrow** once. This will change the flashing “No” to a flashing “Yes”. Press **Enter** to make “Yes” your selection.
- You will receive one of 2 prompts (Messages).*
    - Move data to Card? – Proceed to Step 10.**
    - Card Full – Overwrite? – Proceed to Step 11.**

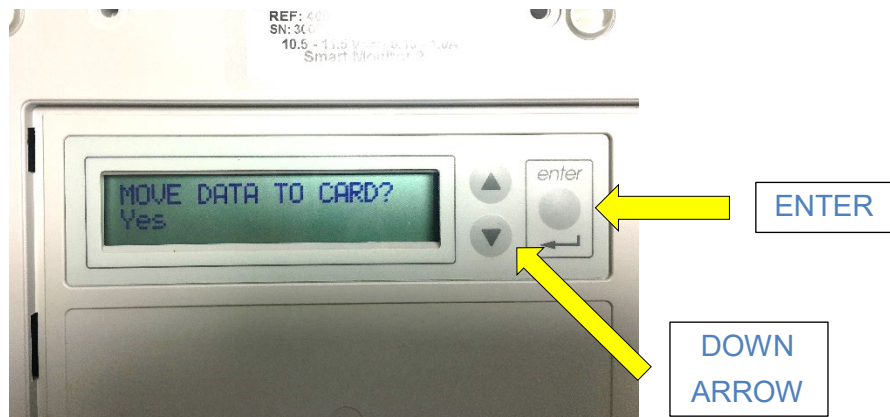



### Compact Flash Card: Empty

10. If the data card is empty, the display will read “MOVE DATA TO CARD? Transferring...” followed by “MOVE DATA TO CARD? Data Transferred”. (See Ref. 10-1 and 10-2)



(Ref. 10-1)



(Ref. 10-2)

### Compact Flash Card: Full

11. If the card is full, the display will read “CARD FULL – OVERWRITE?”
  - a. The card can still save the patient data by overwriting the old data.



12. To overwrite the data, press the **Enter** button once. This will cause the word “No” displayed in screen to flash.

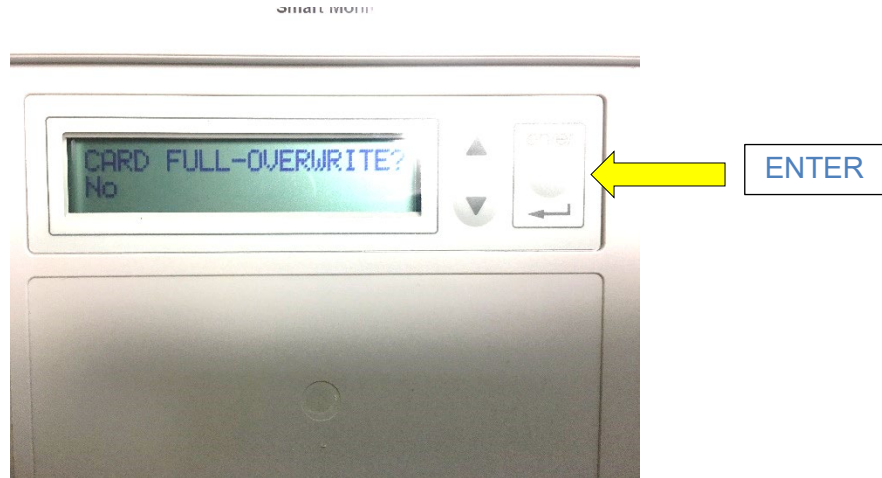

13. Press the **down-arrow** once. This will change the flashing “No” to a flashing “Yes”. Press **Enter** to make “Yes” your selection.

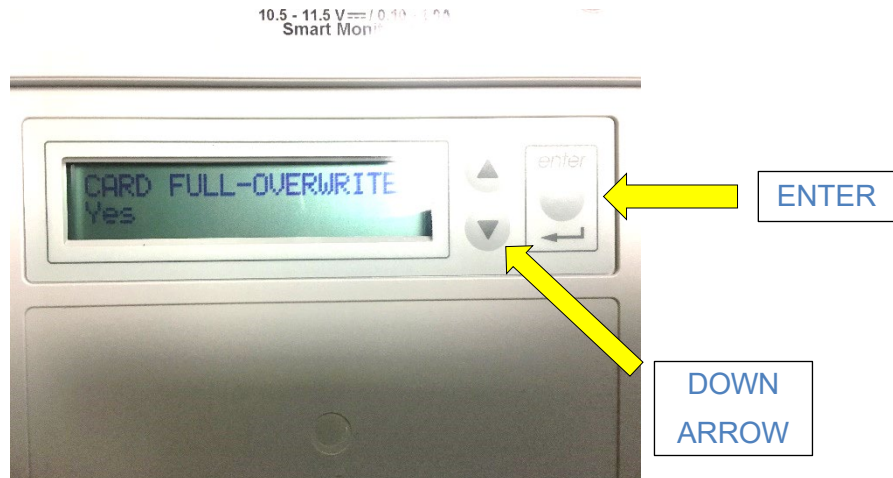



14. The display will read “CARD FULL – OVERWRITE? Transferring...” followed by “CARD FULL – OVERWRITE? Data Transferred”. (See Ref. 14-1 and 14-2)



(Ref. 14-1)

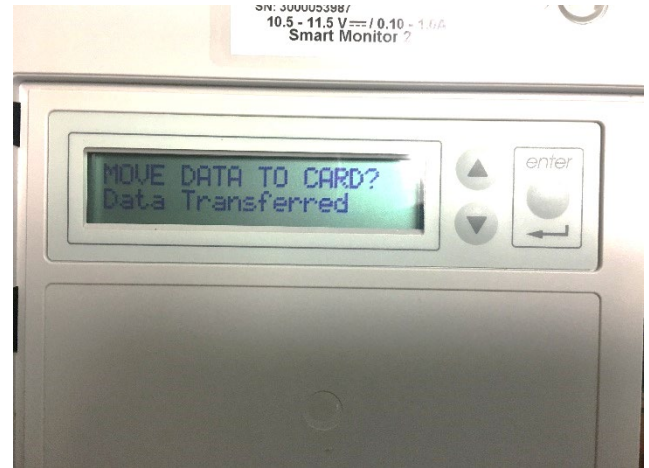

(Ref. 14-2)

15. Patient data transfer to PC Card is now complete. Turn monitor off by holding down the blue reset button and pressing the grey power button. Then, release the grey power button followed by the blue reset button.

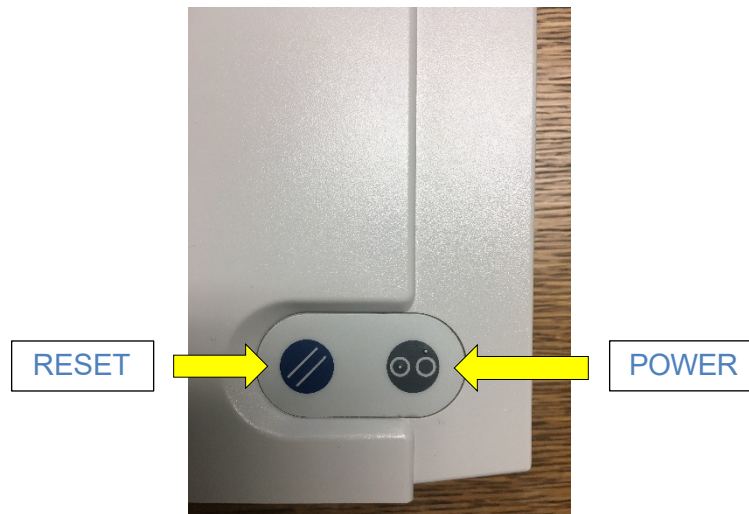

16. Turn over the SmartMonitor 2 unit and press black button to release the Compact Flash Card from the unit.

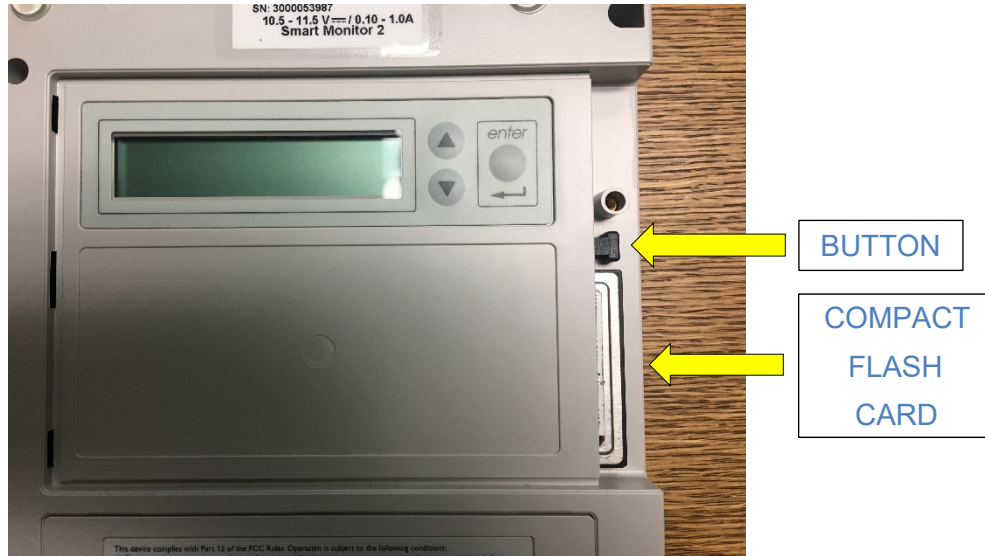

17. Remove the Compact Flash Card from the unit/adaptor and install in into a Flash card reader.
  - a. *If your Compact Flash card is installed in a Compact Flash adaptor, you will need to remove it from the adaptor prior to installing in into the flash card reader.*



ADAPTER

CARD

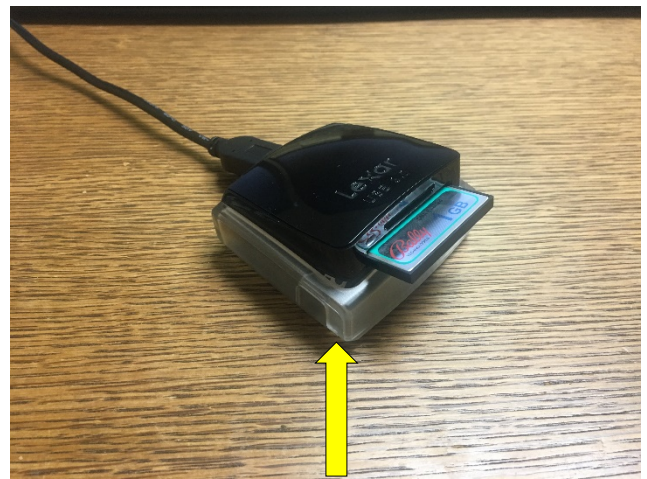

CARD READER

18. Plug the USB end of the Flash Card reader into a USB port located on your computer.
  - a. Ignore any “error” messages that are prompted when connecting the Flash Card reader to the computer.
  
19. Using your computer operating system’s file explorer, navigate to the Flash Card reader location and click on that drive to open.
  - a. **Please note: Every computer will assign a different drive letter to the card reader.**
  - b. Some operating systems will automatically open the drive when you plug the USB into the computer USB port.

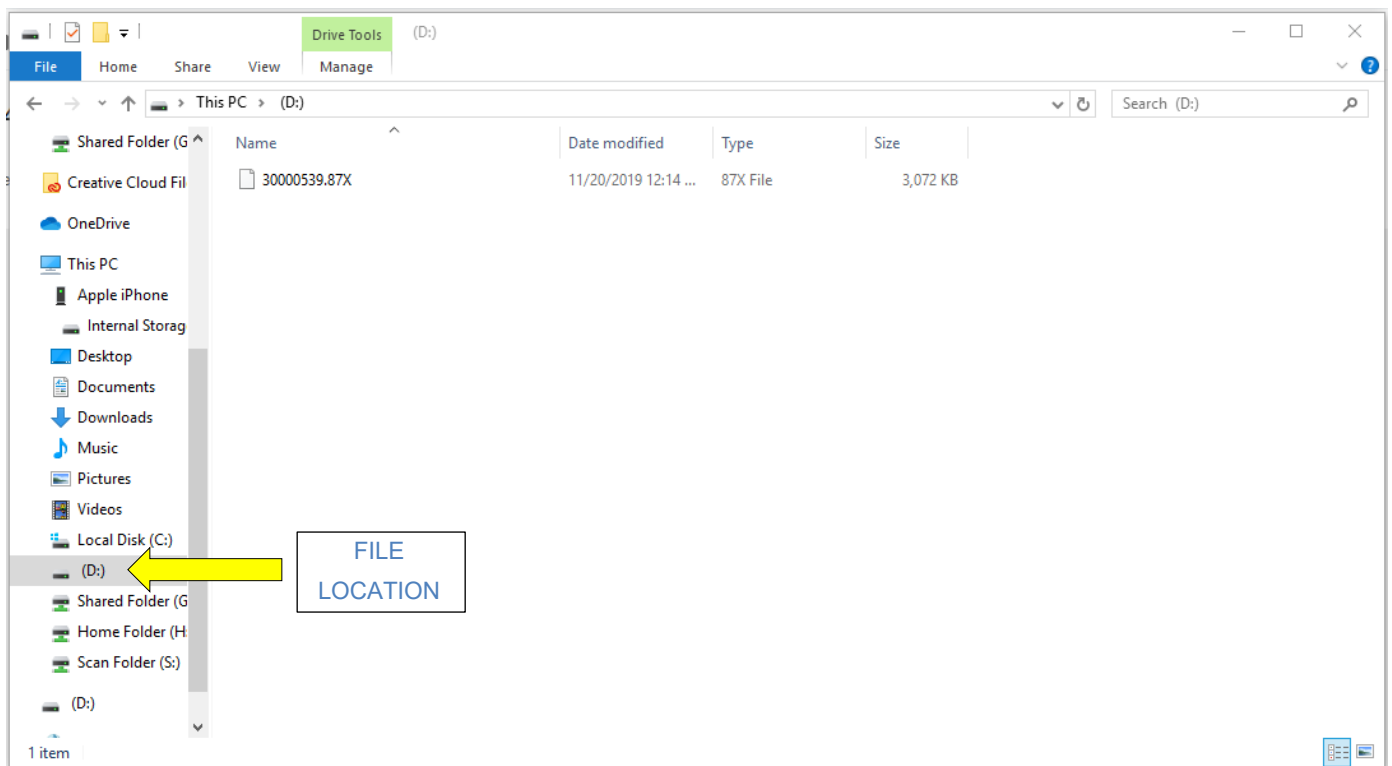

20. Most readers should only have one file. Using the pointer conduct the following:
- Hover over the file and right-click on it. A drop-down box will appear.
  - Move the pointer to the “Send to” tab. This will open another box that will provide a list of actions that can be done with that file.
  - If you were instructed to send data via Email, Click on “Mail Recipient”.

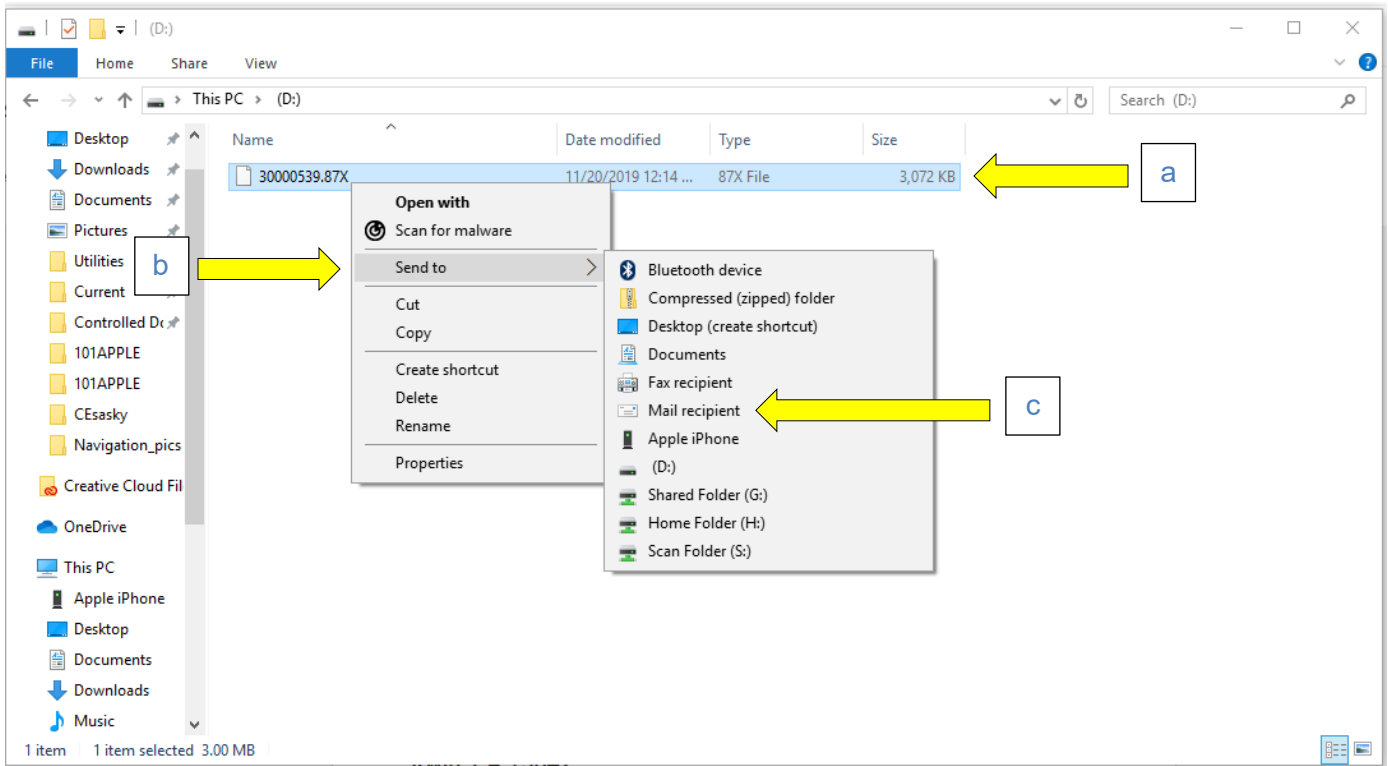



21. This will open your email program and attach the file into a new email. Insert your DME's email address into the proper field and send email as instructed.

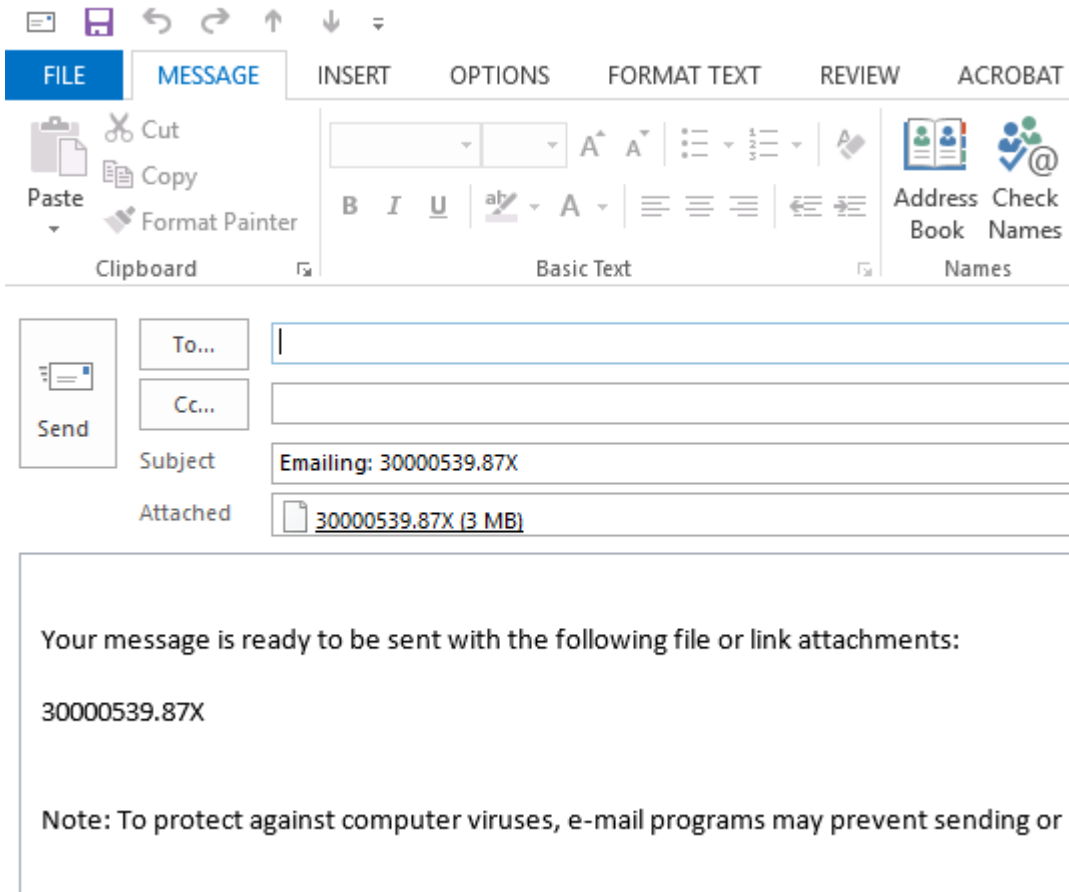

22. Once the file has been sent, unplug the USB end of card reader from your computer.



23. Remove the Compact Flash card from the reader and reinstall the card into the SmartMonitor 2 unit.  
a. *If your Compact Flash card was installed in a Compact Flash adaptor, you will need to install the card back into the adaptor prior to installing the adaptor back into the SmartMonitor 2 unit.*

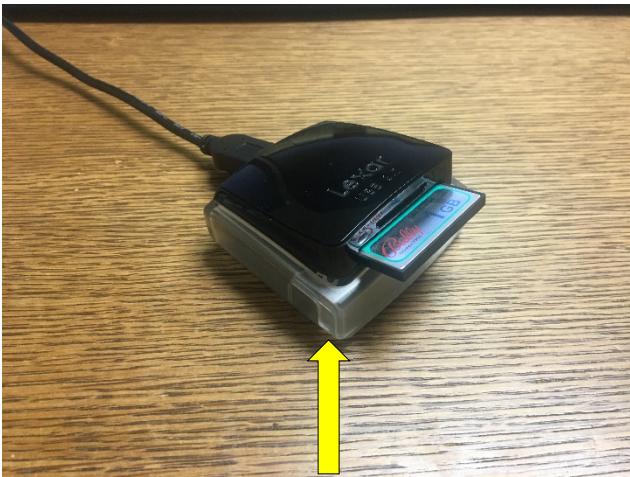

CARD  
READER



ADAPTER

CARD

24. Turn over the SmartMonitor 2 unit and install the Compact Flash Card adapter into the slotted provision.

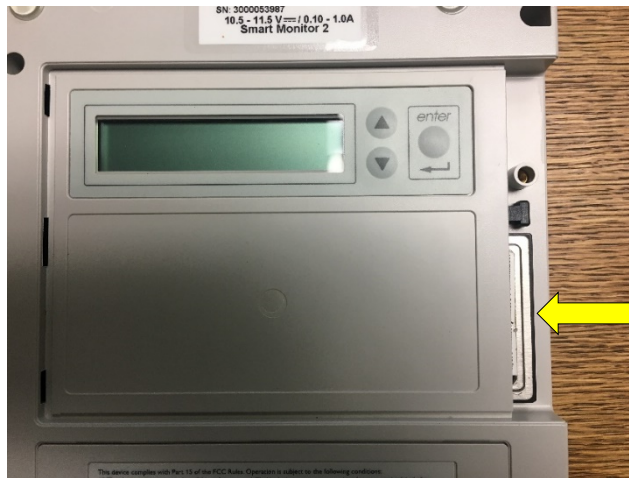

COMPACT  
FLASH  
CARD



25. Place LCD cover back on SmartMonitor 2 unit. Use Philips screwdriver to screw LCD cover back onto the unit.

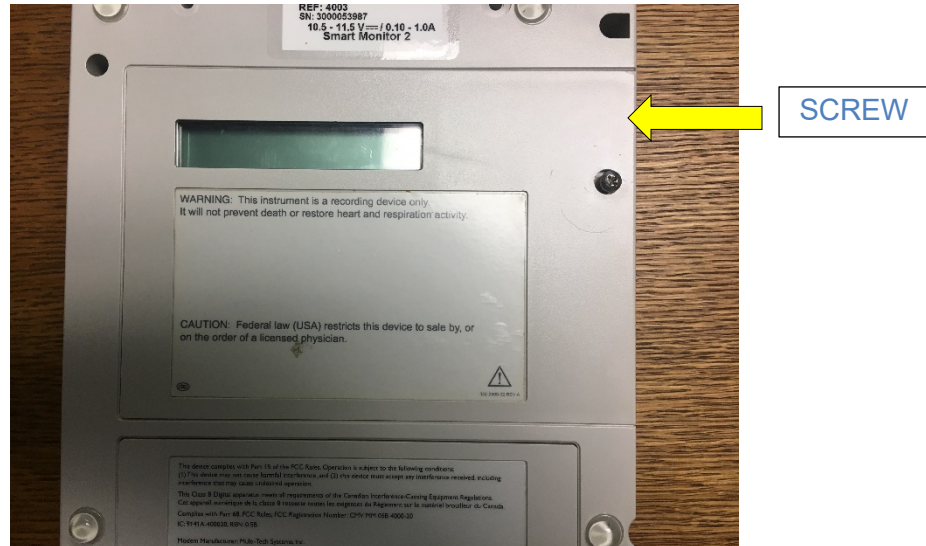

26. Return SmartMonitor 2 unit to its operating position and continue with patient monitoring as instructed by health care provider.
27. You have successfully completed the patient data download and transfer.