



Care@Home™

Cellular Version

Control Panel Getting Started





The Best Location for the Control Panel



Good cellular reception



Convenient for resident to access



Where speakerphone can be heard throughout premises



Control Panel

At least 2 m (6 ft.)
from other devices



Motion detector



Setting Up the Control Panel



1 Place thumb in oval hold and lift off the cover

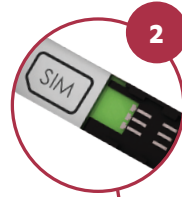

2 Insert the SIM

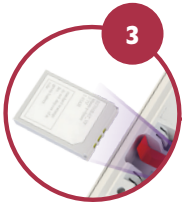

3 Insert the backup battery

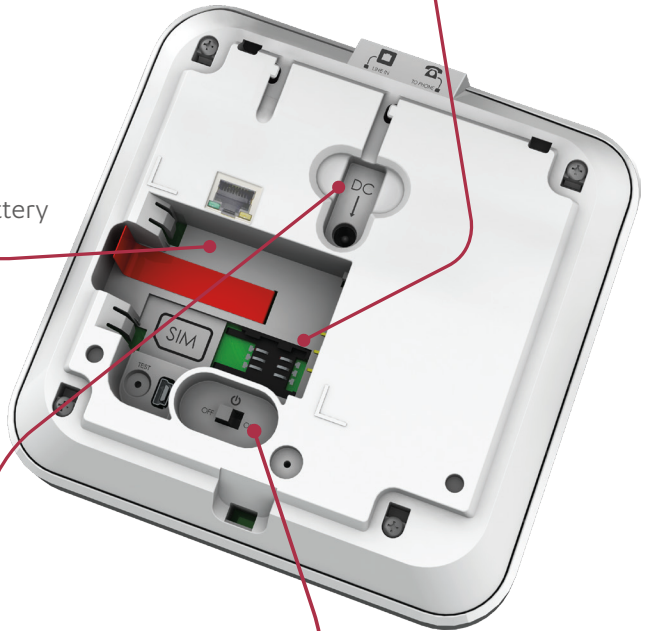

4

Connect the power cable and plug into a power source. Then close the back cover



5

Turn the power switch on



Using the Control Panel



Press to cancel an emergency call



Press to start an emergency call.
Red light:

- Blinking: alarm in progress
- On: message acknowledged



Shows power status

- On: AC power connected
- Blinking: using battery
- Off: no power



Shows communication status

- **Green**: if on, ready for call. If blinking, message being sent
- **Red**: if on, communication failure
- **Orange**: active conversation



Shows problem status

- On: malfunction in the control panel or a peripheral
- Blinking: supervision lost, or low battery in a peripheral

For more information, see: <http://www.essence-grp.com/resources/smart-care-download.html>

Legal notice: http://www.essence-grp.com/html/concerning_documents.html

www.essence-grp.com • info@essence-grp.com

