

Leasing Clusters



**VALIANT**  
**Corporate**



# CONTENTS

|                                     |    |
|-------------------------------------|----|
| PROJECT TEAM                        | 3  |
| BREAKOUT CLUSTERS                   | 7  |
| COLLABORATION CLUSTERS              | 12 |
| CORRIDOR CLUSTERS                   | 15 |
| CONFERENCE TABLE CLUSTERS           | 17 |
| ROUND TABLE CLUSTERS                | 18 |
| FOYER / EXECUTIVE BREAKOUT CLUSTERS | 21 |
| BREAKOUT MODULAR CLUSTERS           | 23 |
| LEASING CALCULATOR                  | 25 |





## VALIANT CORPORATE

Provides turnkey furniture solutions across the commercial, Government and Education markets. We have large teams across multiple disciplines and it allows us to add value to your project at any stage, from design through to project delivery.

### PROJECT TEAM



**Valentine Nzvimbo**

P: 0419 873 472

E: [valentine@valiant.com.au](mailto:valentine@valiant.com.au)



**Ben Tully**

P: 0438 597 668

E: [ben.tully@valiant.com.au](mailto:ben.tully@valiant.com.au)

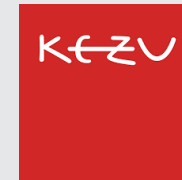

BERNHARDT|design

**BREAKOUT ZONES**

**COLLABORATION ZONES**

**FOYERS / CORRIDORS**





## THE NEIGHBORHOOD COLLECTION

Customisable stitching and finishes on limitless seating combinations



© 2016 All Rights Reserved. This concept is the property of Valiant Hire Pty Ltd. Any copying or altering of the concept shall not be undertaken without written permission.



## NEIGHBORHOOD SEATING SYSTEM

Neighborhood is a modular seating and table system consisting of thirty-nine unique modules for use in creating an unlimited number of configurations. Options include single sided, double sided and privacy modules as well as freestanding modules for use with any configuration. To select modules appropriate for your application use the following guide





## NEIGHBORHOOD MODULAR SOFA

- Fully upholstered modular seating system available with saddle stitch or jump master stitch in 38 unique models
- Table finishes available: oak veneer, laminate or corian
- Optional accessories include power and USB ports



## NEIGHBOURHOOD CONFIG 11

**\$870****per month/24mths**

90° Curved Corner Connector Single  
Seat Straight Connector (3) 45°

Inverted Curved Connector Single  
Seat Straight Connector (2) 90°

Curved Corner Connector.

## NEIGHBOURHOOD CONFIG 12

**\$1,035****per month/24mths**

Two-seat Straight Connector (2)

Single Connecting Table

Two-seat Straight Connector (2) 90°

Curved End Module Table (2).

## NEIGHBOURHOOD CONFIG 21

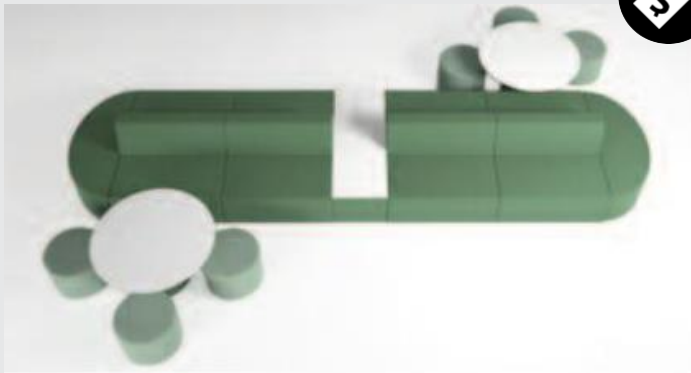
**\$1,890****per month/24mths**

180° Curved Half Oval End Module  
Double Sided Two-seat Straight  
Connector (2)

Double Sided Connecting Table  
Double Sided Two-seat Straight  
Connector (2)

180° Curved Half Oval End Module  
6021 Round Ottoman (6) JR2X 42"  
Round Table (2)

## NEIGHBOURHOOD CONFIG 14

**\$1,560****per month/24mths**

90° Curved Corner Connector

Two-seat Straight Connector

90° Curved Corner Connector

Two-seat Straight Connector (2)

90° Curved Corner Connector

Two-seat Straight Connector

90° Curved Corner Connector

Round Ottoman (2)

22" Round Table (2).



## NEIGHBOURHOOD CONFIGURATIONS

Neighborhood is a modular seating and table system consisting of thirty-nine unique modules for use in creating an unlimited number of configurations.

Options include single sided, double sided and privacy modules as well as freestanding modules for use with any configuration. To select modules appropriate for your application contact the Valiant team.







## OCCASIONAL CHAIRS : CHIARA | DIEGO | CHLOE

The Diego mobile chair with tab pull. Four weight-activated, self-locking casters. Fully upholstered with concealed zippers in outside back seams. GREENGUARD Certified

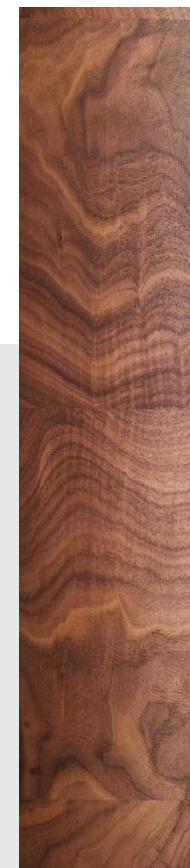

© 2016 All Rights Reserved. This concept is the property of Valiant Hire Pty Ltd. Any copying or altering of the concept shall not be undertaken without written permission.





## CHANTAL ARMCHAIR

Chantal is a versatile and ergonomic chair that can be used as companion pieces in a variety of workplace settings, including boardrooms, executive suites, home offices, open areas, waiting rooms and cafeterias. Each design within the range retains its signature clean and graceful look that Bernhardt Design and Noé are known for.





### DIEGO LOUNGE CHAIR

Fully upholstered lounge chair with memory foam . Two versions available: mobile chair with four weight-activated, self locking casters and pull tab or stationary chair with non-marring glides and no pull tab. Mix and match contrasting fabrics for body, handle and welt





COLLABORATION ZONE CLUSTERS



**\$598**  
per month/24mnths

- 1 x Clue Occasional Table
- 2 x Chiara Lounge Chair - 4755W inc fabric

*(Solid walnut base. Upholstered seat and back)*



**\$1,125**  
per month/24mnths

- 4 x Chloe - 1021K Timber Legs
- 2 x Chantal Armchairs Timber Legs
- 1 x 3000mL x 1200mmW Blueprint Loop Table (Walnut)



**\$410**  
per month/24mnths

- 1 x Quiet Conference Table 900dia HPL Top
- 4 x Chloe - 1020K inc fabric.

*(Matte Black Powder coat Tubular Steel Base)*



**\$798**  
per month/24mnths

- 1 x Quiet Occasional Table 900mmdia HPL Top
- 4 x Diego Lounge Chair - 5682 fully upholstered in fabric .

*(mobile chair with four weight-activated, self locking casters)*





## MEETING TABLES | COFFEE TABLES | CONFERENCE TABLES

A collection of organic-shaped tables with fully enclosed sides that may be used individually or grouped together to form configurations.

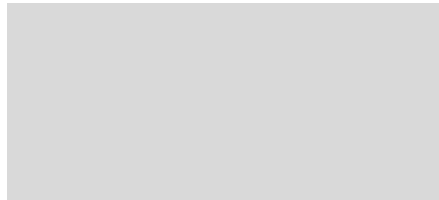

© 2016 All Rights Reserved. This concept is the property of Valiant Hire Pty Ltd. Any copying or altering of the concept shall not be undertaken without written permission.





## ELEVATION SEATING & TABLES

Elevation is a modular system of benches, ottomans, and tables that can be used in groupings or as individual products. Benches are available in two and three-seat versions and feature a quilted seat resting on an oak or walnut platform. Metal base options include: an asymmetrical T-leg and a symmetrical fin leg with finish options offered in a bronze metallic or matte black powder coat.



## CORRIDOR/FOYER CLUSTERS

CONFIGURATION 1

**\$2,398****per month/24mnths**

- Three-seat asymmetrical bench (2)
- Connecting table (2)
- Two-seat symmetrical bench (2)
- Corner Table
- 1500mm Round table\*

*(Solid oak or walnut tops)*

CONFIGURATION 2

**\$2,597****per month/24mnths**

- Three-seat symmetrical bench (2)
- Connecting table (2)
- Two-seat symmetrical bench (2)
- Corner table
- 500mm Ottomans (4)
- 1200mm Round table\*

*(Solid oak or walnut tops)*

CONFIGURATION 3

**\$3,079****per month/24mnths**

- Three-seat asymmetrical bench (2)
- 500mm Square drum table (3)
- Two-seat asymmetrical bench (2)
- 1200mm Square drum table

*(Solid oak or walnut tops)*



## BLUEPRINT CONFERENCE TABLES

Designed for open environments, the Blueprint table collection meets a multitude of conference table needs and expands Bernhardt Design's conference table offering. The collection features a large number of combinations and multiple configurations that include standalone tables, kitchen pedestals, media walls, stepped tables and endless table runs. Blueprint offers three base options: Frame, Loop and Block.



BLOCK BASE



LOOP BASE



FRAME BASE





**\$1,720**  
per month/24mths

- Block Stepped Configuration
- 6 x Ace barstools
- 6 x Halo Guest Chairs (*Ash veneered seat & back*)



**\$1,865**  
per month/24mths

- Loop Stepped Configuration
- 5 x Vanish Barstools
- 5 x Chloe matt black powder-coat frame



**\$1,620**  
per month/24mths

- 1 x Clue Occasional Table
- 10 x Halo Guest Chairs (*Upholstered Seat & Back*)



**\$1,930**  
per month/24mths

- Block run
- 12 x Ace barstools



## BLUEPRINT FRAME ROUND TABLES

The frame base is constructed of solid oak with subtle bevel details



**\$965**  
per month/24mnths

- **Frame Round Table**  
(1500MM DIA )
- **5 x Vanish Barstools**
- **5 x Upholstered Halo Meeting Chairs**



DETAILS



**\$1,150**  
per month/24mnths

- **Frame Round Table**  
(1500MM DIA )
- **5 x Chantal.02 on castors**



## CLUE COFFEE TABLE

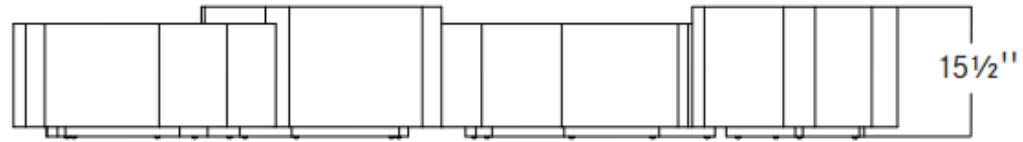

Clue Configuration 3

**\$1,175****per month/24mnths****Clue Configuration 3**

Features all 4 coffee tables at varying heights.

Clue is a collection of organic-shaped tables with fully enclosed sides that may be used individually or grouped together to form configurations. The table is available in two heights with maple or walnut veneers. The optional power module includes power + USB installed in the top of the work surface





**BECCA OUNGE CHAIR**

Fully upholstered. Standard with plain welt. Saddle stitch seams on the inside and outside. An Elegant Pieces to create a lasting first impression.





**\$1,950**  
per month/24mnth

- 1 X Becca 3 Seater
- 2 x Becca Armchairs
- 2 x Round Drum Table 500mmdia
- 1 x Round Drum Table 1200mmdia



**\$787**  
per month/24mnth

- 2 x Becca Armchairs
- 1 x Round Drum Table 500dia



**\$1,390**  
per month/24mnth

- 1 x Round Drum Table 1200mmdia
- 4 x Becca Armchairs







## BREAKOUT ZONE : HARMONY | CINEMA | COLOURS MODULAR SOFAS

The Diego mobile chair with tab pull. Four weight-activated, self-locking casters. Fully upholstered with concealed zippers in outside back seams. GREENGUARD Certified

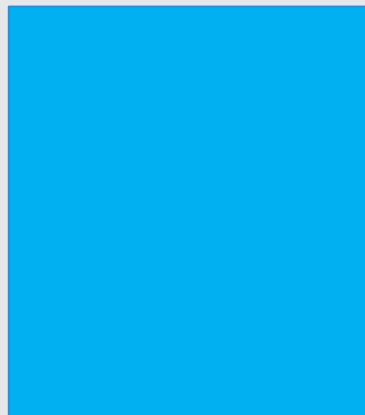
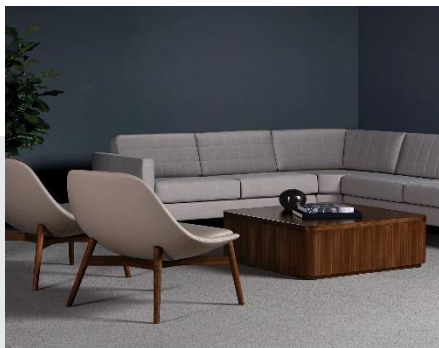
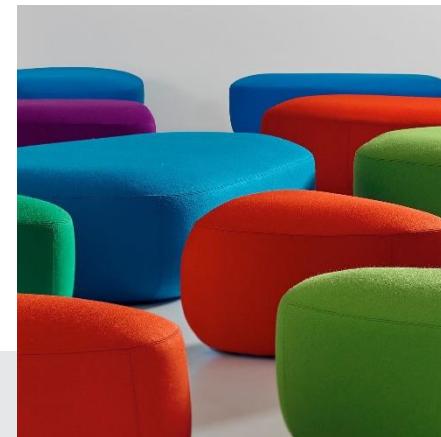

© 2016 All Rights Reserved. This concept is the property of Valiant Hire Pty Ltd. Any copying or altering of the concept shall not be undertaken without written permission.



**CINEMA SEATING SYSTEM**

Cinema is a modular seating product comprised of 15 unique modules which may be used interchangeably to create an unlimited number of configurations.



**\$1,958**

per month/24mnths

1 X Cinema Configuration 10

2 x Chiara Lounge chairs (polished Aluminium base)

1 x Quiet Coffee Table

1 x Quiet Side Table

2 x Apel Ottomans





Harmony is an extensive seating platform which allows you to design your own product. You can easily personalize pieces to create different looks within a space.

Harmony is an extensive seating platform which allows you to design your own product. You can easily personalize pieces to create different looks within a space. Customization is made easy by following a simple menu of options including:

style, scale, cushion type, cushion stitching options, fabric application and leg design. The collection of chairs, sofas, benches and modular units are available in three distinctive.



\$1,655

per month/24mths

2 X Classic Standard Sofas

1 x Quiet Coffee Table

1 x Quiet Side Table

2 x Chiara Lounge chairs (polished Aluminium base)

1 x Round Drum Table 500mmdia

#### CLUSTER OPTIONS



Contact The Valiant Team for furniture Schedules & Leasing Options



\$0,000.00  
total monthly cost

COST PER ZONE

| ZONES              | MONTHLY       | YEAR 1 COST   | YEAR 2 COST   | YEAR 3 COST   |
|--------------------|---------------|---------------|---------------|---------------|
| Touchdown          | \$0.00        | \$0.00        | \$0.00        | \$0.00        |
| Collaboration      | \$0.00        | \$0.00        | \$0.00        | \$0.00        |
| Home Base          | \$0.00        | \$0.00        | \$0.00        | \$0.00        |
| Break-out          | \$0.00        | \$0.00        | \$0.00        | \$0.00        |
| Resource Centre    | \$0.00        | \$0.00        | \$0.00        | \$0.00        |
| Outdoor            | \$0.00        | \$0.00        | \$0.00        | \$0.00        |
| Executive Office   | \$0.00        | \$0.00        | \$0.00        | \$0.00        |
| Corridors          | \$0.00        | \$0.00        | \$0.00        | \$0.00        |
| Sub Total          | \$0.00        | \$0.00        | \$0.00        | \$0.00        |
| Installation       |               | \$0.00        |               |               |
| Damage Waiver      |               | \$0.00        | \$0.00        | \$0.00        |
| Make-good          |               |               |               |               |
| <b>GRAND TOTAL</b> | <b>\$0.00</b> | <b>\$0.00</b> | <b>\$0.00</b> | <b>\$0.00</b> |





# CONTACT



[valentine@valiant.com.au](mailto:valentine@valiant.com.au)



M: 0419 873 472  
P:(07) 3859 8500



16/50 Parker Court  
Pinkenba QLD 4008



[www.valiant.com.au](http://www.valiant.com.au)

