

Brass Ball Valve

General Description

General purpose Ball Valve with female to female BSP threaded ends. Suitable for water, gas and oil applications. Also available with lockable lever. Also available in Male to Female BSP Thread in 15mm, 20mm & 25mm.

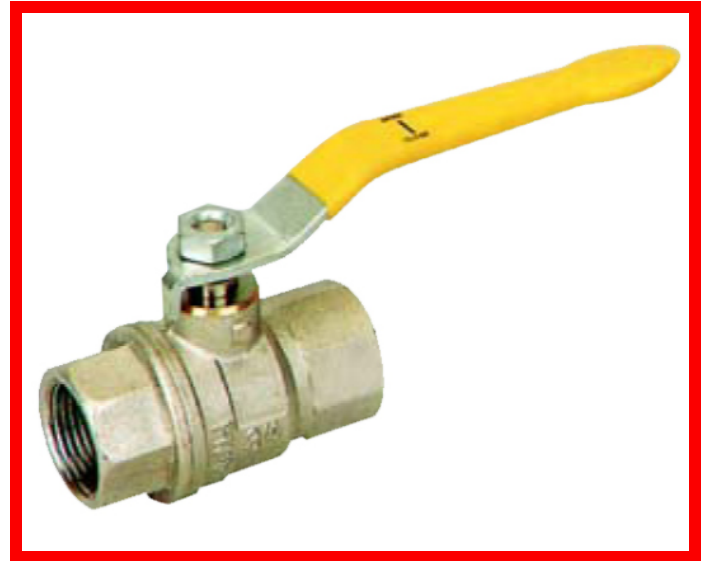

Technical Data

- Cold Working Pressure: 2500 kPa
- Max Working Temp: 60°C
- Coating: Fusion Bonded Epoxy Coating
- Thread: AS1722.1

Part List

- ① Valve Body: Forged Brass
- ② Seat Retainer: Brass (Nickle Plated)
- ③ Seat Retainer: P.T.F.E
- ④ Ball: Brass (Chronium plated)
- ⑤ Stem: Brass
- ⑥ Gland: Brass
- ⑦ Packing: Viton (Double O-Ring)
- ⑧ Lever: Stainless Steel (Plastic Coated)
- ⑨ Lever Retaining Nut: Brass (Nickle Plated)

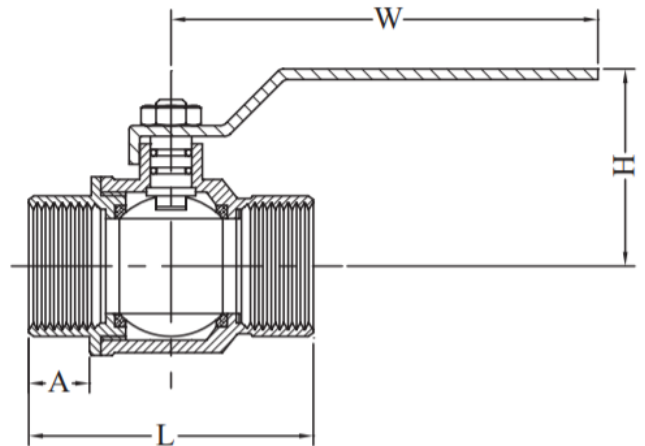

Brass Ball Valve					
Part #		L	H	W	A
Ball valve	Lockable Ball Valve				
BVT8	LOBV8	49	37	70	13
BVT10	LOBV10	49	37	70	13
BVT15	LOBV15	59.5	39	95	16.5
BVT20	LOBV20	68.5	43	115	18.5
BVT25	LOBV25	79	48.5	115	21
BVT32	LOBV32	96.5	63	125	23.5
BVT40	LOBV40	104.5	76	180	23.5
BVT50	LOBV50	126	81	180	28
BVT65	LOBV65	151	112	257	33
BVT80	LOBV80	174	120	301	40
BVT100	LOBV100	212	144	340	43