

NOTE:
 BOTTOM LAYER OF INSULATION SHALL BE LAID DOWN IN
 A STAGGERED PROFILE. STAGGER AND OFFSET TOP LAYER
 OF INSULATION FROM BOTTOM LAYER TO PREVENT
 ALIGNED EDGES.

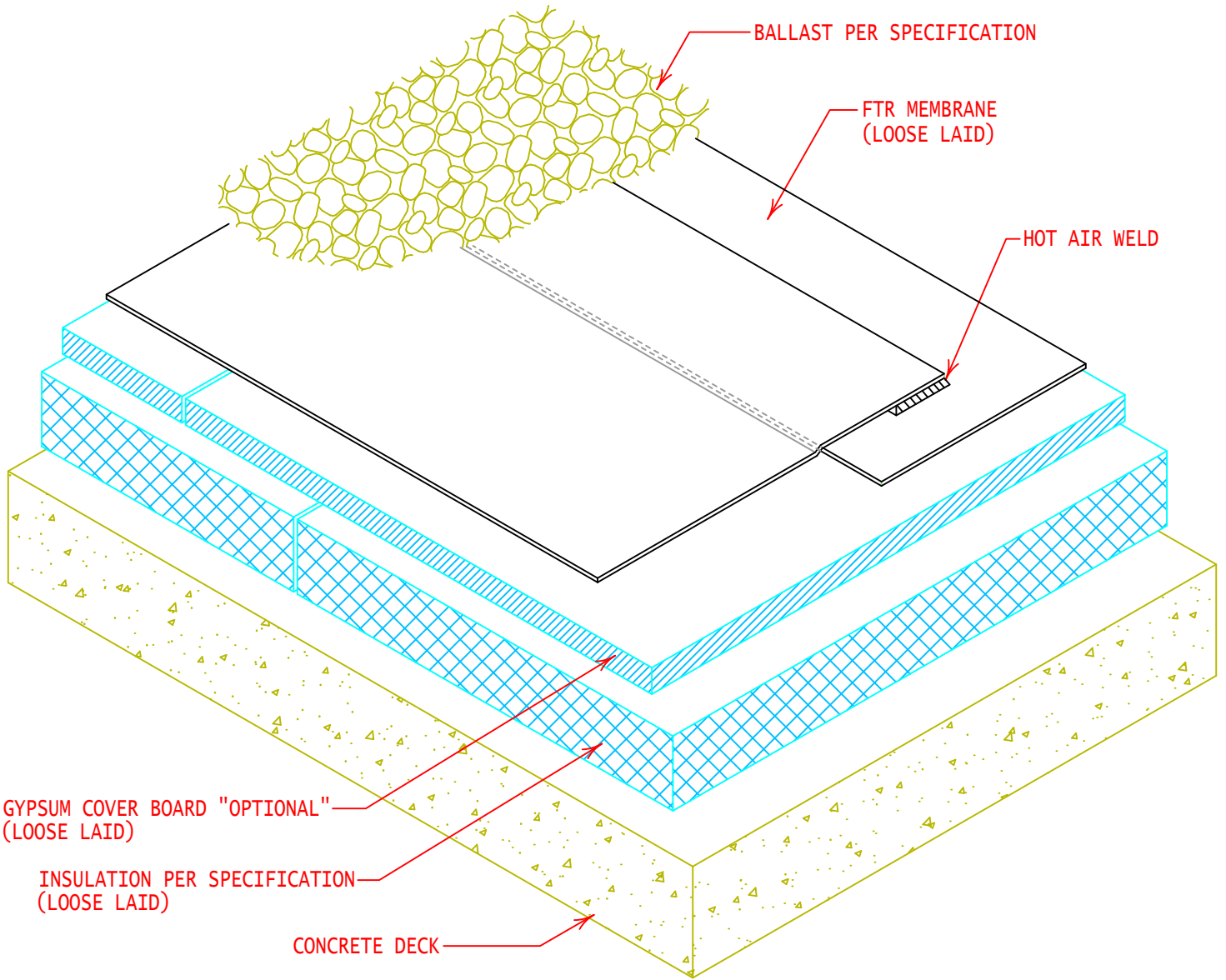

GYPSUM COVER BOARD "OPTIONAL"
 (LOOSE LAID)

INSULATION PER SPECIFICATION
 (LOOSE LAID)

CONCRETE DECK

BALLAST PER SPECIFICATION

FTR MEMBRANE
 (LOOSE LAID)

HOT AIR WELD



GENERAL REFERENCE:
 "FTR GS 01/21"
 APPLICABLE SYSTEMS:
 "FTR BA 01/21"

COMPOSITE ROOF SYSTEM CROSS SECTION
 (BALLASTED SYSTEM)

REVISES DETAIL	ISSUE DATE	DRAWING NUMBER
ALL PREVIOUS	03-15-21	FTR-DBS1