

NOTE:
 BOTTOM LAYER OF INSULATION SHALL BE LAID DOWN IN
 A STAGGERED PROFILE. STAGGER AND OFFSET TOP LAYER
 OF INSULATION FROM BOTTOM LAYER TO PREVENT
 ALIGNED EDGES.

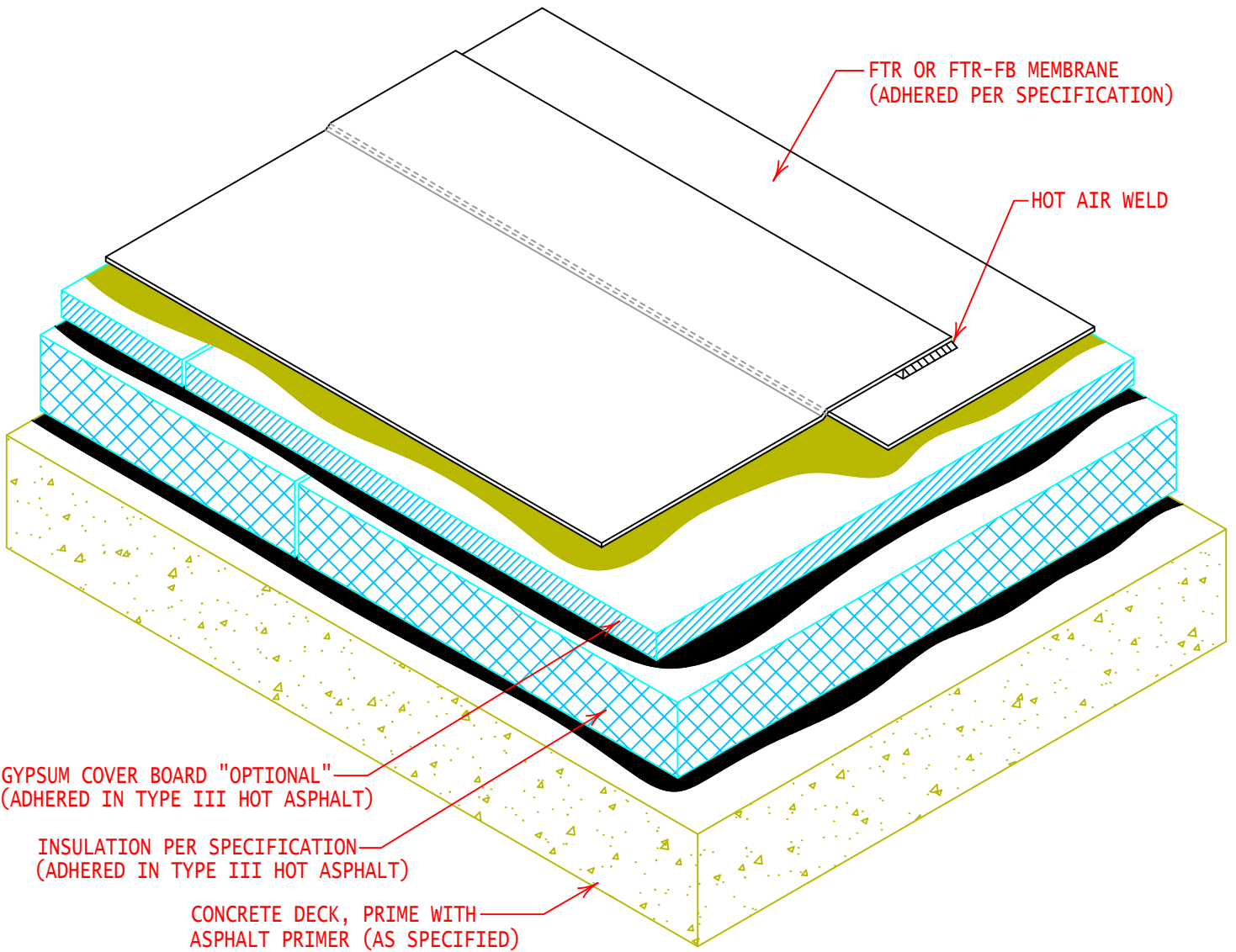

GYPSUM COVER BOARD "OPTIONAL"
 (ADHERED IN TYPE III HOT ASPHALT)

INSULATION PER SPECIFICATION
 (ADHERED IN TYPE III HOT ASPHALT)

CONCRETE DECK, PRIME WITH
 ASPHALT PRIMER (AS SPECIFIED)

FTR OR FTR-FB MEMBRANE
 (ADHERED PER SPECIFICATION)

HOT AIR WELD



GENERAL REFERENCE:
 "FTR GS 01/21"
 APPLICABLE SYSTEMS:
 "FTR AD 01/21"

COMPOSITE ROOF SYSTEM CROSS SECTION
 (ADHERED INSULATION IN ASPHALT)

REVISES DETAIL	ISSUE DATE	DRAWING NUMBER
ALL PREVIOUS	03-15-21	FTR-DAS1