

NOTE:
 BOTTOM LAYER OF INSULATION SHALL BE LAID DOWN IN
 A STAGGERED PROFILE. STAGGER AND OFFSET TOP LAYER
 OF INSULATION FROM BOTTOM LAYER TO PREVENT
 ALIGNED EDGES.

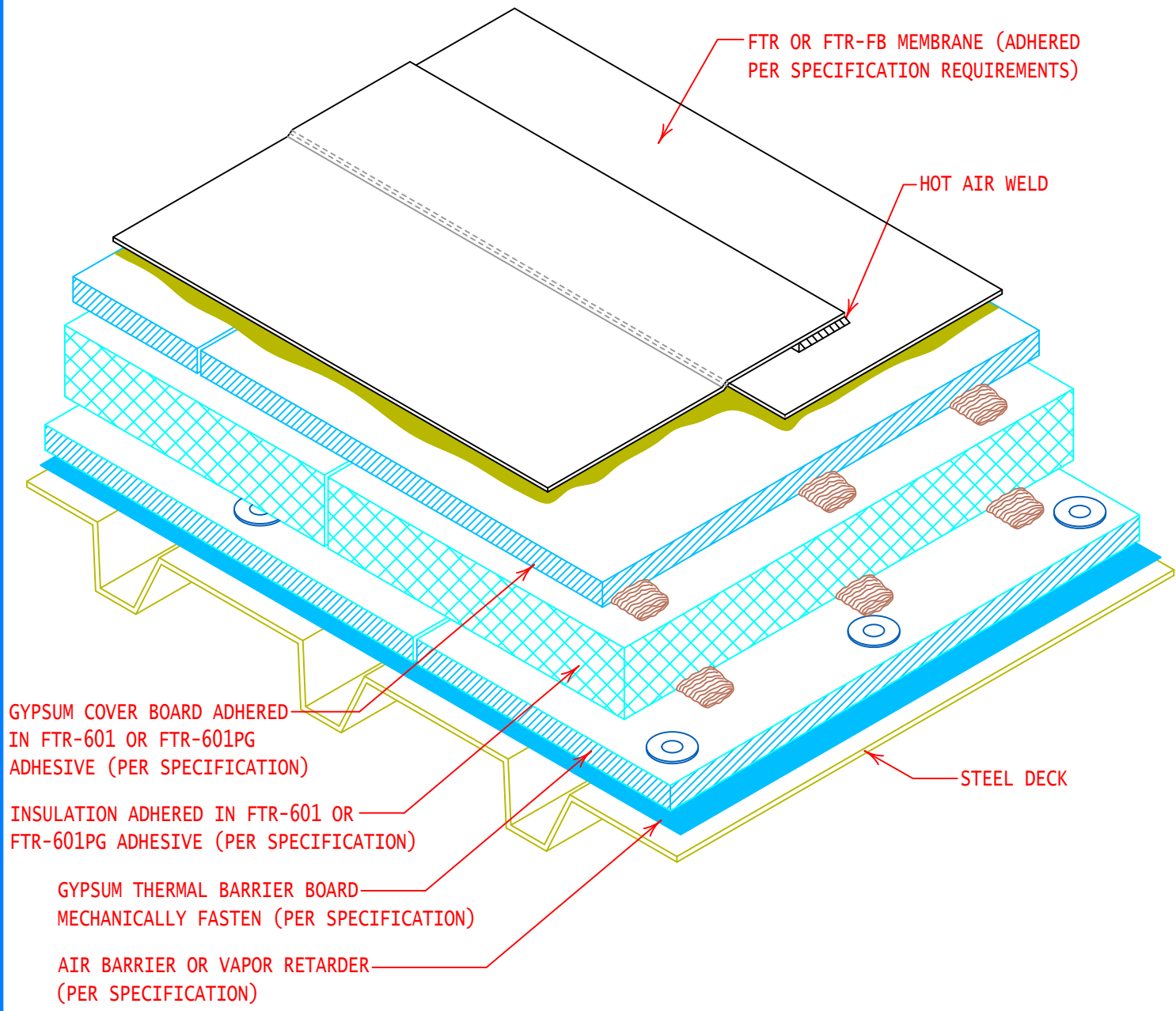

FTR OR FTR-FB MEMBRANE (ADHERED
 PER SPECIFICATION REQUIREMENTS)

HOT AIR WELD

GYPSUM COVER BOARD ADHERED
 IN FTR-601 OR FTR-601PG
 ADHESIVE (PER SPECIFICATION)

INSULATION ADHERED IN FTR-601 OR
 FTR-601PG ADHESIVE (PER SPECIFICATION)

GYPSUM THERMAL BARRIER BOARD
 MECHANICALLY FASTEN (PER SPECIFICATION)

AIR BARRIER OR VAPOR RETARDER
 (PER SPECIFICATION)

STEEL DECK



GENERAL REFERENCE: "FTR GS 01/21" APPLICABLE SYSTEMS: "FTR AD 01/21"			ROOF SYSTEM CROSS SECTION (MECH. FAST. COVER BOARD & ADHERED INSUL.)		
REVISES DETAIL	ISSUE DATE	DRAWING NUMBER			
ALL PREVIOUS	03-15-21	FTR-DAS12SP			