

NOTE:
 BOTTOM LAYER OF INSULATION SHALL BE LAID DOWN IN
 A STAGGERED PROFILE. STAGGER AND OFFSET TOP LAYER
 OF INSULATION FROM BOTTOM LAYER TO PREVENT
 ALIGNED EDGES.

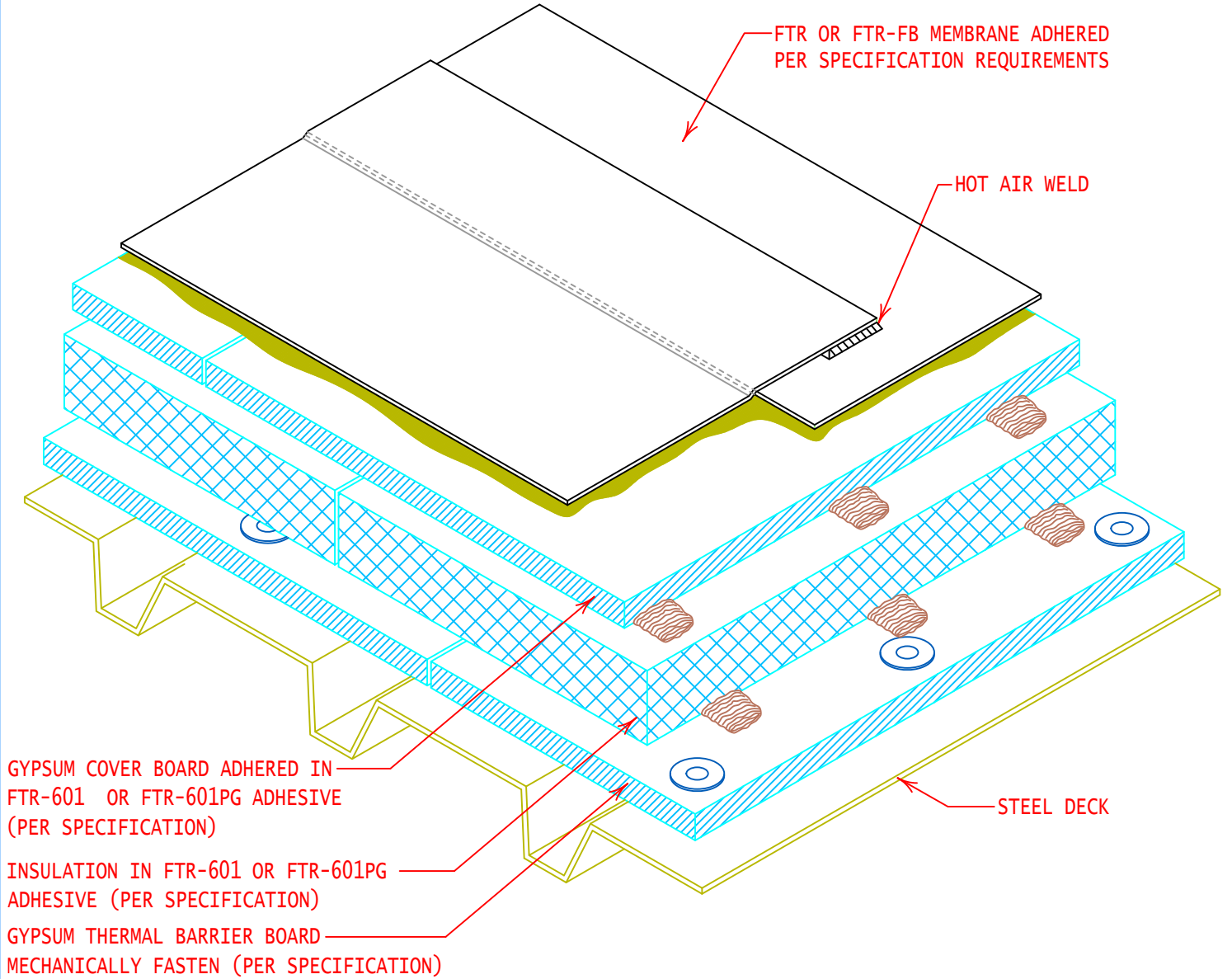

GENERAL REFERENCE: <i>"FTR GS 01/21"</i>		
APPLICABLE SYSTEMS: <i>"FTR AD 01/21"</i>		
ROOF SYSTEM CROSS SECTION (MECH. FAST. COVER BOARD & ADHERED INSUL.)		
REVISES DETAIL	ISSUE DATE	DRAWING NUMBER
ALL PREVIOUS	03-15-21	FTR-DAS16SP