

NOTE:
 BOTTOM LAYER OF INSULATION SHALL BE LAID DOWN IN
 A STAGGERED PROFILE. STAGGER AND OFFSET TOP LAYER
 OF INSULATION FROM BOTTOM LAYER TO PREVENT
 ALIGNED EDGES.

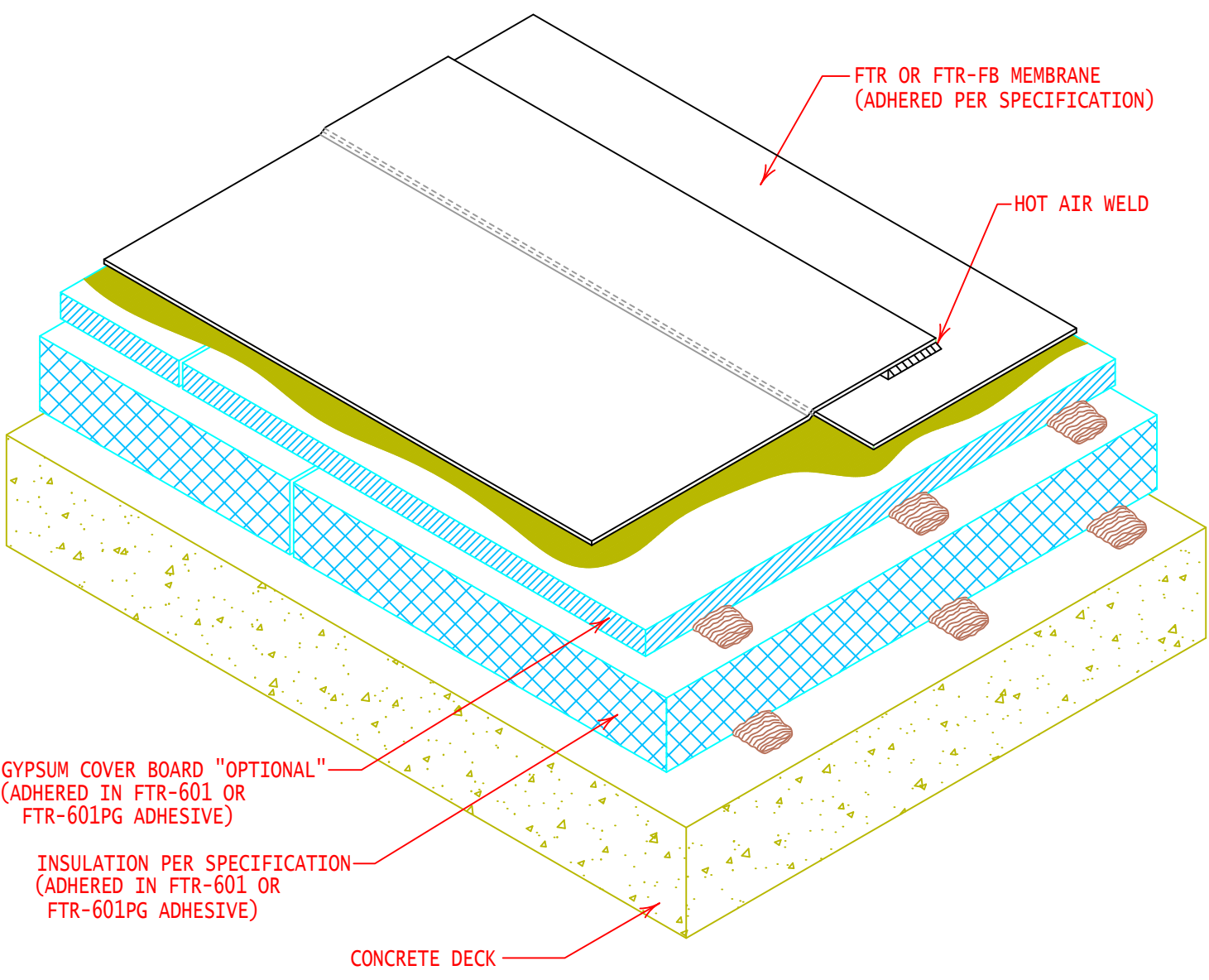

GYPSUM COVER BOARD "OPTIONAL"
 (ADHERED IN FTR-601 OR
 FTR-601PG ADHESIVE)

INSULATION PER SPECIFICATION
 (ADHERED IN FTR-601 OR
 FTR-601PG ADHESIVE)

CONCRETE DECK

FTR OR FTR-FB MEMBRANE
 (ADHERED PER SPECIFICATION)

HOT AIR WELD



GENERAL REFERENCE:
 "FTR GS 01/21"
 APPLICABLE SYSTEMS:
 "FTR AD 01/21"

COMPOSITE ROOF SYSTEM CROSS SECTION (ADHERED INSULATION IN FTR-601 ADHESIVE)		
REVISES DETAIL	ISSUE DATE	DRAWING NUMBER
ALL PREVIOUS	10-14-21	FTR-DAS2