

NOTE:
 BOTTOM LAYER OF INSULATION SHALL BE LAID DOWN IN
 A STAGGERED PROFILE. STAGGER AND OFFSET TOP LAYER
 OF INSULATION FROM BOTTOM LAYER TO PREVENT
 ALIGNED EDGES.

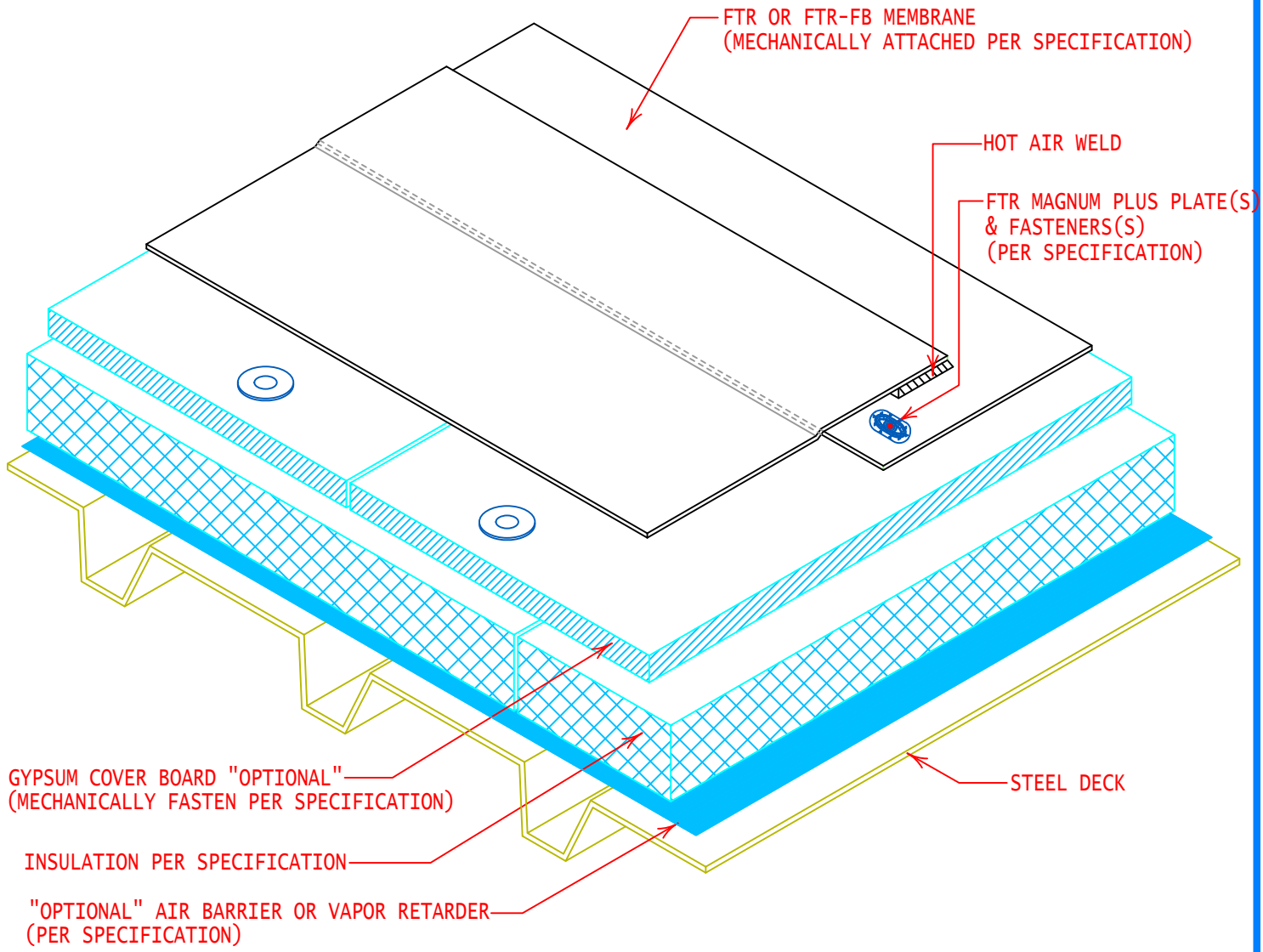

GYPSUM COVER BOARD "OPTIONAL"
 (MECHANICALLY FASTEN PER SPECIFICATION)

INSULATION PER SPECIFICATION

"OPTIONAL" AIR BARRIER OR VAPOR RETARDER
 (PER SPECIFICATION)

FTR OR FTR-FB MEMBRANE
 (MECHANICALLY ATTACHED PER SPECIFICATION)

HOT AIR WELD

FTR MAGNUM PLUS PLATE(S)
 & FASTENERS(S)
 (PER SPECIFICATION)

STEEL DECK



GENERAL REFERENCE:
 "FTR GS 01/21"
 APPLICABLE SYSTEMS:
 "FTR MA 01/21"

COMPOSITE ROOF SYSTEM CROSS SECTION
 (MECHANICALLY FASTENED SYSTEM)

REVISES DETAIL	ISSUE DATE	DRAWING NUMBER
ALL PREVIOUS	03-15-21	FTR-DMFS1