

NOTE: JOINING OF EDGE METAL PIECES

1. INSTALL METAL CORRECTLY
2. APPLY 1" WIDE ALUMINUM TAPE OVER JOINT GAP
3. WELD IN MEMBRANE EDGE FLASHING STRIP ONTO METAL AND THE ROOF MEMBRANE.
4. WELD IN 4-6" WIDE FLASHING STRIP OVER TAPE COVERED JOINT GAP ON THE EDGE FLASHING STRIP

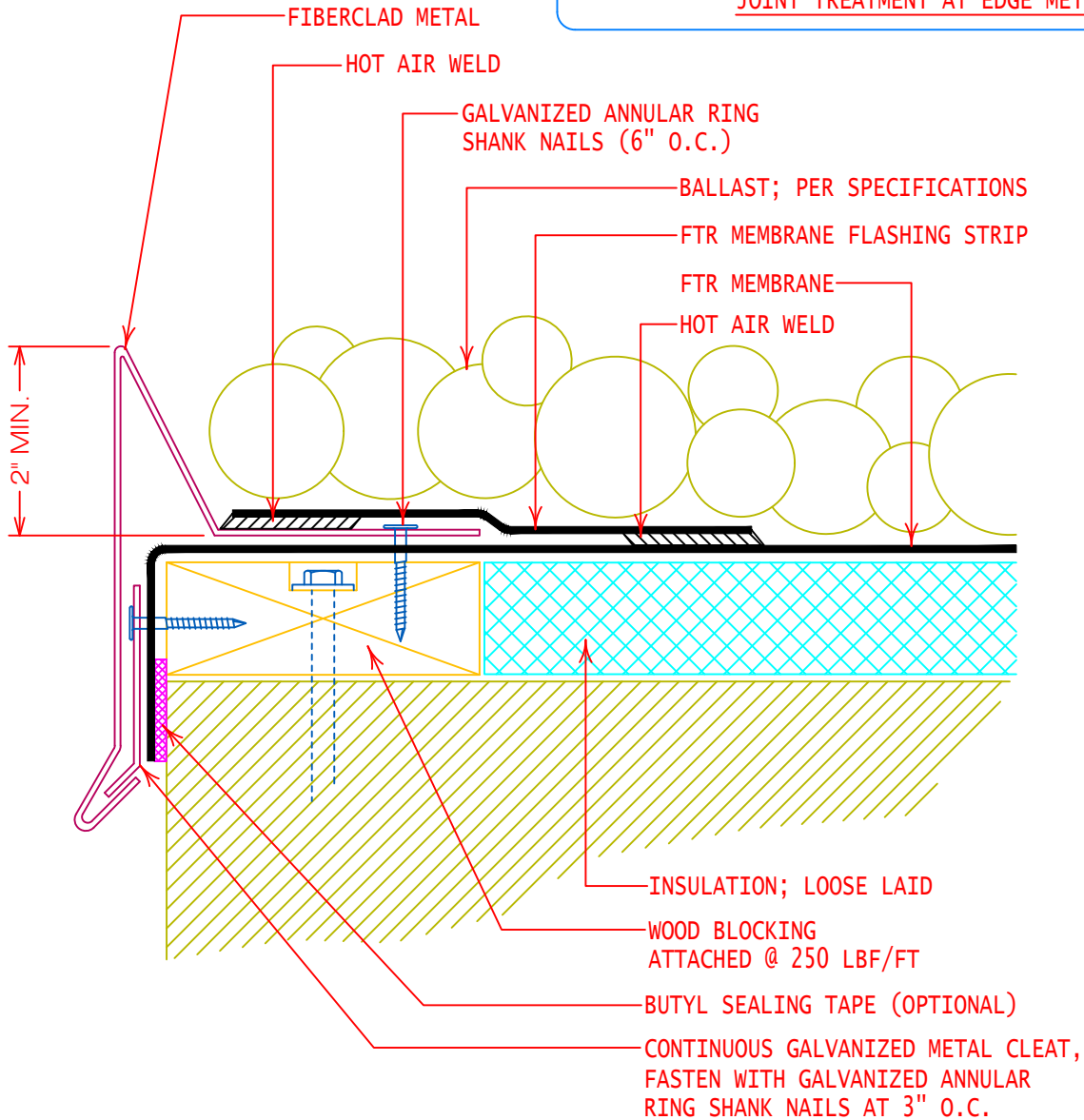
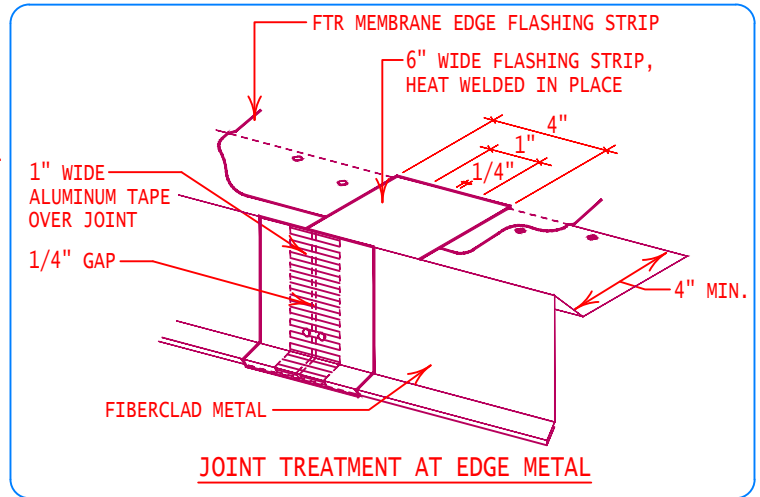

GENERAL REFERENCE:
 "FTR GS 01/21"
 APPLICABLE SYSTEMS:
 "FTR BA 01/21"

FIBERCLAD METAL "GRAVEL STOP" FLASHING BALLAST ROOFING SYSTEM(S)

REVISES DETAIL	ISSUE DATE	DRAWING NUMBER
ALL PREVIOUS	02-10-14	FTR-DE6