

FIBERTITE 200 FASCIA SYSTEM			
PRODUCT ID. NO.	H DIMENSION	X DIMENSION	NAILER COVERAGE
FAF-50	5" (127.0 mm)	3" (76.2 mm)	1 NAILER
FAF-65	6-1/2" (165.1 mm)	4-1/2" (114.3 mm)	2 NAILERS
FAF-80	8" (203.2 mm)	6" (152.4 mm)	3 NAILERS
FAF-95	9-1/2" (241.3 mm)	7-1/2" (190.5 mm)	4 NAILERS
FAF-110	11" (279.4 mm)	9" (228.6 mm)	5 NAILERS
FAF-125	12-1/2" (314.5 mm)	10-1/2" (266.7 mm)	6 NAILERS
FM APPROVED UP TO 1-195			

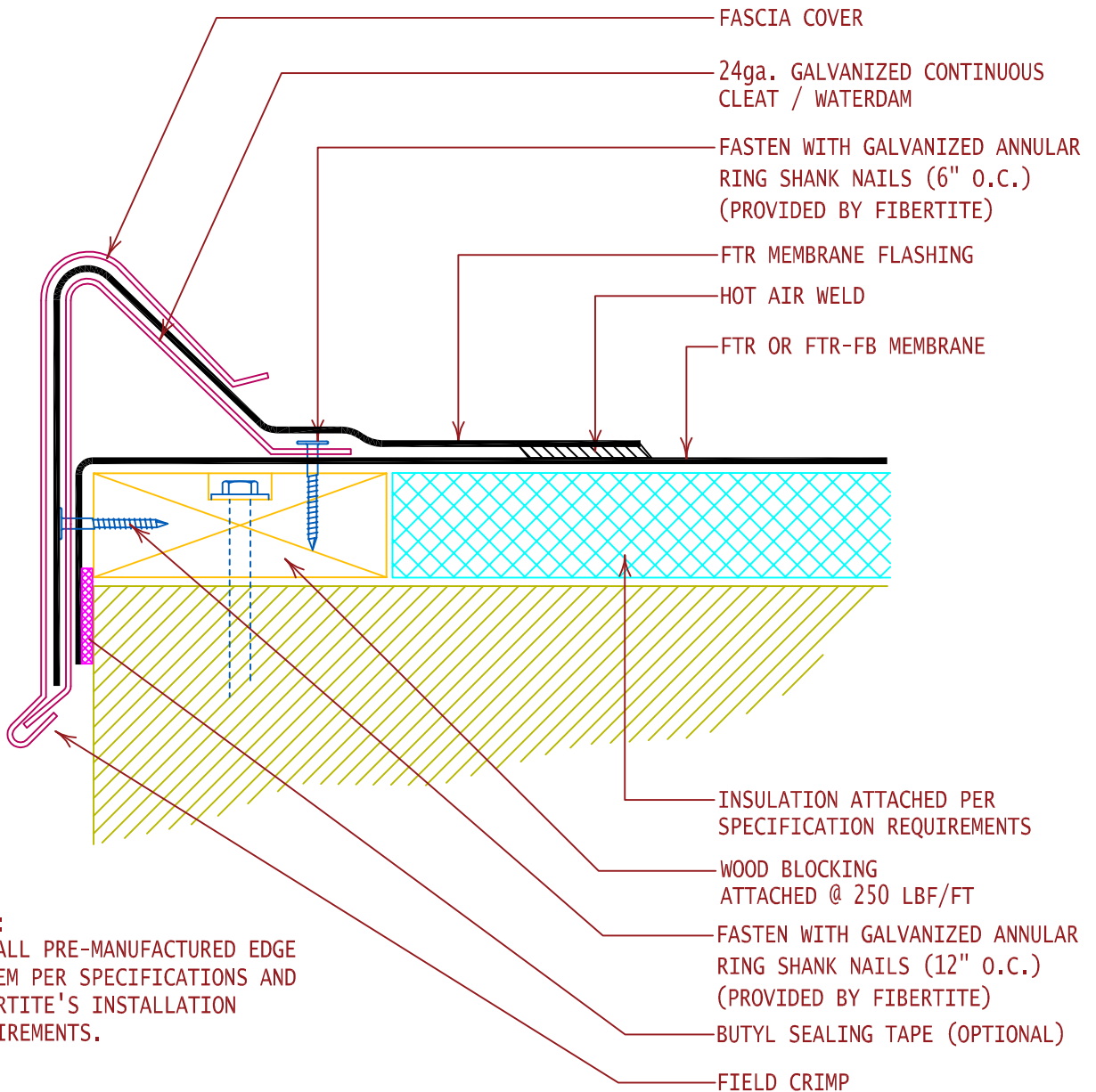

NOTE:  
INSTALL PRE-MANUFACTURED EDGE SYSTEM PER SPECIFICATIONS AND FIBERTITE'S INSTALLATION REQUIREMENTS.

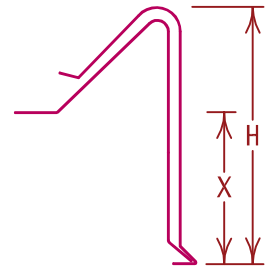

GENERAL REFERENCE:  
"FTR GS 02/13"  
APPLICABLE SYSTEMS:  
"FTR MA 02/13"  
"FTR AD 02/13"  
"FTR BA 02/13"

FIBERTITE 200 FASCIA SYSTEM  
(RAISED CLEAT EDGE)

REVISES DETAIL	ISSUE DATE	DRAWING NUMBER
ALL PREVIOUS	02-10-14	FTR-DE8a