

NON-LIFTABLE

FTR #101 SEALANT
BEHIND TOP OF FLASHING

MECHANICAL UNIT

METAL COUNTERFLASHING, FASTEN W/
EPDM WASHERED FASTENERS (12" O.C.)

FTR MEMBRANE FLASHING (FULLY ADHERED)

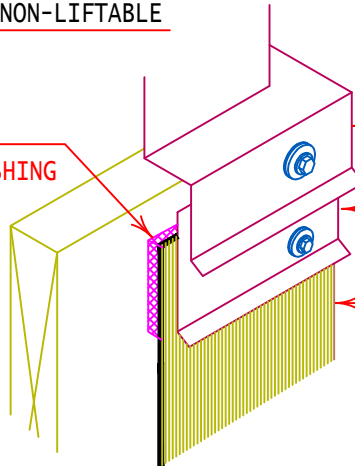

GALVANIZED ANNULAR
RING SHANK NAILS
(3" O.C.)

ROOF TOP UNIT
OR SKYLIGHT

EPDM WASHERED FASTENER
AS REQUIRED

FTR MEMBRANE FLASHING
ADHERED IN FTR #201, FTR #190e
OR Alpha-Tite BONDING ADHESIVE

PREMOLDED CORNER
HOT AIR WELD

8" MIN.

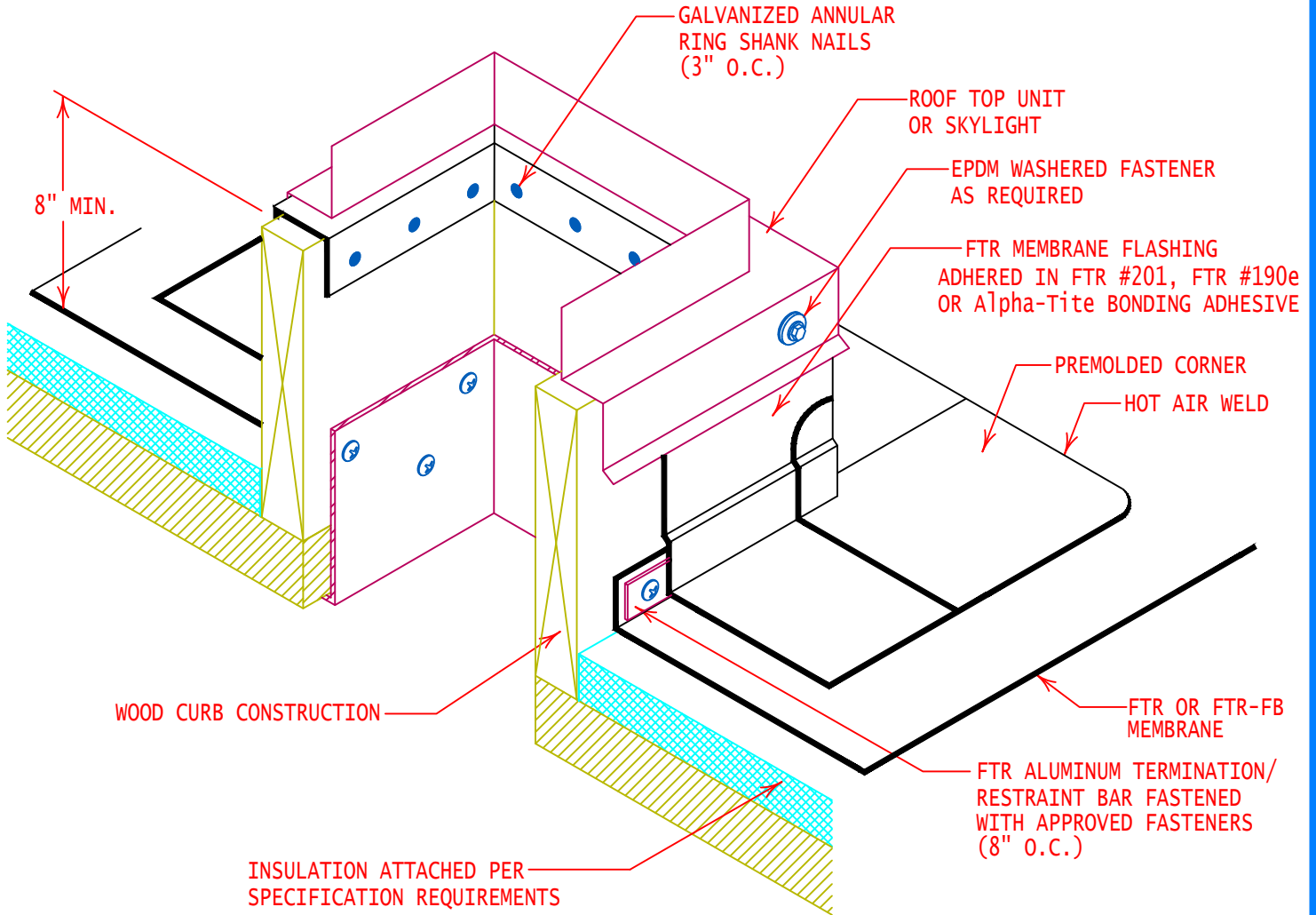

WOOD CURB CONSTRUCTION

INSULATION ATTACHED PER
SPECIFICATION REQUIREMENTS

FTR OR FTR-FB
MEMBRANE

FTR ALUMINUM TERMINATION/
RESTRAINT BAR FASTENED
WITH APPROVED FASTENERS
(8" O.C.)



GENERAL REFERENCE:
"FTR GS 01/21"

APPLICABLE SYSTEMS:
"FTR MA 01/21"
"FTR AD 01/21"
"FTR BA 01/21"

**TYPICAL WOOD OR SKYLIGHT CURB FLASHING
(BLOCKING ALTERNATE) T-BAR RESTRAINT**

| REVISES DETAIL | ISSUE DATE | DRAWING NUMBER |
|----------------|------------|----------------|
| ALL PREVIOUS | 02-23-21 | FTR-DP1ai |