

NON-LIFTABLE

FTR #101 SEALANT  
BEHIND TOP OF FLASHING

MECHANICAL UNIT

METAL COUNTERFLASHING, FASTEN W/  
EPDM WASHED FASTENERS (12" O.C.)

FTR MEMBRANE FLASHING (FULLY ADHERED)

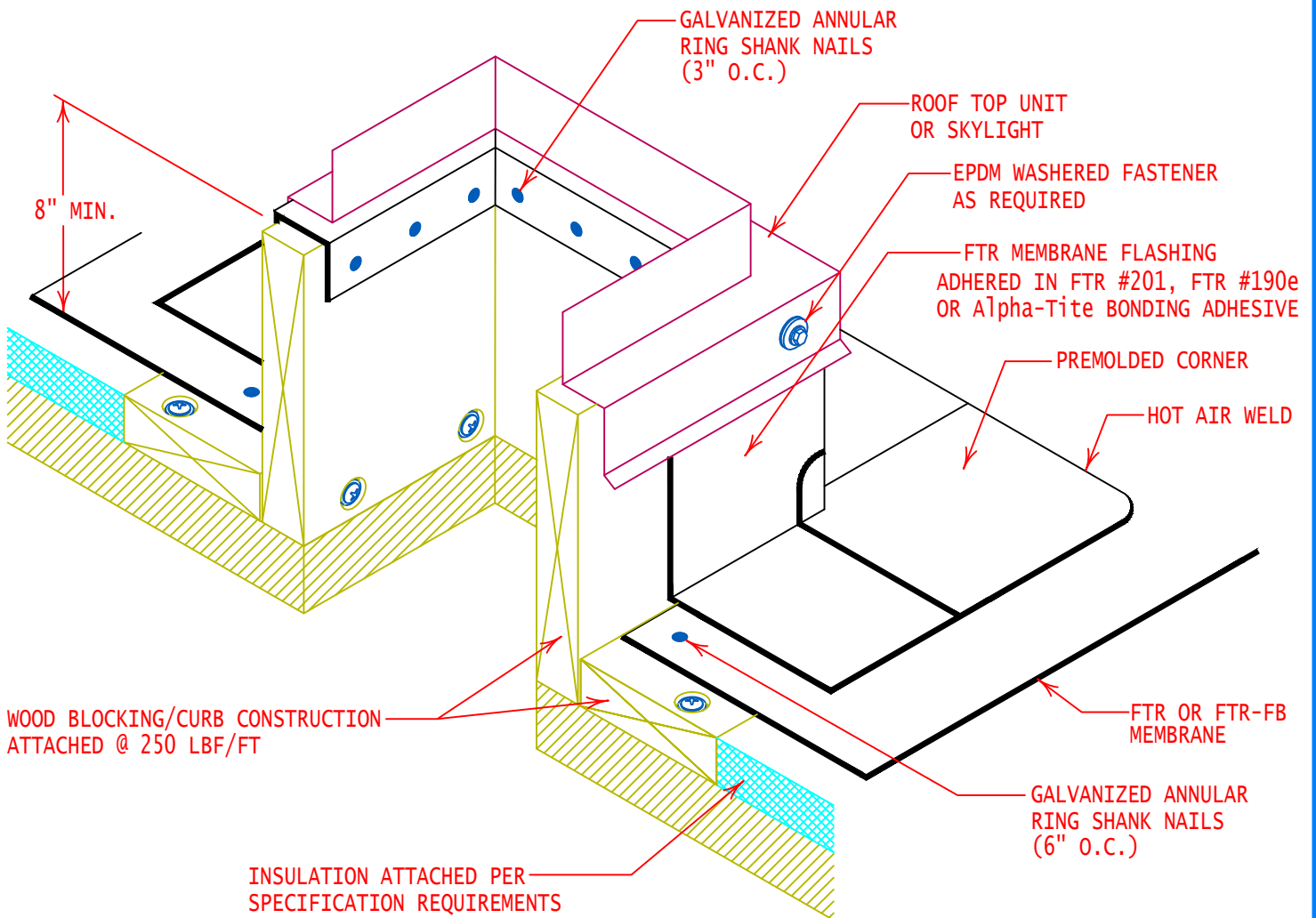

WOOD BLOCKING/CURB CONSTRUCTION  
ATTACHED @ 250 LBF/FT

INSULATION ATTACHED PER  
SPECIFICATION REQUIREMENTS



GENERAL REFERENCE:  
"FTR GS 01/21"

APPLICABLE SYSTEMS:  
"FTR MA 01/21"  
"FTR AD 01/21"  
"FTR BA 01/21"

TYPICAL WOOD CURB  
OR SKYLIGHT FLASHING

REVISES DETAIL	ISSUE DATE	DRAWING NUMBER
ALL PREVIOUS	02-23-21	FTR-DP1i